

NO. OF COPIES RECEIVED	
DISTRIBUTION	
SANTA FE	<input checked="" type="checkbox"/>
FILE	<input checked="" type="checkbox"/>
U.S.G.S.	<input checked="" type="checkbox"/>
LAND OFFICE	<input checked="" type="checkbox"/>
OPERATOR	<input checked="" type="checkbox"/>

APR 18 1983

O. C. D.

ARTESIA OFFICE

APPLICATION FOR PERMIT TO DRILL, DEEPEN, OR PLUG BACK

5A. Indicate Type of Lease
STATE <input type="checkbox"/> FEE <input checked="" type="checkbox"/>
5. State Oil & Gas Lease No.
7. Unit Agreement Name
8. Farm or Lease Name Cannon "A" #41
9. Well No. 1
10. Field and Pool, or Wildcat Undesignated ABO
12. County Chaves

1a. Type of Work
b. Type of Well DRILL <input checked="" type="checkbox"/> DEEPEN <input type="checkbox"/> PLUG BACK <input type="checkbox"/> OIL WELL <input type="checkbox"/> GAS WELL <input checked="" type="checkbox"/> OTHER <input type="checkbox"/> SINGLE ZONE <input checked="" type="checkbox"/> MULTIPLE ZONE <input type="checkbox"/>
2. Name of Operator Sanders Oil and Gas Company
3. Address of Operator 14679 Midway Rd., Suite 101, Dallas, TX 75234
4. Location of Well UNIT LETTER <u>I</u> LOCATED <u>660 1980</u> FEET FROM THE <u>East</u> <u>3</u> LINE AND <u>1980</u> FEET FROM THE <u>South</u> LINE OF SEC. <u>18</u> TWP. <u>10S</u> RGE. <u>25E</u> NMPM

19. Proposed Depth 4250	19A. Formation ABO	20. Rotary or C.T. Rotary
21. Elevations (Show whether DT, RT, etc.) GL 3525	21A. Kind & Status Plug. Bond State wide	21B. Drilling Contractor Young
		22. Approx. Date Work will start May 1st

PROPOSED CASING AND CEMENT PROGRAM

SIZE OF HOLE	SIZE OF CASING	WEIGHT PER FOOT	SETTING DEPTH	SACKS OF CEMENT	EST. TOP
12 1/4	8 5/8	24	900	450	Surface
7 7/8	4 1/2	9.5	4250	450	2800

Will drill a 12 1/4" to 915', set 900' of 8 5/8 casing and circulate cement to surface. Nipple up BOP and test surface pipe to 1000 psi for 1 hour. Reduce hole to 7 7/8" and drill to proposed T.D. If ABO zone is productive, 4 1/2 casing will be run to T.D. and cemented with 450 sacks. Drilling fluid will be fresh water and soft gel as required.

GOS is not dedicated

Posted 2 1/2
10-1-83
4-22-83

180 DAYS
10-19-83
ORDER DAY

4 ABOVE SPACE DESCRIBE PROPOSED PROGRAM; IF PROPOSAL IS TO DEEPEN OR PLUG BACK, GIVE DATA ON PRESENT PRODUCTIVE ZONE AND PROPOSED NEW PRODUCTIVE ZONE. GIVE BLOWOUT PREVENTER PROGRAM, IF ANY.

hereby certify that the information above is true and complete to the best of my knowledge and belief.

Signed Don Whitaker Title Exploration Manager Date APR 12-1983

(This space for State Use)

APPROVED BY Mark Miller TITLE OIL AND GAS INSPECTOR DATE APR 19 1983

CONDITIONS OF APPROVAL, IF ANY:

the 8 5/8 casing

NEW MEXICO OIL CONSERVATION COMMISSION
WELL LOCATION AND ACREAGE DEDICATION PLAT

RECEIVED

Form C-102
Supersedes C-128
Effective 1-1-65

APR 18 1983

All distances must be from the outer boundaries of the Section.

Operator Sanders Oil and Gas Co.			Lease Cannon (A) <i>ETD</i>		O. C. D. ARTESIA OFFICE	Well No. 1
Unit Letter	Section 18	Township 10 South	Range 25 East	County Chaves		
Actual Footage Location of Well: 1980 feet from the South line and 660 feet from the East line						
Ground Level Elev. 3525	Producing Formation <i>ABT</i>		Pool <i>UNDESIGNATED A.P.D.</i>		Dedicated Acreage: <i>100</i> Acres	

1. Outline the acreage dedicated to the subject well by colored pencil or hachure marks on the plat below.
2. If more than one lease is dedicated to the well, outline each and identify the ownership thereof (both as to working interest and royalty).
3. If more than one lease of different ownership is dedicated to the well, have the interests of all owners been consolidated by communitization, unitization, force-pooling, etc?

☒ Yes ☐ No If answer is "yes," type of consolidation *COMMUNITIZED*

If answer is "no," list the owners and tract descriptions which have actually been consolidated. (Use reverse side of this form if necessary.)

No allowable will be assigned to the well until all interests have been consolidated (by communitization, unitization, forced-pooling, or otherwise) or until a non-standard unit, eliminating such interests, has been approved by the Commission.

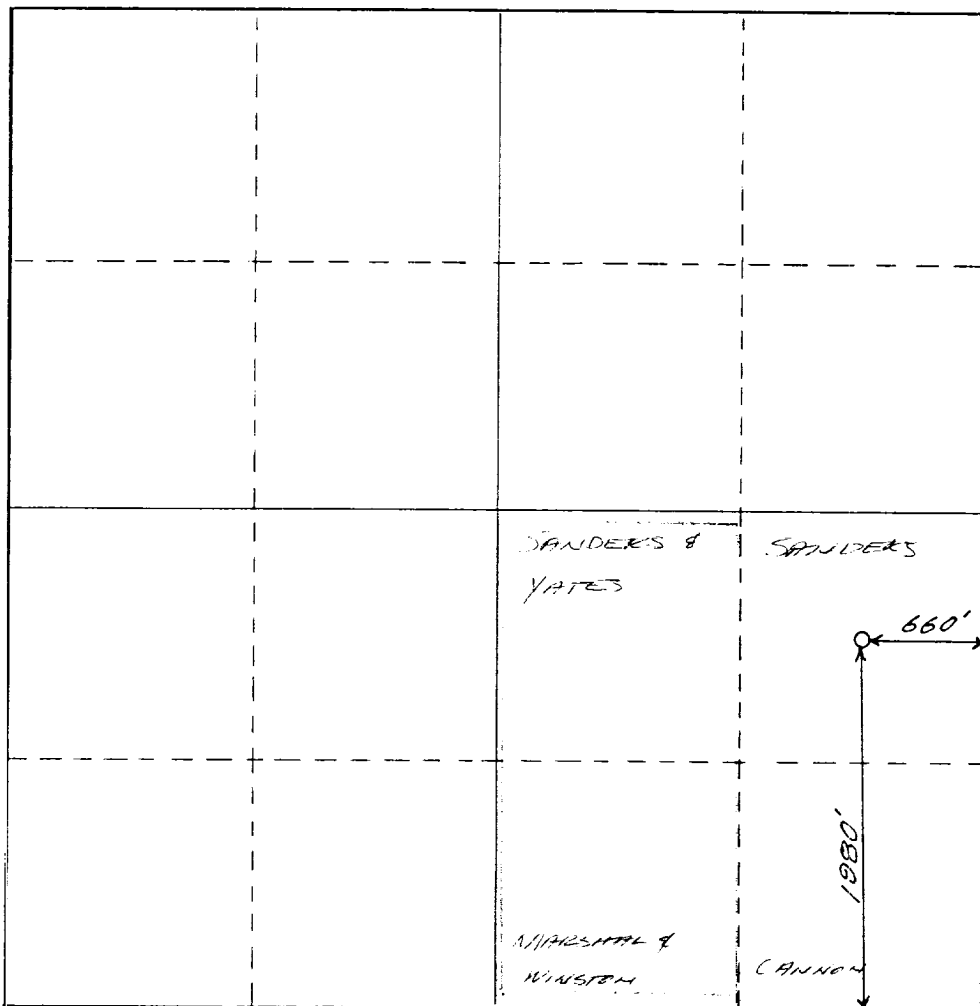

CERTIFICATION

I hereby certify that the information contained herein is true and complete to the best of my knowledge and belief.

Name
Don McArthur
Position
EXPLORATION MGR
Company
SANDERS OIL & GAS
Date
APR 12-1983

I hereby certify that the well location shown on this plat was plotted from field notes of actual surveys made by me or under my supervision, and that the same is true and correct to the best of my knowledge and belief.

March 28, 1983

Date Surveyed
P.R. Patton

Registered Professional Engineer and/or Land Surveyor

8112

Certificate No.