

UN I T E D STATES  
DEPARTMENT OF THE INTERIOR  
BUREAU OF LAND MANAGEMENT

NM Oil Cons. Commission  
SUBMIT IN TRIP  
Drawings (Instructions  
reverse side)  
Artesia, NM 88210

Form approved.  
Budget Bureau No. 1004-0135  
Expires August 31, 1985

SUNDRY NOTICES AND REPORTS ON WELLS

(Do not use this form for proposals to drill or to deepen or plug back to a different reservoir.  
Use "APPLICATION FOR PERMIT—" for such proposals.)

RECEIVED

APR 14 '88

O. C. D.  
ARTESIA OFFICE

1. OIL WELL <input type="checkbox"/> GAS WELL <input checked="" type="checkbox"/> OTHER <input type="checkbox"/>	7. UNIT AGREEMENT NAME
2. NAME OF OPERATOR Yates Petroleum Corporation	8. FARM OR LEASE NAME Mildred XD Federal
3. ADDRESS OF OPERATOR 105 South Fourth Street - Artesia, NM 88210	9. WELL NO. 1
4. LOCATION OF WELL (Report location clearly and in accordance with any State requirements. See also space 17 below.) At surface 330' FNL and 380' FEL	10. FIELD AND POOL, OR WILDCAT Pecos Slope Abo
14. PERMIT NO.	11. SEC., T., R., E., M., OR BLK. AND SURVEY OR AREA Section 33-T7S-R23E
15. ELEVATIONS (Show whether DF, RT, GR, etc.) 3835.1' GR	12. COUNTY OR PARISH Chaves
	13. STATE NM

16. Check Appropriate Box To Indicate Nature of Notice, Report, or Other Data

NOTICE OF INTENTION TO:

TEST WATER SHUT-OFF <input type="checkbox"/>	PULL OR ALTER CASING <input type="checkbox"/>
FRACTURE TREAT <input type="checkbox"/>	MULTIPLE COMPLETE <input type="checkbox"/>
SHOOT OR ACIDIZE <input type="checkbox"/>	ABANDON* <input type="checkbox"/>
REPAIR WELL <input type="checkbox"/>	CHANGE PLANS <input type="checkbox"/>

(Other) Amend Land Use Plan

X

SUBSEQUENT REPORT OF:

WATER SHUT-OFF <input type="checkbox"/>	REPAIRING WELL <input type="checkbox"/>
FRACTURE TREATMENT <input type="checkbox"/>	ALTERING CASING <input type="checkbox"/>
SHOOTING OR ACIDIZING <input type="checkbox"/>	ABANDONMENT* <input type="checkbox"/>

(Other) \_\_\_\_\_  
(NOTE: Report results of multiple completion on Well Completion or Recompletion Report and Log form.)

17. DESCRIBE PROPOSED OR COMPLETED OPERATIONS (Clearly state all pertinent details, and give pertinent dates, including estimated date of starting any proposed work. If well is directionally drilled, give subsurface locations and measured and true vertical depths for all markers and zones pertinent to this work.) \*

Amend Land Use Plan to include a natural gas pipeline right-of-way, 30 feet in width and approximately 179' in length, going from the Mildred XD Federal #1 well to the section line north of the location. From here the line will be on state surface. The pipeline will be constructed of a 2-1/2" steel pipe to be buried with a minimum of 24 inches of cover. An archaeological survey has been conducted over the proposed route. A copy has been submitted to the BLM. Note the enclosed map.

18. I hereby certify that the foregoing is true and correct

SIGNED

*Phil Kirk*

TITLE Regulatory Agent

DATE February 3, 1988

(This space for Federal or State office use)

APPROVED BY

S/Phil Kirk

TITLE Area Manager

DATE APR 13 1988

CONDITIONS OF APPROVAL, IF ANY:

Conditions of approval, if any:

This authorization is subject to the condition that all or part might be converted to a right-of-way grant in the future. Attached are two pages of stipulations which also apply.

\*See Instructions on Reverse Side

Title 18 U.S.C. Section 1001, makes it a crime for any person knowingly and willfully to make to any department or agency of the United States any false, fictitious or fraudulent statements or representations as to any matter within its jurisdiction.

R. 23 E.

T.  
7  
S.

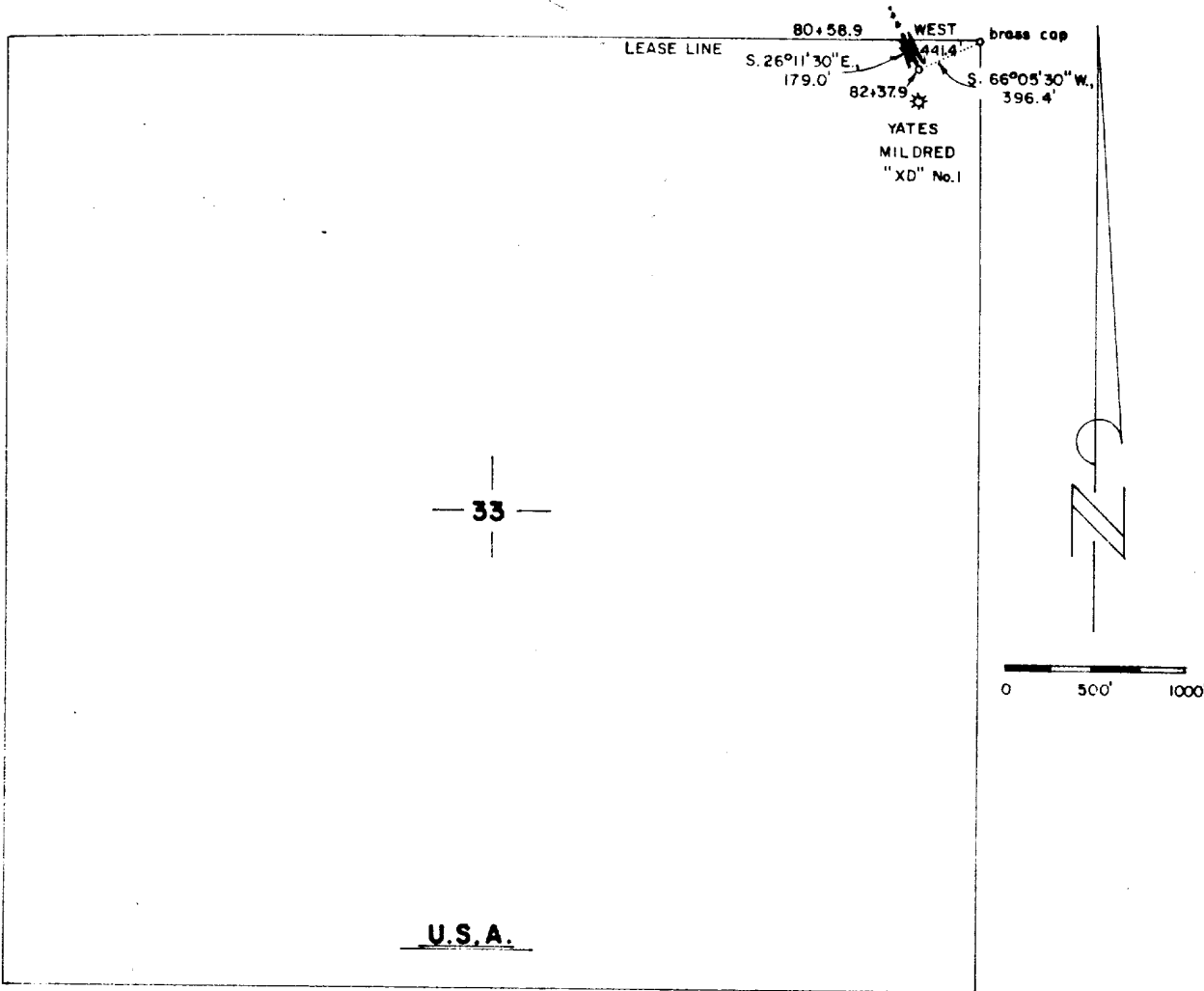

DESCRIPTION:

A Strip of land 50 feet wide, being 25 feet to the left and right of the survey centerline as shown on this plat, and being 179.0 feet in length or 0.034 miles or 0.206 acres in area, more or less.

THE PREPARATION OF THIS PLAT AND THE PERFORMANCE OF THE SURVEY UPON WHICH IT IS BASED WERE DONE UNDER MY DIRECTION AND THE PLAT ACCURATELY DEPICTS THE RESULTS OF SAID SURVEY AND MEETS THE REQUIREMENTS OF THE STANDARDS FOR LAND SURVEYS IN NEW MEXICO AS ADOPTED BY THE NEW MEXICO STATE BOARD OF REGISTRATION FOR PROFESSIONAL ENGINEERS AND LAND SURVEYORS.

YATES PETROLEUM CORPORATION

Survey for a Pipeline to connect the  
Yates MILDRED "XD" #1 located 330/E and  
380'/N of Sec.33, T.7 S., R.23 E., N.M.P.M.  
Chaves County, New Mexico.

P.O. Box 996

Lovington, New Mexico 88260

SCALE: 1" = 1000'

DRAWN BY: erb

DATE: 1/18/88

SHEET 2 OF 2

*Herschel L. Jones*  
HERSCHEL L. JONES R.L.S. No. 3640

