

P. O. BOX 2088

SANTA FE, NEW MEXICO 87501

RECEIVED

JUN 08 1983

NO. OF COPIES RECEIVED	
DISTRIBUTION	
SANTA FE	<input checked="" type="checkbox"/>
FILE	<input checked="" type="checkbox"/>
U.S.G.S.	<input checked="" type="checkbox"/>
LAND OFFICE	<input checked="" type="checkbox"/>
OPERATOR	<input checked="" type="checkbox"/>

APPLICATION FOR PERMIT TO DRILL, DEEPEN, OR PLUG BACK **C. D.**

1. Type of Work

ARTESIA, OFFICE

2. Type of Well

DRILL ☒

DEEPEN ☐

PLUG BACK ☐

OIL WELL ☐

GAS WELL ☒

OTHER

SINGLE ZONE ☐

MULTIPLE ZONE ☐

3. Name of Operator

Yates Petroleum Corporation

4. Address of Operator

207 S. 4th, Artesia, New Mexico 88210

5. Location of Well

UNIT LETTER **K**

LOCATED **1980**

FEET FROM THE **South** LINE

6. Section

**1980**

FEET FROM THE **West**

LINE OF SEC. **23**

TWP. **6S**

RGE. **25E**

NMPM

7. Unit Agreement Name

8. Farm or Lease Name

Sacra "SA"

9. Well No.

6

10. Field and Pool, or Wildcat

Pecos Slope Abo

12. County

Chaves

19. Proposed Depth

4200'

19A. Formation

Abo

20. Rotary or C.T.

Rotary

11. Elevations (show whether DF, KT, etc.)

3783.8' GL

21A. Kind & Status Plug. Bond

Blanket

21B. Drilling Contractor

not determined

22. Approx. Date Work will start

ASAP

3.

PROPOSED CASING AND CEMENT PROGRAM

SIZE OF HOLE	SIZE OF CASING	WEIGHT PER FOOT	SETTING DEPTH	SACKS OF CEMENT	EST. TOP
14 3/4"	10 3/4"	40.5# J-55	850'	700 sx	circulated
7 7/8"	4 1/2"	9.5# J-55	TD	350 sx	

We propose to drill and test the Abo and intermediate formations. Approximately 850' of surface casing will be set and cement circulated to shut off gravel and caving. If needed (lost circulation) 8 5/8" intermediate casing will be run to 1500' and cemented with enough cement calculated to tie back into the surface casing. If commercial, production casing will be run and cemented with adequate cover, perforated, and stimulated as needed for production.

MUD PROGRAM: FW gel & LCM to 850', Brine to 3200', Brine & KCL water to TD.

BOP PROGRAM: BOP's will be installed at the offset and tested daily.

GAS NOT DEDICATED.

APPROVAL VALID FOR 180 DAYS  
PERMIT EXPIRES 12-9-83  
UNLESS DRILLING UNDERWAY

ABOVE SPACE DESCRIBE PROPOSED PROGRAM: IF PROPOSAL IS TO DEEPEN OR PLUG BACK, GIVE DATA ON PRESENT PRODUCTIVE ZONE AND PROPOSED NEW PRODUCTIVE ZONE. GIVE BLOWOUT PREVENTER PROGRAM, IF ANY.

I hereby certify that the information above is true and complete to the best of my knowledge and belief.

Signed [Signature] Title Regulatory Agent

Date 6/8/83

(This space for State Use)

APPROVED BY [Signature]

TITLE

OIL AND GAS INSPECTOR

DATE

JUN 09 1983

CONDITIONS OF APPROVAL, IF ANY:

*Perforated at 850' BOP 6-10-83*

**NEW MEXICO OIL CONSERVATION COMMISSION  
WELL LOCATION AND ACREAGE DEDICATION PLAT**

Form C-102  
Supersedes C-128  
Effective 1-1-65

All distances must be from the outer boundaries of the Section.

Operator <b>YATES PETROLEUM CORPORATION</b>			Lease <b>SACRA "SA"</b>		Well No. <b>6</b>
Unit Letter <b>K</b>	Section <b>23</b>	Township <b>6 South</b>	Range <b>25 East</b>	County <b>Chaves</b>	
Actual Footage Location of Well:					
1980 feet from the <b>South</b> line and		1980 feet from the <b>West</b> line			
Ground Level Elev. <b>3783.8</b>	Producing Formation <b>Abo</b>	Pool <b>Pecos Slope Abo</b>		Dedicated Acreage: <b>160</b>	Acres

1. Outline the acreage dedicated to the subject well by colored pencil or hachure marks on the plat below.
2. If more than one lease is dedicated to the well, outline each and identify the ownership thereof (both as to working interest and royalty).
3. If more than one lease of different ownership is dedicated to the well, have the interests of all owners been consolidated by communitization, unitization, force-pooling, etc?

☐ Yes    ☐ No    If answer is "yes," type of consolidation \_\_\_\_\_

If answer is "no," list the owners and tract descriptions which have actually been consolidated. (Use reverse side of this form if necessary.) \_\_\_\_\_

No allowable will be assigned to the well until all interests have been consolidated (by communitization, unitization, forced-pooling, or otherwise) or until a non-standard unit, eliminating such interests, has been approved by the Commission.

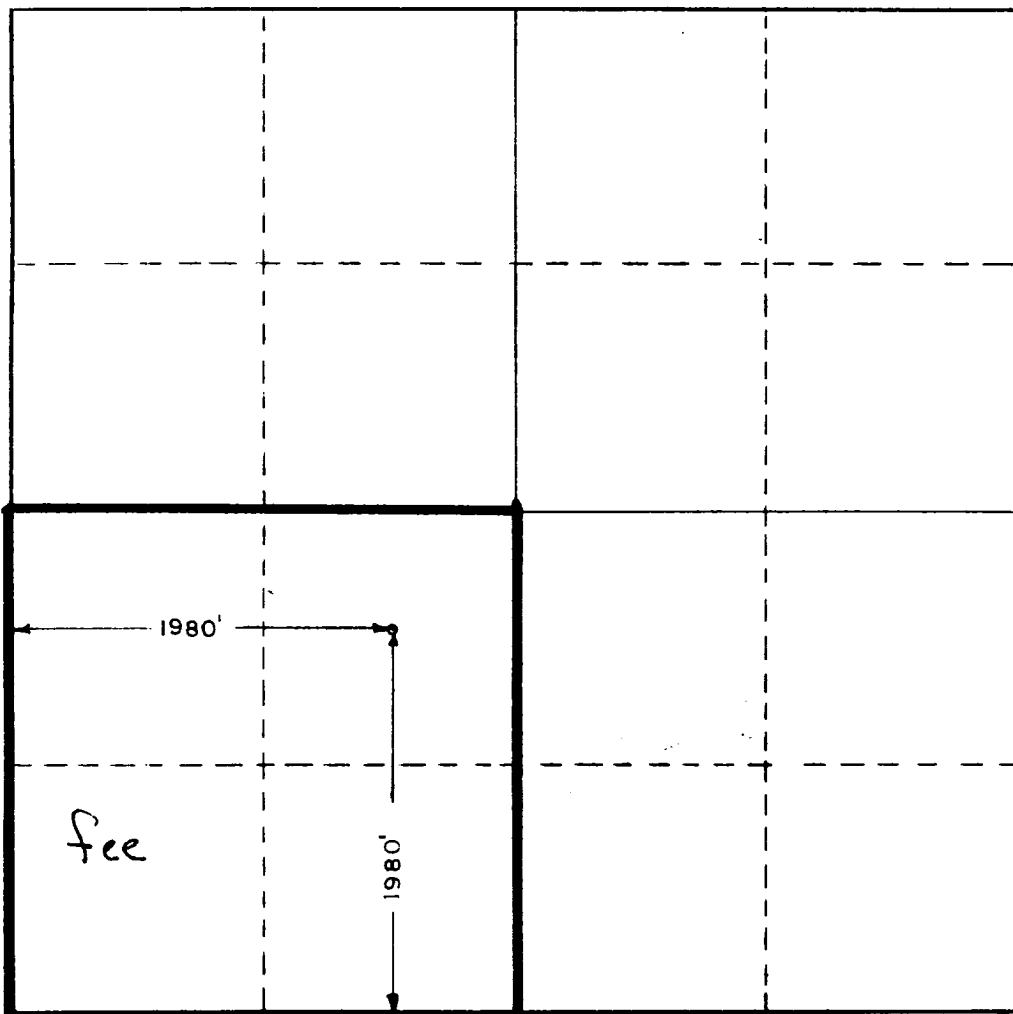

<b>CERTIFICATION</b>	
I hereby certify that the information contained herein is true and complete to the best of my knowledge and belief.	
<i>Ken Beardemphl</i>	
Name	<b>Ken Beardemphl</b>
Position	<b>Regulatory Agent</b>
Company	<b>Yates Petroleum Corp.</b>
Date	<b>6/8/83</b>
I hereby certify that the well location shown on this plat was plotted from field notes of actual surveys made by me or under my supervision, and that the same is true and correct to the best of my knowledge and belief.	
Date Surveyed	<b>6/6/83</b>
Registered Professional Engineer and/or Land Surveyor	
<i>James G. She</i>	
Certificate No.	<b>7977</b>

# EXHIBIT B

## BOP DIAGRAM

