

UNITED STATES
DEPARTMENT OF THE INTERIOR
GEOLOGICAL SURVEYDrawer 110
Artesia, NM 88210
(Other instructions on
reverse side)

APPLICATION FOR PERMIT TO DRILL, DEEPEN, OR PLUG BACK

1a. TYPE OF WORK DRILL <input checked="" type="checkbox"/> DEEPEN <input type="checkbox"/> PLUG BACK <input type="checkbox"/>		5. LEASE DESIGNATION AND SERIAL NO. N.M. 18609	
b. TYPE OF WELL OIL WELL <input checked="" type="checkbox"/> GAS WELL <input type="checkbox"/> OTHER <input type="checkbox"/>		6. IF INDIAN, ALLOTTEE OR TRIBE NAME	
2. NAME OF OPERATOR Harper Oil Company		7. UNIT AGREEMENT NAME	
3. ADDRESS OF OPERATOR Suite 310 Gibraltar Building Midland, Texas 79701		8. FARM OR LEASE NAME K M 26	
4. LOCATION OF WELL (Report location clearly and in accordance with any State requirements.) At surface 990' From N Line NW/4 NE/4 At proposed prod. zone 1980' From E Line Same		9. WELL NO. 1	
14. DISTANCE IN MILES AND DIRECTION FROM NEAREST TOWN OR POST OFFICE* 13 Miles North of Elkins, N. Mexico		10. FIELD AND POOL, OR WILDCAT San Wildcat-St. Andres	
15. DISTANCE FROM PROPOSED* LOCATION TO NEAREST PROPERTY OR LEASE LINE, FT. (Also to nearest drig. unit line, if any) 990' N		11. SEC. T., R., N., OR BLK. AND SURVEY OR AREA SEC 26-5S-27E	
16. NO. OF ACRES IN LEASE 1440		12. COUNTY OR PARISH Chaves	
17. NO. OF ACRES ASSIGNED TO THIS WELL 40		13. STATE N.M.	
18. DISTANCE FROM PROPOSED LOCATION* TO NEAREST WELL, DRILLING, COMPLETED, OR APPLIED FOR, ON THIS LEASE, FT. 3600' NE		19. PROPOSED DEPTH 1750'	
20. ROTARY OR CABLE TOOLS Rotary		21. APPROX. DATE WORK WILL START* June 20, 1983	
21. ELEVATIONS (Show whether DF, RT, GR, etc.) 4131.1 GR.		22. APPROX. DATE WORK WILL START*	
23. PROPOSED CASING AND CEMENTING PROGRAM			

SIZE OF HOLE	SIZE OF CASING	WEIGHT PER FOOT	SETTING DEPTH	QUANTITY OF CEMENT
17-1/4	13-3/8"	48#	300' DN	300 SKS (Circ.)
7-7/8	5-1/2"	15.5#	1750'	300 SKS (Circ.)

Proposed plans are to drill to the San Andres and test for possible commercial production.

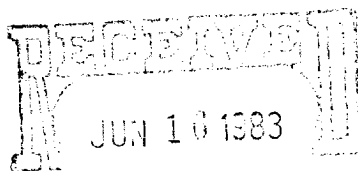

ROSWELL, NEW MEXICO

RECEIVED

JUN 30 1983

O. C. D.
ARTESIA, OFFICE

IN ABOVE SPACE DESCRIBE PROPOSED PROGRAM: If proposal is to deepen or plug back, give data on present productive zone and proposed new productive zone. If proposal is to drill or deepen directionally, give pertinent data on subsurface locations and measured and true vertical depths. Give blowout preventer program, if any.

24. SIGNED Don Rushman TITLE Production Supt. DATE 6-13-83

(This space for Federal or State office use)

PERMIT NO. _____ APPROVAL DATE _____
APPROVED BY A.C. Lopez TITLE _____
CONDITIONS OF APPROVAL, IF ANY: _____

MEXICO OIL CONSERVATION COMMISSION
WELL LOCATION AND ACREAGE DEDICATION PLAT

Form C-102
 Supersedes C-128
 Effective 1-1-65

All distances must be from the outer boundaries of the Section

Operator HARPER OIL COMPANY			Lease K M "26"		Well No. 1
Tract Letter B	Section 26	Township 5 SOUTH	Range 27 EAST	County CHAVES	
Actual Portage Location of Well: 990 feet from the NORTH line and 1980 feet from the EAST line					
Original Level Elev. 4131.1	Producing Formation <i>San Andres</i>	Pool <i>Undesignated</i>		Dedicated Acreage: 48 Acres	

1. Outline the acreage dedicated to the subject well by colored pencil or hachure marks on the plat below.
2. If more than one lease is dedicated to the well, outline each and identify the ownership thereof (both as to working interest and royalty).
3. If more than one lease of different ownership is dedicated to the well, have the interests of all owners been consolidated by communitization, unitization, force-pooling, etc?

☐ Yes ☐ No If answer is "yes," type of consolidation _____

If answer is "no," list the owners and tract descriptions which have actually been consolidated. (Use reverse side of this form if necessary.) _____

No allowable will be assigned to the well until all interests have been consolidated (by communitization, unitization, forced-pooling, or otherwise) or until a non-standard unit, eliminating such interests, has been approved by the Commission.

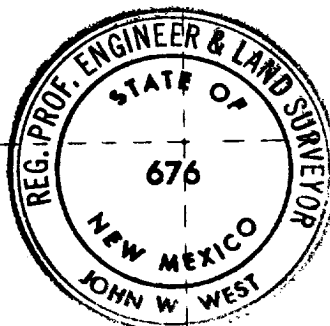
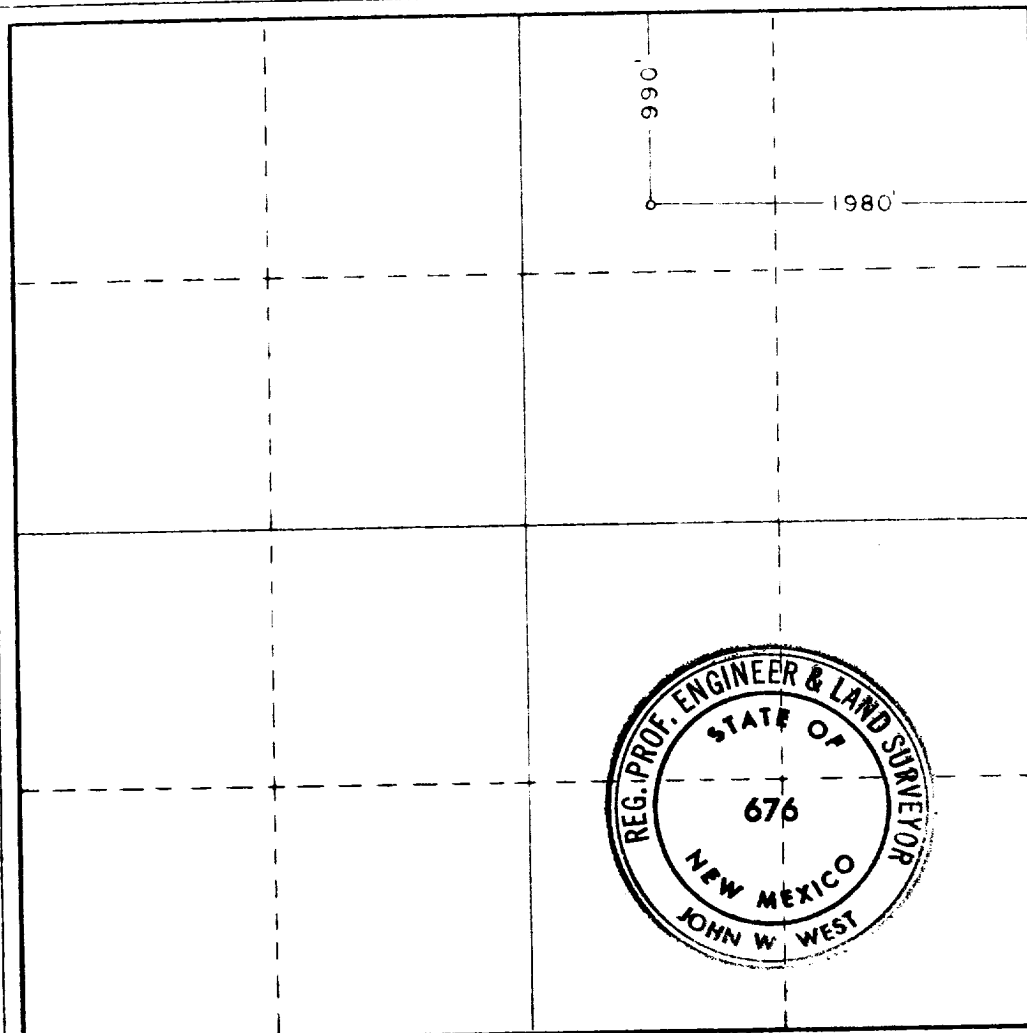

CERTIFICATION

I hereby certify that the information contained herein is true and complete to the best of my knowledge and belief

Name *Don Mudham*

Position *Prod. Supt.*

Company *Harper oil co.*

Date *June 16, 1983*

I hereby certify that the well location shown on this plat was plotted from field notes of actual surveys made by me or under my supervision, and that the same is true and correct to the best of my knowledge and belief.

Date Surveyed *5-27-83*

Registered Professional Engineer and/or Land Surveyor

John W. West

Certificate No *676*

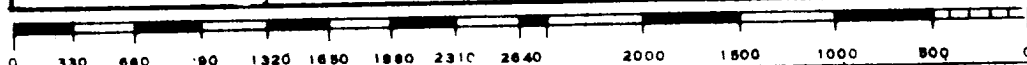

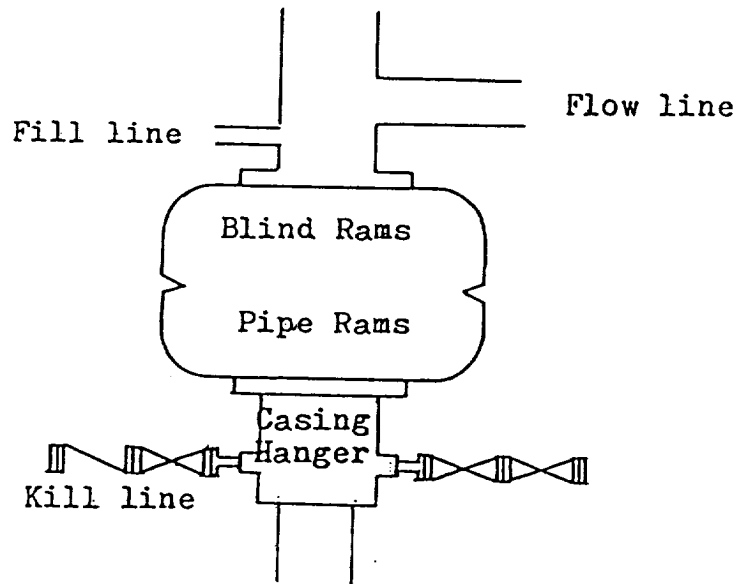

Blowout Preventer
3000 psi working pressure

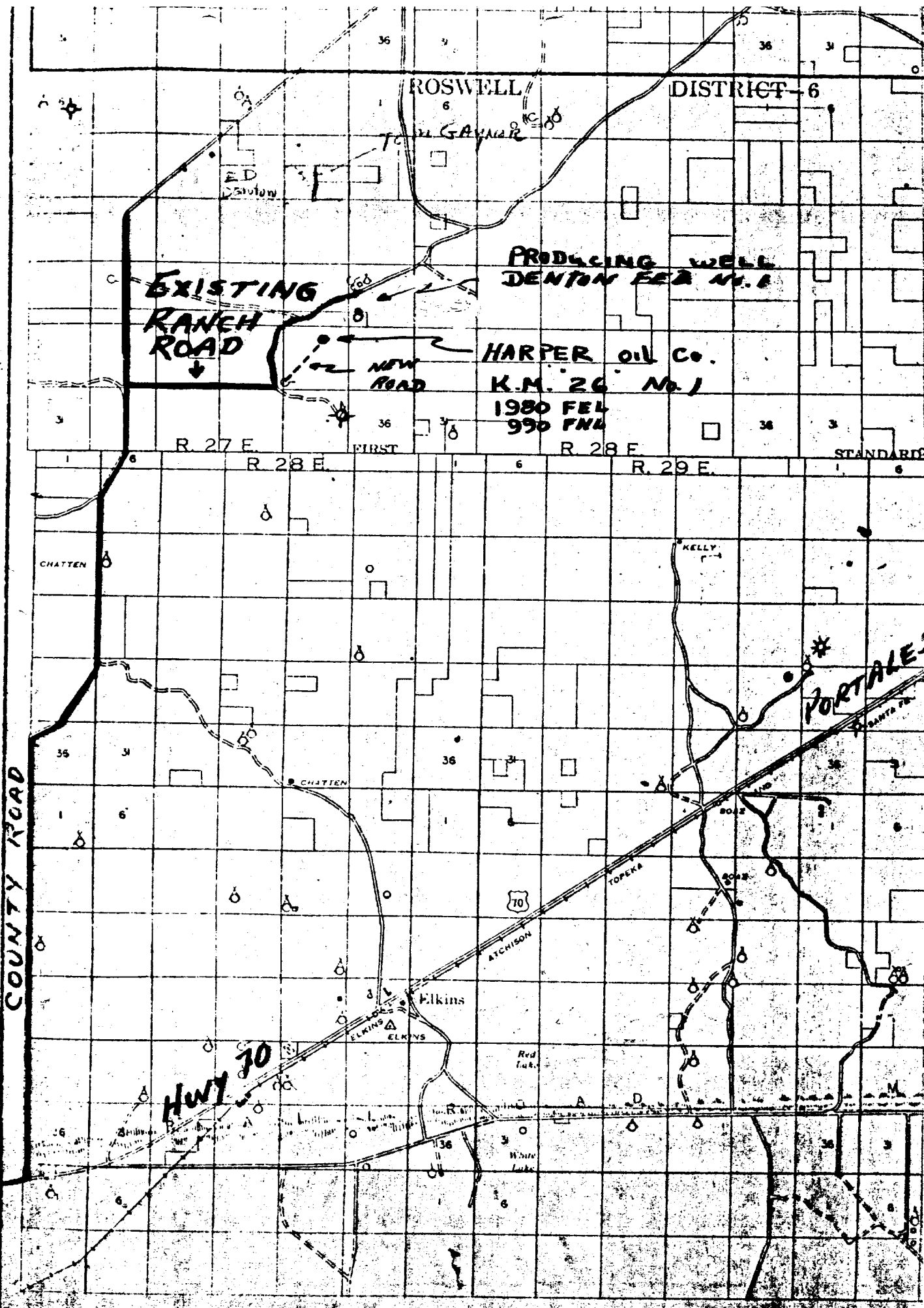

ROS WELL
27 MI.

Hwy 70

SCALE: 1" = 1 MILE

EXHIBIT A

1
N

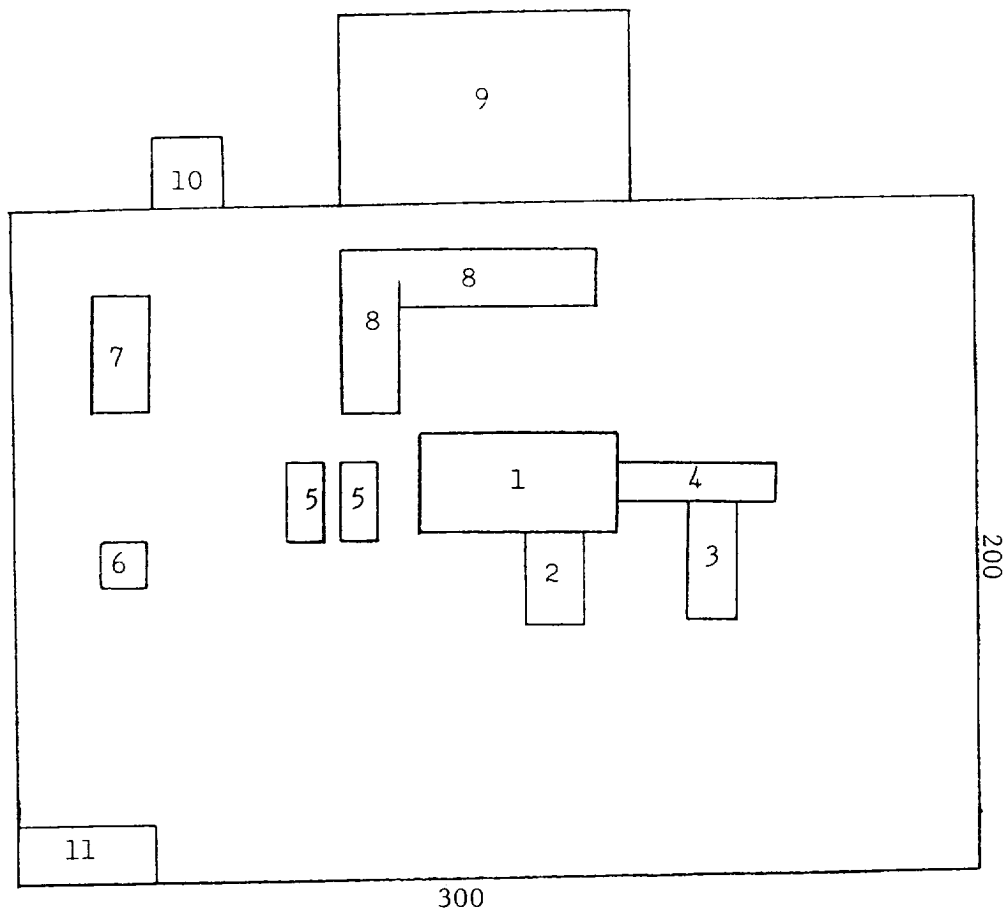

- | | |
|-----------------|-------------------|
| 1. Substructure | 7. Water Tank |
| 2. Doghouse | 8. Working Pits |
| 3. Piperacks | 9. Reserve Pit |
| 4. Catwalk | 10. Trash Pit |
| 5. Mud Pumps | 11. Trailer House |
| 6. Light Plant | |

EXHIBIT 'C'
Harper Oil Company
K. - M. 26 No. 1
1980' FEL & 990' FNL
Sec. 26, T5S, R27E
Chaves County, N.M.