

NO. OF COPIES RECEIVED	
DISTRIBUTION	
SANTA FE	<input checked="" type="checkbox"/>
FILE	<input checked="" type="checkbox"/>
U.S.G.S.	<input checked="" type="checkbox"/>
LAND OFFICE	<input checked="" type="checkbox"/>
OPERATOR	<input checked="" type="checkbox"/>

P. O. BOX 2088  
SANTA FE, NEW MEXICO 87501

RECEIVED BY

AUG 25 1983

O. C. D.

ARTESIA, OFFICE

5A. Indicate Type of Lease  
STATE ☐ FEE ☒  
30. State Oil & Gas Lease No.

## APPLICATION FOR PERMIT TO DRILL, DEEPEN, OR PLUG BACK

1. Type of Work DRILL <input checked="" type="checkbox"/> DEEPEN <input type="checkbox"/> PLUG BACK <input type="checkbox"/>		7. Unit Agreement Name
2. Type of Well OIL WELL <input type="checkbox"/> GAS WELL <input checked="" type="checkbox"/> OTHER <input type="checkbox"/>		8. Farm or Lease Name Red Lake Ridge
3. Name of Operator Stevens Operating Corporation ✓		9. Well No. 1
4. Address of Operator P. O. Box 2408, Roswell, New Mexico 88201		10. Well and Pool, or Wildcat Siliuro-Devonian
5. Location of Well UNIT LETTER C LOCATED 760 FEET FROM THE North LINE 1660 FEET FROM THE West East LINE OF SEC. 21 TWP. 8S RGE. 29E NMDM		12. County Chaves
19. Proposed Depth 8500'		19A. Formation Devonian
20. Rotary or C.T. Rotary		21. Kind & Status Plug. Bond Statewide
21B. Drilling Contractor Moranco Drilling, Inc.		22. Approx. Date Work will start August 26, 1983
1. Elevations (Show whether DR, RT, etc.) 3958.0 GR		

## PROPOSED CASING AND CEMENT PROGRAM

SIZE OF HOLE	SIZE OF CASING	WEIGHT PER FOOT	SETTING DEPTH	SACKS OF CEMENT	EST. TOP
17 1/2"	13 3/8 "	54.5 #	350'	350	Circ. to surface
11 "	8 5/8 "	24.0 #	2300'	200	
7 7/8"	4 1/2 or 5 1/2"	11.6 or 15.0 #	8500'		1000' above top pay zone

Well will be drilled to a depth of approximately 8500' to evaluate the pay zone of the Devonian formation. If commercial production is indicated, well will be selectively perforated and stimulated.

Adequate blow out preventers will be used.

Gas is not dedicated.

APPROVAL VALID FOR 180 DAYS  
PERMIT EXPIRES 2/25/84  
UNLESS DRILLING UNDERWAY

ABOVE SPACE DESCRIBE PROPOSED PROGRAM; IF PROPOSAL IS TO DEEPEN OR PLUG BACK, GIVE DATA ON PRESENT PRODUCTIVE ZONE AND PROPOSED NEW PRODUCTIVE ZONE. GIVE BLOWOUT PREVENTER PROGRAM, IF ANY.

I hereby certify that the information above is true and complete to the best of my knowledge and belief.

Signed [Signature] Title Production Controller Date August 24, 1983

(This space for State Use)

APPROVED BY [Signature] TITLE Geologist DATE 8/25/83

CONDITIONS OF APPROVAL, IF ANY:

**N MEXICO OIL CONSERVATION COMMISS.**  
**WELL LOCATION AND ACREAGE DEDICATION PLAT**

Form C-102  
 Supersedes C-128  
 Effective 1-1-65

All distances must be from the outer boundaries of the Section.

Operator <b>Stevens Operating Company</b>			Lease <b>Red Lake Ridge</b>		Well No. <b>1</b>
Plot Letter <b>C</b>	Section <b>21</b>	Township <b>8 South</b>	Range <b>29 East</b>	County <b>Chaves County</b>	
Actual Footage Location of Well:					
<b>760</b> feet from the <b>North</b> line and		<b>1660</b> feet from the <b>West</b> line			
Ground Level Elev. <b>3958.0</b>	Producing Formation <b>Devonian</b>	Pool <del>Siluro</del> <b>Devonian</b>	Dedicated Acreage: <b>320</b> Acres		

1. Outline the acreage dedicated to the subject well by colored pencil or hachure marks on the plat below.
2. If more than one lease is dedicated to the well, outline each and identify the ownership thereof (both as to working interest and royalty).
3. If more than one lease of different ownership is dedicated to the well, have the interests of all owners been consolidated by communitization, unitization, force-pooling, etc?

☐ Yes ☐ No If answer is "yes," type of consolidation \_\_\_\_\_

If answer is "no," list the owners and tract descriptions which have actually been consolidated. (Use reverse side of this form if necessary.) \_\_\_\_\_

No allowable will be assigned to the well until all interests have been consolidated (by communitization, unitization, forced-pooling, or otherwise) or until a non-standard unit, eliminating such interests, has been approved by the Commission.

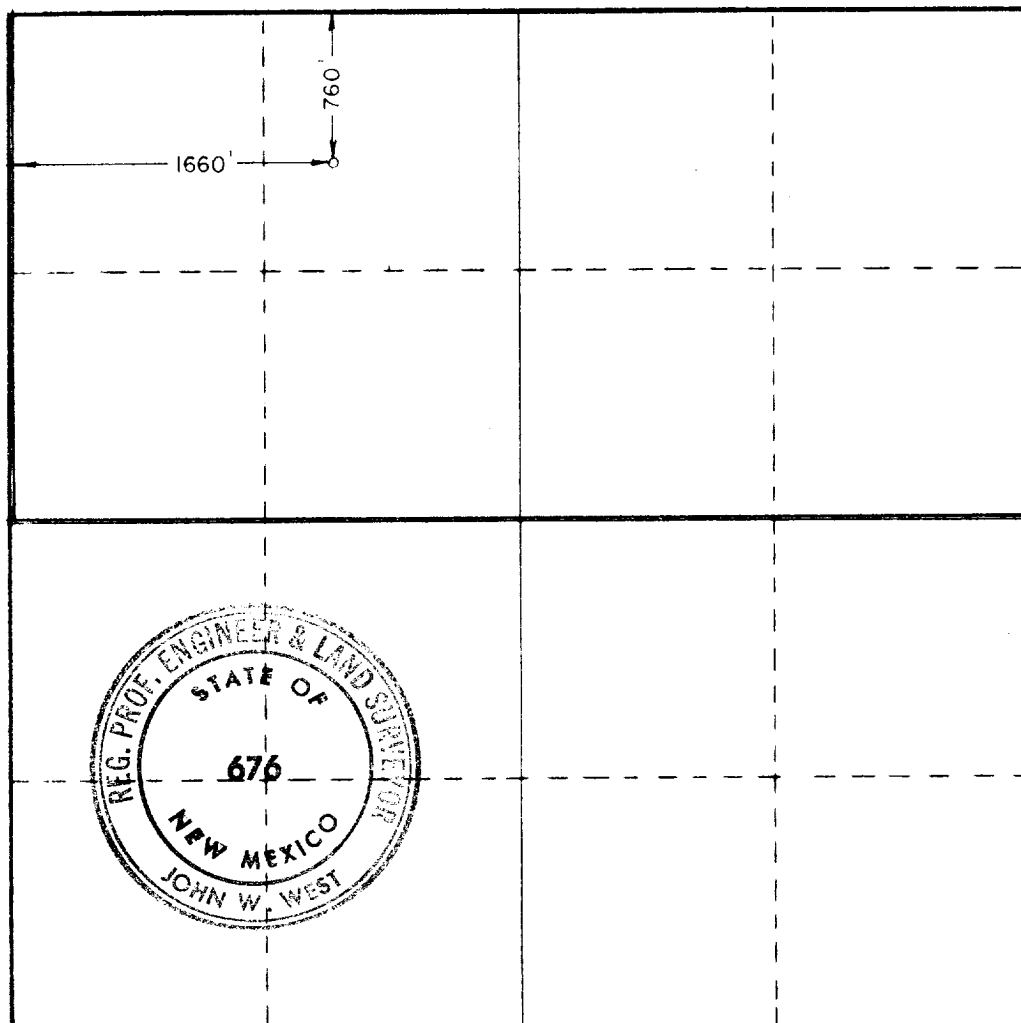

**CERTIFICATION**

I hereby certify that the information contained herein is true and complete to the best of my knowledge and belief.

Name  
**Pat Thompson**  
 Position  
**Production Controller**  
 Company  
**Stevens Operating Corporation**  
 Date  
**August 24, 1983**

I hereby certify that the well location shown on this plat was plotted from field notes of actual surveys made by me or under my supervision, and that the same is true and correct to the best of my knowledge and belief.

Date Surveyed  
**August 3, 1983**

Registered Professional Engineer and/or Land Surveyor

*John W. West*  
 Certificate No. **JOHN W. WEST, 676**  
**RONALD J. EIDSON, 3239**

0 330 660 990 1320 1650 1980 2310 2640 2000 1500 1000 500 0