

NO. OF COPIES RECEIVED	
DISTRIBUTION	
SANTA FE	<input checked="" type="checkbox"/>
FILE	<input checked="" type="checkbox"/>
U.S.G.S.	<input checked="" type="checkbox"/>
LAND OFFICE	<input checked="" type="checkbox"/>
OPERATOR	<input checked="" type="checkbox"/>

P. O. BOX 2088
SANTA FE, NEW MEXICO 87501

RECEIVED BY

AUG 23 1983

O. C. D.

ARTESIA OFFICE

5A. Indicate Type of Lease

STATE ☒FEE ☐

5. State Oil & Gas Lease No.

LG-6682

APPLICATION FOR PERMIT TO DRILL, DEEPEN, OR PLUG BACK

a. Type of Work

DRILL ☒DEEPEN ☐PLUG BACK ☐

b. Type of Well

OIL WELL ☐GAS WELL ☒

OTHER

SINGLE ZONE ☐MULTIPLE ZONE ☐

c. Name of Operator

Yates Petroleum Corporation

d. Address of Operator

207 S. 4th, Artesia, New Mexico 88210

e. Location of Well

UNIT LETTER E LOCATED 1980 FEET FROM THE North LINE

NO 660 FEET FROM THE West LINE OF SEC. 27 TWP. 7S RGE. 23E NMPM

7. Unit Agreement Name

8. Farm or Lease Name

Bajillo Draw "WQ" St

9. Well No.

5

10. Field and Pool, or Wildcat

Undes. Pecos Slope

Abo

12. County

Chaves

19. Proposed Depth

3400'

19A. Formation

Abo

20. Rotary or C.T.

Rotary

f. Elevations (show whether DF, RT, etc.)

3898.9' GL

21A. Kind & Status Plug. Bond

Blanket

21B. Drilling Contractor

AFT #2

22. Approx. Date Work will start

ASAP

3.

PROPOSED CASING AND CEMENT PROGRAM

SIZE OF HOLE	SIZE OF CASING	WEIGHT PER FOOT	SETTING DEPTH	SACKS OF CEMENT	EST. TOP
14 3/4"	10 3/4"	40.5# J-55	1100'	850 sx	circ
7 7/8"	4 1/2"	9.5# J-55	TD	350 sx	

We propose to drill and test the Abo and intermediate formations. Approximately 1100' of surface casing will be set and cement circulated to shut off gravel and caving. If needed (lost circulation) 8 5/8" intermediate casing will be run to 1500' and cemented with enough cement calculated to tie back into the surface casing. If commercial, production casing will be run and cemented with adequate cover, perforated and stimulated as needed for production.

MUD PROGRAM: FW gel/LCM to 1100', Brine to 3200', Brine/KCL water to TD.

BOP PROGRAM: BOP's will be installed at the offset and tested daily.

GAS NOT DEDICATED.

DATE FOR 180 DAYS
2-26-84
UNLESS DRILLING UNDERWAY

ABOVE SPACE DESCRIBE PROPOSED PROGRAM: IF PROPOSAL IS TO DEEPEN OR PLUG BACK, GIVE DATA ON PRESENT PRODUCTIVE ZONE AND PROPOSED NEW PRODUCTION ZONE. GIVE BLOWOUT PREVENTER PROGRAM, IF ANY.

I hereby certify that the information above is true and complete to the best of my knowledge and belief.

Signed Ken Dearden Title Regulatory Agent Date 8/18/83

(This space for State Use)

PROVED BY

Mike Williams

TITLE

OIL AND GAS INSPECTOR

DATE

AUG 26 1983

CONDITIONS OF APPROVAL, IF ANY:

Only 103/4" casing
the 103/4" casing

Posted C.P. Booth
8-26-83

NEW MEXICO OIL CONSERVATION COMMISSION
WELL LOCATION AND ACREAGE DEDICATION PLAT

Form C-102
Supersedes C-128
Effective 1-1-65

All distances must be from the outer boundaries of the Section.

Operator YATES PETROLEUM CORPORATION			Lease BAJILLO DRAW "WQ" STATE		Well No. 5
Unit Letter E	Section 27	Township 7 South	Range 23 East	County Chaves	
Actual Footage Location of Well: 660 feet from the West line and 1980 feet from the North line					
Ground Level Elev. 3898.9	Producing Formation Abo	Pool Unders. Pecos Slope Abo	Dedicated Acreage: 160 Acres		

1. Outline the acreage dedicated to the subject well by colored pencil or hachure marks on the plat below.
2. If more than one lease is dedicated to the well, outline each and identify the ownership thereof (both as to working interest and royalty).
3. If more than one lease of different ownership is dedicated to the well, have the interests of all owners been consolidated by communitization, unitization, force-pooling, etc?

☐ Yes ☐ No If answer is "yes," type of consolidation _____

If answer is "no," list the owners and tract descriptions which have actually been consolidated. (Use reverse side of this form if necessary.) _____

No allowable will be assigned to the well until all interests have been consolidated (by communitization, unitization, forced-pooling, or otherwise) or until a non-standard unit, eliminating such interests, has been approved by the Commission.

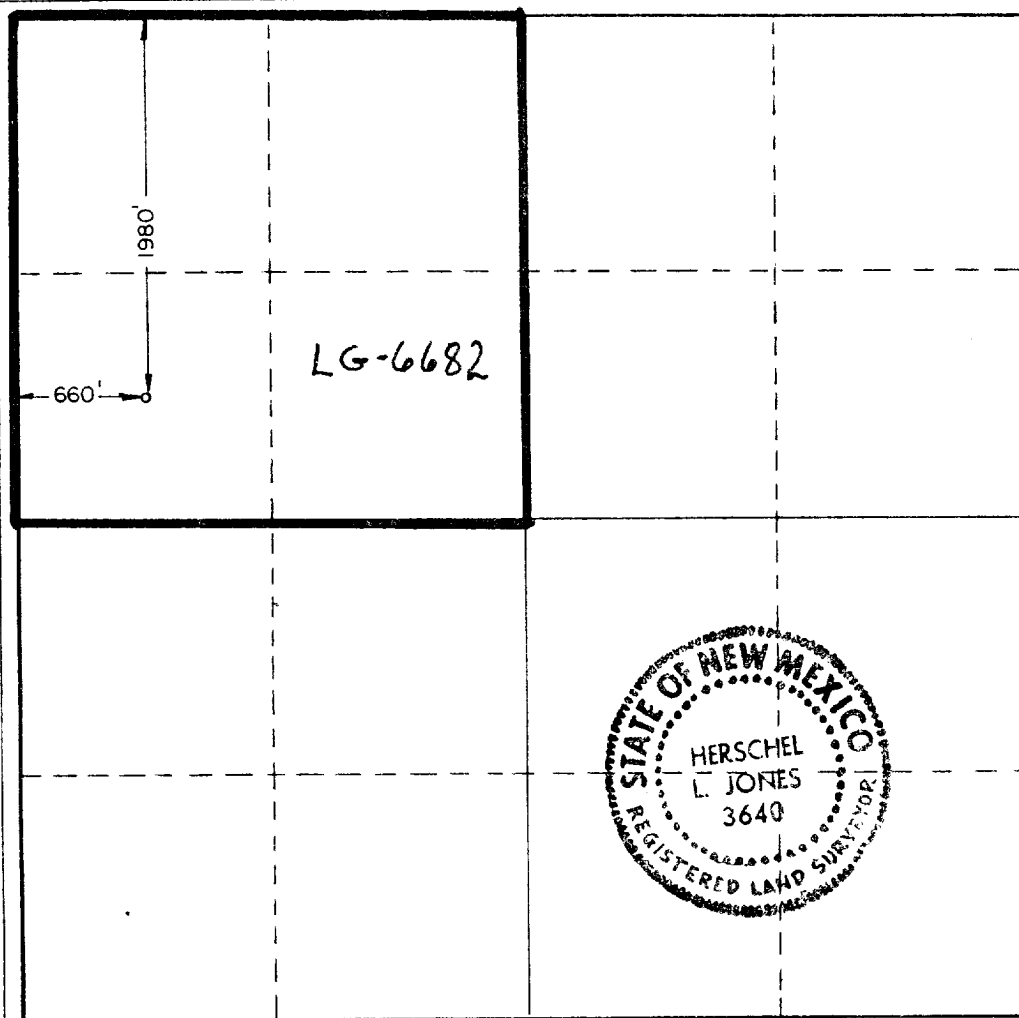

CERTIFICATION

I hereby certify that the information contained herein is true and complete to the best of my knowledge and belief.

Ken Beardemphl
Name

Ken Beardemphl
Position

Regulatory Agent
Company

Yates Petroleum Corp.

Date
8/18/83

I hereby certify that the well location shown on this plat was plotted from field notes of actual surveys made by me or under my supervision, and that the same is true and correct to the best of my knowledge and belief.

Date Surveyed
8/15/83

Registered Professional Engineer and/or Land Surveyor

Herschel L. Jones
Certificate No. 3640

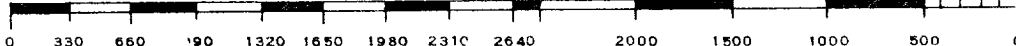

EXHIBIT B

BDP DIAGRAM

RATED 3000[#]

