

STATE OF NEW MEXICO
ENERGY AND MINERALS DEPARTMENT

OIL CONSERVATION DIVISION

P. O. BOX 2088
SANTA FE, NEW MEXICO 87501

Form C-101
Revised 10-1-79

NO. OF COPIES RECEIVED	
DISTRIBUTION	
SANTA FE	<input checked="" type="checkbox"/>
FILE	<input checked="" type="checkbox"/>
U.S.G.S.	
LAND OFFICE	
OPERATOR	<input checked="" type="checkbox"/>

5a. Indicate Type of Lease
State ☐ Fee ☒

5. State Oil & Gas Lease No.

SUNDRY NOTICES AND REPORTS ON WELLS

(DO NOT USE THIS FORM FOR PROPOSALS TO DRILL OR TO DEEPEN OR PLUG BACK TO A DIFFERENT RESERVOIR.
USE "APPLICATION FOR PERMIT -" (FORM C-101) FOR SUCH PROPOSALS.)

1. OIL WELL <input checked="" type="checkbox"/> GAS WELL <input type="checkbox"/> OTHER <input type="checkbox"/>	7. Unit Agreement Name
2. Name of Operator Rhymes Drlg. Co., Inc.	8. Farm or Lease Name O'Brien "19"
3. Address of Operator P.O. Box 729, Roswell, New Mexico	9. Well No. # 1
4. Location of Well UNIT LETTER E 2310' FEET FROM THE North LINE AND 660' FEET FROM THE West LINE, SECTION 19 TOWNSHIP 8 South RANGE 29 East NMPM.	10. Field and Pool, or WHdcat Twin Lakes-Sa Assoc.
15. Elevation (Show whether DF, RT, GR, etc.) 3972.6	12. County Chaves

Check Appropriate Box To Indicate Nature of Notice, Report or Other Data

NOTICE OF INTENTION TO:

SUBSEQUENT REPORT OF:

PERFORM REMEDIAL WORK <input type="checkbox"/>	PLUG AND ABANDON <input type="checkbox"/>	REMEDIAL WORK <input type="checkbox"/>	ALTERING CASING <input type="checkbox"/>
TEMPORARILY ABANDON <input type="checkbox"/>	CHANGE PLANS <input type="checkbox"/>	COMMENCE DRILLING OPNS. <input checked="" type="checkbox"/>	PLUG AND ABANDONMENT <input type="checkbox"/>
PULL OR ALTER CASING <input type="checkbox"/>	OTHER <input type="checkbox"/>	CASING TEST AND CEMENT JOBS <input checked="" type="checkbox"/>	OTHER <input type="checkbox"/>

17. Describe Proposed or Completed Operations (Clearly state all pertinent details, and give pertinent dates, including estimated date of starting any proposed work) SEE RULE 1703.

09/06/83 Spud well @ 1:00 P.M. W/Cable Tool
09/08/83 Drill to 125' Ran 3 Jts. 125' 8 5/8" 24# Casing
Cement W/ 6 Yards, 6 Sk. 2 % CaCl Redi-Mix
09/17/83 Move Rotary on Hole
09/21/83 Drlg. 7 7/8" Hole to 2825'
09/22/83 Ran 67 Jts. 2825' 4 1/2" 9.5 J-55 Csg.
Cmt. W/ 175 Sk. Class "C" 50/50 Poz
Bumped Plug @ 6:00 P.M. W/1000 P.S.I.
Csg. ok

18. I hereby certify that the information above is true and complete to the best of my knowledge and belief.

SIGNED <u>Gaddie G. Givens</u>	TITLE <u>Operations Manager</u>	DATE <u>09/23/83</u>
APPROVED BY <u>Leslie A. Clements</u>	TITLE <u>Supervisor District II</u>	DATE <u>SEP 28 1983</u>
CONDITIONS OF APPROVAL, IF ANY:		

OIL CONSERVATION DIVISION
P. O. BOX 2088
SANTA FE, NEW MEXICO 87506

Form C-101 30-005-62044
Revised 10-1-78

NO. OF COPIES RECEIVED	
DISTRIBUTION	
SANTA FE	<input checked="" type="checkbox"/>
FILE	<input checked="" type="checkbox"/>
U.S.G.S.	<input checked="" type="checkbox"/>
LAND OFFICE	<input checked="" type="checkbox"/>
OPERATOR	<input checked="" type="checkbox"/>

O. C. D.
ARTESIA, OFFICE

5. Indicate Type of Lease
STATE ☐ FEDERAL ☒
6. State Oil & Gas Lease No.

APPLICATION FOR PERMIT TO DRILL, DEEPEN, OR PLUG BACK

1. Type of Work DRILL <input checked="" type="checkbox"/> DEEPEN <input type="checkbox"/> PLUG BACK <input type="checkbox"/>		7. Unit Agreement Name
2. Type of Well OIL WELL <input checked="" type="checkbox"/> GAS WELL <input type="checkbox"/> OTHER <input type="checkbox"/> SINGLE ZONE <input checked="" type="checkbox"/> MULTIPLE ZONE <input type="checkbox"/>		8. Farm or Lease Name O'Brien #19
3. Name of Operator Rhymes Drilling Co., Inc.		9. Well No. #1
4. Address of Operator P.O. Box 729, Roswell, NM 88201		10. Field and Pool, or Wildcat Twin Lakes - SA Assoc.
5. Location of Well UNIT LETTER E LOCATED 2310' FEET FROM THE North LINE 660' FEET FROM THE West LINE OF SEC. 19 TWP. 8 S RGE. 29 E NMPM		12. County Chaves
18. Proposed Depth 2850'		19A. Formation San Andres
20. Rotary or C.T. Rotary		21. Elevations (Show whether DF, KT, etc.) 3972.6 GR.
21A. Kind & Status Plug. Bond Single Well		21B. Drilling Contractor Salazar Bros.
22. Approx. Date Work will start Sept. 1, 1983		

PROPOSED CASING AND CEMENT PROGRAM

SIZE OF HOLE	SIZE OF CASING	WEIGHT PER FOOT	SETTING DEPTH	SACKS OF CEMENT	EST. TOP
11"	8 5/8"	23#	125'	75 sks.	Surface
7 7/8"	4 1/2"	9.5	2850'	175 sks.	2100'

Adequate Blowout preventers will be used.

Ported up
2-1-84
8-26-83

APPROVAL VALID FOR 180 DAYS
PERMIT EXPIRES 2-26-84
UNLESS DRILLING UNDERWAY

ABOVE SPACE DESCRIBE PROPOSED PROGRAM; IF PROPOSAL IS TO DEEPEN OR PLUG BACK, GIVE DATA ON PRESENT PRODUCTIVE ZONE AND PROPOSED NEW PRODUCTIVE ZONE. GIVE BLOWOUT PREVENTER PROGRAM, IF ANY.

I hereby certify that the information above is true and complete to the best of my knowledge and belief.

Signature: Sadie Sisco Title: Operations Manager Date: 08/18/83
(This space for State Use)

PROVED BY: Mike Williams TITLE: OIL AND GAS INSPECTOR DATE: AUG 26 1983

CONDITIONS OF APPROVAL, IF ANY:

Not to be used for anything
other than the 8 5/8" casing

STATE OF NEW MEXICO
ENERGY AND MINERALS DEPARTMENT

OIL CONSERVATION DIVISION

P. O. BOX 2088
SANTA FE, NEW MEXICO 87501

All distances must be from the outer boundaries of the Section.

RECEIVED BY	
FORM C-102 Revised 10-1-78	
AUG 23 1983	
Well No.	O. C. I. D.
ARTESIA, OFFICE	

Operator Rhymes Drilling Co., Inc.		Lease O'Brien (19)	
Init Letter E	Section 19	Township 8 South	Range 29 East
		County Chaves	

Actual Footage Location of Well: 2310 feet from the North		Line and 660	feet from the West	Line
Ground Level Elev. 3972.6	Producing Formation San Andres	Pool Twin Lakes	Dedicated Acreage: 40.0	Acres

1. Outline the acreage dedicated to the subject well by colored pencil or hatchure marks on the plat below.
2. If more than one lease is dedicated to the well, outline each and identify the ownership thereof (both as to working interest and royalty).
3. If more than one lease of different ownership is dedicated to the well, have the interests of all owners been consolidated by communitization, unitization, force-pooling, etc?

☐ Yes ☐ No If answer is "yes," type of consolidation _____

If answer is "no," list the owners and tract descriptions which have actually been consolidated. (Use reverse side of this form if necessary.) _____

No allowable will be assigned to the well until all interests have been consolidated (by communitization, unitization, forced-pooling, or otherwise) or until a non-standard unit, eliminating such interests, has been approved by the Division.

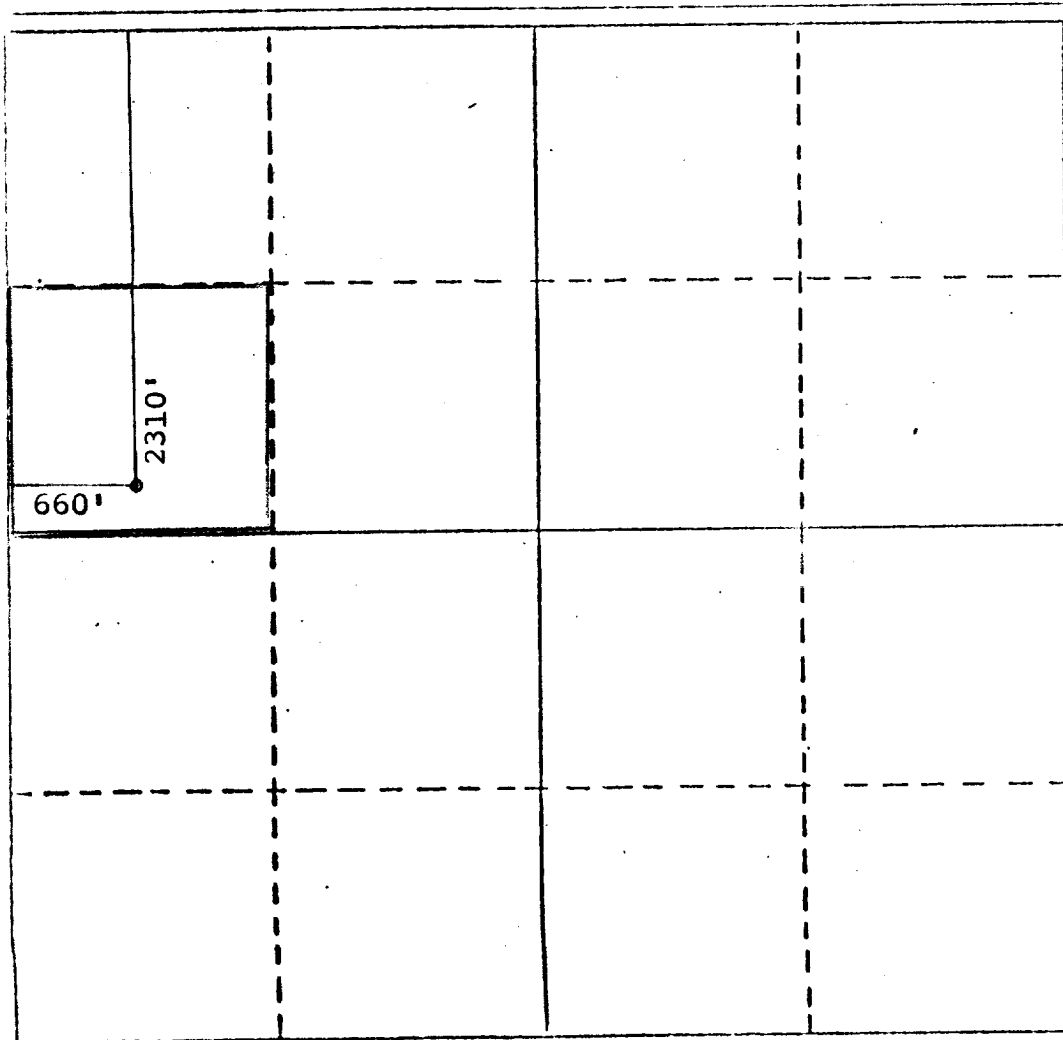

CERTIFICATION

I hereby certify that the information contained herein is true and complete to the best of my knowledge and belief.

Name
SS Siver
Position
Operations Manager
Company
Rhymes Drilling Co., Inc.
Date
August 21, 1983

I hereby certify that the well location shown on this plat was proved from field notes of actual survey, or from me or under my supervision, and the same is true to the best of my knowledge and belief.

August 16, 1983

Date Surveyed
Jackie D. Atkins
Registered Professional Engineer
and/or Land Surveyor

PE 6403 LS 8504

Certificate No.

0 320 640 960 1280 1600 1920 2240 2560 2880 3200 3520 3840 4160 4480 4800 5120 5440 5760 6080 6400