

OIL CONSERVATION RECEIVED BY
P. O. BOX 2088
SANTA FE, NEW MEXICO 87501

Form C-101 30-005-62045
Revised 10-1-78

| | |
|------------------------|-------------------------------------|
| NO. OF COPIES RECEIVED | |
| DISTRIBUTION | |
| SANTA FE | <input checked="" type="checkbox"/> |
| FILE | <input checked="" type="checkbox"/> |
| U.S.G.S. | <input checked="" type="checkbox"/> |
| LAND OFFICE | <input checked="" type="checkbox"/> |
| OPERATOR | <input checked="" type="checkbox"/> |

AUG 23 1983
O. C. D.
ARTESIA, OFFICE

5A. Indicate Type of Lease
STATE ☐ FEE ☒
5. State Oil & Gas Lease No.

APPLICATION FOR PERMIT TO DRILL, DEEPEN, OR PLUG BACK

| | | |
|---|--|---|
| Type of Work DRILL <input checked="" type="checkbox"/> DEEPEN <input type="checkbox"/> PLUG BACK <input type="checkbox"/> | | 7. Unit Agreement Name |
| Type of Well OIL WELL <input checked="" type="checkbox"/> GAS WELL <input type="checkbox"/> OTHER <input type="checkbox"/> | | 8. Form or Lease Name O'Brien #19 |
| Name of Operator Rhymes Drilg. Co., Inc. | | 9. Well No. 2 |
| Address of Operator P.O. Box 729, Roswell, NM 88201 | | 10. Field and Pool, or Wildcat Twin Lakes - SA Basin |
| Location of Well UNIT LETTER C LOCATED 990 FEET FROM THE North LINE 1650 FEET FROM THE West LINE OF SEC. 19 TWP. 8 S RGE. 29 E NMPM | | 12. County Chaves |
| 19. Proposed Depth 2850' | | 19A. Formation San Andres |
| 20. Rotary or C.T. Rotary | | |
| Elevations (Show whether DI, RT, etc.) 3985.7 GR. | | 21A. Kind & Status Plug. Bond Single Well |
| 21B. Drilling Contractor Salazar Bros. | | 22. Approx. Date Work will start Sept. 10, 1983 |

PROPOSED CASING AND CEMENT PROGRAM

| SIZE OF HOLE | SIZE OF CASING | WEIGHT PER FOOT | SETTING DEPTH | SACKS OF CEMENT | EST. TOP |
|--------------|----------------|-----------------|---------------|-----------------|----------|
| 11" | 8 5/8" | 23# | 125' | 75 sks. | Surface |
| 7 7/8" | 4 1/2" | 9.5 | 2850' | 175 sks. | 2100' |

Adequate blowout preventers will be used.

*Postcard
AD-14111 Book
8-26-83*

APPROVAL VALID FOR 180 DAYS
PERMIT EXPIRES 2-26-84
UNLESS DRILLING UNDERWAY

ABOVE SPACE DESCRIBE PROPOSED PROGRAM: IF PROPOSAL IS TO DEEPEN OR PLUG BACK, GIVE DATA ON PRESENT PRODUCTIVE ZONE AND PROPOSED NEW PRODUCTIVE ZONE. GIVE BLOWOUT PREVENTER PROGRAM, IF ANY.

I hereby certify that the information above is true and complete to the best of my knowledge and belief.

Signed Sadie Sivecoak Title Operations Manager Date 08/18/83
(This space for State Use)

APPROVED BY Mike Walker TITLE OIL AND GAS INSPECTOR DATE AUG 26 1983
CONDITIONS OF APPROVAL, IF ANY:
Noted: 2850' to sufficient
the 8 5/8 casing

STATE OF NEW MEXICO
ENERGY AND MINERALS DEPARTMENT

OIL CONSERVATION DIVISION
P. O. BOX 2088
SANTA FE, NEW MEXICO 87501

All distances must be from the outer boundaries of the Section

RECEIVED BY

Form C-102
Revised 10-1-78

AUG 23 1983

| | | | | | |
|---------------------------------------|---------------|-----------------------|------------------|-----------------------------------|--|
| Operator Rhymes Drilling Co., Inc. | | Lease O'Brien (19) | | O. C. D. Well No. ARTESIA 0122 | |
| Init Letter C | Section 19 | Township 8 South | Range 29 East | County Chaves | |

| | | | |
|--|-----------------------------------|--------------------------------|----------------------------------|
| Actual Well Location of Well: 990 feet from the North line and 1650 feet from the West line | | Pool Twin Lakes - SA A-2111 | Dedicated Acreage: 40.0 Acres |
| Ground Level Elev. 3985.7 | Producing Formation San Andres | | |

1. Outline the acreage dedicated to the subject well by colored pencil or hatchure marks on the plat below.
2. If more than one lease is dedicated to the well, outline each and identify the ownership thereof (both as to working interest and royalty).
3. If more than one lease of different ownership is dedicated to the well, have the interests of all owners been consolidated by communitization, unitization, force-pooling, etc?

☐ Yes ☐ No If answer is "yes," type of consolidation _____

If answer is "no," list the owners and tract descriptions which have actually been consolidated. (Use reverse side of this form if necessary.) _____

No allowable will be assigned to the well until all interests have been consolidated (by communitization, unitization, forced-pooling, or otherwise) or until a non-standard unit, eliminating such interests, has been approved by the Division.

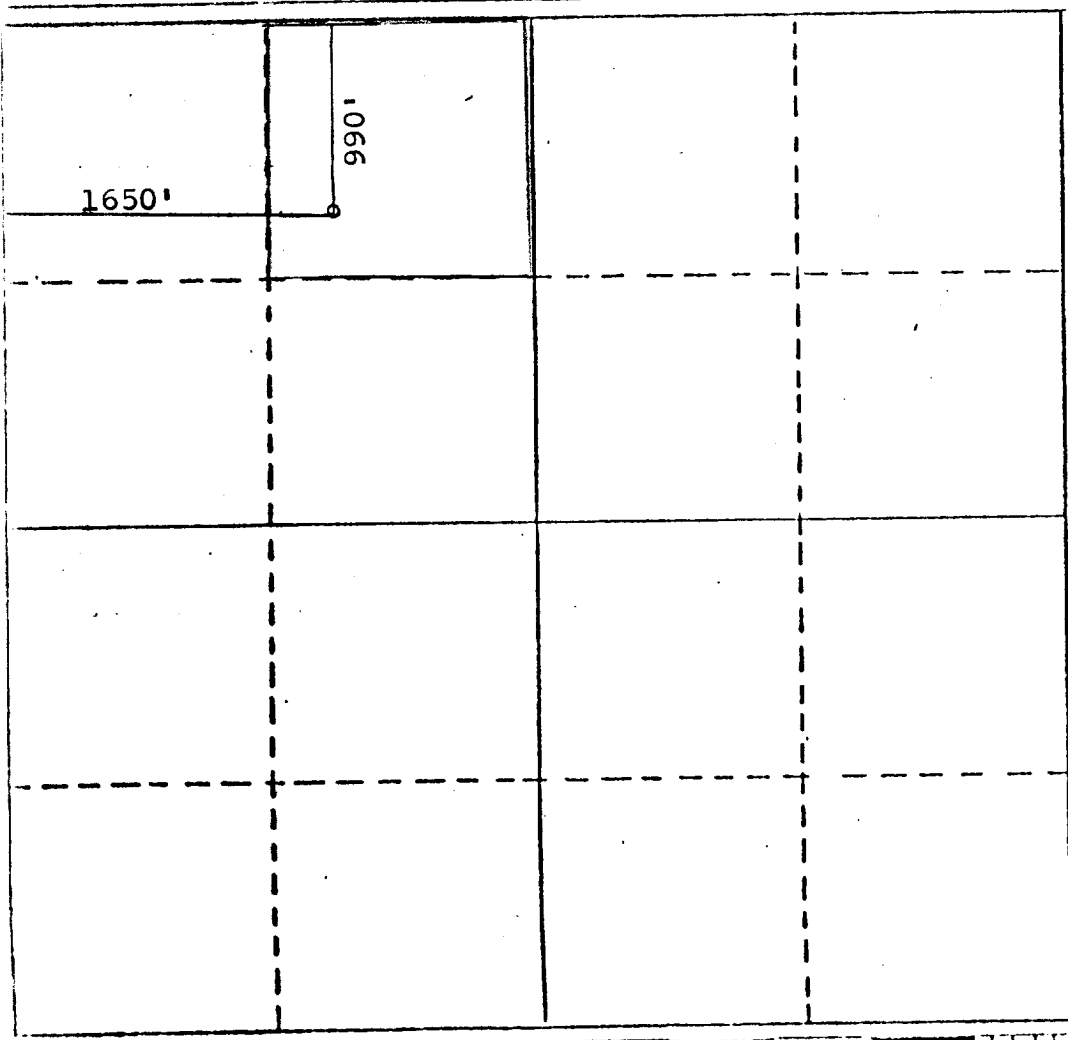

CERTIFICATION

I hereby certify that the information contained herein is true and complete to the best of my knowledge and belief.

| |
|--------------------------------------|
| Name <i>L. L. Siverek</i> |
| Position Operations Manager |
| Company Rhymes Drilling Co., Inc. |
| Date August 21, 1983 |

I hereby certify that the well location shown on this plat was plotted from field notes of _____ or under my supervision and that the same is true and correct to the best of my knowledge and belief.



| |
|---|
| Date Surveyed August 16, 1983 |
| Signature <i>Jackie B. Atkins</i> |
| Registered Professional Engineer and/or Land Surveyor |

PE 6403 LS 8504

Certificate No.

