

OIL CONSERVATION DIVISION  
P. O. BOX 2088  
SANTA FE, NEW MEXICO 87501

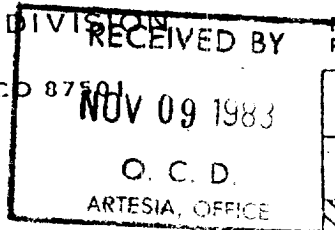

Form C-101 31-105-62068  
Revised 10-1-78

NO. OF COPIES RECEIVED	
DISTRIBUTION	
SANTA FE	✓
FILE	✓
U.S.G.S.	✓
LAND OFFICE	✓
OPERATOR	✓

5. Indicate Type of Lease  
STATE ☐ FEE ☒  
6. State Oil & Gas Lease No.

APPLICATION FOR PERMIT TO DRILL, DEEPEN, OR PLUG BACK

a. Type of Work DRILL <input checked="" type="checkbox"/> DEEPEN <input type="checkbox"/> PLUG BACK <input type="checkbox"/>		7. Unit Agreement Name
b. Type of Well OIL WELL <input checked="" type="checkbox"/> GAS WELL <input type="checkbox"/> OTHER <input type="checkbox"/> SINGLE ZONE <input type="checkbox"/> MULTIPLE ZONE <input type="checkbox"/>		8. Farm or Lease Name O'Brien "D"
c. Name of Operator STEVENS OPERATING CORPORATION ✓		9. Well No. 6
d. Address of Operator P. O. Box 2408, Roswell, New Mexico 88201		10. Field and Pool, or Wildcat Twin Lakes San Andres
e. Location of well UNIT LETTER <u>H</u> LOCATED <u>2310</u> FEET FROM THE <u>North</u> LINE NO <u>330</u> FEET FROM THE <u>East</u> LINE OF SEC. <u>12</u> TWP. <u>9S</u> RGE. <u>28E</u> RMPM		12. County Chaves
19. Proposed Depth 2700'		19A. Formation San Andres
20. Rotary or C.T. Cable Tool		
1. Elevations (Show whether D.R., K.I., etc.) 3905.4 GR	21A. Kind & Status Plug. Bond Statewide	21B. Drilling Contractor Comanche Drilling
22. Approx. Date Work will start November 14, 1983		

PROPOSED CASING AND CEMENT PROGRAM

SIZE OF HOLE	SIZE OF CASING	WEIGHT PER FOOT	SETTING DEPTH	SACKS OF CEMENT	EST. TOP
16"	13 3/8"	54.5#	60' 120	<del>ready mix</del> CIRC	CIRC
10"	8 5/8"	24.0#	700'	150	300'
8"	4 1/2"	10.5	2700'	300	500' above pay zone

Well will be drilled to a depth of approximately 2700' to evaluate the pay zone of the San Andres formation. If commercial production is indicated, well will be selectively perforated and stimulated.

Adequate blow out preventers will be used.

Posted R.R.  
SD-101 Book  
11-13-83

APPROVAL VALID FOR 180 DAYS  
EXPIRES 5-10-84  
UNLESS DRILLING UNDERWAY

4. ABOVE SPACE DESCRIBE PROPOSED PROGRAM; IF PROPOSAL IS TO DEEPEN OR PLUG BACK, GIVE DATA ON PRESENT PRODUCTIVE ZONE AND PROPOSED NEW PRODUCTIVE ZONE. GIVE BLOWOUT PREVENTER PROGRAM, IF ANY.

I hereby certify that the information above is true and complete to the best of my knowledge and belief.

Signed Gus M. King Title Production Controller Date November 8, 1983

(This space for State Use)

APPROVED BY Frank Williams TITLE OIL AND GAS INSPECTOR DATE NOV 10 1983

CONDITIONS OF APPROVAL, IF ANY:

NEW MEXICO OIL CONSERVATION COMMISSION  
WELL LOCATION AND ACREAGE DEDICATION PLAT

Form C-102  
Supersedes C-128  
Effective 1-1-65

All distances must be from the outer boundaries of the Section.

Operator <b>STEVENS OPERATING CO.</b>			Lease <b>O'BRIEN D</b>		Well No. <b>6</b>
Unit Letter <b>H</b>	Section <b>12</b>	Township <b>9 SOUTH</b>	Range <b>28 EAST</b>	County <b>CHAVES</b>	
Actual Footage Location of Well: <b>2310</b> feet from the <b>NORTH</b> line and <b>330</b> feet from the <b>EAST</b> line					
Ground Level Elev. <b>3905.4</b>	Producing Formation <b>San Andres</b>		Pool <b>Twin Lakes San Andres Assoc.</b>	Dedicated Acreage: <b>40</b> Acres	

1. Outline the acreage dedicated to the subject well by colored pencil or hatchure marks on the plat below.
2. If more than one lease is dedicated to the well, outline each and identify the ownership thereof (both as to working interest and royalty).
3. If more than one lease of different ownership is dedicated to the well, have the interests of all owners been consolidated by communitization, unitization, force-pooling, etc?

☐ Yes ☐ No If answer is "yes," type of consolidation \_\_\_\_\_

If answer is "no," list the owners and tract descriptions which have actually been consolidated. (Use reverse side of this form if necessary.) \_\_\_\_\_

No allowable will be assigned to the well until all interests have been consolidated (by communitization, unitization, forced-pooling, or otherwise) or until a non-standard unit, eliminating such interests, has been approved by the Commission.

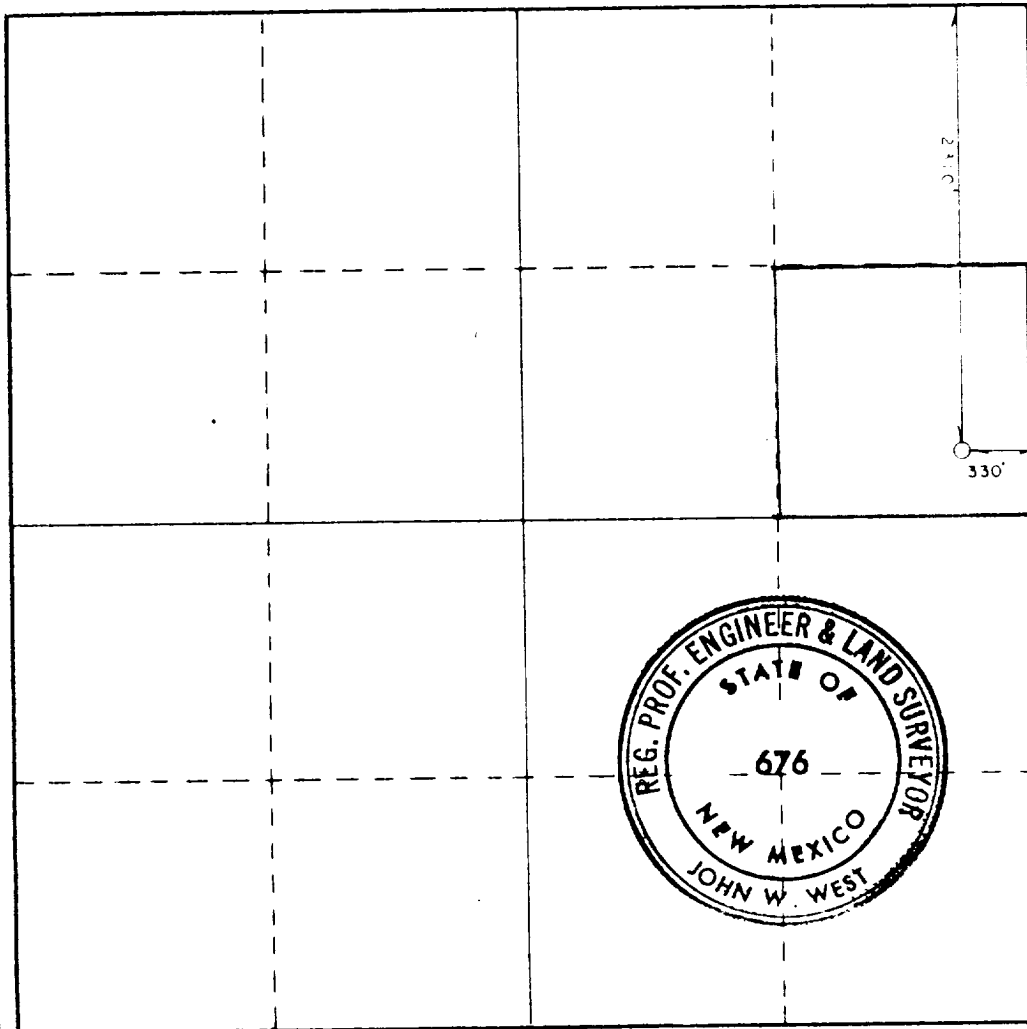

CERTIFICATION

I hereby certify that the information contained herein is true and complete to the best of my knowledge and belief.

*Pat Thompson*  
Name

Pat Thompson  
Position

Production Controller  
Company

STEVENS OPERATING CORPORATION  
Date

November 8, 1983

I hereby certify that the well location shown on this plat was plotted from field notes of actual surveys made by me or under my supervision, and that the same is true and correct to the best of my knowledge and belief.

Date Surveyed

OCTOBER 19, 1983

Registered Professional Engineer and/or Land Surveyor

*John W. West*  
Certificate No. JOHN W. WEST, 676

RONALD J. EIDSON, 3239