

OIL CONSERVATION DIVISION

STATE OF NEW MEXICO
ENERGY AND MINERALS DEPARTMENT

P. O. BOX 2088

SANTA FE, NEW MEXICO 87501

RECEIVED BY

JUL 03 1984

Form C-102
Revised 10-1-79

All distances must be from the outer boundaries of the Section.

Operator Yates Petroleum Corporation		Lease Lightcap "YF"		O. C. D. ARTESIA, OFFICE		Well No. 1
Init Letter A	Section 25	Township 7 South	Range 29 East	County Chaves		
Actual Postage Location of Well: 330 feet from the North line and 330 feet from the East line						
Ground Level Elev. 4113'	Producing Formation San Andres		Pool Wildcat San Andres		Dedicated Acreage: 160 Acres	

1. Outline the acreage dedicated to the subject well by colored pencil or hatchure marks on the plat below.
2. If more than one lease is dedicated to the well, outline each and identify the ownership thereof (both as to working interest and royalty).
3. If more than one lease of different ownership is dedicated to the well, have the interests of all owners been consolidated by communitization, unitization, force-pooling, etc?

☐ Yes ☐ No If answer is "yes," type of consolidation _____

If answer is "no," list the owners and tract descriptions which have actually been consolidated. (Use reverse side of this form if necessary.) _____

No allowable will be assigned to the well until all interests have been consolidated (by communitization, unitization, forced-pooling, or otherwise) or until a non-standard unit, eliminating such interests, has been approved by the Division.

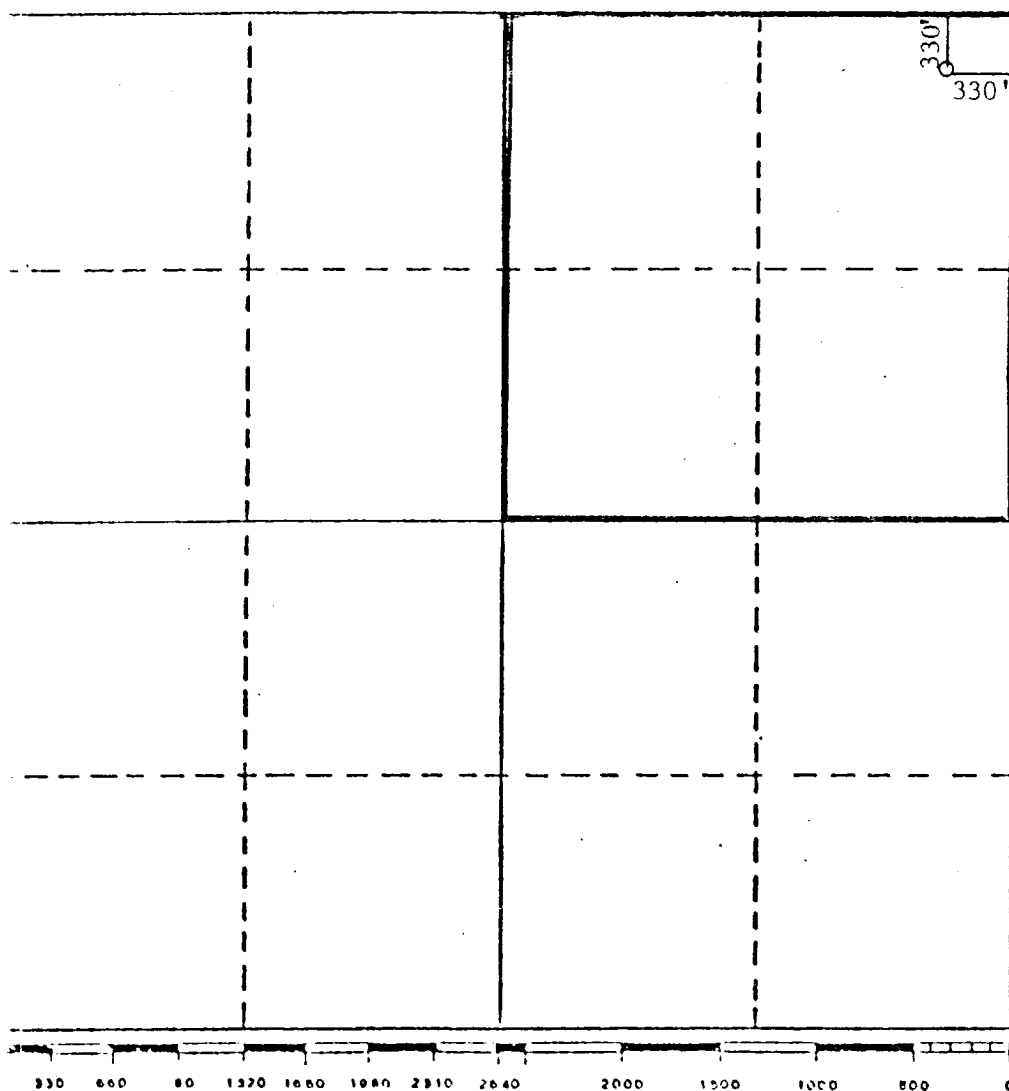

CERTIFICATION

I hereby certify that the information contained herein is true and complete to the best of my knowledge and belief.

Name

Juanita Goodlett

Position

Production Supervisor

Company

Yates Petroleum Corporation

Date

6-29-84

I hereby certify that the well location shown on this plat was plotted from field notes of actual surveys made by me or under my supervision, and that the same is true and correct to the best of my knowledge and belief.

Refer to original plat

Date Surveyed dated 12-10-83

Registered Professional Engineer
and/or Land Surveyor

Certificate No.