

**NEW MEXICO OIL CONSERVATION COMMISSION
WELL LOCATION AND ACREAGE DEDICATION PLAT**

Form C-102
Supersedes C-128
Effective 1-1-65

All distances must be from the outer boundaries of the Section.

Operator GETTY OIL COMPANY			Lease GETTY "PS" FEDERAL		Well No. 1
Unit Letter I-J	Section 8	Township 6 South	Range 26 East	County Chaves	
Actual Footage Location of Well:					
1650 feet from the South line and		1320 feet from the East line			
Ground Level Elev. 3678.6	Producing Formation Abo	Pool <i>Permian Shale</i> Undesignated	Dedicated Acreage: 160 Acres		

1. Outline the acreage dedicated to the subject well by colored pencil or hatchure marks on the plat below.
2. If more than one lease is dedicated to the well, outline each and identify the ownership thereof (both as to working interest and royalty).
3. If more than one lease of different ownership is dedicated to the well, have the interests of all owners been consolidated by communitization, unitization, force-pooling, etc?

☐ Yes ☐ No If answer is "yes," type of consolidation _____

If answer is "no," list the owners and tract descriptions which have actually been consolidated. (Use reverse side of this form if necessary.) _____

No allowable will be assigned to the well until all interests have been consolidated (by communitization, unitization, forced-pooling, or otherwise) or until a non-standard unit, eliminating such interests, has been approved by the Commission.

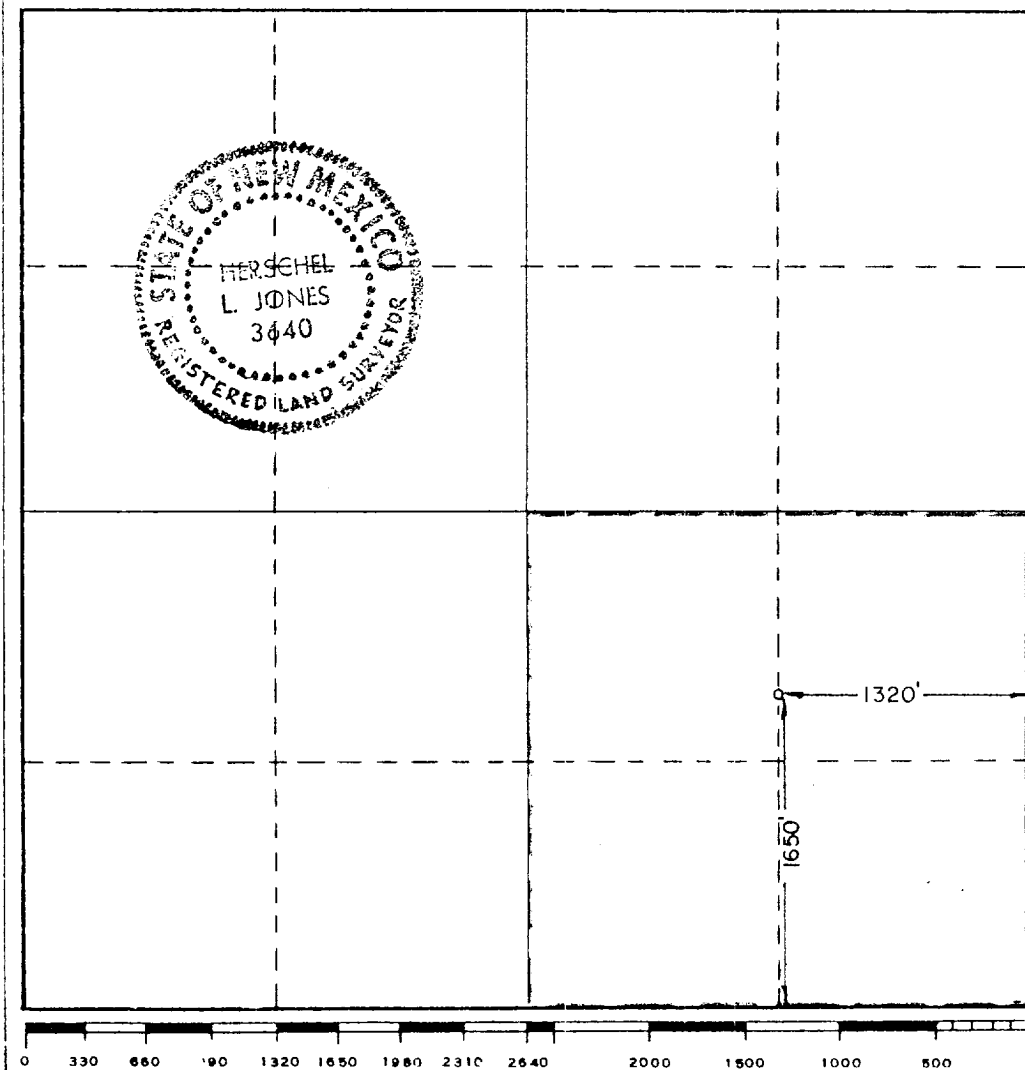

CERTIFICATION

I hereby certify that the information contained herein is true and complete to the best of my knowledge and belief.

Name *Dale R. Crockett*
Dale R. Crockett
 Position
Area Superintendent
 Company
Getty Oil Company
 Date
November 17, 1983

I hereby certify that the well location shown on this plat was plotted from field notes of actual surveys made by me or under my supervision, and that the same is true and correct to the best of my knowledge and belief.

Date Surveyed
10/21/83
 Registered Professional Engineer and/or Land Surveyor
Herschel L. Jones
 Certificate No. **3640**

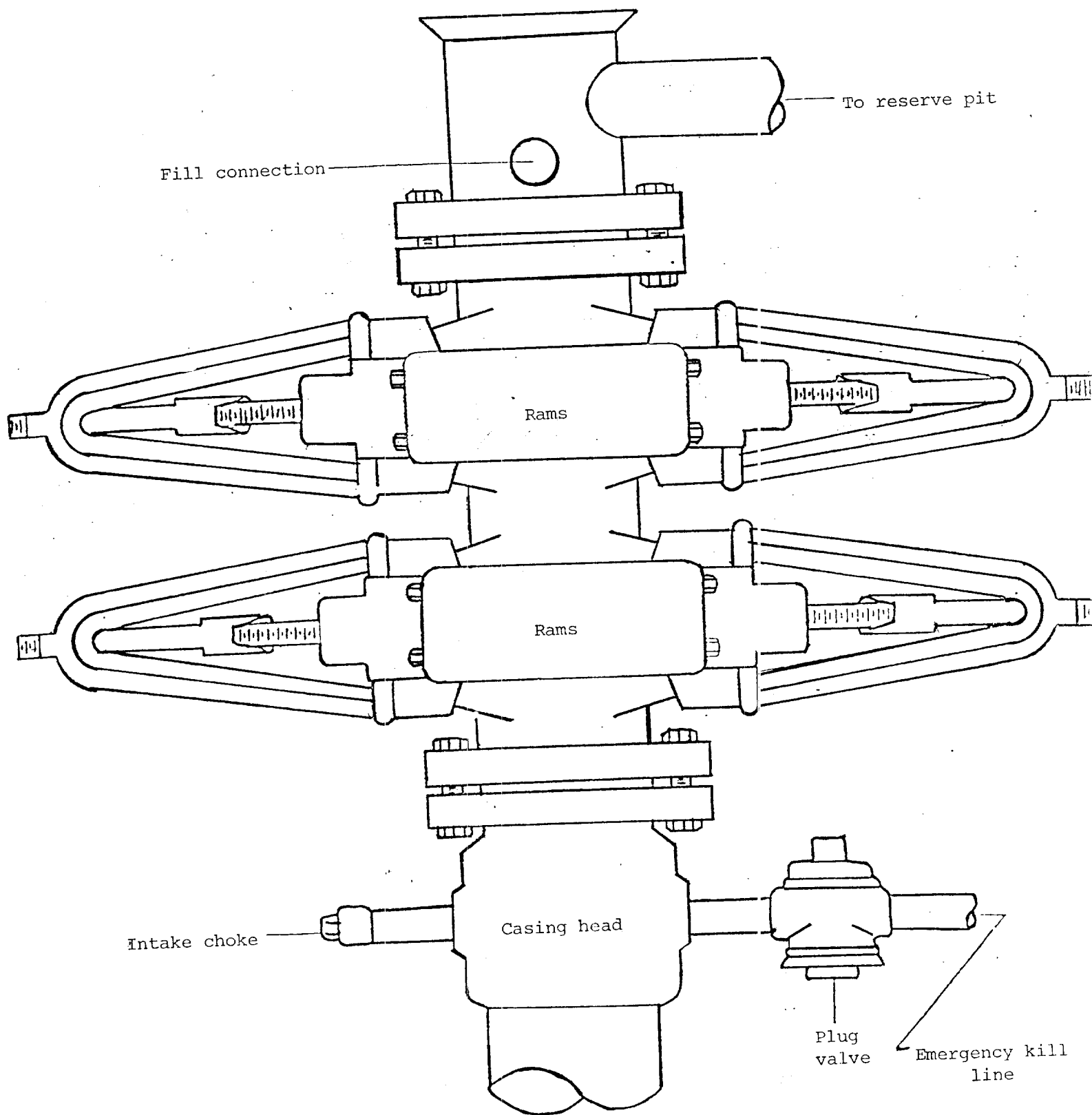

Getty Oil Company
5000 psi working pressure
Drilling control hookup.