

P. O. BOX 2088

SANTA FE, NEW MEXICO 87501

JAN 23 1984

O. C. D.  
ARTESIA, OFFICE

5. Indicate Type of Lease

STATE ☒ FEE ☐

6. State Oil &amp; Gas Lease No.

LC-780

## APPLICATION FOR PERMIT TO DRILL, DEEPEN, OR PLUG BACK

a. Type of Work

DRILL ☒DEEPEN ☐PLUG BACK ☐

b. Type of Well

OIL  
WELL ☐GAS  
WELL ☒

OTHER

SINGLE  
ZONE ☐MULTIPLE  
ZONE ☐

c. Name of Operator

Yates Petroleum Corporation

d. Address of Operator

207 S. 4th, Artesia, New Mexico 88210

e. Location of Well

UNIT LETTER L

LOCATED 1980

FEET FROM THE

South

LINE

AND 660

FEET FROM THE

West

LINE OF SEC. 2

TWP. 9S

RGE. 25E

NMPM

f. County

Chaves

7. Unit Agreement Name

8. Farm or Lease Name

River Bridge "UX" *St.*

9. Well No.

2

10. Field and Pool, or Wildcat

Undg. Pecos Slope Abo

*South*

19. Proposed Depth

4350'

19A. Formation

Abo

20. Rotary or C.T.

Rotary

1. Elevations (show whether DF, KT, etc.)

3531' GL

21A. Kind &amp; Status Plug. Bond

Blanket

21B. Drilling Contractor

not designated

22. Approx. Date Work will start

ASAP

3.

## PROPOSED CASING AND CEMENT PROGRAM

SIZE OF HOLE	SIZE OF CASING	WEIGHT PER FOOT	SETTING DEPTH	SACKS OF CEMENT	EST. TOP
14 3/4"	10 3/4"	40.5# J-55	850'	650 sx	circulated
7 7/8"	4 1/2"	9.5#	TD	350 sx	

We propose to drill and test the Abo and intermediate formations. Approximately 850' of surface casing will be set and cement circulated to shut off gravel and caving. If needed (lost circulation) 8 5/8" intermediate casing will be run to 1500' and cemented with enough cement calculated to tie back into the surface casing. If commercial, production casing will be run and cemented with adequate cover, perforated and stimulated as needed for production.

MUD PROGRAM: FW gel/LCM to 850', KCL & starch to 3500', Brine & KCL water to TD.

BOP PROGRAM: BOP's will be installed at the offset and tested daily.

GAS NOT DEDICATED.

APPROVAL VALID FOR 180 DAYSPERMIT EXPIRES 7-27-84

UNLESS DRILLING UNDERWAY

1. ABOVE SPACE DESCRIBE PROPOSED PROGRAM; IF PROPOSAL IS TO DEEPEN OR PLUG BACK, GIVE DATA ON PRESENT PRODUCTIVE ZONE AND PROPOSED NEW PRODUCTION ZONE. GIVE BLOWOUT PREVENTER PROGRAM, IF ANY.

I hereby certify that the information above is true and complete to the best of my knowledge and belief.

Signed Cy Conner Title Regulatory AgentDate 1/11/84

(This space for State Use)

APPROVED BY

TITLE

OIL AND GAS INSPECTOR

DATE

JAN 27 1984

CONDITIONS OF APPROVAL, IF ANY:

Notify N.M.O.C.C. in sufficient  
time to witness cementing  
the 10 3/4 casing

Post at #2  
JD-1-11/84 Book  
2-3-84

**NEW MEXICO OIL CONSERVATION COMMISSION  
WELL LOCATION AND ACREAGE DEDICATION PLAT**

Form C-102  
Supersedes C-128  
Effective 1-1-65

All distances must be from the outer boundaries of the Section.

Operator <b>YATES PETROLEUM CORPORATION</b>			Lease <b>River Bridge UX State</b>		Well No. <b>2</b>
Unit Letter <b>L</b>	Section <b>2</b>	Township <b>9 South</b>	Range <b>25 East</b>	County <b>Chaves</b>	
Actual Footage Location of Well: <b>1980</b> feet from the <b>South</b> line and <b>660</b> feet from the <b>West</b> line					
Ground Level Elev. <b>3531.</b>	Producing Formation <b>ABO</b>	Pool <b>South Pecos Slope ABO</b>		Dedicated Acreage: <b>160</b> Acres	

1. Outline the acreage dedicated to the subject well by colored pencil or hatchure marks on the plat below.
2. If more than one lease is dedicated to the well, outline each and identify the ownership thereof (both as to working interest and royalty).
3. If more than one lease of different ownership is dedicated to the well, have the interests of all owners been consolidated by communitization, unitization, force-pooling, etc?

☐ Yes ☒ No If answer is "yes," type of consolidation \_\_\_\_\_

If answer is "no," list the owners and tract descriptions which have actually been consolidated. (Use reverse side of this form if necessary.) \_\_\_\_\_

No allowable will be assigned to the well until all interests have been consolidated (by communitization, unitization, forced-pooling, or otherwise) or until a non-standard unit, eliminating such interests, has been approved by the Commission.

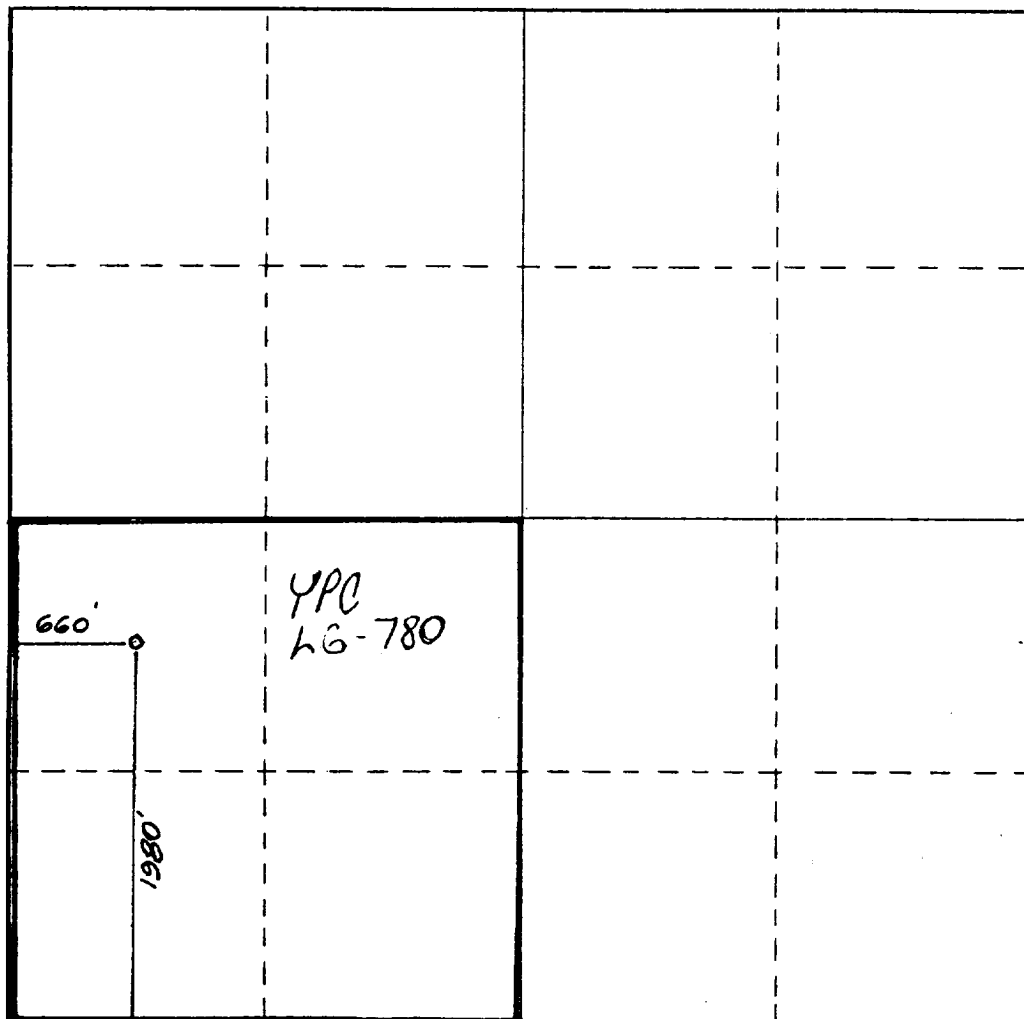

**CERTIFICATION**

I hereby certify that the information contained herein is true and complete to the best of my knowledge and belief.

*Cy Cowan*

Name

**Cy Cowan**

Position

**Regulatory Agent**

Company

**Yates Petroleum Corp**

Date

**1/11/84**

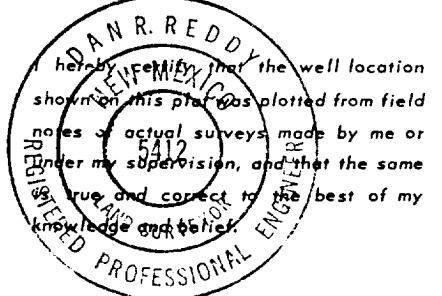

Date Surveyed

**January 11, 1984**

Registered Professional Engineer  
and/or Land Surveyor

*Dan R. Reddy*

Certificate No.

**NM PE&LS #5412**

0 330 660 990 1320 1650 1980 2310 2640 2000 1500 1000 500 0

# EXHIBIT B

## BDP DIAGRAM

RATED 3000<sup>#</sup>

RECEIVED BY

JAN 23 1984

O. C. D.

ARTESIA, OFFICE

