



Texaco USA

NM OIL CONS. COMMISSION

Drawer DD

Artesia, NM 88210

P O Box 728  
Hobbs NM 88240  
505 393 7191



February 3, 1986

Bureau of Land Management  
P. O. Box 1857  
Roswell, New Mexico 88201

RE: REQUEST TO SURFACE COMMINGLE GAS FROM  
TEXACO PRODUCING INC'S.  
CAUDILL FEDERAL COM WELL NO. 1  
SECTION 18, T-6-S, R-26-E  
CHAVES COUNTY, NEW MEXICO

Gentlemen:

Texaco Producing Inc. respectfully requests approval to surface commingle gas production from the referenced well with Texaco Producing Inc's. P.S. 18 Federal Lease. Wells No. 1 and 2 on the P.S. 18 Federal Lease have previously been approved for surface commingling. Wells from both leases yield dry gas from the Pecos Slope Abo Pool and are located in Section 18, T-6-S, R-26-E, Chaves County, New Mexico.

Transwestern Pipeline Company is the gas purchaser for both leases. Pursuant to the Gas Purchase Agreement, Transwestern has installed only one line and sales meter to Section 18, and is located north of P.S. 18 Federal Well No. 2.

The two wellstreams of the P.S. 18 Federal Lease are currently surface commingled at Well No. 2. The Caudill Federal Com. Well No. 1 ties into the sales lateral of the P.S. 18 Federal Com. Lease. Thus, a total of 3 wells are surface commingled prior to entering Transwestern's sales meter. Texaco Producing Inc. has installed meters at each well for production monitoring and allocation purposes. Please refer to the attached figure.

All Working Interest Owners have been notified of this request.

Yours very truly,

*W. B. CADE*

W. B. CADE  
District Operations Manager

LDR:JEB

Attachment

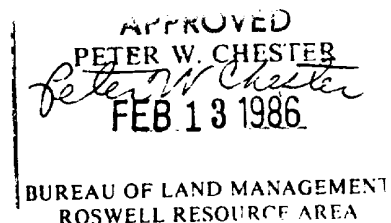

Texaco Producing Inc  
Surface Commingling  
Sec. 18 T6S R26E  
Chaves County, NM

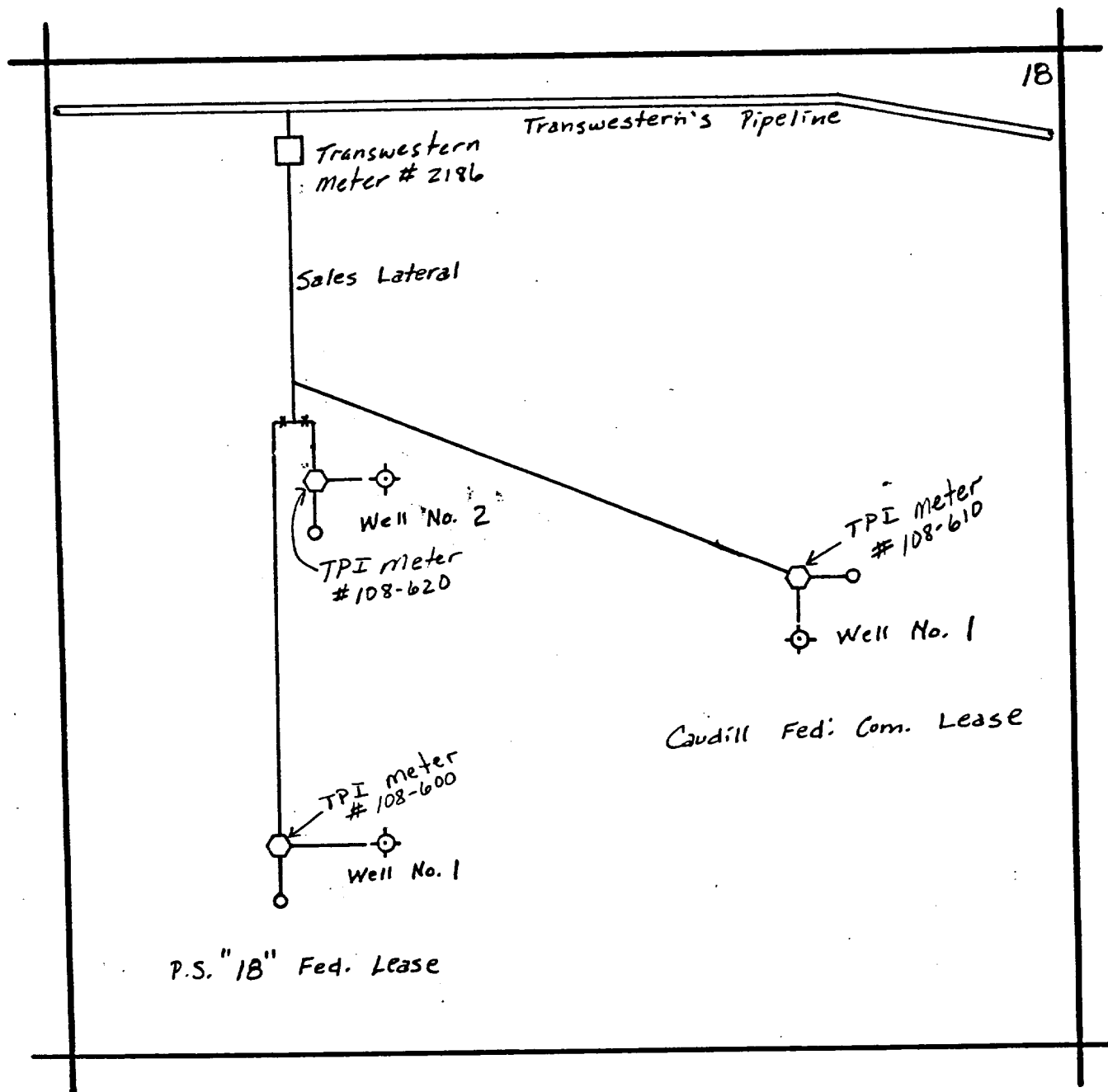

RECEIVED

MAY 28 '85

STATE OF NEW MEXICO  
ENERGY AND MINERALS DEPARTMENTO. C. D.  
ARTESIA, OFFICEForm C-104  
Revised 10-01-78  
Format 06-01-83  
Page 1OIL CONSERVATION DIVISION  
P. O. BOX 2088  
SANTA FE, NEW MEXICO 87501

NO. OF COPIES RECEIVED	
DISTRIBUTION	
SANTA FE	<input checked="" type="checkbox"/>
FILE	<input checked="" type="checkbox"/>
U.S.G.S.	<input type="checkbox"/>
LAND OFFICE	<input type="checkbox"/>
TRANSPORTER	<input type="checkbox"/>
OIL	<input checked="" type="checkbox"/>
GAS	<input checked="" type="checkbox"/>
OPERATOR	<input checked="" type="checkbox"/>
PRODUCTION OFFICE	<input type="checkbox"/>

REQUEST FOR ALLOWABLE  
AND  
AUTHORIZATION TO TRANSPORT OIL AND NATURAL GAS

I. Operator  
TEXACO Producing Inc.

Address  
P.O. Box 728, Hobbs, New Mexico 88240

Reason(s) for filing (Check proper box)

<input type="checkbox"/> New Well	Change in Transporter of:	<input type="checkbox"/> Dry Gas
<input type="checkbox"/> Recompletion	<input type="checkbox"/> Oil	<input type="checkbox"/> Condensate
<input checked="" type="checkbox"/> Change in Ownership	<input type="checkbox"/> Casinghead Gas	

Other (Please explain)  
Change of Operator from Getty to  
TEXACO Producing Inc. 12/31/84

If change of ownership give name  
and address of previous owner \_\_\_\_\_

## II. DESCRIPTION OF WELL AND LEASE

Lease Name Caudill Fed Com	Well No. 1	Pool Name, including Formation Pecos Slope Abo	Kind of Lease State, Federal or Fee	Fee	Leased to
Location Unit Letter <u>I</u> : <u>1980</u> Feet From The <u>South</u> Line and <u>660</u> Feet From The <u>East</u> Line of Section <u>18</u> Township <u>6S</u> Range <u>26E</u> , NMPM, <u>Chaves</u> County					

## III. DESIGNATION OF TRANSPORTER OF OIL AND NATURAL GAS

Name of Authorized Transporter of Oil <input type="checkbox"/> or Condensate <input type="checkbox"/> None	Address (Give address to which approved copy of this form is to be sent)	
Name of Authorized Transporter of Casinghead Gas <input type="checkbox"/> or Dry Gas <input checked="" type="checkbox"/> Transwestern Pipeline Co.	Address (Give address to which approved copy of this form is to be sent) P.O. Box 2521, Houston, TX 77001	
If well produces oil or liquids, give location of tanks.	Unit I	Sec. 18
	Twp. 6S	Rge. 26E
	Is gas actually connected? <u>Yes</u>	
	When <u>12-28-84</u>	

If this production is commingled with that from any other lease or pool, give commingling order number: \_\_\_\_\_

NOTE: Complete Parts IV and V on reverse side if necessary.

## VI. CERTIFICATE OF COMPLIANCE

I hereby certify that the rules and regulations of the Oil Conservation Division have  
been complied with and that the information given is true and complete to the best of  
my knowledge and belief.

W. B. L. L.

(Signature)

District Operations Manager

April 30, 1985

(Title)

(Date)

## OIL CONSERVATION DIVISION

MAY 29 1985

APPROVED \_\_\_\_\_, 19 \_\_\_\_\_

BY \_\_\_\_\_ ORIGINAL SIGNED

BY LARRY BROOKS

TITLE \_\_\_\_\_ GEOLOGIST - NMOCD

This form is to be filed in compliance with RULE 1104.

If this is a request for allowable for a newly drilled or deepen  
well, this form must be accompanied by a tabulation of the deviate  
tests taken on the well in accordance with RULE 111.All sections of this form must be filled out completely for allo  
able on new and recompleted wells.Fill out only Sections I, II, III, and VI for changes of own  
well name or number, or transporter, or other such change of conditioSeparate Forms C-104 must be filed for each pool in multi  
completed wells.

RECEIVED BY

AUG 06 1984

O. C. D.

ARTESIA, OFFICE

0+6-NMOCD-Artesia

1-File

1-Engr BDB

1-Foreman HS

1-JA, 1-BB, 1-CP, 1-SH

1-Mr. J.A.-Midland

1-BK

Getty Oil Company

P.O. Box 730, Hobbs, NM 88240

Assignee(s) for filing (Check proper box)

New Well ☒Recompletion ☐Change in Ownership ☐

Change in Transporter of:

Oil ☐Casinghead Gas ☐Dry Gas ☐Condensate ☐

Other (Please explain)

Well is presently shut-in waiting on pipeline.

If change of ownership give name and address of previous owner

## 1. DESCRIPTION OF WELL AND LEASE

Lease Name Caudill Fed Com	Well No. 1	Pool Name, Including Formation Pecos Slope Abo	Kind of Lease State, Federal or Fee	Fee	Lease No.
Location Unit Letter <u>I</u> : <u>1980</u> Feet From The <u>South</u> Line and <u>660</u> Feet From The <u>East</u> Line of Section <u>18</u> Township <u>6S</u> Range <u>26E</u> , NMPM, <u>Chaves</u> County					

## 2. DESIGNATION OF TRANSPORTER OF OIL AND NATURAL GAS

Name of Authorized Transporter of Oil <input type="checkbox"/> or Condensate <input type="checkbox"/>	Address (Give address to which approved copy of this form is to be sent)	
Name of Authorized Transporter of Casinghead Gas <input type="checkbox"/> or Dry Gas <input checked="" type="checkbox"/>	Address (Give address to which approved copy of this form is to be sent)	
<u>Transwestern Pipeline Co.</u>	<u>2801 N. Main, P.O. Box 11, M. 88201</u>	
If well produces oil or liquids, give location of tanks.	Unit	Sec. Twp. Rge.
		Is gas actually connected? <u>yes</u> when <u>12-28-84</u>

If this production is commingled with that from any other lease or pool, give commingling order number:

## 3. COMPLETION DATA

Designate Type of Completion - (X)	Oil Well	Gas Well	New Well	Workover	Deepen	Plug Back	Same Res'v.	Diff. Res'v.
		X	X					
Date Spudded 7/5/84	Date Compl. Ready to Prod. 7/28/84 Shut in	Total Depth 4200'		P.B.T.D. 4155'				
Elevations (DF, RAB, RT, GR, etc.) 3712.5 GR	Name of Producing Formation Pecos Slope Abo	Top Oil/Gas Pay 3838		Tubing Depth 3796'				
Perforations 3838-4008, Pecos Slope Abo, 22 holes				Depth Casing Shoe				

## TUBING, CASING, AND CEMENTING RECORD

HOLE SIZE	CASING & TUBING SIZE	DEPTH SET	SACKS CEMENT
14 3/4"	10 3/4"	908'	810 SXS
7 7/8"	4 1/2"	4200'	1450 SXS
	2 3/8"	3796'	

## 4. TEST DATA AND REQUEST FOR ALLOWABLE (Test must be after recovery of total volume of load oil and must be equal to or exceed top allowable oil well. Well is shut in Waiting on Pipeline this depth or be for full 24 hours)

Date First New Oil Run To Tanks Shut in	Date of Test 7-31-84	Producing Method (Flow, pump, gas lift, etc.)	
Length of Test	Tubing Pressure	Casing Pressure	Choke Size
Actual Prod. During Test	Oil-Bbls.	Water-Bbls.	Gas-MCF AOF 1189

## GAS WELL

Actual Prod. Test-MCF/D	Length of Test	Bbls. Condensate/MMCF	Gravity of Condensate
Testing Method (pilot, back pr.)	Tubing Pressure (Shut-in)	Casing Pressure (Shut-in)	Choke Size

## CERTIFICATE OF COMPLIANCE

I hereby certify that the rules and regulations of the Oil Conservation Division have been complied with and that the information given above is true and complete to the best of my knowledge and belief.

3

Dale R. Crockett  
(Signature)

Area Superintendent

(Title)

August 2, 1984

(Date)

## OIL CONSERVATION DIVISION

JAN 11 1985

APPROVED \_\_\_\_\_, 19

Original Signed By

BY Mike WilliamsTITLE Oil & Gas Inspector

This form is to be filed in compliance with RULE 1104.

If this is a request for allowable for a newly drilled or deepen well, this form must be accompanied by a tabulation of the deviation logs taken on the well in accordance with RULE 111.

All sections of this form must be filled out completely for all wells on new and recompleted wells.

Fill out only Sections I, II, III, and VI for changes of own well name or number, or transporter, or other such change of condition.

Separate Form C-104 must be filed for each pool in multi-completed wells.

NEW MEXICO OIL CONSERVATION DIVISION

P. O. DRAWER "DD"

ARTESIA, NEW MEXICO 88210

NOTICE OF GAS CONNECTION

DATE 1-02-85

This is to notify the Oil Conservation Division that connection for the purchase of gas from the Getty Oil Co.

Operator

Caudill

Fed Com.  
Lease

#1

I  
Well Unit

18-6S-26E

S.T.R.

Pecos Slope (Abo)

Pool

Transwestern  
Name of Purchaser

was made on

December 28, 1984

Transwestern Pipeline Company  
Company

Rodney C. Burke Rodney C. Burke  
Representative

Title

cc: Operator

New Mexico Oil Conservation Commission  
Oil & Gas Conservation Division  
P. O. Box 2088  
Santa Fe, NM 87501

