

UNITED STATES  
DEPARTMENT OF THE INTERIOR  
GEOLOGICAL SURVEY

APPLICATION FOR PERMIT TO DRILL, DEEPEN, OR PLUG BACK

1a. TYPE OF WORK

DRILL ☒

DEEPEN ☐

PLUG BACK ☐

b. TYPE OF WELL

OIL  
WELL ☐

GAS  
WELL ☒

OTHER

2. NAME OF OPERATOR

MESA PETROLEUM CO. ✓

3. ADDRESS OF OPERATOR

P.O. BOX 2009, AMARILLO, TX 79189

4. LOCATION OF WELL (Report location clearly and in accordance with any State requirements.\*)

At surface

660' FSL & 1980' FWL L<sub>6</sub> SE 1/4 SW 1/4

At proposed prod. zone

660' FSL & 660' FWL

14. DISTANCE IN MILES AND DIRECTION FROM NEAREST TOWN OR POST OFFICE\*

17 miles northeast of Roswell, New Mexico

15. DISTANCE FROM PROPOSED\*

LOCATION TO NEAREST  
PROPERTY OR LEASE LINE, FT.  
(Also to nearest drlg. unit line, if any)

660' / 660'

18. DISTANCE FROM PROPOSED LOCATION\*  
TO NEAREST WELL, DRILLING, COMPLETED,  
OR APPLIED FOR, ON THIS LEASE, FT.

2300'

16. NO. OF ACRES IN LEASE

Com 160

17. NO. OF ACRES ASSIGNED  
TO THIS WELL

160

19. PROPOSED DEPTH

4500'

20. ROTARY OR CABLE TOOLS

Rotary

21. ELEVATIONS (Show whether DF, RT, GR, etc.)

3549' GR

22. APPROX. DATE WORK WILL START\*

February 15, 1983

23.

PROPOSED CASING AND CEMENTING PROGRAM

SIZE OF HOLE	SIZE OF CASING	WEIGHT PER FOOT	SETTING DEPTH	QUANTITY OF CEMENT
14 3/4"	10 3/4"	40.5#	950'	700/300 SURFACE
9 1/2"	7 5/8"	26.4#	1600'	700/300 TIE BACK
6 1/2 or 7 7/8"	4 1/2"	10.5#	4500'	300 COVER ABO

Propose to drill 14 3/4" hole with mud or air to approximately 950' and run 10 3/4" casing. Will cement to surface and test casing with cementing head to 600 psi. Will reduce hole to 9 1/2" and drill on mud or air to approximately 1600' and run 7 5/8" casing if circulation has been lost and cement with sufficient amounts to tie-back to 10 3/4" casing. Will then reduce hole to 6 1/2" or 6 1/4", test BOP's and casing and drill to total depth. If hole conditions are favorable, the 7 5/8" casing will be omitted and the hole will be reduced to 7 7/8" and drilled to total depth. Either 4 1/2" or 5 1/2" casing will be run as production casing depending upon hole size drilled to TD.

Operator's gas sales are dedicated.

XC: ~~XXXXXXXXXX~~ CEN RCDS, ACCTG, OPS (FILE), MIDLAND, ROSWELL, PARTNERS

IN ABOVE SPACE DESCRIBE PROPOSED PROGRAM: If proposal is to deepen or plug back, give data on present productive zone and proposed new productive zone. If proposal is to drill or deepen directionally, give pertinent data on subsurface locations and measured and true vertical depths. Give blowout preventer program, if any.

24.

SIGNED

*R. P. Mathews*

TITLE REGULATORY COORDINATOR

DATE 1-5-83

(This space for Federal or State office use)

PERMIT NO.

*SJ Richard Bastin*

APPROVAL DATE

Associate District Manager

APPROVED BY

CONDITIONS OF APPROVAL, IF ANY:

NEED EXCEPTION FROM RULE 111  
TO DEVIATE HOLE THE OGD

TITLE

JAN 7 1983

MAR 07 1984

APPROVAL SUBJECT TO  
GENERAL REQUIREMENTS AND  
SPECIAL STIPULATIONS

OIL & GAS  
MINERALS MGMT. SERVICE  
ROSWELL, NEW MEXICO

5. LEASE DESIGNATION AND SERIAL NO.

SH:NM-29417, BH:NM-A-38115

6. IF INDIAN, ALLOTTEE OR TRIBE NAME

7. UNIT AGREEMENT NAME

8. FARM OR LEASE NAME

Mike Fed Com

9. WELL NO.

1

10. FIELD AND POOL, OR WILDCAT

Undes. Pecos Slope ABO

11. SEC., T., R., M., OR BLK.  
AND SURVEY OR AREA

SEC 12, T8S, R25E

12. COUNTY OR PARISH

Chaves

13. STATE

New Mexico

All distances must be from the outer boundaries of the Section.

Mesa Petroleum Co.		Lease		Mike Federal Com		Well No.			
N		12		8 South		25 East		Chaves	
Section		Township		Range		County			
660		South		1650		West		Line	
feet from the		line and		feet from the		line			
Ground Level Elev.		Producing Formation		Pool		Dedicated Acreage:			
3544		ABC		PECOS SLOPE ABO		SW 1/4		160 Acres	

1. Outline the acreage dedicated to the subject well by colored pencil or hatchure marks on the plat below.
2. If more than one lease is dedicated to the well, outline each and identify the ownership thereof (both as to working interest and royalty).
3. If more than one lease of different ownership is dedicated to the well, have the interests of all owners been consolidated by communitization, unitization, force-pooling, etc?

☒ Yes ☐ No If answer is "yes" type of consolidation Communitization in progress

If answer is "no," list the owners and tract descriptions which have actually been consolidated. (Use reverse side of this form if necessary.)

No allowable will be assigned to the well until all interests have been consolidated (by communitization, unitization, forced-pooling, or otherwise) or until a non-standard unit, eliminating such interests, has been approved by the Division.

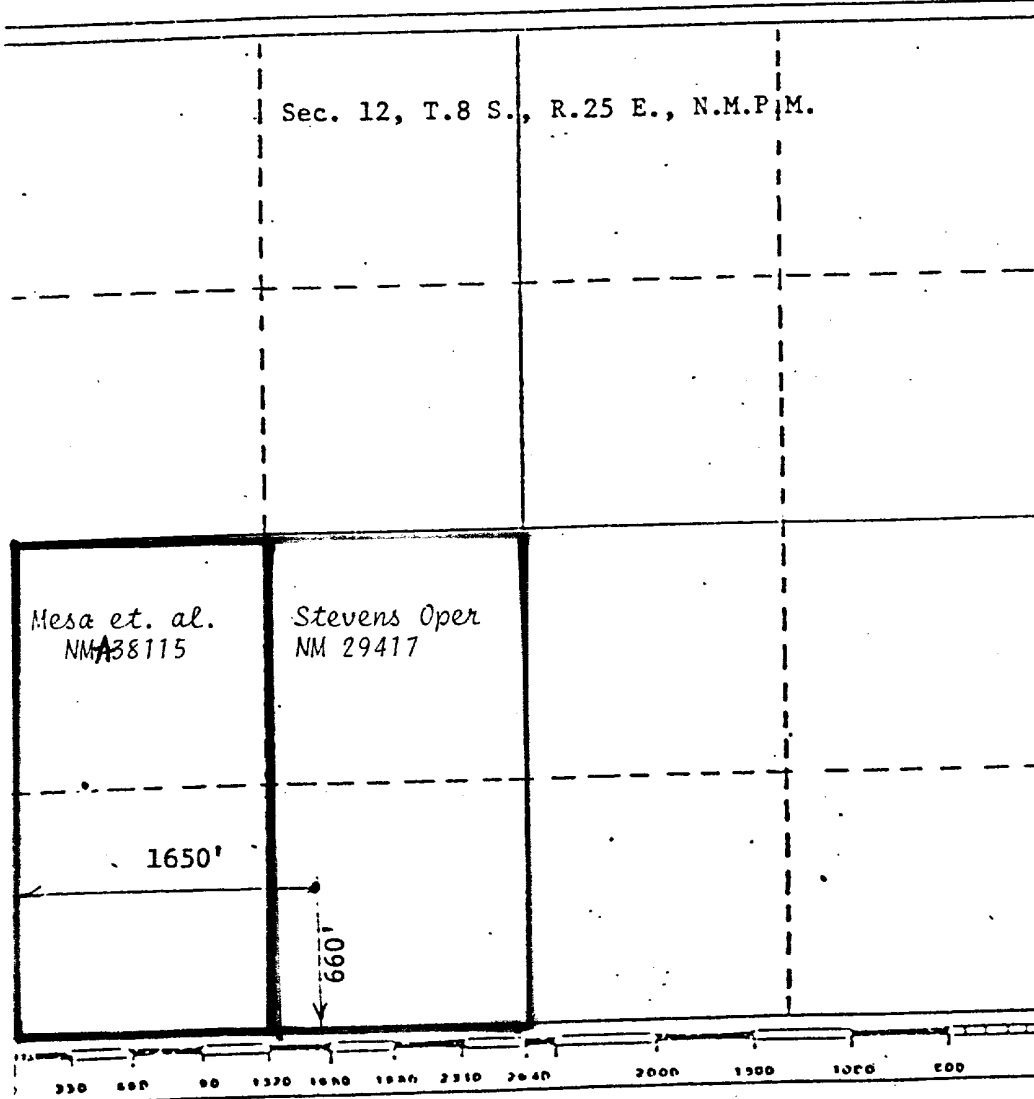

## CERTIFICATION

I hereby certify that the information contained herein is true and complete to the best of my knowledge and belief.

Name

Lloyd Reed

Position

Regulatory Agent

Company

Mesa Petroleum Co.

Date

24 Feb. 84

I hereby certify that the well location shown on this plat was plotted from field notes of actual surveys made by me or under my supervision, and that the same is true and correct to the best of my knowledge and belief.

Date Surveyed

Registered Professional Engineer and/or Land Surveyor

John D. Jaques, P.E. L.S.

Certificate No. 6290

APPLICATION FOR PERMIT TO DRILL

MESA PETROLEUM CO.  
MIKE FED COM #1  
660' FSL & 1980' FWL, SEC 12, T8S, R25E  
CHAVES COUNTY, NEW MEXICO

LEASE NO. NM-29417

In conjunction with Form 9331-C, Application For Permit to Drill subject well, the following additional information is provided:

1. Applicable portions of the GENERAL REQUIREMENTS FOR OIL AND GAS OPERATIONS ON FEDERAL LEASES, Roswell District, Geological Survey of September 1, 1980 will be adhered to.
2. Geological markers are estimated as follows:

Seven Rivers	Surface
San Andres	702'
Glorieta	1740'
Tubb	3040'
Abo	3760'
3. Hydrocarbon bearing strata may occur in the Abo formation(s). No fresh water is expected to be encountered below 950'.
4. The Casing and Blowout Preventer Program will be determined by hole conditions as encountered. See Exhibit VI. Anticipate drilling with fresh water/mud using ram type preventer and rotating head for well control. The 10 3/4" casing will be set at approximately 950' to protect any fresh water zones and cemented to the surface. The 7 5/8" casing will be set at approximately 1600' if water zones have been encountered or omitted if not and ram type preventers installed. Sufficient amounts and kinds of cement would be used to ensure any water, gas, or oil zones encountered are isolated and shut off down to the casing point if run. The 4 1/2" production casing will be set at total depth or shallower depending upon the depth of the deepest commercial hydrocarbon bearing strata encountered.
5. No drill stem test or coring program is planned. The logging program may consist of a GR-CNL from surface total depth and FDC from casing point to total depth.
6. Anticipated drilling time is ten days with completion operations to follow as soon as a completion unit is available.

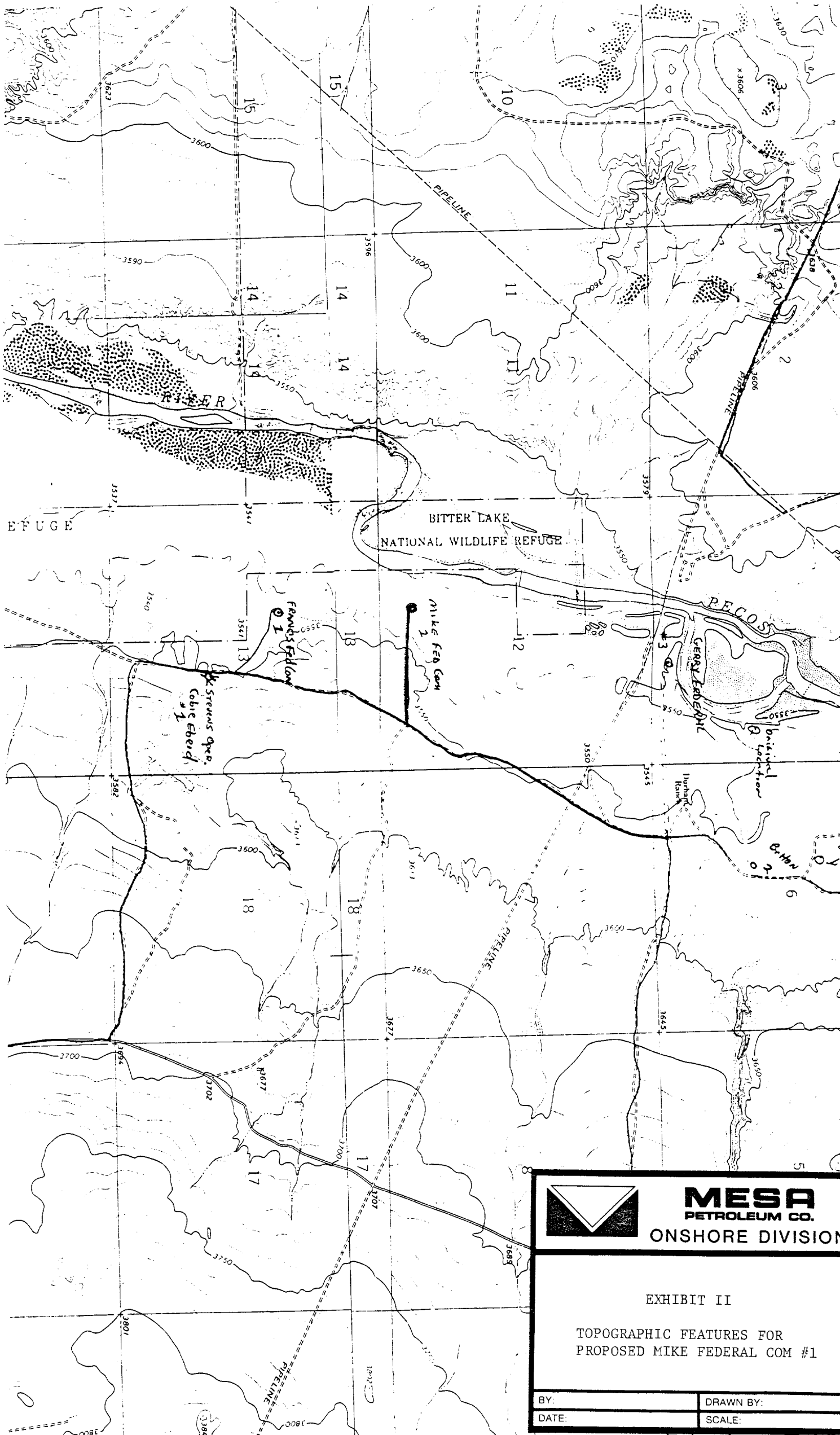

**MESA**  
PETROLEUM CO.  
ONSHORE DIVISION

EXHIBIT II

TOPOGRAPHIC FEATURES FOR  
PROPOSED MIKE FEDERAL COM #1

BY:	DRAWN BY:
DATE:	SCALE:

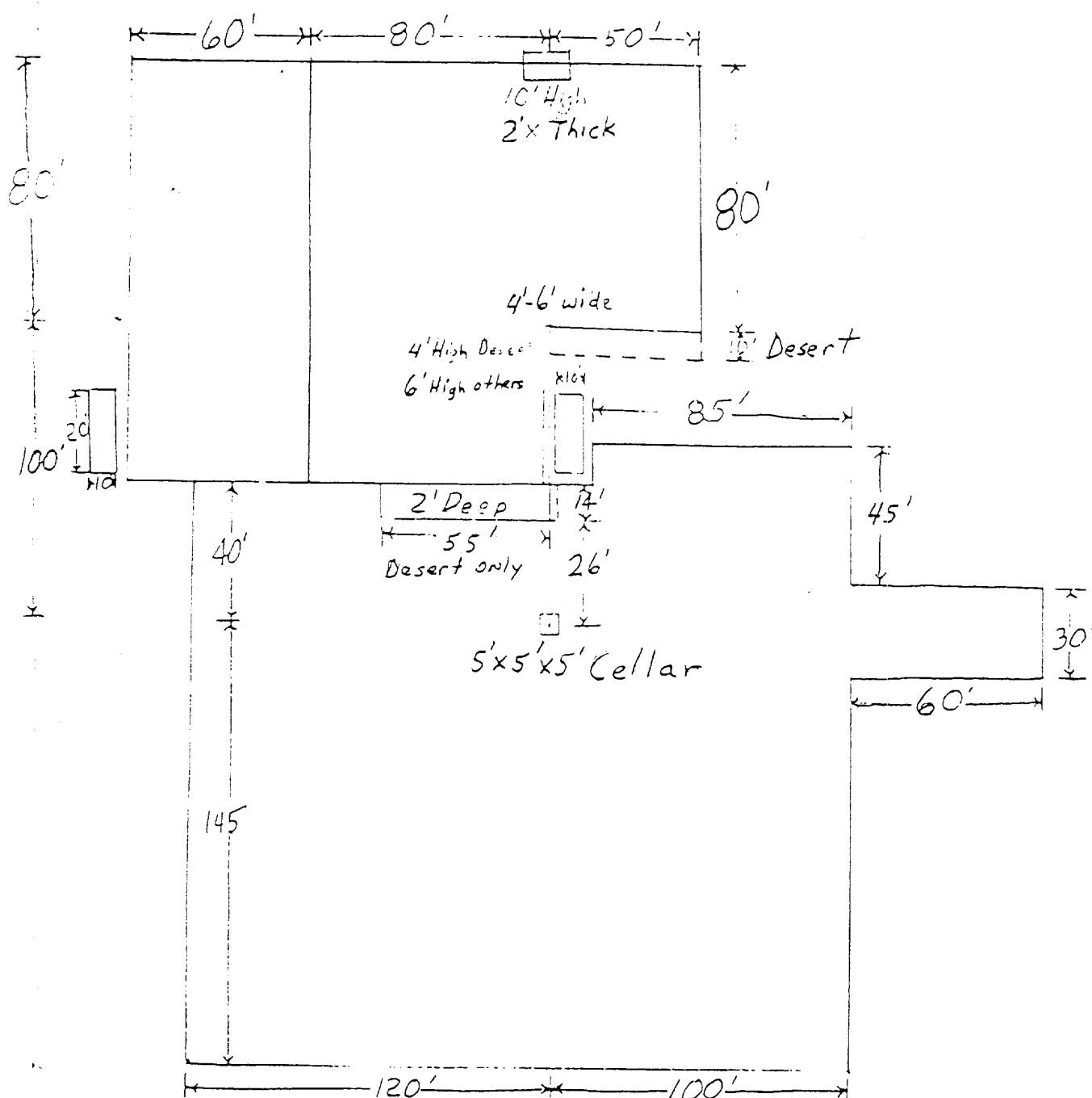

6"-8" Watered & Compacted Caliche  
ON PAD & ROAD IF NEEDED



EXHIBIT V

FOR PROPOSED MIKE FEDERAL COM #1

BY:

DRAWN BY:

DATE:

SCALE:

Blow-out Preventers hydril and choke manifold are all 900 Series

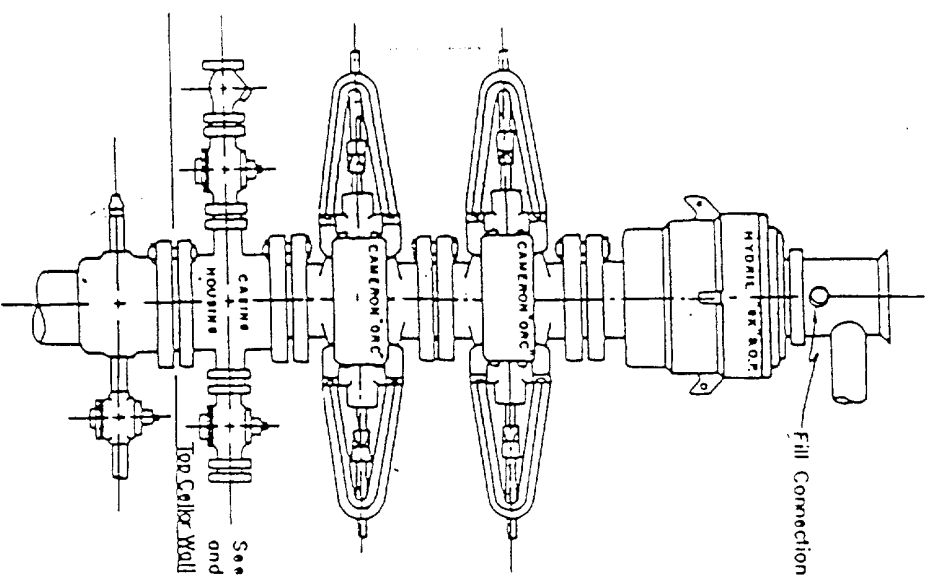

3,000 PSI WORKING PRESSURE  
BLOW-OUT PREVENTER HOOK-UP

See Detail of 4" Flow Line  
and Choke Assembly  
Top Seal/Wall

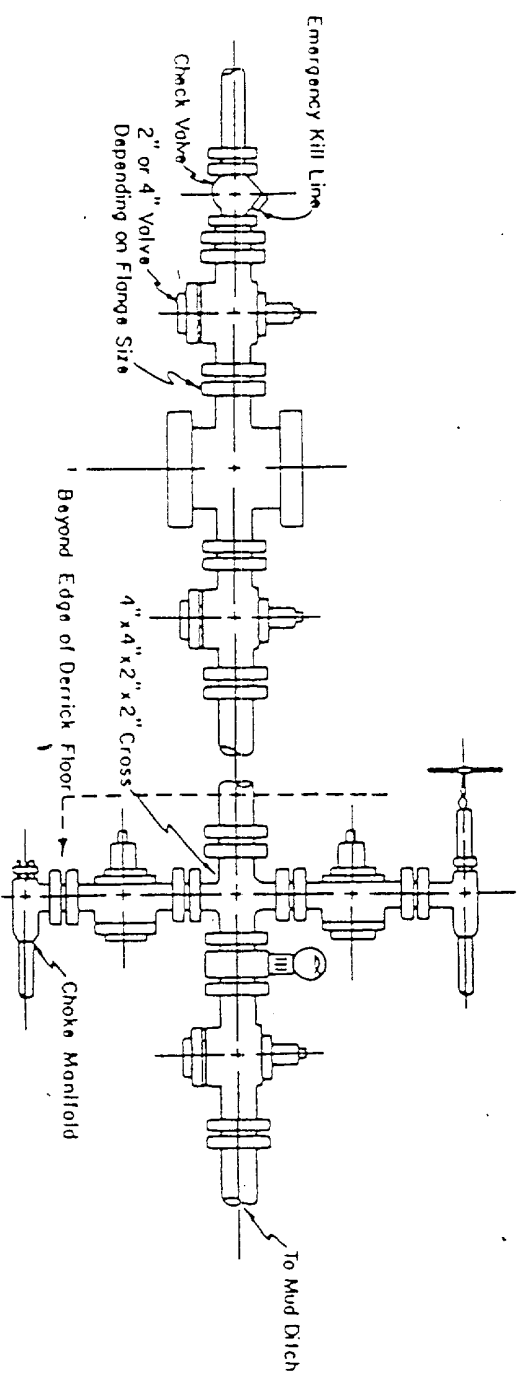

3,000 PSI WORKING PRESSURE  
KILL, CHOKE, AND FILL CONNECTIONS

DETAIL OF 4" FLOW LINE CHOKE ASSEMBLY

Minimum assembly for 3,000 PSI working pressure will consist of three preventers.  
The bottom and middle preventers may be Cameron.

NOTE: HYDRIL not installed on shallow-low pressure wells.  
RAM type BOPs are API 10" X 3000 PSI

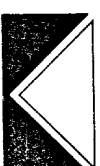

**MESA**  
PETROLEUM CO.  
ONSHORE DIVISION

EXHIBIT VI

BY:	DRAWN BY:
DATE:	SCALE: