

NEW OIL CORP.  
Dr. ...  
Artesia, NM 88210

UNITED STATES  
DEPARTMENT OF THE INTERIOR

GEOLOGICAL SURVEY

APPLICATION FOR PERMIT TO DRILL DEEPEN OR PLUG BACK

1a. TYPE OF WORK

DRILL ☒

DEEPEN ☐

b. TYPE OF WELL

OIL WELL ☐

GAS WELL ☒

OTHER ARTESIA, OFFICE

SINGLE ZONE ☒

MULTIPLE ZONE ☐

2. NAME OF OPERATOR

Getty Oil Company

3. ADDRESS OF OPERATOR

P.O. Box 730, Hobbs, New Mexico 88240

4. LOCATION OF WELL (Report location clearly and in accordance with any State requirements.)\*

At surface Unit Ltr. F, 1980 FNL & 1980 FWL

Section 18, T6S, R26E

At proposed prod. zone

14. DISTANCE IN MILES AND DIRECTION FROM NEAREST TOWN OR POST OFFICE\*

33 miles northeast of Roswell, New Mexico

15. DISTANCE FROM PROPOSED\* LOCATION TO NEAREST PROPERTY OR LEASE LINE, FT. (Also to nearest drlg. unit line, if any)

660'

16. NO. OF ACRES IN LEASE

468.61

17. NO. OF ACRES ASSIGNED TO THIS WELL

160'

18. DISTANCE FROM PROPOSED LOCATION\* TO NEAREST WELL, DRILLING, COMPLETED, OR APPLIED FOR, ON THIS LEASE, FT.

2640'

19. PROPOSED DEPTH

4200'

20. ROTARY OR CABLE TOOLS

Rotary

21. ELEVATIONS (Show whether DF, RT, GR, etc.)

3726.4 GR

23. PROPOSED CASING AND CEMENTING PROGRAM

SIZE OF HOLE	SIZE OF CASING	WEIGHT PER FOOT	SETTING DEPTH
14-3/4"	10-3/4"	40.5#	920'
9-7/8"	7"	20.00#	1650'
7"	4-1/2"	10.5#	4200'

- The subject well will be drilled from surface to 920' with fresh water and gel additives to condition the hole for running casing. From 920' to 1650' (1650' only if lost circulation becomes a problem), native mud and brine of sufficient weight and gel additives will be used to control formation pressures and condition the hole for electric logging.
- The pump and plug method will be used to cement all strings of casing. The 14" and 7" casing will be cemented to the surface. The 7" casing will be cemented approximately 1650' only if lost circulation becomes a problem. The casing will have the top of cement tied into surface/or intermediate casing.
- BOP program attached.

IN ABOVE SPACE DESCRIBE PROPOSED PROGRAM: If proposal is to deepen or plug back, give data on present productive zone and proposed new productive zone. If proposal is to drill or deepen directionally, give pertinent data on subsurface locations and measured and true vertical depths. Give blowout preventer program, if any.

24.

SIGNED

Dale R. Crockett

TITLE

Area Superintendent

(This space for Federal or State office use)

PERMIT NO.

APPROVAL DATE

(Orig. Sgd.) James A. Gillham

Acting District Manager

APPROVED BY

TITLE

CONDITIONS OF APPROVAL, IF ANY:

\*See Instructions On Reverse Side

Form approved.  
Budget Bureau No. 42-R1425.  
30-005-62143

LEASE DESIGNATION AND SERIAL NO.

NM-54991

INDIAN ALLOTTEE OR INDIAN NAME

AGREEMENT NAME

PARTY OR LEASE NAME

WELL NO.

FIELD AND POST OR LOCAT

SEC., T., R., MAP OR BLK.

COUNTY PARISH STATE

APPROX. DATE WORK WILL START\*

APPROVAL SUBJECT TO

GENERAL REQUIREMENTS AND

SPECIAL REGULATIONS

APPROVED

**NEW MEXICO OIL CONSERVATION COMMISSION  
WELL LOCATION AND ACREAGE DEDICATION PLAT**

Form C-102  
Supersedes C-128  
Effective 1-1-65

All distances must be from the outer boundaries of the Section.

Operator <b>GETTY OIL COMPANY</b>			Lease <b>Getty Federal PS 18</b>		Well No. <b>2</b>
Unit Letter <b>F</b>	Section <b>18</b>	Township <b>6 South</b>	Range <b>26 East</b>	County <b>Chaves</b>	
Actual Footage Location of Well: <div style="display: flex; justify-content: space-between;"> <span><b>1980</b> feet from the <b>North</b> line and</span> <span><b>1980</b> feet from the <b>West</b> line</span> </div>					
Ground Level Elev. <b>3726.4</b>	Producing Formation <b>ABO</b>	Pool <b>PECOS SLOPE ABO</b>		Dedicated Acreage: <b>160</b> Acres	

1. Outline the acreage dedicated to the subject well by colored pencil or hatchure marks on the plat below.
2. If more than one lease is dedicated to the well, outline each and identify the ownership thereof (both as to working interest and royalty).
3. If more than one lease of different ownership is dedicated to the well, have the interests of all owners been consolidated by communitization, unitization, force-pooling, etc?

☐ Yes    ☐ No    If answer is "yes," type of consolidation \_\_\_\_\_

If answer is "no," list the owners and tract descriptions which have actually been consolidated. (Use reverse side of this form if necessary.) \_\_\_\_\_

No allowable will be assigned to the well until all interests have been consolidated (by communitization, unitization, forced-pooling, or otherwise) or until a non-standard unit, eliminating such interests, has been approved by the Commission.

**CERTIFICATION**

I hereby certify that the information contained herein is true and complete to the best of my knowledge and belief.

*Dale R. Crockett*

Name

**Dale R. Crockett**

Position

**Area Superintendent**

Company

**Getty Oil Company**

Date

**March 15, 1984**

I hereby certify that the well location shown on this plat was plotted from field notes of actual surveys made by me or under my supervision, and that the same is true and correct to the best of my knowledge and belief.

Date Surveyed

**February 23, 1984**

Registered Professional Engineer  
and/or Land Surveyor

*Herschel L. Jones*

Certificate No.

**3640**

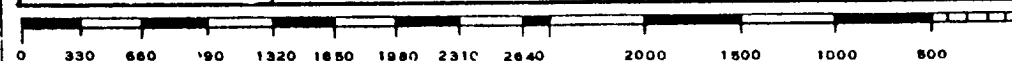
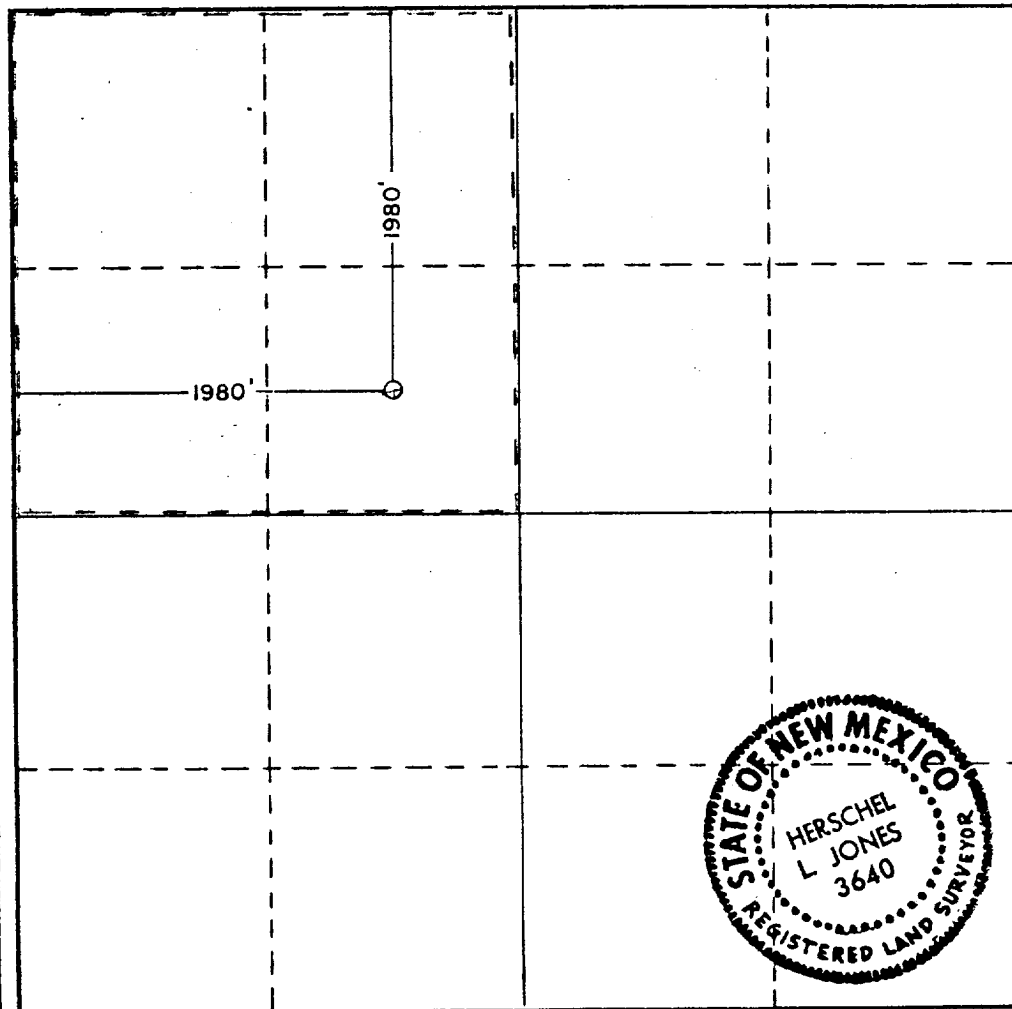
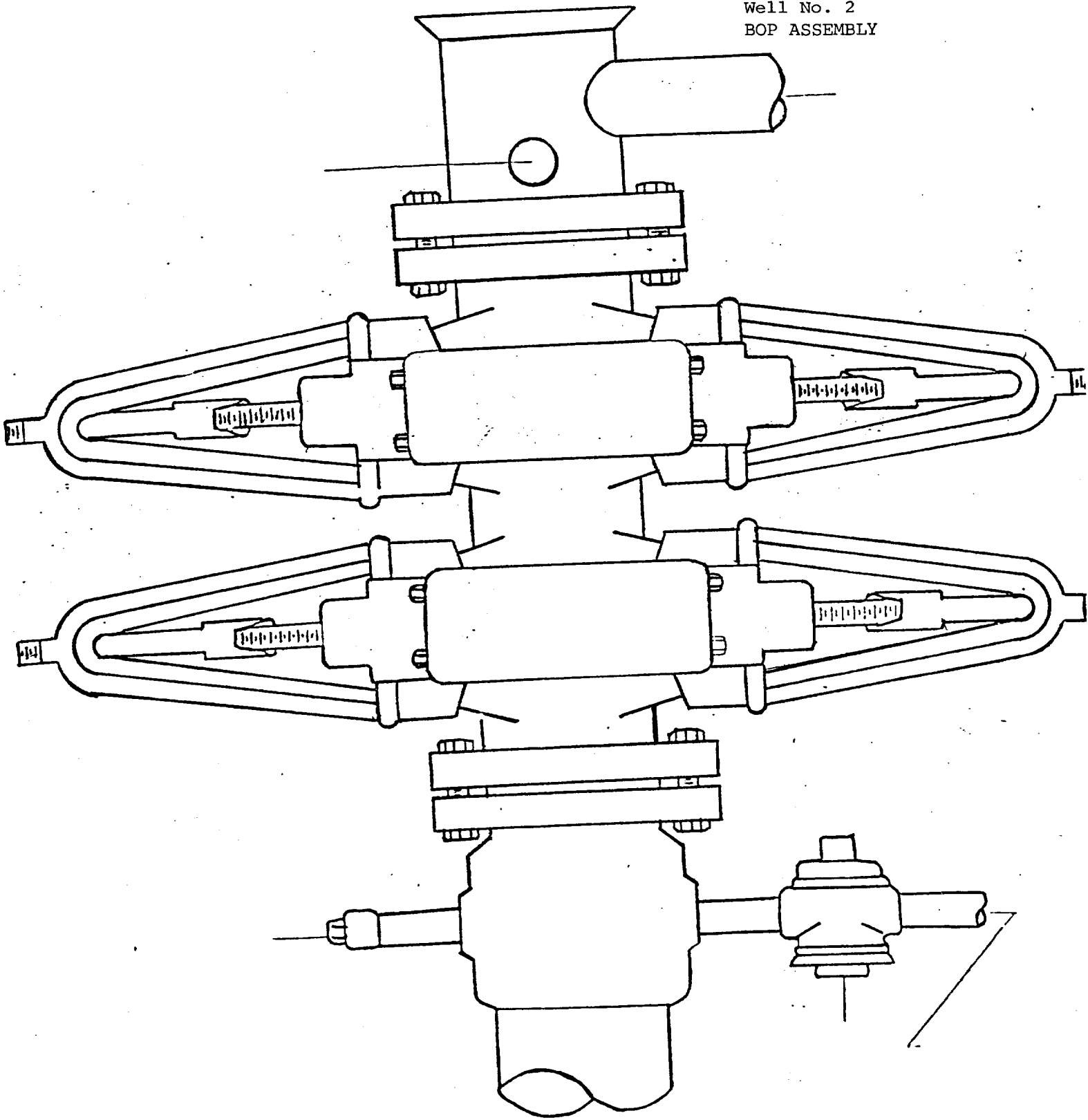

FIGURE 1

Getty Oil Company  
Getty P.S. 18 Federal  
Well No. 2  
BOP ASSEMBLY



ADDITIONAL INFORMATION  
FOR  
"APPLICATION FOR PERMIT TO DRILL"  
GETTY OIL COMPANY  
GETTY P.S. FEDERAL NO. 2

1. The soil encountered in the area can be classified as a member of the camborthids-calciorthids association.
2. The estimated tops of important geologic markers are as follows:

<u>FORMATION</u>	<u>DEPTH FROM SURFACE</u>	<u>DEPTH SUBSEA</u>
San Andres	530'	+ 3196.4
Glorietta	1610'	+ 2116.4
Tubb	3110'	+ 616.4
Abo	3695'	+ 31.4

3. The estimated depths at which anticipated water and oil could be encountered are:

DEPTH

50'	-	530'	Possible fresh water
530'	-	1610'	San Andres - possible oil
3695'	-	4200'	Abo - possible gas

4. The proposed casing program is as follows:

<u>SIZE</u>	<u>GRADE</u>	<u>THREAD</u>	<u>WEIGHT</u>	<u>TOP</u>	<u>BOTTOM</u>	<u>LENGTH</u>
10-3/4"	H-40	8RST&C	40.5	Surface	920'	920'
* 7"	H-40	8RST&C	20	Surface	1600'	1600'
4-1/2"	K-55	8RST&C	10.5	Surface	4200'	4200'

\* Will run only if lost circulation is a problem.

5. The minimum specifications for pressure control equipment to be used - see Figure 1. The BOP stack will be tested to 5000 psi.
6. The drilling fluid from surface to 920' will be fresh water of sufficient gel to condition the hole for running casing. From 920' to 3400', a native mud system will be used with brine and LCM added for stability and seepage. From 3400' to TD, a salt gel system will be used to condition the hole for logging and running casing.
7. The auxiliary equipment to be used is as follows:
  - a. Kelly cocks
  - b. Monitoring equipment on the mud system.
  - c. Sub on the floor with a full opening valve to be stabbed into drill pipe when the Kelly is not in the string.

**EXHIBIT "C"**

Getty Oil Comapny  
Getty P.S. 18 Federal  
Well No. 2

1980 FNL & 1980 FWL  
Section 18, T6S, R26E

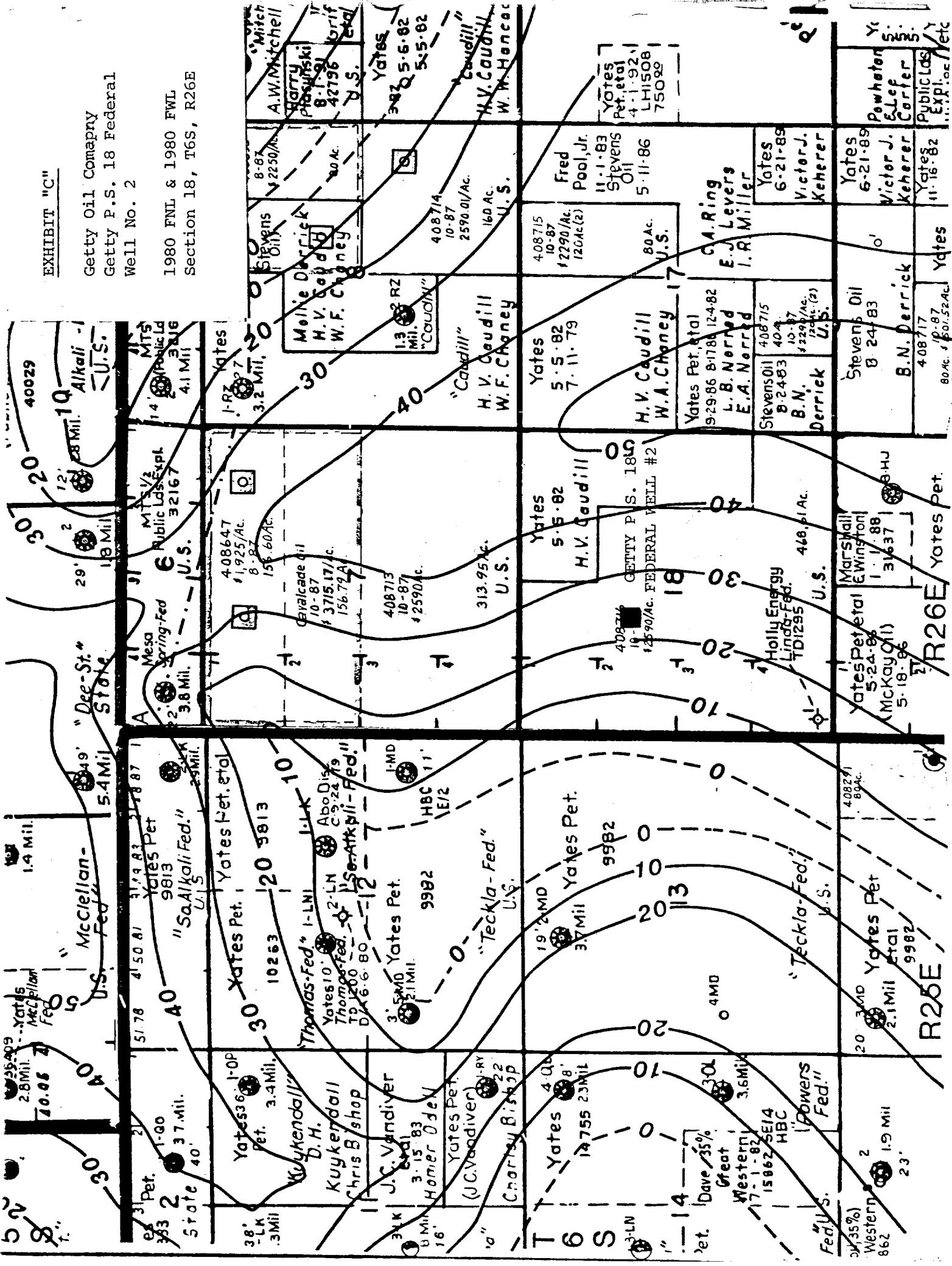

EXHIBIT "D"

Getty Oil Company  
Getty P.S. 18 Federal  
Well No. 2

Drilling Location Layout  
Schematic

