

RECEIVED BY

Drawer DD

Artesia, NM 88210 SUBMIT IN 7 LIGATE*
(Other instructions on reverse side)Form approved.
Budget Bureau No. 42-R1425.

MAY 15 1984 UNITED STATES

DEPARTMENT OF THE INTERIOR

O. C. GEOLOGICAL SURVEY

APPLICATION FOR PERMIT TO DRILL, DEEPEN, OR PLUG BACK

1a. TYPE OF WORK

DRILL ☒DEEPEN ☒ O. C. D.PLUG BACK ☐

b. TYPE OF WELL

OIL WELL ☐GAS WELL ☒OTHER ☐SINGLE ZONE ☒MULTIPLE ZONE ☐

2. NAME OF OPERATOR

McClellan Oil Corporation

3. ADDRESS OF OPERATOR

P.O. Drawer 730, Roswell, New Mexico

4. LOCATION OF WELL (Report location clearly and in accordance with any State requirements.)*

At surface

At proposed prod. zone 1650' FSL & 1980' FWL

14. DISTANCE IN MILES AND DIRECTION FROM NEAREST TOWN OR POST OFFICE*

10 miles Northeast of Roswell, NM

15. DISTANCE FROM PROPOSED*

LOCATION TO NEAREST
PROPERTY OR LEASE LINE, FT.
(Also to nearest drlg. unit line, if any)

1650'

16. NO. OF ACRES IN LEASE

1400'

18. DISTANCE FROM PROPOSED LOCATION*

TO NEAREST WELL, DRILLING, COMPLETED,
OR APPLIED FOR, ON THIS LEASE, FT.

3113'

19. PROPOSED DEPTH

4500'

17. NO. OF ACRES ASSIGNED
TO THIS WELL

160

20. ROTARY OR CABLE TOOLS

Rotary

21. ELEVATIONS (Show whether DF, RT, GR, etc.)

3664' G.L.

22. APPROX. DATE WORK WILL START*

5-15-84

23.

PROPOSED CASING AND CEMENTING PROGRAM

SIZE OF HOLE	SIZE OF CASING	WEIGHT PER FOOT	SETTING DEPTH	QUANTITY OF CEMENT
12-1/8"	8-5/8"	23#	500' 950' Fwd	450 sx Circulate
7-7/8"	4-1/2"	10.5#	4500'	350 sx

Proposed to drill to approximately 4500' to test the Abo formation.

If production is indicated, will set casing and attempt completion.

Estimated Geological Tops: San Andres 640'
Glorieta 1710'
Tubb 3220'
Abo 3970'

Mud Program. Will drill to top of Abo with native mud. Mud up with salt gel.,
40 Viscosity, 20cc water loss and 9.8#/gal. mud (gas indicated).

Gas Dedicated

IN ABOVE SPACE DESCRIBE PROPOSED PROGRAM: If proposal is to deepen or plug back, give data on present productive zone and proposed new productive zone. If proposal is to drill or deepen directionally, give pertinent data on subsurface locations and measured and true vertical depths. Give blowout preventer program, if any.

24.

SIGNED

Mark McClellan

TITLE

Geologist

DATE

4/26/84

(This space for Federal or State office use)

PERMIT NO.

APPROVAL DATE

APPROVED BY

S/Phil Kirk

TITLE

Area Manager

DATE

5-11-84

CONDITIONS OF APPROVAL, IF ANY:

*See Instructions On Reverse Side

All distances must be from the outer boundaries of the Section.

Operator McClellan Oil Corp.		Lease Leeman Federal		Well No. #3
Unit Letter K	Section 12	Township 9 South	Range 25 East	County Chaves
Actual Wellbore Location of Wells				
1980 feet from the West line and		1650 feet from the South line		
Ground Level Elev. 3664	Producing Formation Abo	Pool Pecos Slope Abo	Dedicated Acreage 160 Acres	

1. Outline the acreage dedicated to the subject well by colored pencil or hatchure marks on the plat below.
2. If more than one lease is dedicated to the well, outline each and identify the ownership thereof (both as to working interest and royalty).
3. If more than one lease of different ownership is dedicated to the well, have the interests of all owners been consolidated by communitization, unitization, force-pooling, etc?

☐ Yes ☐ No If answer is "yes;" type of consolidation _____

If answer is "no;" list the owners and tract descriptions which have actually been consolidated. (Use reverse side of this form if necessary.) _____

No allowable will be assigned to the well until all interests have been consolidated (by communitization, unitization, forced-pooling, or otherwise) or until a non-standard unit, eliminating such interests, has been approved by the Division

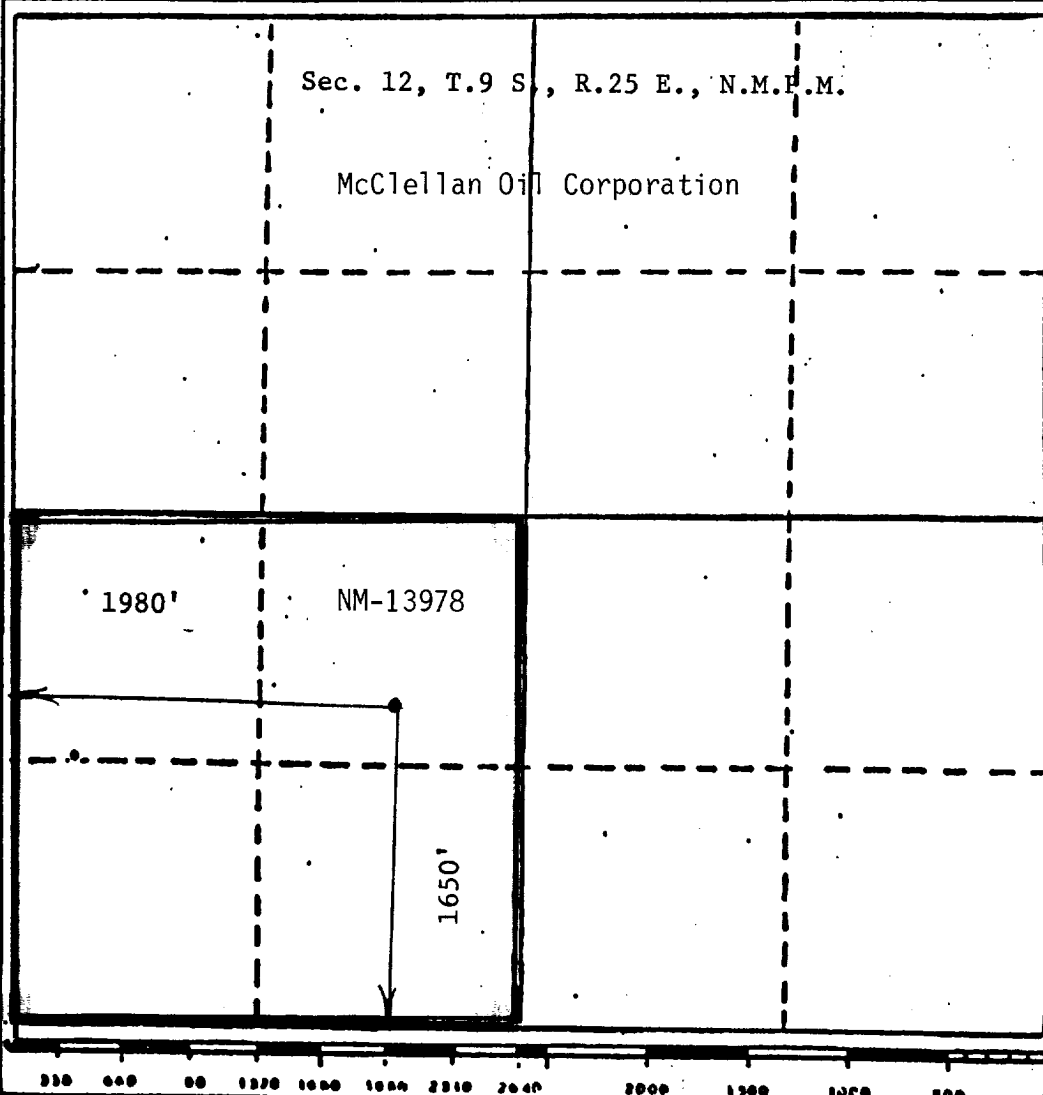

CERTIFICATION

I hereby certify that the information contained herein is true and complete to the best of my knowledge and belief.

Mark McClellan

Name
Mark McClellan

Position
Geologist

Company
McClellan Oil Corp.

Date
4/23/84

I hereby certify that the well location shown on this plat was plotted from field notes of actual surveys made by me or under my supervision, and that the same is true and correct to the best of my knowledge and belief.

Date Surveyed
APR 24 1984

Registered Professional Geologist and/or Land Surveyor

JOHN D. JACQUES
Certification No. 6290
P.E. & L.S.

BLOWOUT PREVENTER SPECIFICATION

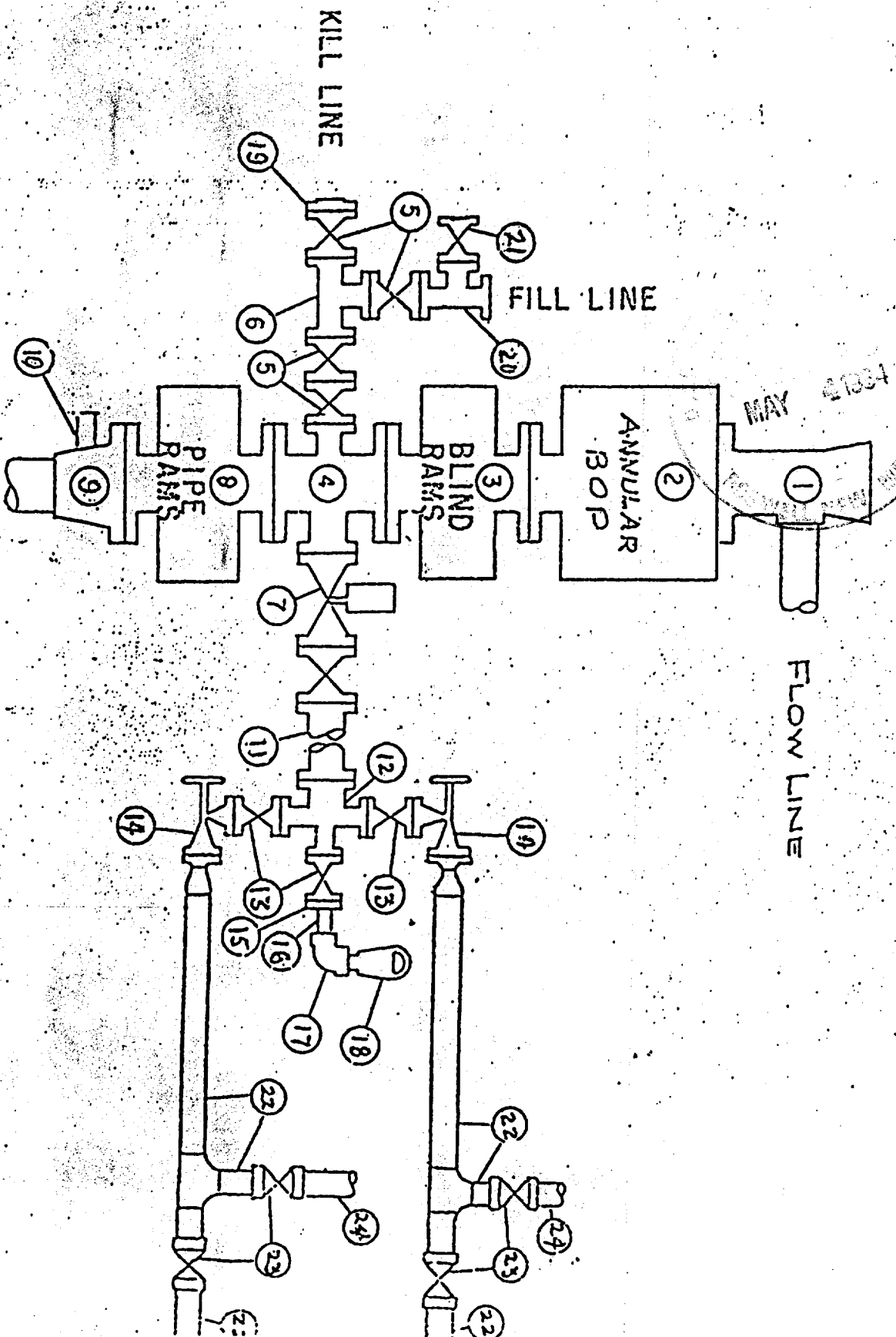

McCLELLAN OIL CORPORATION
SUGGESTED PAD DIMENSIONS

Reserve Pits 4 ft. deep, plastic lined

Working pits 5 ft. deep

No cellar

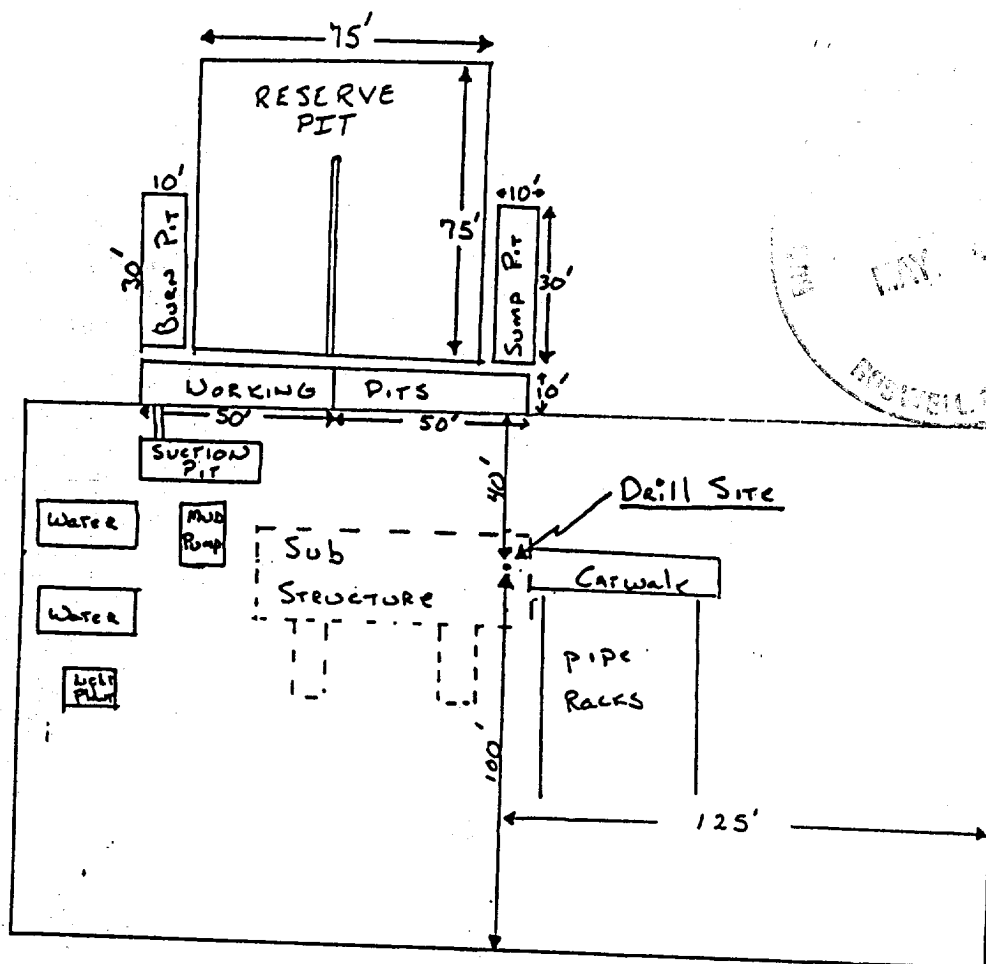

Scale 1" = 50'