

All distances must be from the outer boundaries of the Section.

Operator McKay Oil Corp.		Lease McKay Harvey Federal		Well No. #4
Unit Letter D	Section 21	Township 9 South	Range 25 East	County Chaves
Actual Wellbore Location of Well:				
860 feet from the North line and		860 feet from the West line		
Ground Level Elev. 3570	Producing Formation Abo	Paul S. Pecos <i>Paul S. Pecos</i> undesignated		Dedicated Acreage 160 Acres

1. Outline the acreage dedicated to the subject well by colored pencil or hatchure marks on the plat below.
2. If more than one lease is dedicated to the well, outline each and identify the ownership thereof (both as to working interest and royalty).
3. If more than one lease of different ownership is dedicated to the well, have the interests of all owners been consolidated by communitization, unitization, force-pooling, etc?

☐ Yes ☐ No If answer is "yes," type of consolidation _____

If answer is "no," list the owners and tract descriptions which have actually been consolidated. (Use reverse side of this form if necessary.) _____

No allowable will be assigned to the well until all interests have been consolidated (by communitization, unitization, forced-pooling, or otherwise) or until a non-standard unit, eliminating such interests, has been approved by the Division.

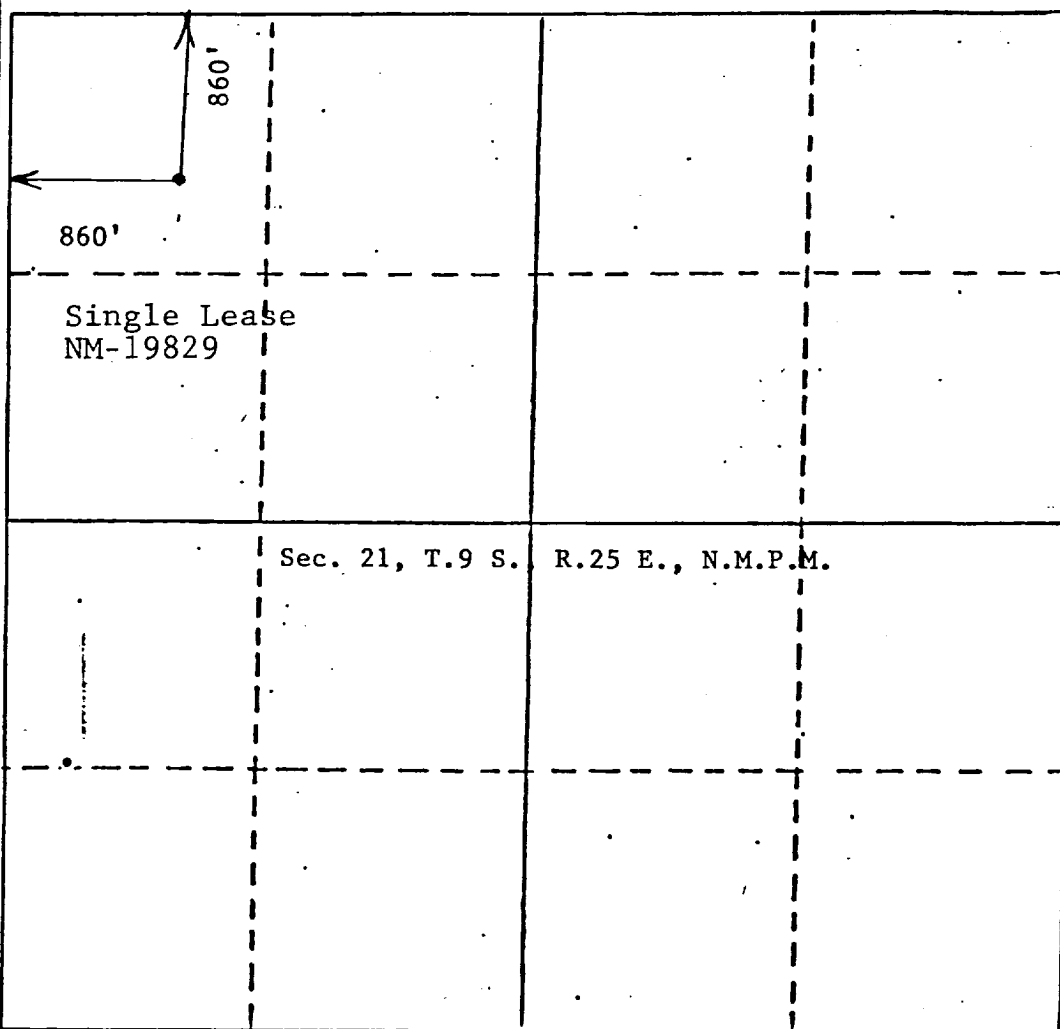

CERTIFICATION

I hereby certify that the information contained herein is true and complete to the best of my knowledge and belief.

James L. Schultz
Name

James L. Schultz
Position

Landman
Company

McKay Oil Corporation
Date

7-5-84

I hereby certify that the well location shown on this plat was plotted from field notes of actual surveys made by me or under my supervision, and that the same is true and correct to the best of my knowledge and belief.

Date Surveyed

June 25, 1984

Registered Professional Engineer and/or Land Surveyor

6290

JOHN D. JACOBSON, P.E. & L.S.

Certificate No. 6290