

All distances must be from the outer boundaries of the Section.

| | | | | |
|---|----------------------------------|--------------------------------|--------------------------------|------------------|
| Operator Elk Oil Corp. | | Lease S.E.State | | Well No. #2 |
| Unit Letter I | Section 23 | Township 9 South | Range 26 East | County Chaves |
| Actual Wellbore Location of Well 990 feet from the East line and 1980 feet from the South line | | | | |
| Ground Level Elev. 3794 | Producing Formation Fusselman | Pool Foor Ranch Pre-Permian | Dedicated Acreage 320 Acres | |

1. Outline the acreage dedicated to the subject well by colored pencil or hatchure marks on the plat below.
2. If more than one lease is dedicated to the well, outline each and identify the ownership thereof (both as to working interest and royalty).
3. If more than one lease of different ownership is dedicated to the well, have the interests of all owners been consolidated by communitization, unitization, force-pooling, etc?

☐ Yes ☐ No If answer is "yes;" type of consolidation _____

If answer is "no;" list the owners and tract descriptions which have actually been consolidated. (Use reverse side of this form if necessary.) _____

No allowable will be assigned to the well until all interests have been consolidated (by communitization, unitization, forced-pooling, or otherwise) or until a non-standard unit, eliminating such interests, has been approved by the Division

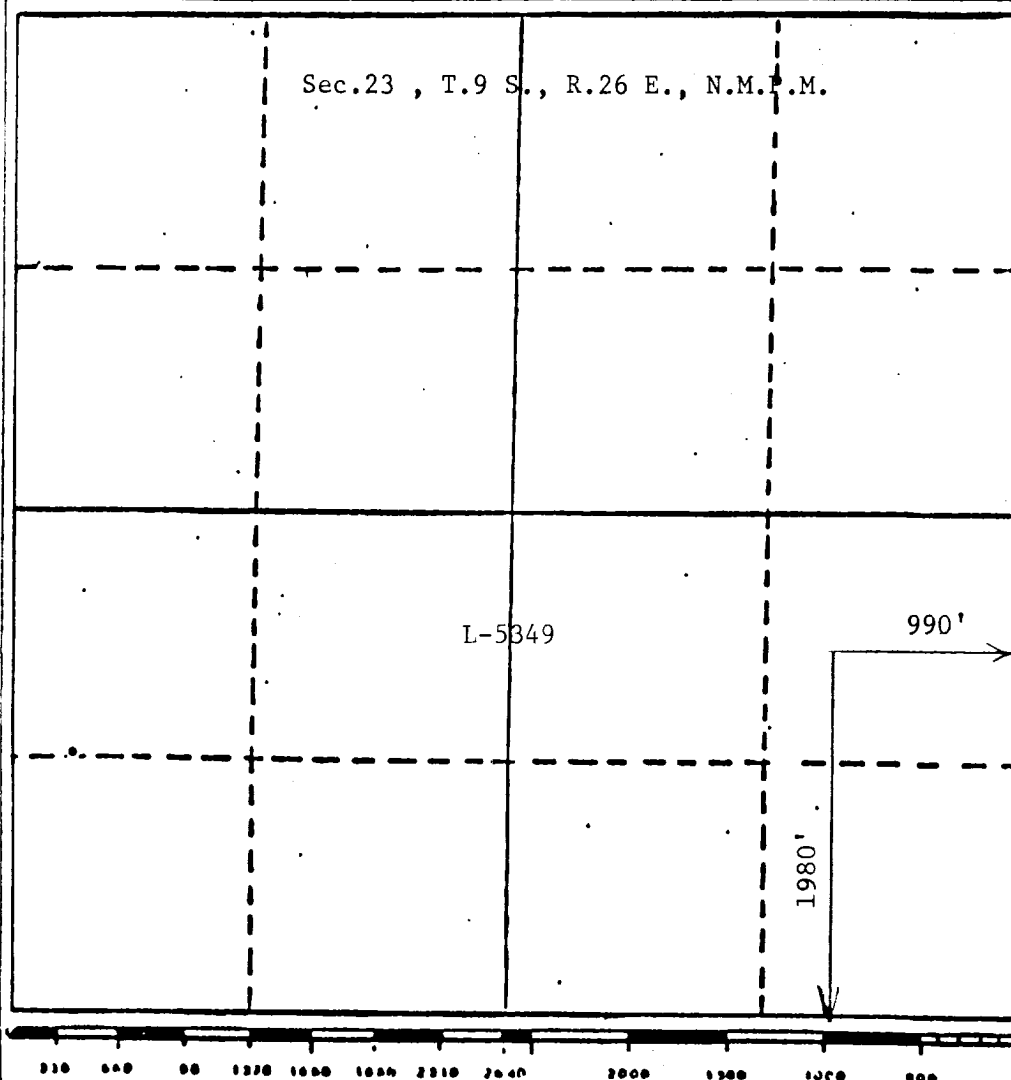

CERTIFICATION

I hereby certify that the information contained herein is true and complete to the best of my knowledge and belief.

Joseph J. Kelly
Name

Joseph J. Kelly

Position

President

Company

ELK OIL COMPANY

Date

August 10, 1984

I hereby certify that the well location shown on this plat was plotted from field notes of actual surveys made by me or under my supervision, and that the same is true and correct to the best of my knowledge and belief.

Date Surveyed

August 10, 1984

Registered Professional Engineer and/or Land Surveyor

John D. Jaques
John D. Jaques, P.E. & L.S.

Certification No.

6290 PROFESSIONAL ENGINEER