

NO. OF COPIES RECEIVED	
DISTRIBUTION	
SANTA FE	<input checked="" type="checkbox"/>
FILE	<input checked="" type="checkbox"/>
U.S.G.S.	<input checked="" type="checkbox"/>
LAND OFFICE	<input checked="" type="checkbox"/>
OPERATOR	<input checked="" type="checkbox"/>

Form C-105
Revised 11-1-84

NEW MEXICO OIL CONSERVATION COMMISSION
WELL COMPLETION OR RECOMPLETION REPORT AND LOG

RECEIVED BY
FEB 8 1985
O. C. D.
ARTESIA, OFFICE

5a. Indicate Type of Lease
State ☒ Fee ☐
5. State Oil & Gas Lease No.
LG 5230

1a. TYPE OF WELL
OIL WELL ☐ GAS WELL ☒ DRY ☐ OTHER ☐
b. TYPE OF COMPLETION
NEW WELL ☐ WORK OVER ☐ DEEPEN ☐ PLUG BACK ☐ DIFF. REVR. ☐ OTHER ☐

7. Unit Agreement Name
8. Form or Lease Name
South Dallas

2. Name of Operator
Harper Oil Company
3. Address of Operator
904 Hightower Bldg., Oklahoma City, OK 73102

9. Well No.
1
10. Field and Pool, or Wildcat
Wildcat-Penn

4. Location of Well
UNIT LETTER F LOCATED 1980 FEET FROM THE North LINE AND 1980 FEET FROM
THE West LINE OF SEC. 2 TWP. 10S RGE. 26E N.M.P.M.

12. County
Chaves

15. Date Spudded
9-13-84
16. Date T.D. Reached
10-3-84
17. Date Compl. (Ready to Prod.)
1-16-85
18. Elevations (DF, RKB, RT, GR, etc.)
GR 3843.3'
19. Elev. Casinghead
KB 3855.3'

20. Total Depth
6560'
21. Plug Back T.D.
NA
22. If Multiple Compl., How Many
NA
23. Intervals Drilled By
Rotary Tools
0-6560'
Cable Tools
--

25. Was Directional Survey Made
Yes

24. Producing Interval(s), of this completion - Top, Bottom, Name
6106'-6123'; 6131'-6136' Pennsylvanian
26. Type Electric and Other Logs Run
Dual Laterlog Micro Laterlog Gamma Ray & Compensated Neutron Gamma ray
27. Was Well Cored
No

28. CASING RECORD (Report all strings set in well)

CASING SIZE	WEIGHT LB./FT.	DEPTH SET	HOLE SIZE	CEMENTING RECORD	AMOUNT PULLED
13 3/8"	68#	361'	17 1/2"	776 sks	None
8 5/8"	24#	1206'	11"	825 sks	None
5 1/2"	15.5#	6560'	7 7/8"	1250 sks	None

SIZE	TOP	BOTTOM	SACKS CEMENT	SCREEN	SIZE	DEPTH SET	PACKER SET
None					2 3/8"	6029.65'	6029.65'

29. LINER RECORD
30. TUBING RECORD

31. Perforation Record (Interval, size and number)
6106'-6123' 4 JSPF, 88 holes
6131'-6136'

32. ACID, SHOT, FRACTURE, CEMENT SQUEEZE, ETC.
DEPTH INTERVAL
6106'-6123'-6131'-6136' Pumped 1000 gals. 7 1/2% MSR100
Start Strata Frac II pad & 20/40 sand.

33. PRODUCTION
Date First Production
10-20-84
Production Method (Flowing, gas lift, pumping - Size and type pump)
Flowing
Well Status (Prod. or Shut-in)
Shut in.

Date of Test
1-16-85
Hours Tested
7
Choke Size
Various
Prod'n. For Test Period
--
Oil - Bbl.
--
Gas - MCF
263
Water - Bbl.
2
Gas - Oil Ratio
263,000/1
Flow Tubing Press.
115 (DWT)
Casing Pressure
0
Calculated 24-Hour Rate
--
Oil - Bbl.
--
Gas - MCF
263
Water - Bbl.
2
Oil Gravity - API (Corr.)
NA

34. Disposition of Gas (Sold, used for fuel, vented, etc.)
Vented
Test Witnessed By
John West

35. List of Attachments
Logs listed in item #26

36. I hereby certify that the information shown on both sides of this form is true and complete to the best of my knowledge and belief.

SIGNED [Signature] TITLE Operations Manager DATE

INSTRUCTIONS

This form is to be filed with the appropriate District Office of the Commission not later than _____ days after the completion of any newly-drilled or deepened well. It shall be accompanied by one copy of all electrical and radio-activity logs run on the well and a summary of all special tests conducted, including drill stem tests. All depths reported shall be measured depths. In the case of directionally drilled wells, true vertical depths shall also be reported. For multiple completions, items 30 through 34 shall be reported for each zone. The form is to be filed in quintuplicate except on state land, where six copies are required. See Rule 1105.

INDICATE FORMATION TOPS IN CONFORMANCE WITH GEOGRAPHICAL SECTION OF STATE

Southeastern New Mexico

Northwestern New Mexico

T. Anhy _____	T. Canyon _____	T. Ojo Alamo _____	T. Penn. "B" _____
T. Salt _____	T. Strawn _____	T. Kirtland Fruitland _____	T. Penn. "C" _____
B. Salt _____	T. Atoka _____	T. Pictured Cliffs _____	T. Penn. "D" _____
T. Yates _____	T. Miss <u>6164'</u>	T. Cliff House _____	T. Leadville _____
T. 7 Rivers _____	T. Devonian _____	T. Menefee _____	T. Madison _____
T. Queen _____	T. Silurian _____	T. Point Lookout _____	T. Elbert _____
T. Grayburg _____	T. Montoya _____	T. Mancos _____	T. McCracken _____
T. San Andres <u>1211'</u>	T. Simpson _____	T. Gallup _____	T. Ignacio Qtzite _____
T. Glorieta <u>2328'</u>	T. McKee _____	Base Greenhorn _____	T. Granite _____
T. Paddock _____	T. Ellenburger _____	T. Dakota _____	T. _____
T. Blinbry _____	T. Gr. Wash _____	T. Morrison _____	T. _____
T. Tubb <u>3806'</u>	T. Granite <u>6514'</u>	T. Todilto _____	T. _____
T. Drinkard _____	T. Delaware Sand _____	T. Entrada _____	T. _____
T. Abo <u>4580'</u>	T. Bone Springs _____	T. Wingate _____	T. _____
T. Wolfcamp <u>5266'</u>	T. _____	T. Chinle _____	T. _____
T. Penn. <u>Lm</u> <u>5829'</u>	T. _____	T. Permian _____	T. _____
T. Cisco (Bough C) _____	T. _____	T. Penn. "A" _____	T. _____

OIL OR GAS SANDS OR ZONES

No. 1, from _____ to _____	No. 4, from _____ to _____
No. 2, from _____ to _____	No. 5, from _____ to _____
No. 3, from _____ to _____	No. 6, from _____ to _____

IMPORTANT WATER SANDS

Include data on rate of water inflow and elevation to which water rose in hole.

No. 1, from _____ to _____	_____ feet
No. 2, from _____ to _____	_____ feet
No. 3, from _____ to _____	_____ feet
No. 4, from _____ to _____	_____ feet

FORMATION RECORD (Attach additional sheets if necessary)

From	To	Thickness in Feet	Formation	From	To	Thickness in Feet	Formation
0	810	810	Surface	6333	6560	227	Dolo & lm
810	1206	396	Redbed		TD		
1206	2005	799	Lm				
2005	2234	229	Dolo				
2234	3055	821	Lm				
3055	3925	870	Anhy & Dolo				
3925	4386	461	Anhy & Dolo & Salt				
4386	4703	317	Dolo & Anhy				
4703	5010	307	Abo Shale				
5010	5477	467	Sh				
5477	6165	688	Lm & Sh				
6165	6269	104	Chert & Lm				
6269	6333	64	Lm, Sh, & Chert				

MEXICO OIL CONSERVATION COMMI
WELL LOCATION AND ACREAGE DEDICATION PLAT

All distances must be from the outer boundaries of the Section

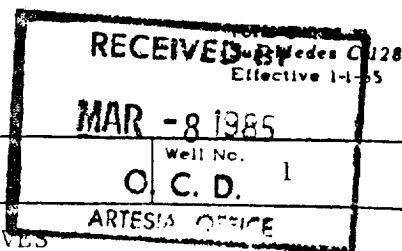

Operator HARPER OIL CO.			Lease SOUTH DALLAS		
Unit Letter F	Section 2	Township 10S	Range 26E	County CHAVES	
Actual Footage Location of Well: 1980 feet from the NORTH line and 1980 feet from the WEST line					
Ground Level Elev. 3843.3	Producing Formation MONTOKA		Pool Wildcat: Montoya		Dedicated Acreage: 320 Acres

1. Outline the acreage dedicated to the subject well by colored pencil or hachure marks on the plat below.
2. If more than one lease is dedicated to the well, outline each and identify the ownership thereof (both as to working interest and royalty).
3. If more than one lease of different ownership is dedicated to the well, have the interests of all owners been consolidated by communitization, unitization, force-pooling, etc?

☐ Yes ☐ No If answer is "yes," type of consolidation _____

If answer is "no," list the owners and tract descriptions which have actually been consolidated. (Use reverse side of this form if necessary.) _____

No allowable will be assigned to the well until all interests have been consolidated (by communitization, unitization, forced-pooling, or otherwise) or until a non-standard unit, eliminating such interests, has been approved by the Commission.

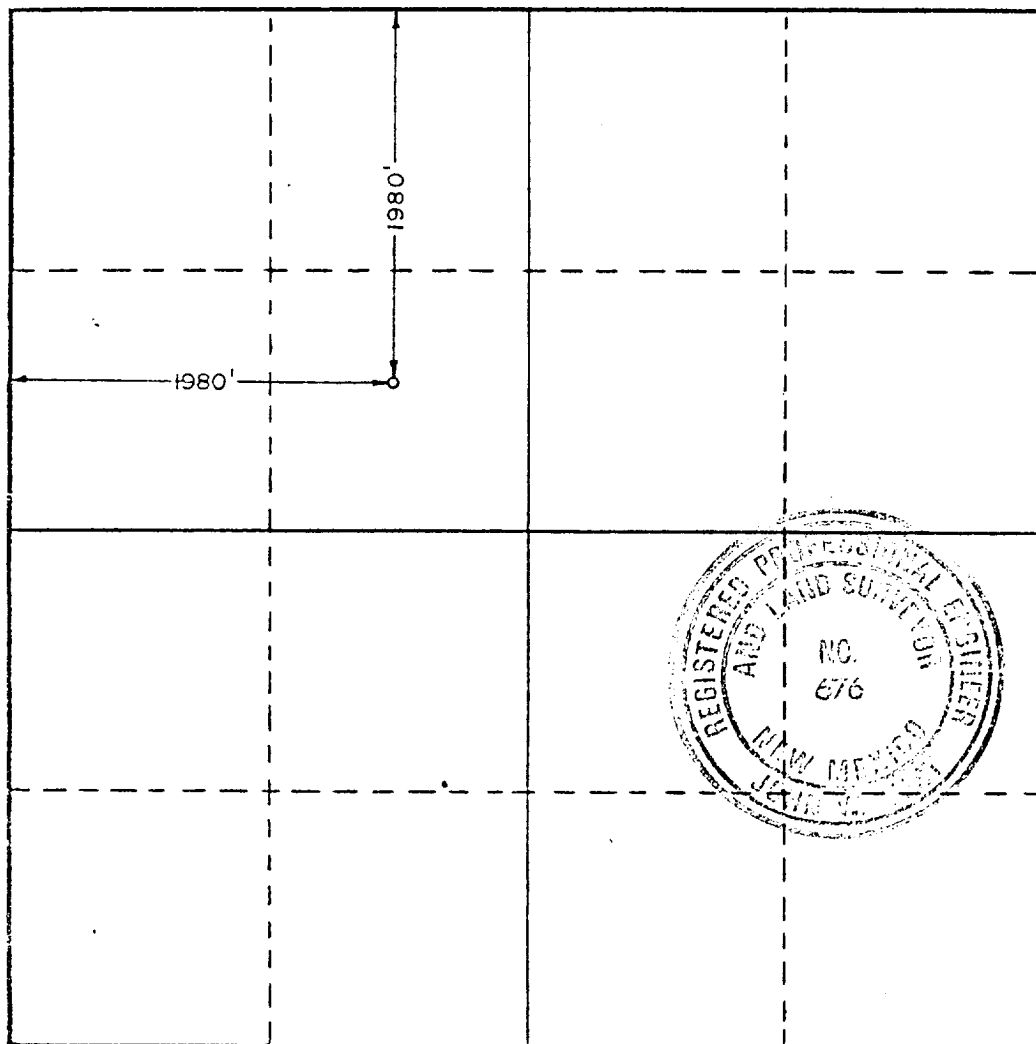

CERTIFICATION

I hereby certify that the information contained herein is true and complete to the best of my knowledge and belief.

Name *Don Needham*
Position *Prod. Supt.*
Company *Harper Oil Co*
Date *8-17-84*

I hereby certify that the well location shown on this plat was plotted from field notes of actual surveys made by me or under my supervision, and that the same is true and correct to the best of my knowledge and belief.

Date Surveyed
8/14/84

Registered Professional Engineer and/or Land Surveyor

Certificate No. JOHN W. WEST, 676

RONALD J. EIDSON, 3239

0 330 660 990 1320 1650 1980 2310 2640 2000 1800 1600 1400 1200 1000 800 0