

NEW MEXICO OIL CONSERVATION COMMISSION

Form C-101
Revised 1-1-65

RECEIVED BY

AUG 20 1984

O. C. D.

ARTESIA, OFFICE

5A. Indicate Type of Lease

STATE ☐FEE ☒

5. State Oil & Gas Lease No.

APPLICATION FOR PERMIT TO DRILL, DEEPEN, OR PLUG BACK

1a. Type of Work

DRILL ☒DEEPEN ☐PLUG BACK ☐

b. Type of Well

OIL
WELL ☒GAS
WELL ☐

OTHER

SINGLE
ZONE ☐MULTIPLE
ZONE ☐

2. Name of Operator

Cibola Energy Corporation ✓

3. Address of Operator

P. O. Box 1668, Albuquerque, New Mexico 87103

7. Unit Agreement Name

8. Farm or Lease Name

Plains 7

9. Well No.

2

10. Field and Pool, or Wildcat

~~North Race Track SA~~

4. Location of Well

UNIT LETTER B

LOCATED 330

FEET FROM THE North LINE

AND 2310 FEET FROM THE East

LINE OF SEC. 7

TWP. 10S

RGE. 28E

NMPM

12. County

Chaves

19. Proposed Depth

2375

19A. Formation

San Andres

20. Rotary or C.T.

CT

21. Elevations (Show whether DF, RT, etc.)

3824.5

21A. Kind & Status Plug. Bond

Statewide

21B. Drilling Contractor

22. Approx. Date Work will start

Immediately

23.

PROPOSED CASING AND CEMENT PROGRAM

| SIZE OF HOLE | SIZE OF CASING | WEIGHT PER FOOT | SETTING DEPTH | SACKS OF CEMENT | EST. TOP |
|--------------|----------------|-----------------|---------------|-----------------|----------|
| 10" | 8 5/8" | 23# | 320' | 200 sx | surface |
| 7 5/8" | 4 1/2" | 9.5# | 2375' | 120 sx | 1500' |

We plan to drill a 10" hole to 320' and set 8 5/8" casing, texas pattern guide shoe and 2 centralizers. 8 5/8" will be cemented with 200 sx Class C cement circulated to surface. A 7 5/8" hole will be drilled to approximately 2375'. Density and Induction logs will be run and depending on the outcome of the well, it will be P & A'd or 4 1/2" casing will be run.

APPROVAL VALID FOR 180 DAYS
PERMIT EXPIRES 2-22-85
UNLESS DRILLING UNDERWAY

Post ID-1
8-24-84
ART & BK

IN ABOVE SPACE DESCRIBE PROPOSED PROGRAM: IF PROPOSAL IS TO DEEPEN OR PLUG BACK, GIVE DATA ON PRESENT PRODUCTIVE ZONE AND PROPOSED NEW PRODUCTIVE ZONE. GIVE BLOWOUT PREVENTER PROGRAM, IF ANY.

I hereby certify that the information above is true and complete to the best of my knowledge and belief.

Signed Karen Ayer Title Drilling Secretary Date 8-15-84

(This space for State Use)

APPROVED BY Mike Williams TITLE OIL AND GAS INSPECTOR DATE AUG 22 1984

CONDITIONS OF APPROVAL, IF ANY:

N. MEXICO OIL CONSERVATION COMMISS
WELL LOCATION AND ACREAGE DEDICATION PLAT

Form C-102
 Supersedes C-128
 Effective 1-1-65

All distances must be from the outer boundaries of the Section.

| | | | | | |
|---|-----------------------------------|----------------------|-------------------------------|------------------|--------------------------------|
| Operator Cibola Energy Co. | | | Lease Plains 7 | | Well No. 2 |
| Unit Letter B | Section 7 | Township 10 South | Range 28 East | County Chaves | |
| Actual Footage Location of Well: 330 feet from the north line and 2310 feet from the east line | | | | | |
| Ground Level Elev. 3824.5' | Producing Formation San Andres | | Pool Race Track San Andres | | Dedicated Acreage: 40 Acres |

1. Outline the acreage dedicated to the subject well by colored pencil or hachure marks on the plat below.
2. If more than one lease is dedicated to the well, outline each and identify the ownership thereof (both as to working interest and royalty).
3. If more than one lease of different ownership is dedicated to the well, have the interests of all owners been consolidated by communitization, unitization, force-pooling, etc?

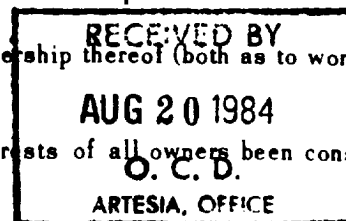

☐ Yes ☒ No If answer is "yes," type of consolidation _____

If answer is "no," list the owners and tract descriptions which have actually been consolidated. (Use reverse side of this form if necessary.) All leases held by operator and participating parties

No allowable will be assigned to the well until all interests have been consolidated (by communitization, unitization, forced-pooling, or otherwise) or until a non-standard unit, eliminating such interests, has been approved by the Commission.

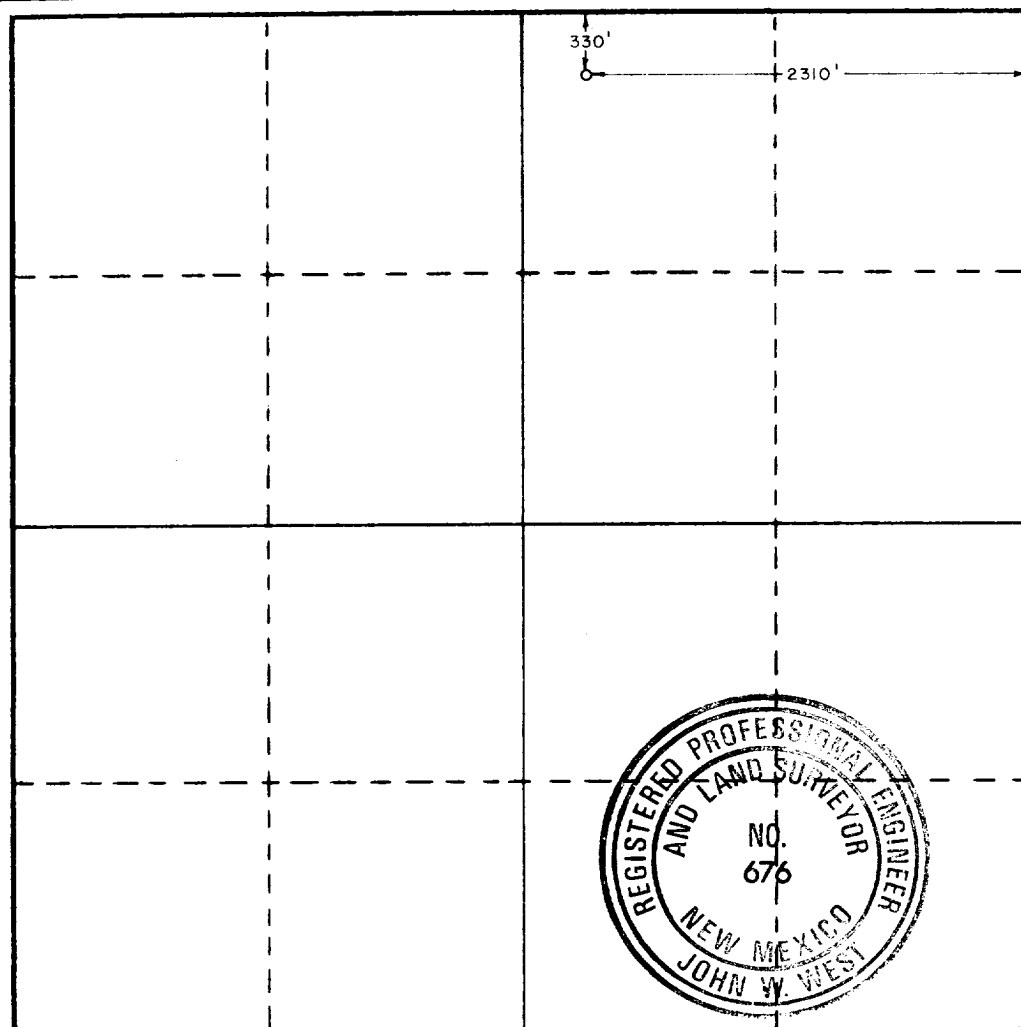

CERTIFICATION

I hereby certify that the information contained herein is true and complete to the best of my knowledge and belief.

Karen Azar

Name
 Karen Azar
 Position
 Drilling Secretary
 Company
 Cibola Energy Corporation
 Date
 8/19/84

I hereby certify that the well location shown on this plat was plotted from field notes of actual surveys made by me or under my supervision, and that the same is true and correct to the best of my knowledge and belief.

Date Surveyed
 August 16, 1984

Registered Professional Engineer and/or Land Surveyor

John W. West

Certificate No. JOHN W. WEST, 676
 RONALD J. EIDSON, 3239

