

STATE OF NEW MEXICO
ENERGY AND MINERALS DEPARTMENT

OIL CONSERVATION DIVISION

P. O. BOX 2088

SANTA FE, NEW MEXICO 87504

O. C. D.
ARTESIA, OFFICEForm C-101
Revised 10-1-78

NO. OF COPIES RECEIVED	
DISTRIBUTION	
SANTA FE	<input checked="" type="checkbox"/>
FILE	<input checked="" type="checkbox"/>
U.S.G.S.	<input checked="" type="checkbox"/>
LAND OFFICE	<input checked="" type="checkbox"/>
OPERATOR	<input checked="" type="checkbox"/>

5A. Indicate Type of Lease STATE <input type="checkbox"/> REC <input checked="" type="checkbox"/>
5. State Oil & Gas Lease No.
7. Unit Agreement Name
8. Form or Lease Name O'Brien Q
9. Well No. 1
10. Field and Pool, or Wildcat Wildcat-San Andres
12. County Chaves

APPLICATION FOR PERMIT TO DRILL, DEEPEN, OR PLUG BACK

a. Type of Work DRILL <input checked="" type="checkbox"/> DEEPEN <input type="checkbox"/> PLUG BACK <input type="checkbox"/>	b. Type of Well OIL WELL <input checked="" type="checkbox"/> GAS WELL <input type="checkbox"/> OTHER <input type="checkbox"/>	SINGLE ZONE <input type="checkbox"/> MULTIPLE ZONE <input type="checkbox"/>
c. Name of Operator Stevens Operating Corporation		
d. Address of Operator P. O. Box 2203 Roswell, NM 88201		
e. Location of well UNIT LETTER G LOCATED 1980 FEET FROM THE NORTH LINE 1980 FEET FROM THE EAST LINE OF SEC. 33 TWP. 8-S REC. 29-E AMPM		
1. Elevations (Show whether DF, RT, etc.) 3923.7 GR	21A. Kind & Status Plug. Bond Statewide	21B. Drilling Contractor Desert Drilling
19. Proposed Depth 3000'	19A. Formation San Andres	20. Rotary or C.T. 0-TD
22. Approx. Date Work will start 8-24-84		

3. PROPOSED CASING AND CEMENT PROGRAM					
SIZE OF HOLE	SIZE OF CASING	WEIGHT PER FOOT	SETTING DEPTH	SACKS OF CEMENT	EST. TOP
12 1/4	8 5/8	24.0#	320'	circ. to surface	
7 7/8	4 1/2	9.5#	3000'	500' above Pay Zone	

Propose to drill to a total depth of 3000'. All potential zones will be evaluated. If Commercial Production is indicated, well will be selectively perforated and treated.

APPROVAL VALID FOR 180 DAYS
PERMIT EXPIRES 2-27-85
UNLESS DRILLING UNDERWAY

4. ABOVE SPACE DESCRIBE PROPOSED PROGRAM; IF PROPOSAL IS TO DEEPEN OR PLUG BACK, GIVE DATA ON PRESENT PRODUCTIVE ZONE AND PROPOSED NEW PRODUCTIVE ZONE. GIVE SPOODY PREVENTER PROGRAM, IF ANY.

I hereby certify that the information above is true and complete to the best of my knowledge and belief.

Signed [Signature] Title Production Controller Date 8-22-84
(This space for State Use)

APPROVED BY [Signature] TITLE OIL AND GAS INSPECTOR DATE AUG 24 1984
CONDITIONS OF APPROVAL, IF ANY:

**N. MEXICO OIL CONSERVATION COMMISSION
WELL LOCATION AND ACREAGE DEDICATION PLAT**

Form C-102
Supersedes C-128
Effective 1-1-65

All distances must be from the outer boundaries of the Section.

Operator STEVENS OPERATING CO.			Lease O'BRIEN Q		Well No. 1
Unit Letter G	Section 33	Township 8 SOUTH	Range 29 EAST	County CHAVES	
Actual Footage Location of Well: <div style="display: flex; justify-content: space-between;"> 1980 feet from the NORTH line and 1980 feet from the EAST line </div>					
Ground Level Elev. 3923.7	Producing Formation San Andres	Pool Wildcat	Dedicated Acreage: 40 Acres		

1. Outline the acreage dedicated to the subject well by colored pencil or hachure marks on the plat below.
2. If more than one lease is dedicated to the well, outline each and identify the ownership thereof (both as to working interest and royalty).
3. If more than one lease of different ownership is dedicated to the well, have the interests of all owners been consolidated by communitization, unitization, force-pooling, etc?

☐ Yes ☐ No If answer is "yes," type of consolidation _____

If answer is "no," list the owners and tract descriptions which have actually been consolidated. (Use reverse side of this form if necessary.) _____

No allowable will be assigned to the well until all interests have been consolidated (by communitization, unitization, forced-pooling, or otherwise) or until a non-standard unit, eliminating such interests, has been approved by the Commission.

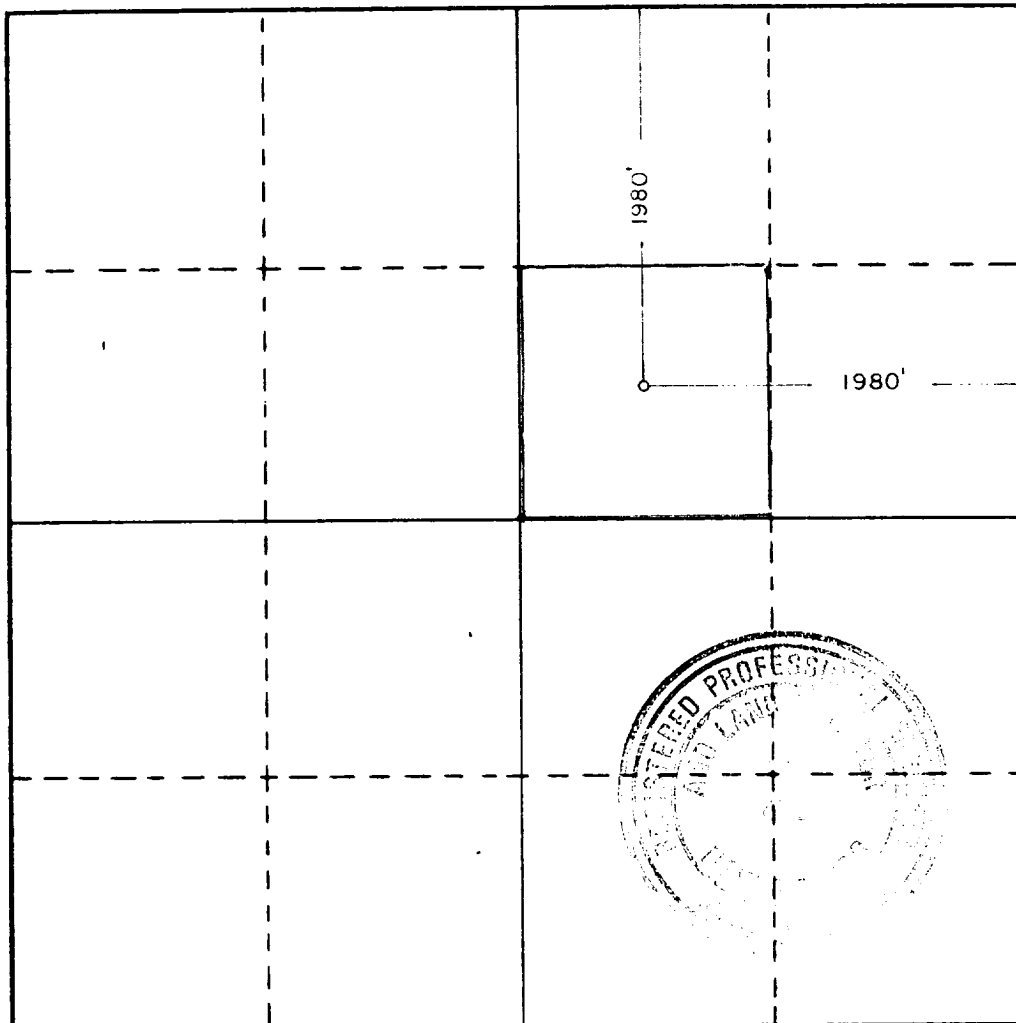

CERTIFICATION

I hereby certify that the information contained herein is true and complete to the best of my knowledge and belief.

Pat Thompson

Name

Position

Production Controller

Company

Stevens Operating Corporation

Date

8-22-84

I hereby certify that the well location shown on this plat was plotted from field notes of actual surveys made by me or under my supervision, and that the same is true and correct to the best of my knowledge and belief.

Date Surveyed

AUGUST 16, 1984

Registered Professional Engineer
and/or Land Surveyor

Certificate No. **JOHN W. WEST,**

676

RONALD J. EIDSON, 3239

0 320 640 960 1280 1600 1920 2240 2560 2880 3200 3520 3600