

D. OF COPIES RECEIVED	
DISTRIBUTION	
NTA FE	✓
LE	✓
S.G.S.	2
AND OFFICE	
PERATOR	✓

NEW MEXICO OIL CONSERVATION COMMISSION

Form C-101 30-005-62201  
Revised 1-4-85

RECEIVED BY  
OCT 09 1984  
O. C. D.  
ARTESIA, OFFICE

5A. Indicate Type of Lease
STATE <input type="checkbox"/> FEE <input checked="" type="checkbox"/>
5. State Oil & Gas Lease No.

APPLICATION FOR PERMIT TO DRILL, DEEPEN, OR PLUG BACK

a. Type of Work		b. Type of Well		c. Name of Operator		d. Address of Operator		e. Location of Well		f. Field and Pool, or Wildcat	
DRILL <input checked="" type="checkbox"/> DEEPEN <input type="checkbox"/> PLUG BACK <input type="checkbox"/>		OIL WELL <input checked="" type="checkbox"/> GAS WELL <input type="checkbox"/> OTHER <input type="checkbox"/>		Cibola Energy Corporation ✓		P. O. Box 1668, Albuquerque, New Mexico 87103		UNIT LETTER I LOCATED 1980 FEET FROM THE South LINE		Wildcat LE Ranch SA	
								ND 660 FEET FROM THE East LINE OF SEC. 30 TWP. 10S RGE. 28E NMPM		12. County Chaves	
								19. Proposed Depth 2300'		19A. Formation San Andres	
								20. Rotary or C.T. CT			
1. Elevations (Show whether DF, RT, etc.) 3784.9		21A. Kind & Status Plug. Bond Statewide		21B. Drilling Contractor Hammond Brothers		22. Approx. Date Work will start					

PROPOSED CASING AND CEMENT PROGRAM

SIZE OF HOLE	SIZE OF CASING	WEIGHT PER FOOT	SETTING DEPTH	SACKS OF CEMENT	EST. TOP
10"	8 5/8"	23#	320'	200 sx	surface
7 5/8"	4 1/2"	9.5#	2300'	120 sx	1500'

We plan to drill a 10" hole to 320' and set 8 5/8" casing, texas pattern guide shoe and 2 centralizers. 8 5/8" casing will be cemented with 200 sx Class C cement circulated to surface. A 7 5/8" hole will be drilled to approximately 2300'. Density and Induction logs will be run and depending on the outcome of the well, it will be p & A'd or 4 1/2" casing will be run.

APPROVAL VALID FOR 180 DAYS  
PERMIT EXPIRES 4-9-85  
UNLESS DRILLING UNDERWAY

4. ABOVE SPACE DESCRIBE PROPOSED PROGRAM: IF PROPOSAL IS TO DEEPEN OR PLUG BACK, GIVE DATA ON PRESENT PRODUCTIVE ZONE AND PROPOSED NEW PRODUCTION ZONE. GIVE BLOWOUT PREVENTER PROGRAM, IF ANY.

I hereby certify that the information above is true and complete to the best of my knowledge and belief.

Signed Karen Azar Title Drilling Secretary Date 10-1-84  
(This space for State Use)

APPROVED BY Leslie A. Clements DATE OCT 9 1984  
CONDITIONS OF APPROVAL, IF ANY: Supervisor District II

**MEXICO OIL CONSERVATION COMMISSION  
WELL LOCATION AND ACREAGE DEDICATION PLAT**

Form C-102  
Supersedes C-128  
Effective 1-1-65

All distances must be from the outer boundaries of the Section.

Operator <b>CIBOLA ENERGY CORP.</b>			Lease <b>SALLIE</b>		Well No. <b>2</b>
Unit Letter <b>I</b>	Section <b>30</b>	Township <b>10S</b>	Range <b>28E</b>	County <b>CHAVES</b>	
Actual Footage Location of Well:					
1980 feet from the <b>SOUTH</b> line and		660 feet from the <b>EAST</b> line			
Ground Level Elev. <b>3724.9</b>	Producing Formation <b>San Andres</b>	Pool <i>Ind.</i> <b>Race Track San Andres</b>	Dedicated Acreage: <b>40</b> Acres		

1. Outline the acreage dedicated to the subject well by colored pencil or hatchure marks on the plat below.
2. If more than one lease is dedicated to the well, outline each and identify the ownership thereof (both as to working interest and royalty).
3. If more than one lease of different ownership is dedicated to the well, have the interests of all owners been consolidated by communitization, unitization, force-pooling, etc?

☐ Yes    ☒ No    If answer is "yes," type of consolidation \_\_\_\_\_

If answer is "no," list the owners and tract descriptions which have actually been consolidated. (Use reverse side of this form if necessary.) All leases held by operator and participating parties

No allowable will be assigned to the well until all interests have been consolidated (by communitization, unitization, forced-pooling, or otherwise) or until a non-standard unit, eliminating such interests, has been approved by the Commission.

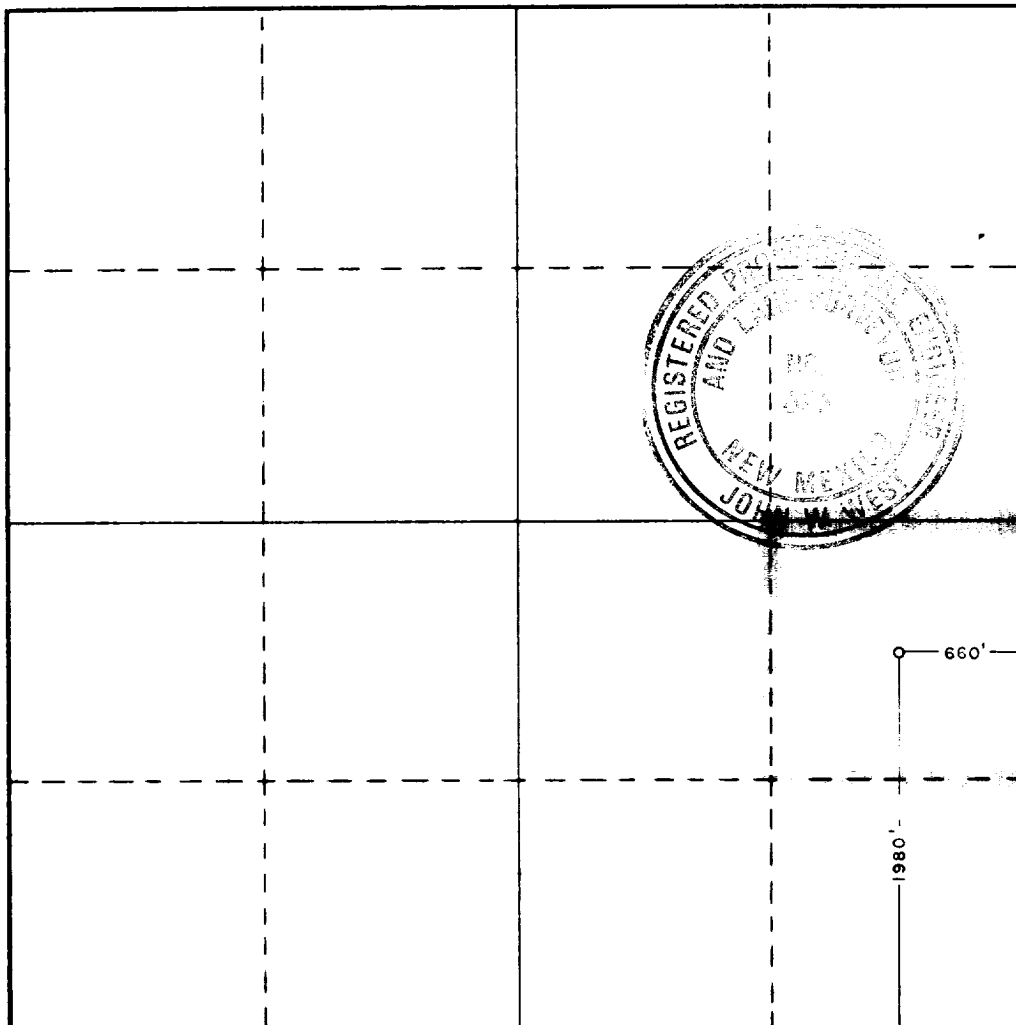

**CERTIFICATION**

I hereby certify that the information contained herein is true and complete to the best of my knowledge and belief.

*Karen Azar*  
Name  
**Karen Azar**  
Position  
**Drilling Secretary**  
Company  
**Cibola Energy**  
Date  
**10/9/84**

I hereby certify that the well location shown on this plat was plotted from field notes of actual surveys made by me or under my supervision, and that the same is true and correct to the best of my knowledge and belief.

Date Surveyed  
**10/1/84**

Registered Professional Engineer and/or Land Surveyor

*John W. West*  
Certificate No. **JOHN W. WEST, 676**  
**RONALD J. EIDSON, 3239**