

RECEIVED BY

UNITED STATES
DEPARTMENT OF THE INTERIOR
BUREAU OF LAND MANAGEMENT

NM OIL CONS. COMMISSION
Drawer DD SUBMIT IN ' Llicate*
Artesia, NM 88210 (Questions on
reverse side)

50-005-62221
Form approved.
Budget Bureau No. 1004-0136
Expires August 31, 1985

APPLICATION FOR PERMIT TO DRILL, DEEPEN, OR PLUG BACK

1a. TYPE OF WORK

DRILL ☒

DEEPEN ☐

PLUG BACK ☐

b. TYPE OF WELL

OIL
WELL ☐

GAS
WELL ☒

OTHER

SINGLE
ZONE ☒

MULTIPLE
ZONE ☐

2. NAME OF OPERATOR

TRANSWESTERN GAS SUPPLY COMPANY

3. ADDRESS OF OPERATOR

2801 North Main

Roswell, New Mexico 88201

4. LOCATION OF WELL (Report location clearly and in accordance with any State requirements.)

At surface

790' FNL 790' FEL

Sec. 24-4S-21E

At proposed prod. zone

Same as above

14. DISTANCE IN MILES AND DIRECTION FROM NEAREST TOWN OR POST OFFICE*

40 miles northwest of Roswell, New Mexico

10. DISTANCE FROM PROPOSED*

LOCATION TO NEAREST

PROPERTY OR LEASE LINE, FT.

(Also to nearest drlg. unit line, if any)

790'

18. DISTANCE FROM PROPOSED LOCATION*

T) NEAREST WELL, DRILLING, COMPLETED,

OR APPLIED FOR, ON THIS LEASE, FT.

None

21. ELEVATIONS (Show whether DF, RT, GR, etc.)

4512' GL

23.

PROPOSED CASING AND CEMENTING PROGRAM

SIZE OF HOLE	SIZE OF CASING	WEIGHT PER FOOT	SETTING DEPTH	QUANTITY OF CEMENT
7-1/2"	13-3/8"	48.0# K-55	40'	Grouted with Redi-Mix
2-1/4"	8-5/8" LT&C	24.0# K-55	875'±	550 sx (Circulated)
7-7/8"	4-1/2" LT&C	10.5# J-55	3400'±	300 sx to cover Abo and Tubb formations

Propose to drill to about 3400' to test Abo and intermediate formations.

See attached "Supplemental Drilling Data".

See Exhibit "D" for BOP diagram.

Gas is dedicated to TRANSWESTERN PIPELINE COMPANY.

IN ABOVE SPACE DESCRIBE PROPOSED PROGRAM: If proposal is to deepen or plug back, give data on present productive zone and proposed new productive zone. If proposal is to drill or deepen directionally, give pertinent data on subsurface locations and measured and true vertical depths. Give blowout preventer program, if any.

24.

SIGNED

JERRY W. LONG

TITLE Agent

DATE December 3, 1984

(This space for Federal or State office use)

PERMIT NO.

APPROVAL DATE

S/Homer Meyer, Acting

Area Manager

APPROVED BY

TITLE

DATE

CONDITIONS OF APPROVAL, IF ANY:

*See Instructions On Reverse Side

All distances must be from the outer boundaries of the Section.

Operator Transwestern Gas Supply Company		Lease Jerry Don Federal		Well No. 1
Unit Letter A	Section 24	Township 4 South	Range 21 East	County Chaves
Actual Postage Location of Well: 790 feet from the North line and 790 feet from the East line				
Ground Level Elev. 4512	Producing Formation Abo	Pool Wildcat	Dedicated Acreage: 160 Acres	

1. Outline the acreage dedicated to the subject well by colored pencil or hachure marks on the plat below.

2. If more than one lease is dedicated to the well, outline each and identify the ownership thereof (both as to working interest and royalty). SINGLE LEASE NM 32330

3. If more than one lease of different ownership is dedicated to the well, have the interests of all owners been consolidated by communitization, unitization, force-pooling, etc?

☐ Yes ☐ No If answer is "yes," type of consolidation _____

If answer is "no," list the owners and tract descriptions which have actually been consolidated. (Use reverse side of this form if necessary.) _____

No allowable will be assigned to the well until all interests have been consolidated (by communitization, unitization, forced-pooling, or otherwise) or until a non-standard unit, eliminating such interests, has been approved by the Division.

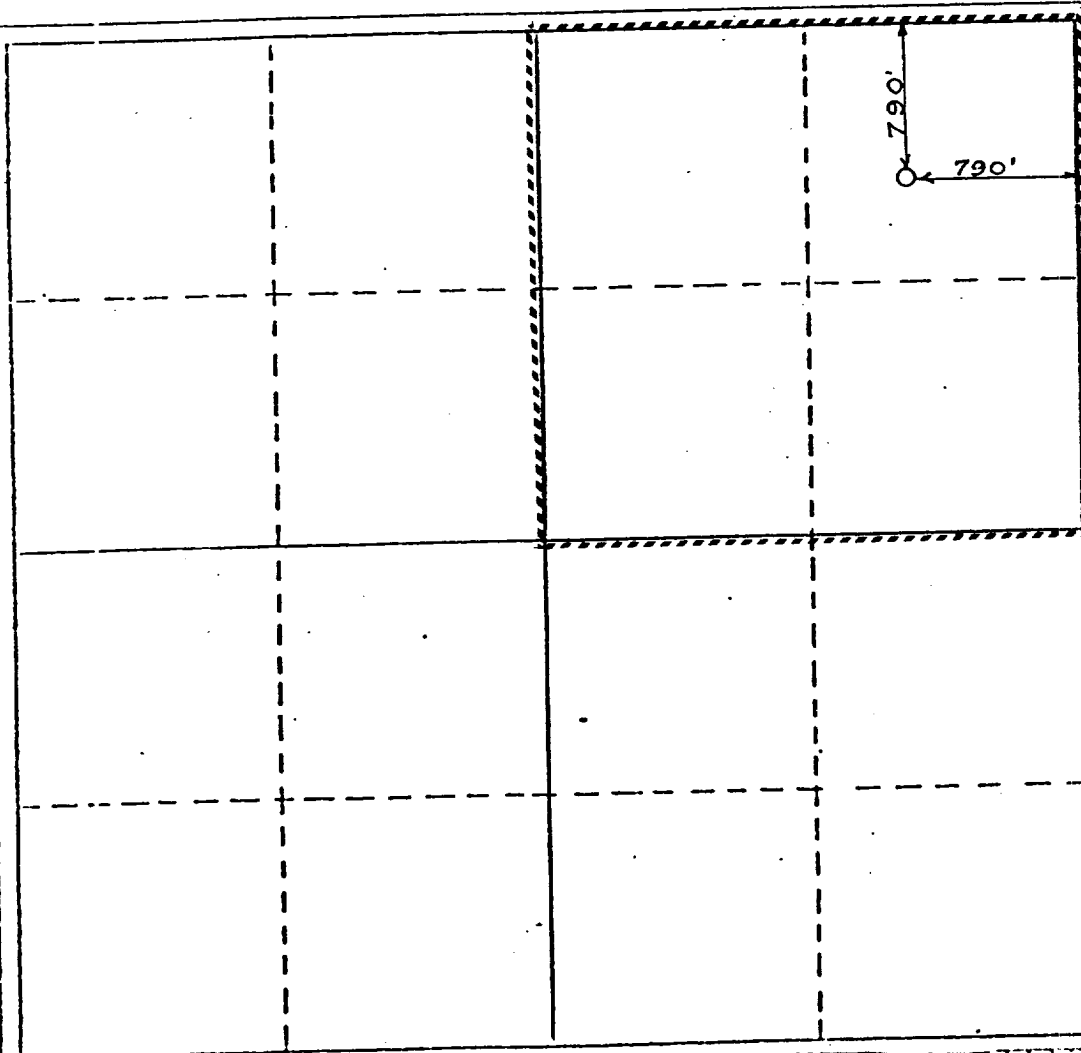

CERTIFICATION

I hereby certify that the information contained herein is true and complete to the best of my knowledge and belief.

Name
JERRY W. LONG

Position
Agent

Company
TRANSWESTERN GAS SUPPLY COMPANY

Date
December 3, 1984

I hereby certify that the well location shown on this plat was plotted from field notes of actual surveys made by me or under my supervision, and that the same is true and correct to the best of my knowledge and belief.

November 29, 1984

Date Surveyed
P. R. Patton

Registered Professional Engineer and/or Land Surveyor

8112

Certificate No.

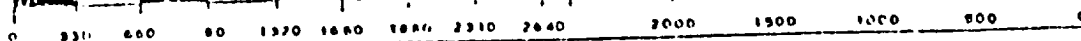
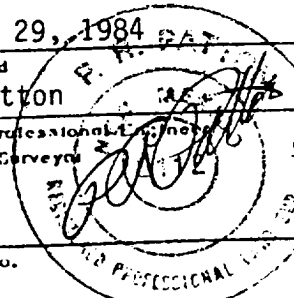

TRANSWESTERN GAS SUPPLY COMPANY
No.1 Jerry Don Federal
NE $\frac{1}{4}$ NE $\frac{1}{4}$ Sec.24-4S-21E
Chaves County, N.M.

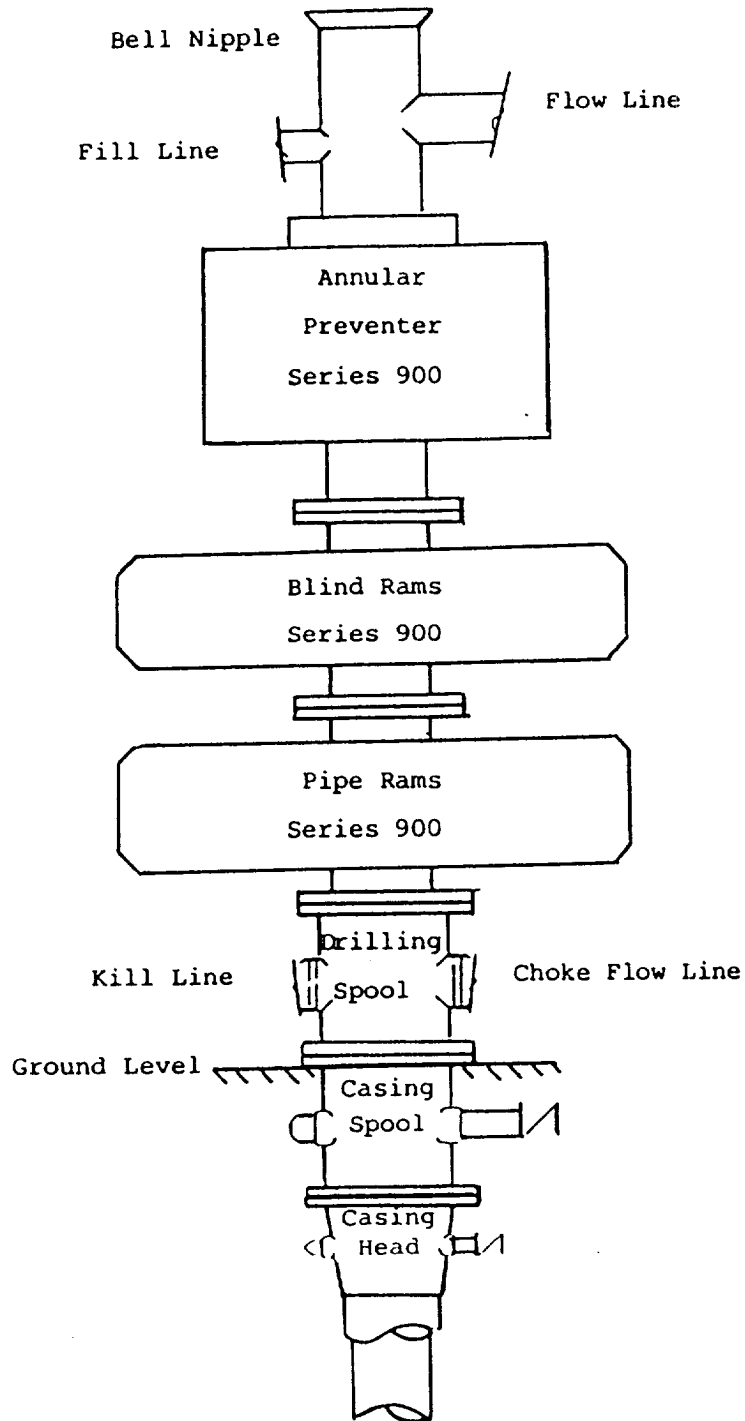

BLOWOUT PREVENTER STACK
Rams Operated Daily

SUPPLEMENTAL DRILLING DATA

TRANSWESTERN GAS SUPPLY COMPANY
No.1 Jerry Don Federal
NE $\frac{1}{4}$ NE $\frac{1}{4}$ Sec.24-4S-21E
Chaves County, N.M.

NM 32330

The following items supplement Form 3160-3 in accordance with instructions contained in Onshore Oil and Gas Order No.1:

1. SURFACE FORMATION: Permian San Andres

2. ESTIMATED TOPS OF GEOLOGIC MARKERS:

San Andres - Surface	Abo - 2745'
Glorieta - 1140'	TD - 3400'
Tubb - 2292'	

3. ESTIMATED DEPTHS TO WATER, OIL OR GAS FORMATION:

Fresh Water - None (Water wells in this area have been unsuccessful)	
Salt Water - 2300' to TD	
Gas - 2800' to 3400'	

4. PROPOSED CASING PROGRAM:

13-3/8" Casing	- Set two joints with rat hole machine and grout to surface.
8-5/8" Casing	- Set at 875'± and cement with 550± sx to circulate to surface.
4-1/2" Casing	- Set to Total Depth and cement with about 300 sx to isolate all water, oil and gas zones.

5. PRESSURE CONTROL EQUIPMENT: BOP stack will consist of double-ram BOP rated to 3000#WP. A sketch of the BOP is attached.

6. CIRCULATING MEDIUM: Hole for 13-3/8" conductor pipe will be drilled with a rat hole auger. Mud will be used as the circulating medium below 40'. Fresh water mud will be used to 875'. Salt gel mud will be used from 875' to TD.

[illegible]

TRANSWESTERN GAS SUPPLY COMPANY
No. 1 Jerry Don Federal
NE 1/4 NE 1/4 Sec. 24-4S-21E
Chaves County, N.M.

14 13 18

23 24 19

26 Bomb Target Tank

25 Big Tank

30

COUNTY ROAD 35

NEW ROAD

PUBLIC SURFACE

RANCH ROAD

NM 32330

No. 1 Pronghorn

PRONGHORN LEASE

NM 32335

EXHIBIT B
CONTOUR MAP

ANSWESTERN GAS SUPPLY COMPANY
No.1 Jerry Don Federal
NE¼NE¼ Sec.24-4S-21E
Chaves County, N.M.

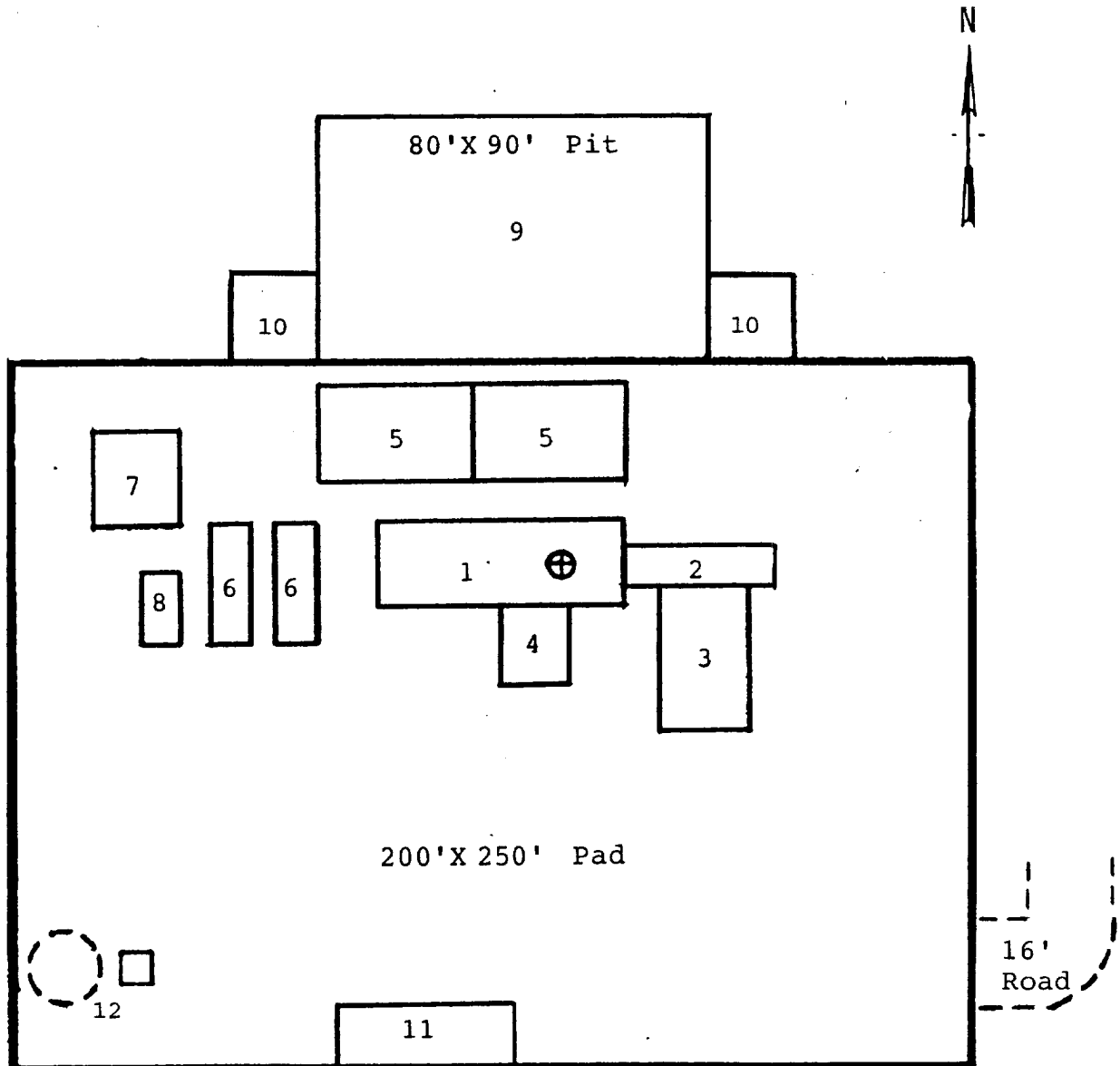

RIG LAYOUT

- | | |
|-----------------|---------------------------|
| 1. Substructure | 7. Water Tank |
| 2. Catwalk | 8. Light Plant |
| 3. Pipe Rack | 9. Reserve Pit |
| 4. Doghouse | 10. Trash Pit |
| 5. Mud Pits | 11. Trailer House |
| 6. Mud Pumps | 12. Production Facilities |