

STATE OF NEW MEXICO
ENERGY AND MINERALS DEPARTMENT

WATER CONSERVATION DIVISION

P. O. BOX 2088

SANTA FE, NEW MEXICO 87501

DEC 26 1984

O. C. D.
ARTESIA, OFFICE

Form C-101 30-005-62258
Revised 10-1-78

NO. OF COPIES RECEIVED	
DISTRIBUTION	
SANTA FE	✓
FILE	✓
U.S.G.S.	2
LAND OFFICE	
OPERATOR	✓

5A. Indicate Type of Lease
STATE ☐ FEE ☒
5. State Oil & Gas Lease No.

APPLICATION FOR PERMIT TO DRILL, DEEPEN, OR PLUG BACK

1a. Type of Work b. Type of Well OIL WELL <input checked="" type="checkbox"/> GAS WELL <input type="checkbox"/> OTHER <input type="checkbox"/> 2. Name of Operator Petrus Operating Company, Inc. ✓ 3. Address of Operator 12201 Merit Drive, Suite 900 Dallas, Texas 75251 4. Location of Well UNIT LETTER I LOCATED 1980 FEET FROM THE South LINE AND 660 FEET FROM THE East LINE OF SEC. 34 TWP. 7S RGE. 29E NMPM 12. County Chaves		7. Unit Agreement Name 8. Farm or Lease Name Moon Company 24 9. Well No. 34-1 #1 10. Field and Pool, or Wildcat Wildcat - SA 19. Proposed Depth 4000 19A. Formation San Andres 20. Rotary or C.T. Rotary 21. Elevations (Show whether DF, RT, etc.) 4105' GL 21A. Kind & Status Plug. Bond Blanket Bond 21B. Drilling Contractor Salazar Brothers Drilling 22. Approx. Date Work will start 1-1-85	
---	--	--	--

PROPOSED CASING AND CEMENT PROGRAM

SIZE OF HOLE	SIZE OF CASING	WEIGHT PER FOOT	SETTING DEPTH	SACKS OF CEMENT	EST. TOP
12-1/4"	8-5/8"	24	500	450 sx	Surface
7-7/8"	4-1/2"	10.5	3500	400 sx	1000'

Drilling to use conventional mud and rotary drilling methods. Completion to be conventional perforation and treatment. Sketch of type blowout preventor attached.

APPROVAL FOR 180 DAYS
6-28-85
UNDERWAY

IN ABOVE SPACE DESCRIBE PROPOSED PROGRAM; IF PROPOSAL IS TO DEEPEN OR PLUG BACK, GIVE DATA ON PRESENT PRODUCTIVE ZONE AND PROPOSED NEW PRODU-
TIVE ZONE. GIVE BLOWOUT PREVENTER PROGRAM, IF ANY.

I hereby certify that the information above is true and complete to the best of my knowledge and belief.

Signed C. L. Hardy Title Drilling & Production Manager Date 12-19-84

(This space for State Use)

APPROVED BY Mike Williams Original Signed By Mike Williams DATE DEC 27 1984
CONDITIONS OF APPROVAL, IF ANY: Oil & Gas Inspector

STATE OF NEW MEXICO
ENERGY AND MINERALS DEPARTMENT

OIL CONSERVATION DIVISION
P. O. BOX 2088
SANTA FE, NEW MEXICO 8 01

RECEIVED
DEC 26 1984

Form C-102
Revised 10-1-78

All Distances must be from the outer boundaries of the Section.

Operator Petrus Operating Co.			Lease Moon Company			O. C. D. ARTESIA OFFICE			Well No. 34 #1		
Section I	Section 34	Township 7 South	Range 29 East	County Chaves							
Actual Wellbore Location of Well											
1980 feet from the		South line and		660 feet from the		East line					
Ground Level Elev. 4105		Producing Formation San Andres		Pool Wildcat		Dedicated Acreage 40		Acres			

1. Outline the acreage dedicated to the subject well by colored pencil or hatchure marks on the plat below.
2. If more than one lease is dedicated to the well, outline each and identify the ownership thereof (both as to working interest and royalty).
3. If more than one lease of different ownership is dedicated to the well, have the interests of all owners been consolidated by communitization, unitization, force-pooling, etc?

☐ Yes ☐ No If answer is "yes," type of consolidation _____

If answer is "no," list the owners and tract descriptions which have actually been consolidated. (Use reverse side of this form if necessary.) _____

No allowable will be assigned to the well until all interests have been consolidated (by communitization, unitization, forced-pooling, or otherwise) or until a non-standard unit, eliminating such interests, has been approved by the Division

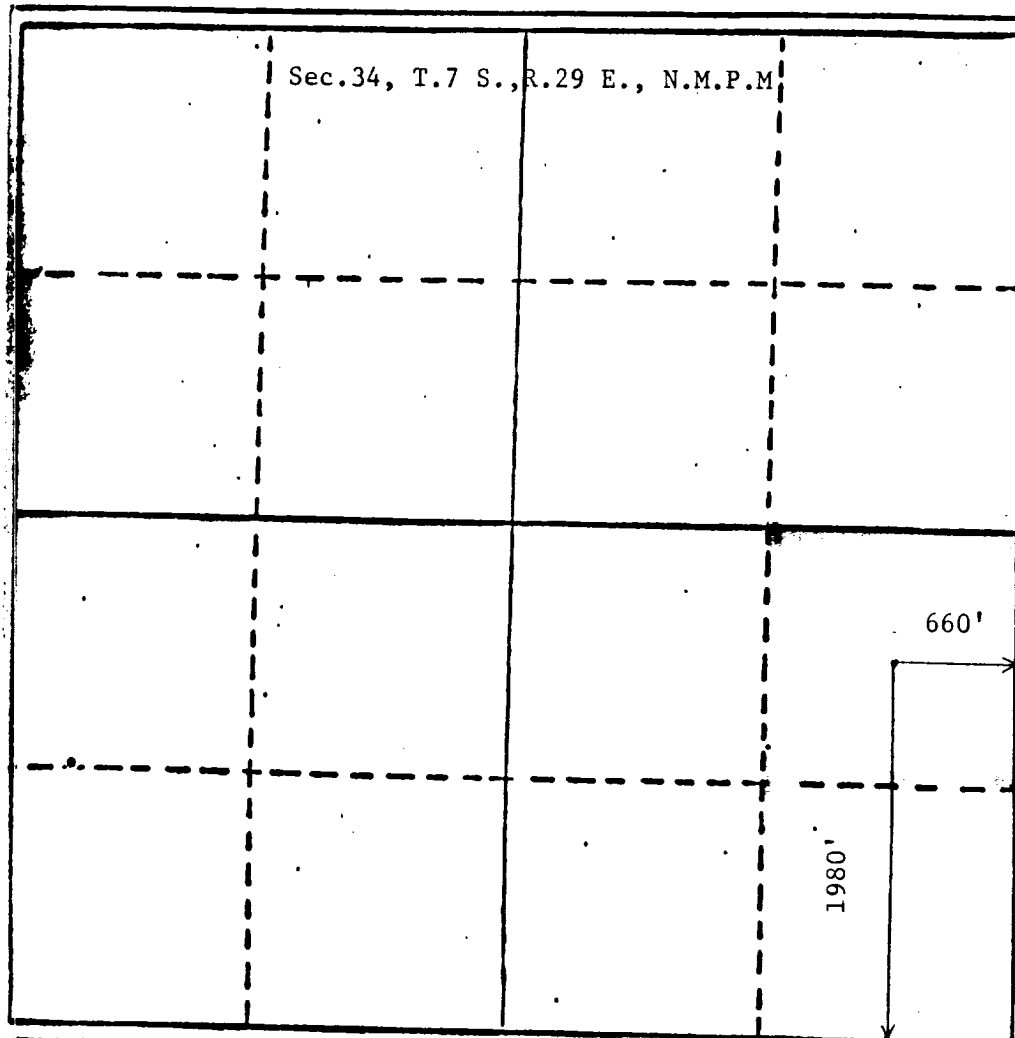

CERTIFICATION

I hereby certify that the information contained herein is true and complete to the best of my knowledge and belief.

C. L. Hardy
Name

C. L. Hardy

Position

Drilling & Production Mgr.

Company

Petrus Operating Company, Inc.

Date

12-19-84

I hereby certify that the well location shown on this plat was plotted from field notes of actual surveys made by me or under my supervision, and that the same is true and correct to the best of my knowledge and belief.

Date Surveyed

November 1984

Registered Professional Engineer and/or Land Surveyor

6290

John D. Jaques

Certificate No. 6290

PROFESSIONAL ENGINEER

