

All distances must be from the outer boundaries of the Section.

Operator Petroleum Development Corporation			Lease Mary "K"		Well No. 1
Unit Letter	Section 29	Township 10 South	Range 25 East	County Chaves	
Actual Footage Location of Well:					
660 feet from the North line and		775 feet from the West line			
Ground Level Elev. 3515	Producing Formation Abo	Pool Undes. Abo	Dedicated Acreage: 160 Acres		

1. Outline the acreage dedicated to the subject well by colored pencil or hatchure marks on the plat below.
2. If more than one lease is dedicated to the well, outline each and identify the ownership thereof (both as to working interest and royalty).
3. If more than one lease of different ownership is dedicated to the well, have the interests of all owners been consolidated by communitization, unitization, force-pooling, etc?

☐ Yes ☐ No If answer is "yes," type of consolidation _____

If answer is "no," list the owners and tract descriptions which have actually been consolidated. (Use reverse side of this form if necessary.) _____

No allowable will be assigned to the well until all interests have been consolidated (by communitization, unitization, forced-pooling, or otherwise) or until a non-standard unit, eliminating such interests, has been approved by the Division.

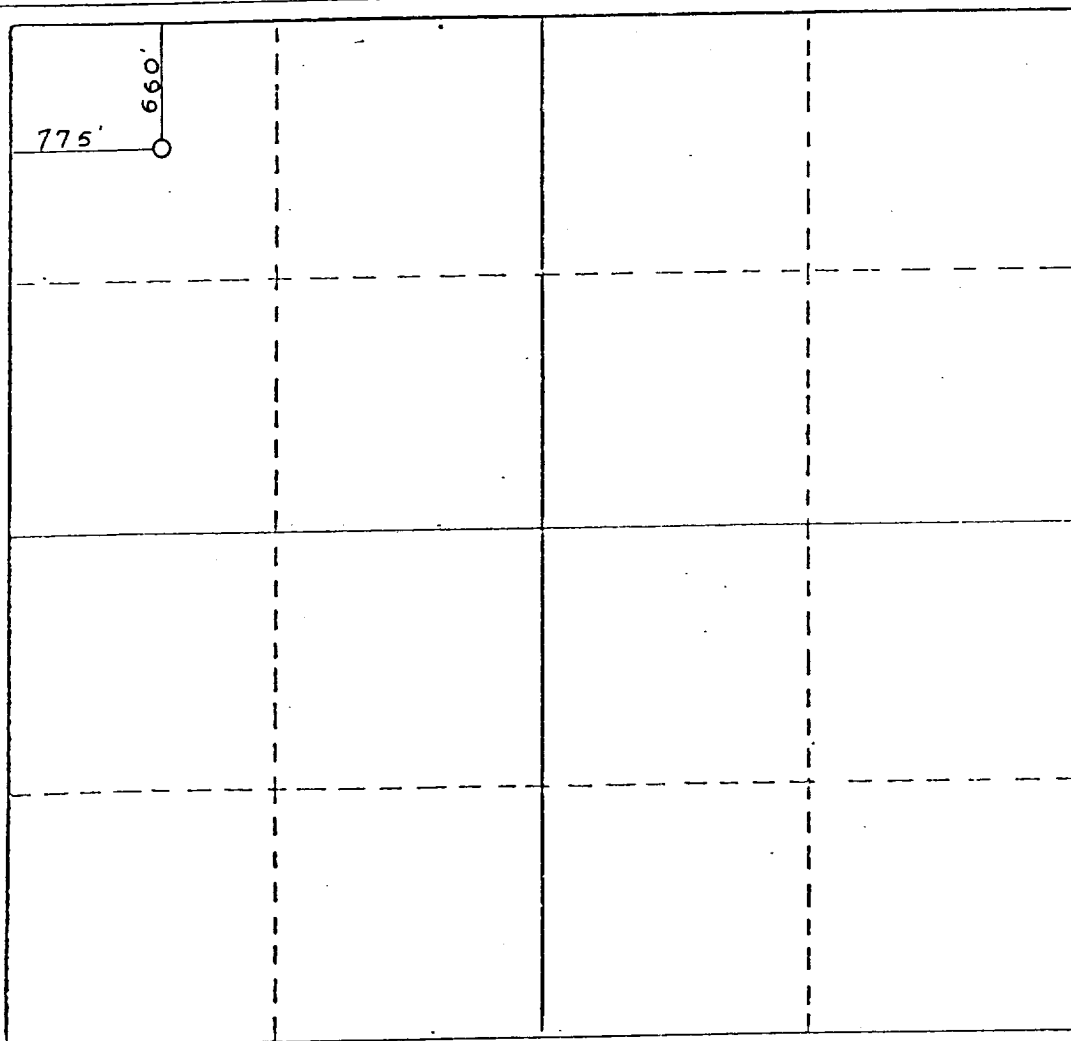

CERTIFICATION

I hereby certify that the information contained herein is true and complete to the best of my knowledge and belief.

Name Jim C. Johnson, Jr.
Position Field Manager
Company Petroleum Development Corp.
Date January 8, 1985

I hereby certify that the well location shown on this plat was plotted from field notes of actual surveys made by me or under my supervision, and that the same is true and correct to the best of my knowledge and belief.

Date Surveyed January 4, 1985
Surveyed by P. R. Patton
Registered Professional Engineer and/or Land Surveyor
8112
Certificate No.

