

STATE OF NEW MEXICO
ENERGY AND MINERALS DEPARTMENT

OIL CONSERVATION DIVISION

RECEIVED BY O. BOX 2088
SANTA FE, NEW MEXICO 87501
JAN 25 1985
O. C. D.
ARTESIA, OFFICE

Form C-101
Revised 10-1-78

NO. OF COPIES RECEIVED	
DISTRIBUTION	
SANTA FE	<input checked="" type="checkbox"/>
FILE	<input checked="" type="checkbox"/>
U.S.G.S.	<input checked="" type="checkbox"/>
LAND OFFICE	<input checked="" type="checkbox"/>
OPERATOR	<input checked="" type="checkbox"/>

5A. Indicate Type of Lease
STATE ☐ FCC ☒
5. State Oil & Gas Lease No.
N/A

APPLICATION FOR PERMIT TO DRILL, DEEPEN, OR PLUG BACK

1a. Type of Work DRILL <input checked="" type="checkbox"/> DEEPEN <input type="checkbox"/> PLUG BACK <input type="checkbox"/>		7. Unit Agreement Name N/A
b. Type of Well OIL WELL <input checked="" type="checkbox"/> GAS WELL <input type="checkbox"/> OTHER <input type="checkbox"/> SINGLE ZONE <input type="checkbox"/> MULTIPLE ZONE <input type="checkbox"/>		8. Farm or Lease Name O'Brien "P"
2. Name of Operator Stevens Operating Corporation		9. Well No. 2
3. Address of Operator P. O. Box 2203 Roswell, New Mexico 88201		10. Field and Pool, or Wildcat Red Lake Ridge San Andres
4. Location of Well UNIT LETTER D LOCATED 660 FEET FROM THE North LINE AND 660 FEET FROM THE West LINE OF SEC. 28 TWP. 8-S RGE. 29-E N.M.P.M.		12. County Chaves
19. Proposed Depth 3000'		19A. Formation San Andres
20. Rotary or C.T. 0-TD		
1. Elevations (show whether DT, RT, etc.) 3928 GR	21A. Kind & Status Plug. Bond Statewide	21B. Drilling Contractor Desert Drilling
22. Approx. Date Work will start 1-28-85		

PROPOSED CASING AND CEMENT PROGRAM

SIZE OF HOLE	SIZE OF CASING	WEIGHT PER FOOT	SETTING DEPTH	SACKS OF CEMENT	EST. TOP
12 1/4	8 5/8	24.0#	380'	Circ to Surface.	
7 7/8	5 1/2		3000'	500' Above Pay Zone.	

Propose to drill to a total depth of 3000' with water & mud.
All potential zones will be evaluated. If commercial production
is indicated, well will be selectively perforated and treated.

Adequate Blowout Preventers will be used.

APPROVAL VALID FOR 180 DAYS
RENEW BY 7-28-85
UNLESS DRILLING UNDERWAY

Partial IDI
API # NL
2-1-85

IN ABOVE SPACE DESCRIBE PROPOSED PROGRAM; IF PROPOSAL IS TO DEEPEN OR PLUG BACK, GIVE DATA ON PRESENT PRODUCTIVE ZONE AND PROPOSED NEW PRODUCTIVE ZONE, GIVE BLOWOUT PREVENTER PROGRAM, IF ANY.

I hereby certify that the information above is true and complete to the best of my knowledge and belief.

Signed John V. Walker Title Geologist Date 1-25-85

(This space for State Use)

APPROVED BY Mike Williams TITLE OIL AND GAS INSPECTOR DATE JAN 29 1985

CONDITIONS OF APPROVAL, IF ANY:

NEW MEXICO OIL CONSERVATION COMMISSION
WELL LOCATION AND ACREAGE DEDICATION PLAT

Form C-102
Supersedes C-128
Effective 1-1-65

All distances must be from the outer boundaries of the Section.

Operator Stevens Operating Corporation			Lease O'Brien "P"		Well No. 2
Unit Letter D	Section 28	Township 8 South	Range 29 East	County Chaves	
Actual Footage Location of Well: 660 feet from the West line and 660 feet from the North line					
Ground Level Elev. 3928 GR	Producing Formation San Andres		Pool Red Lake Ridge-San Andres		Dedicated Acreage: 40 Acres

1. Outline the acreage dedicated to the subject well by colored pencil or hachure marks on the plat below.
2. If more than one lease is dedicated to the well, outline each and identify the ownership thereof (both as to working interest and royalty).
3. If more than one lease of different ownership is dedicated to the well, have the interests of all owners been consolidated by communitization, unitization, force-pooling, etc?

☐ Yes ☐ No If answer is "yes," type of consolidation _____

If answer is "no," list the owners and tract descriptions which have actually been consolidated. (Use reverse side of this form if necessary.) _____

No allowable will be assigned to the well until all interests have been consolidated (by communitization, unitization, forced-pooling, or otherwise) or until a non-standard unit, eliminating such interests, has been approved by the Commission.

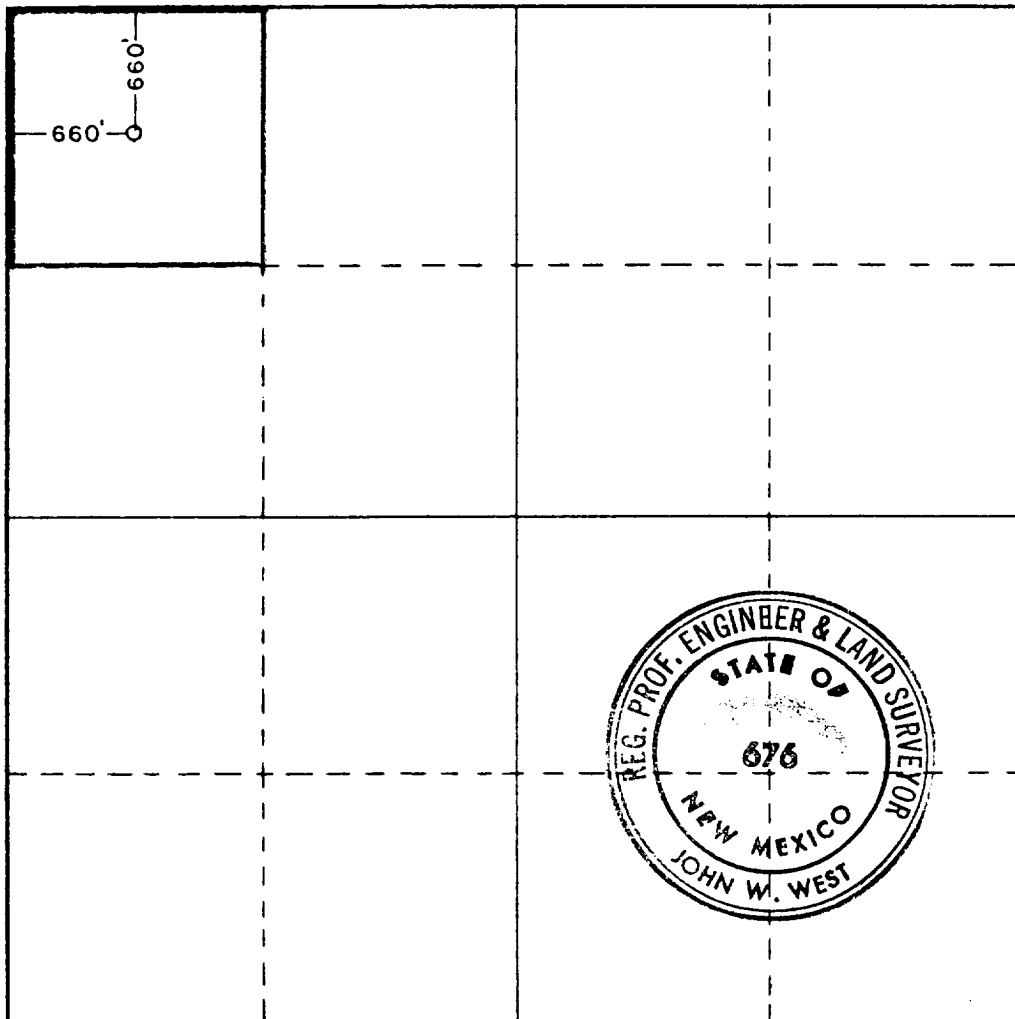

CERTIFICATION

I hereby certify that the information contained herein is true and complete to the best of my knowledge and belief.

Name John V. Walker
Position
Geologist
Company
Stevens Operating Corporation
Date
January 25, 1985

I hereby certify that the well location shown on this plat was plotted from field notes of actual surveys made by me or under my supervision, and that the same is true and correct to the best of my knowledge and belief.

January 25, 1985

Date Surveyed

Registered Professional Engineer and/or Land Surveyor

John W. West
Certificate No. **JOHN W. WEST 676**
PATRICK A. ROMERO 6668
Ronald J. Eidson 3239

