

RECEIVED BY
UNITED STATES
DEPARTMENT OF THE INTERIOR
GEOLOGICAL SURVEY
ARTESIA, NEW MEXICO

NEW OIL CONS. COM. STATION
DRAWER 55
Artesia, NM 88210
(Other instructions on
Form approved.
Budget Bureau No. 42-R1425.

30-005-62282
Form approved.
Budget Bureau No. 42-R1425.

APPLICATION FOR PERMIT TO DRILL, DEEPEN, OR PLUG BACK

1a. TYPE OF WORK

DRILL ☒

DEEPEN ☐

PLUG BACK ☐

b. TYPE OF WELL

OIL WELL ☐

GAS WELL ☒

OTHER

SINGLE ZONE ☐

2. NAME OF OPERATOR

McClellan Oil Corporation

3. ADDRESS OF OPERATOR

P. O. Drawer 730 Roswell, NM 88202

4. LOCATION OF WELL (Report location clearly and in accordance with any state requirements)

660' FSL & 660' FWL

At proposed prod. zone

Same

14. DISTANCE IN MILES AND DIRECTION FROM NEAREST TOWN OR POST OFFICE*

19 miles northwest of Roswell, New Mexico

15. DISTANCE FROM PROPOSED*

LOCATION TO NEAREST PROPERTY OR LEASE LINE, FT. (Also to nearest drlg. unit line, if any)

660'

16. NO. OF ACRES IN LEASE

2560

17. NO. OF ACRES ASSIGNED TO THIS WELL

160

18. DISTANCE FROM PROPOSED LOCATION* TO NEAREST WELL, DRILLING, COMPLETED, OR APPLIED FOR, ON THIS LEASE, FT.

N/A

19. PROPOSED DEPTH

3600'

20. ROTARY OR CABLE TOOLS

Rotary

21. ELEVATIONS (Show whether DF, RT, GR, etc.)

3950 GL

22. APPROX. DATE WORK WILL START*

July 10, 1985

23. PROPOSED CASING AND CEMENTING PROGRAM

SIZE OF HOLE	SIZE OF CASING	WEIGHT PER FOOT	SETTING DEPTH	QUANTITY OF CEMENT
17 1/2"	13 3/8"	54.5#	200'	80 Sx "C" Circ. if possible
10 3/4"	8 5/8"	24.0#	1100'	500 Sx "C" Circulate
7 7/8"	4 1/2"	10.5#	3600'	350 Sx

Propose to drill to approximately 3600' to test the Abo formation. If production is indicated, will run 4 1/2" casing and attempt completion.

Mud Program:

- 0' - 200' Cable Tool rig will drill and set surface casing.
- 200' - 2987' Will drill with cut brine water, no WL control.
- 2987' - 3600' Will mud up to 36 Vis., Mud Wt. 9.5#, WL 10 cc.

BOP Program: Will install 3000 psi BOP on the 8 5/8" casing and test daily.

Gas is not dedicated.

IN ABOVE SPACE DESCRIBE PROPOSED PROGRAM: If proposal is to deepen or plug back, give data on present productive zone and proposed new productive zone. If proposal is to drill or deepen directionally, give pertinent data on subsurface locations and measured and true vertical depths. Give blowout preventer program, if any.

24.

SIGNED

George L. Smith

Agent for:

TITLE McClellan Oil Corporation

DATE June 19, 1985

(This space for Federal or State office use)

PERMIT NO.

APPROVAL DATE

S/Phil Kirk

APPROVED BY

TITLE

Area Manager

DATE

6-28-85

CONDITIONS OF APPROVAL, IF ANY:

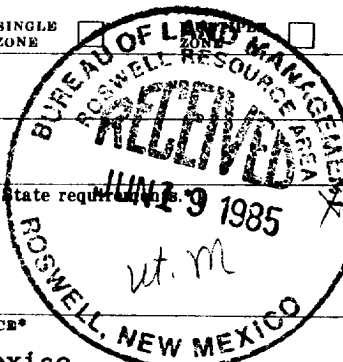

Posted ID
APT & HL
7-5-85

NEW MEXICO OIL CONSERVATION COMMISSION
WELL LOCATION AND ACREAGE DEDICATION PLAT

Form C-122
Supersedes C-128
Effective 1-1-65

All distances must be from the outer boundaries of the Section.

Operator McClellan Oil Corporation		Lease Toles Federal		Well No. 2
Unit Letter M	Section 15	Township 8 South	Range 23 East	County Chaves
Actual Footage Location of Well: 660 feet from the South line and 660 feet from the West line				
Ground Level Elev. 3950	Producing Formation Abo	Pool Pecos Slope Abo	Dedicated Acreage 160	

1. Outline the acreage dedicated to the subject well by colored pencil or hatchure marks on the plat below.
2. If more than one lease is dedicated to the well, outline each and identify the ownership thereof (both as to working interest and royalty).
3. If more than one lease of different ownership is dedicated to the well, have the interests of all owners been consolidated by communitization, unitization, force-pooling, etc?

☐ Yes ☐ No If answer is "yes," type of consolidation _____

If answer is "no," list the owners and tract descriptions which have actually been consolidated. (Use reverse side of this form if necessary.) _____

No allowable will be assigned to the well until all interests have been consolidated (by communitization, unitization, forced-pooling, or otherwise) or until a non-standard unit, eliminating such interests, has been approved by the Commission.

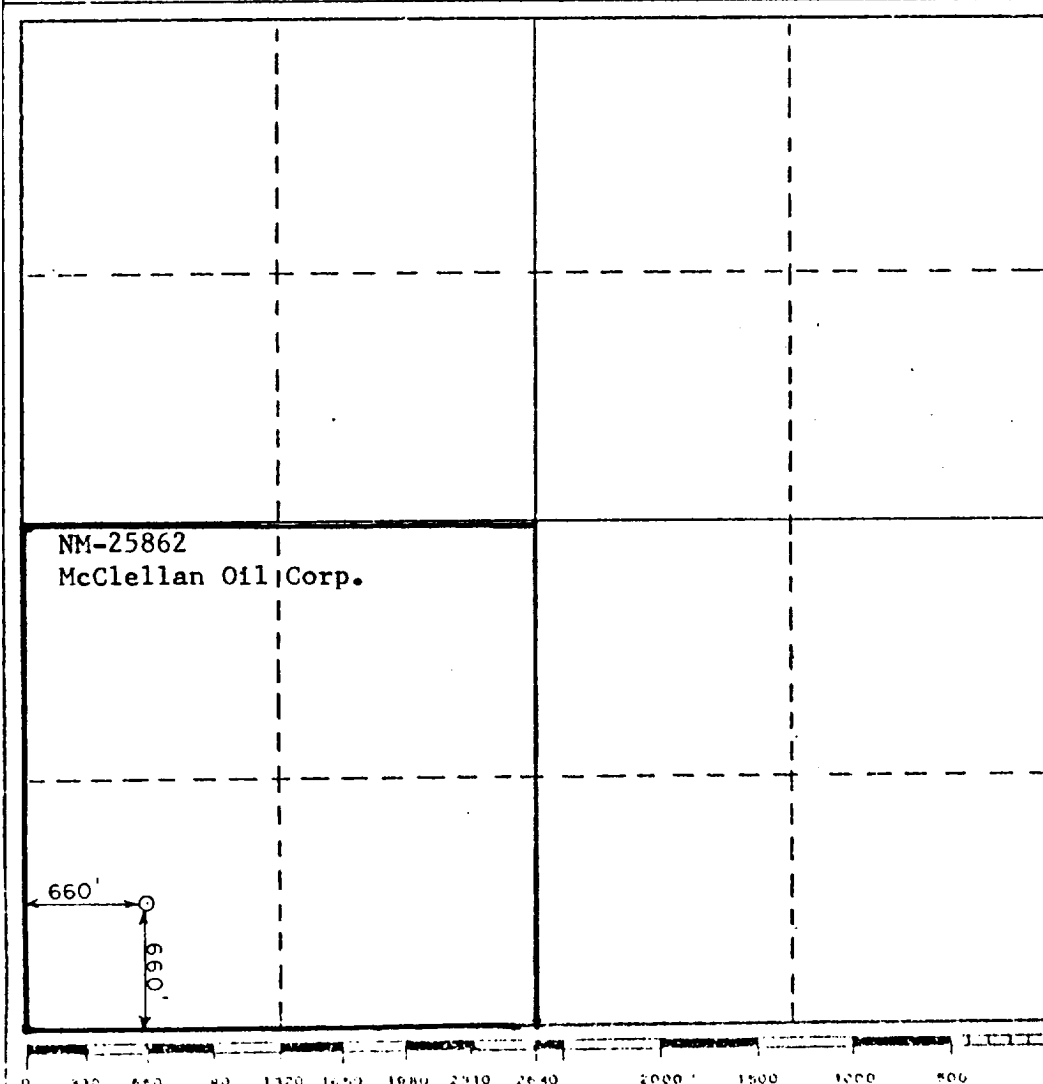

CERTIFICATION

I hereby certify that the information contained herein is true and complete to the best of my knowledge and belief.

George R. Smith

Name

George R. Smith

Position

Agent for:

Company

McClellan Oil Corporation

Date

June 19, 1985

I hereby certify that the well location shown on this plat was plotted from field notes of actual surveys made by me or under my supervision, and that the same is true and correct to the best of my knowledge and belief.

May 21, 1985

Date Surveyed

P. R. Patton

Registered Professional Engineer and/or Land Surveyor

8112

Certificate No.

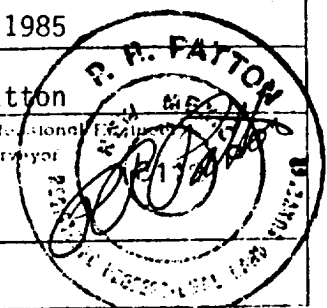

BLOWOUT PREVENTER SPECIFICATION

WEK DRILLING CO., INC. - Rig 1 & 3

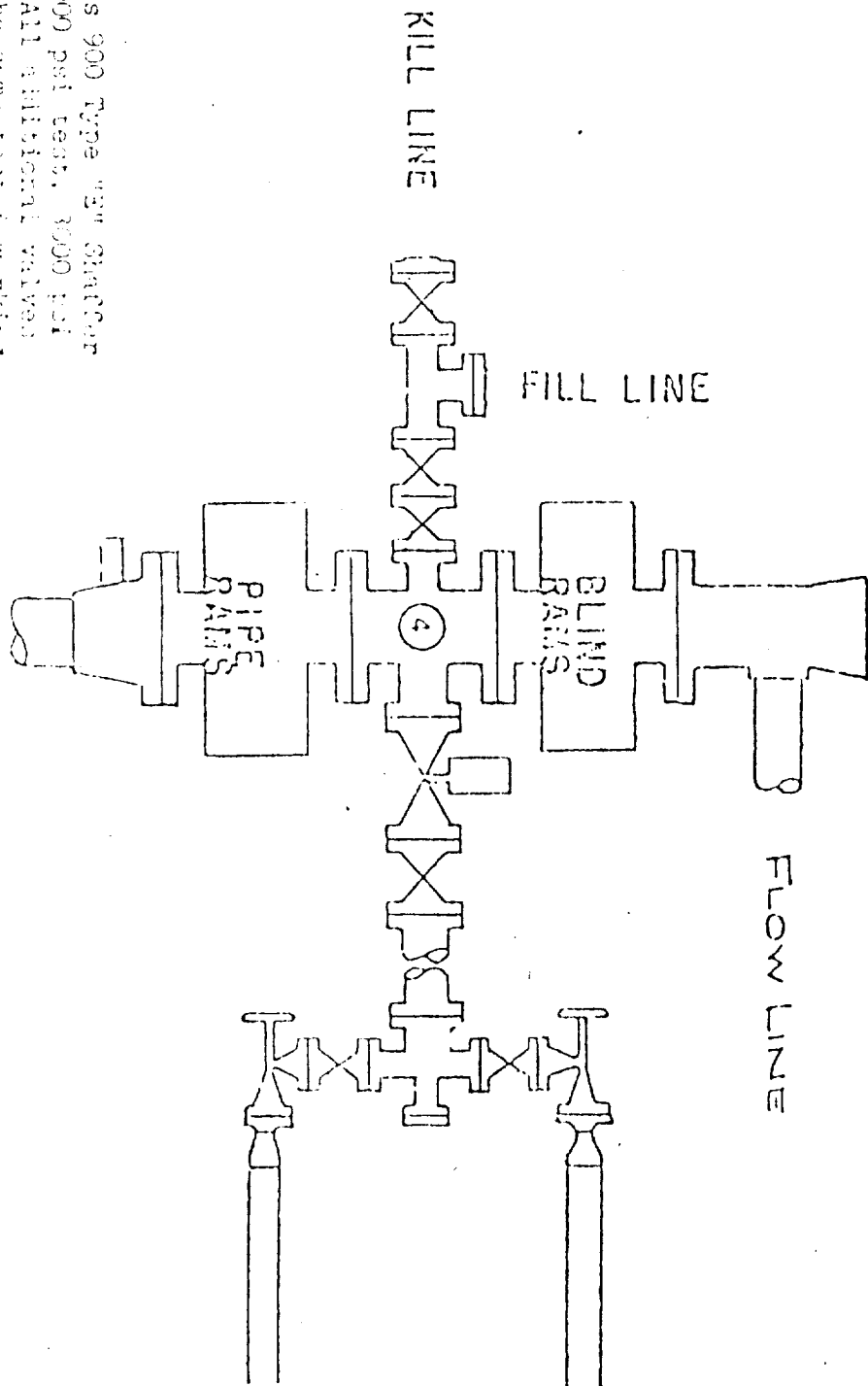

BOP's are 13" Series 900 Type "W" Shutoff
Double Hydraulic 6000 psi test, 3000 psi
working pressure. All additional valves
& connections are the same test & working
pressure.

EXHIBIT "E"
McCLELLAN OIL CORPORATION
Toles Federal, Well No. 2
BOP Specifications