

STATE OF NEW MEXICO
ENERGY AND MINERALS DEPARTMENT

OIL CONSERVATION DIVISION

Form C-101
Revised 10-1-78

NO. OF COPIES RECEIVED	
DISTRIBUTION	
SANTA FE	<input checked="" type="checkbox"/>
FILE	<input checked="" type="checkbox"/>
U.S.G.S.	<input checked="" type="checkbox"/>
LAND OFFICE	<input checked="" type="checkbox"/>
OPERATOR	<input checked="" type="checkbox"/>

SANTA FE, NEW MEXICO 87501

RECEIVED BY

AUG 30 1985

O. C. D.

ARTESIA OFFICE

5A. Indicate Type of Lease
STATE <input type="checkbox"/> FEE <input checked="" type="checkbox"/>
5. State Oil & Gas Lease No.
-

APPLICATION FOR PERMIT TO DRILL, DEEPEN, OR PLUG BACK

1a. Type of Work	7. Unit Agreement Name
b. Type of Well DRILL <input checked="" type="checkbox"/> DEEPEN <input type="checkbox"/> PLUG BACK <input type="checkbox"/> OIL WELL <input type="checkbox"/> GAS WELL <input checked="" type="checkbox"/> OTHER <input type="checkbox"/> SINGLE ZONE <input checked="" type="checkbox"/> MULTIPLE ZONE <input type="checkbox"/>	8. Farm or Lease Name Cannon
2. Name of Operator SANDERS OIL & GAS COMPANY	9. Well No. 2
3. Address of Operator 14679 Midway Road, Ste. 101 Dallas, Texas 75234	10. Field and Pool, or Wildcat South Pecos Slope-Abo
4. Location of Well UNIT LETTER <u>L</u> LOCATED <u>1780'</u> FEET FROM THE <u>South</u> LINE AND <u>660'</u> FEET FROM THE <u>West</u> LINE OF SEC. <u>27</u> TWP. <u>10S</u> RGE. <u>25E</u> NMPM	12. County Chaves
11. Elevations (show whether DF, RT, etc.) 3472' GR	19. Proposed Depth 4400'
21A. Kind & Status Plug. Bond Blanket	19A. Formation Abo
21B. Drilling Contractor Grande Drilling Corp.	20. Rotary or C.T. Rotary
22. Approx. Date Work will start September 15, 1985	

PROPOSED CASING AND CEMENT PROGRAM

SIZE OF HOLE	SIZE OF CASING	WEIGHT PER FOOT	SETTING DEPTH	SACKS OF CEMENT	EST. TOP
17-1/2"	13-3/8"	48.0#	200'	200 sx	Circulated
12-1/4"	8-5/8"	24.0#	*950 800'	400 sx	Circulated
7-7/8"	4-1/2"	9.5#	4400'	350 sx	3200'

This will be a replacement well for the Sanders Oil & Gas Company No.1-Y well. Propose to drill to 4400' to test Abo and intermediate formations.

Set 13-3/8" surface casing to 200' and circulate cement to surface.

Set about 800' of 8-5/8" casing and cement to surface to protect fresh water zone at about 600'.

Set about 4400' of 4-1/2" production casing thru productive interval and cement with about 350 sx 50-50 Poz mix to isolate all porosity zones. Perforate favorable zone, run tubing and test.

Install 3000# double-ram preventer before drilling out 8-5/8" shoe.

Gas is not dedicated.

APPROVAL VALID FOR 180 DAYS
PERMIT EXPIRES 3-4-86
UNLESS DRILLING UNDERWAY

IN ABOVE SPACE DESCRIBE PROPOSED PROGRAM; IF PROPOSAL IS TO DEEPEN OR PLUG BACK, GIVE DATA ON PRESENT PRODUCTIVE ZONE AND PROPOSED NEW PRODUCTIVE ZONE. GIVE BLOWOUT PREVENTER PROGRAM, IF ANY.

I hereby certify that the information above is true and complete to the best of my knowledge and belief.

Signed Jerry H. Long Title Agent Date August 28, 1985
(This space for State Use)

Original Signed By
Mike Williams
Oil & Gas Inspector

APPROVED BY _____ DATE SEP 4 1985

CONDITIONS OF APPROVAL, IF ANY:

* Injection Interval c N-27-10-25
15 850'-917'

Not in sufficient

ness cementing

8 5/8" casing

NEW MEXICO OIL CONSERVATION COMMISSION
WELL LOCATION AND ACREAGE DEDICATION PLAT

Form C-102
Supersedes C-128
Effective 1-1-65

All distances must be from the outer boundaries of the Section

Operator Sanders Oil & Gas			Lease Cannon		Well No. 2
Unit Letter L	Section 27	Township 10 South	Range 25 East	County Chaves	
Actual Footage Location of Well: 1780 feet from the South line and 660 feet from the West line					
Ground Level Elev. 3472	Lithology Formation Abo		Pool South Pecos Slope-Abo		Dedicated Acreage: (SW$\frac{1}{4}$) 160

- Outline the acreage dedicated to the subject well by colored pencil or hatchure marks on the plat below.
- If more than one lease is dedicated to the well, outline each and identify the ownership thereof (both as to working interest and royalty). SINGLE LEASE
- If more than one lease of different ownership is dedicated to the well, have the interests of all owners been consolidated by communitization, unitization, force-pooling, etc?

☐ Yes ☐ No If answer is "yes," type of consolidation _____

If answer is "no," list the owners and tract descriptions which have actually been consolidated. (Use reverse side of this form if necessary.) _____

No allowable will be assigned to the well until all interests have been consolidated (by communitization, unitization, forced-pooling, or otherwise) or until a non-standard unit, eliminating such interests, has been approved by the Commission.

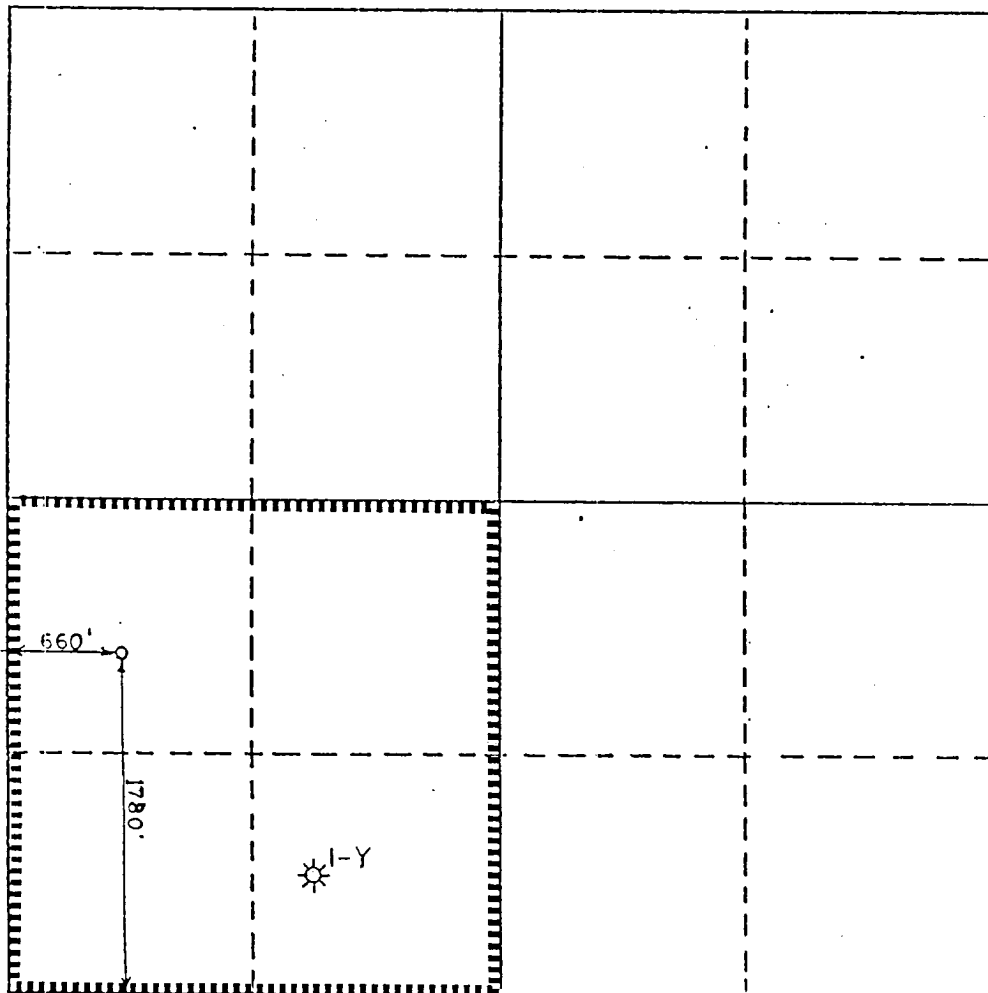

CERTIFICATION

I hereby certify that the information contained herein is true and complete to the best of my knowledge and belief.

Name

JERRY W. LONG

Position

Agent

Company

SANDERS OIL & GAS COMPANY

Date

August 28, 1985

I hereby certify that the well location shown on this plat was plotted from field notes of actual surveys made by me or under my supervision, and that the same is true and correct to the best of my knowledge and belief.

28 August 85

Date Surveyed

P.R. Patton

Registered Professional Surveyor and/or Land Surveyor

8112

Certificate No.

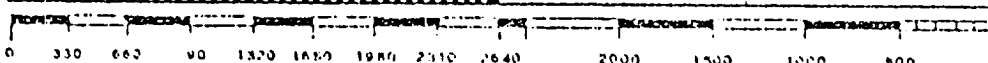
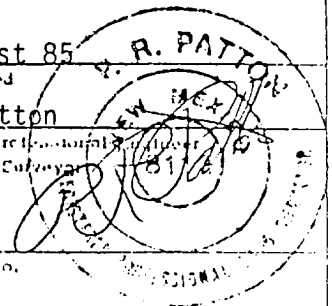

SANDERS OIL & GAS COMPANY
 No.2 Cannon
 1780' FSL 660' FWL Sec.27-10S-25E
 Chaves County, N.M.

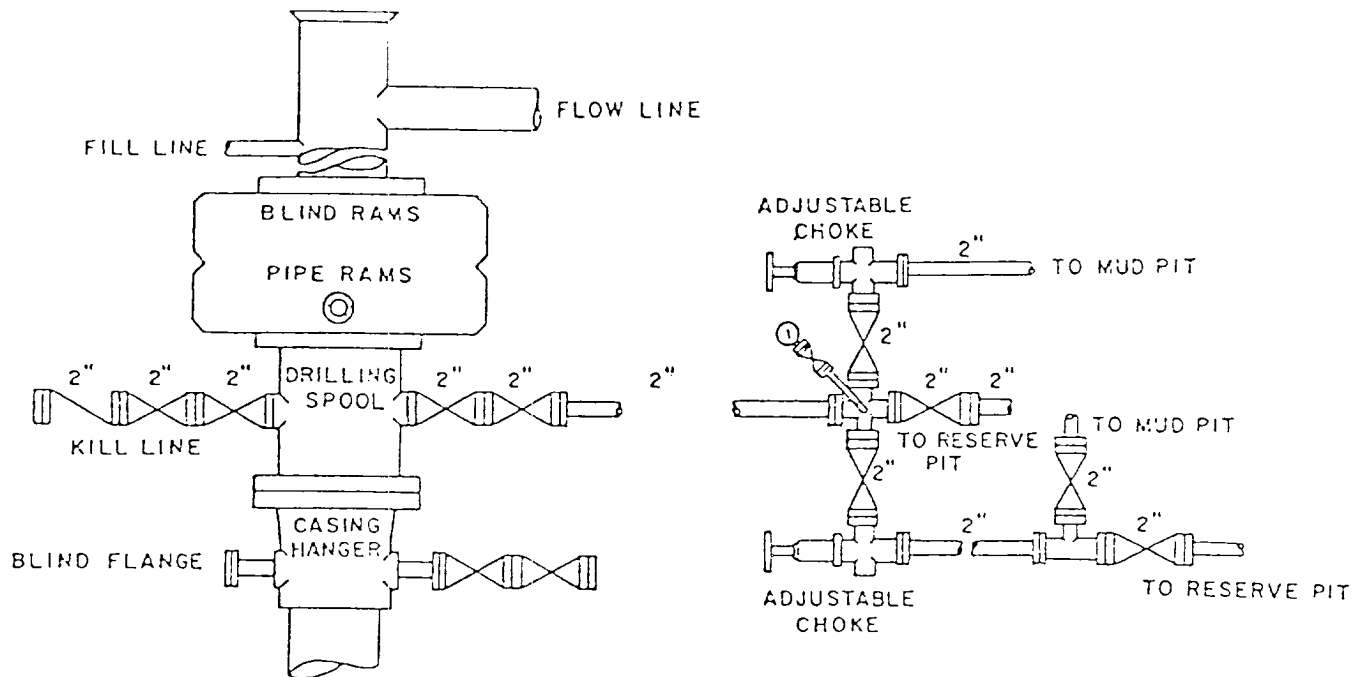

BOP DIAGRAM

3000# Working Pressure
 Rams Operated Daily

SANDERS OIL & GAS COMPANY

No.2 Cannon
NW $\frac{1}{4}$ SW $\frac{1}{4}$ Sec.27-10S-25E
Chaves County, N.M.

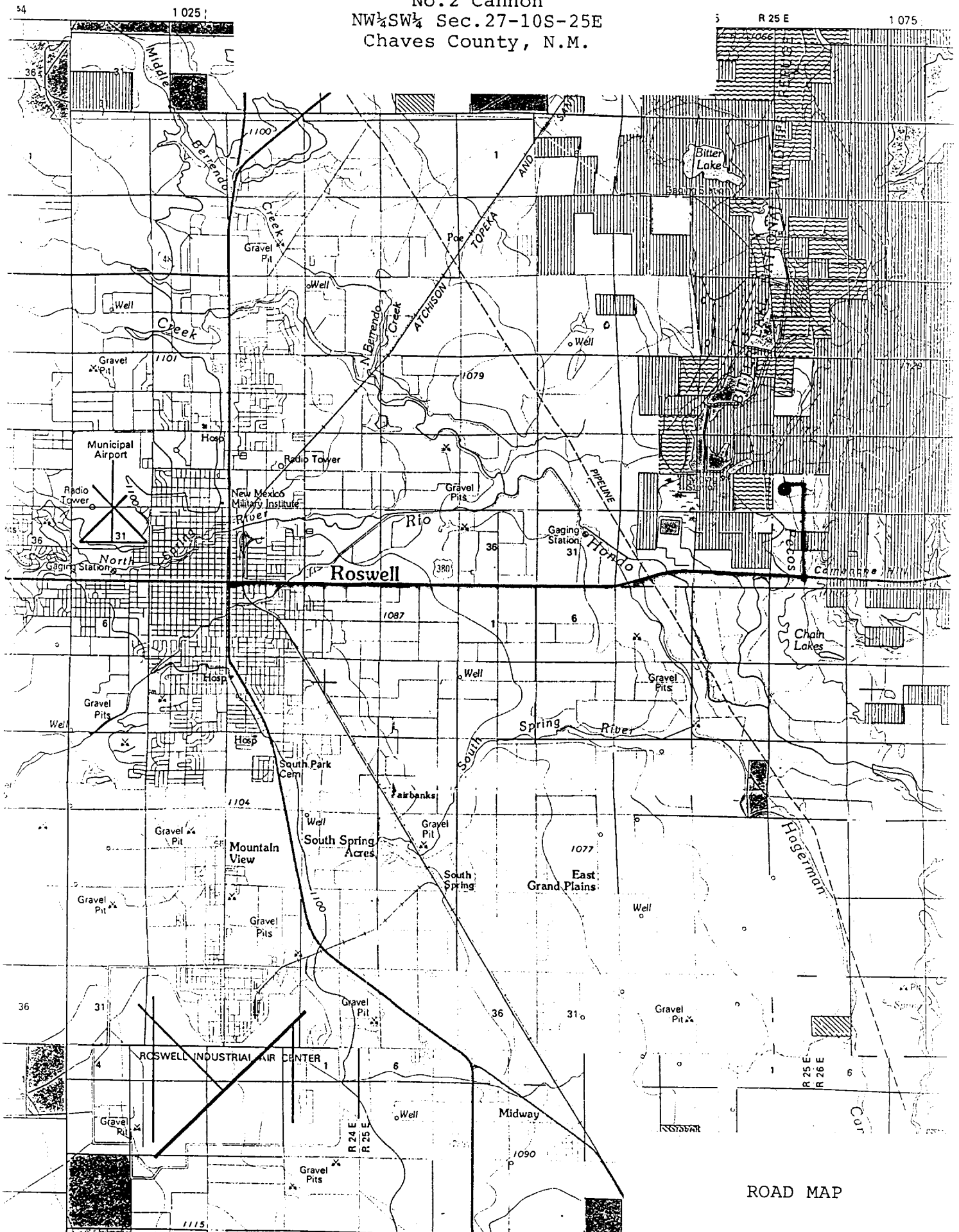

ROAD MAP