

45F.

N. 10-10-1987  
Formerly 9-3310

UNITED STATES DEPARTMENT OF THE INTERIOR  
BUREAU OF LAND MANAGEMENT  
Altesia, NM 88210

Expires August 1, 1988  
5. LEASE DESIGNATION AND SERIAL  
NM-36194  
6. IF INDIAN, ALLOTTEE OR TRIBE NAME

SUNDRY NOTICES AND REPORTS ON WELLS

(Do not use this form for proposals to drill or to deepen or plug back to a different reservoir.  
Use "APPLICATION FOR PERMIT" for such proposals.)

1. ☐ OIL WELL ☐ GAS WELL ☒ OTHER

2. NAME OF OPERATOR  
McKay Oil Corporation

3. ADDRESS OF OPERATOR  
P.O. Box 2014, Roswell, New Mexico 88202

4. LOCATION OF WELL (Report location clearly and in accordance with any State requirements.  
See also space 17 below.)  
At surface  
660'FNL & 1780'FWL

14. PERMIT NO.  
15. ELEVATIONS (Show whether DF, RT, GR, etc.)  
4291'GL

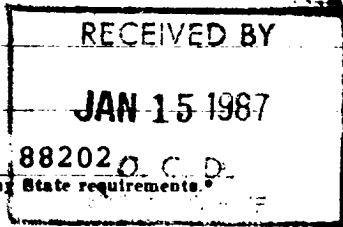

7. UNIT AGREEMENT NAME

8. FARM OR LEASE NAME  
S. Four Mile Draw Fed.

9. WELL NO.  
1

10. FIELD AND POOL, OR WILDCAT  
W. Pecos Slope Abo

11. SEC., T., R., M., OR BLK. AND SUBSTY OR AREA  
Sec. 22-6S-22E

12. COUNTY OR PARISH  
Chaves

13. STATE  
NM

16. Check Appropriate Box To Indicate Nature of Notice, Report, or Other Data

NOTICE OF INTENTION TO:		SUBSEQUENT REPORT OF:	
TEST WATER SHUT-OFF	<input type="checkbox"/>	WATER SHUT-OFF	<input type="checkbox"/>
FRACURE TREAT	<input type="checkbox"/>	FRACURE TREATMENT	<input type="checkbox"/>
SHOOT OR ACIDIZE	<input type="checkbox"/>	SHOOTING OR ACIDIZING	<input type="checkbox"/>
REPAIR WELL	<input type="checkbox"/>	(Other)	<input type="checkbox"/>
FILL OR ALTER CASING	<input type="checkbox"/>	REPAIRING WELL	<input type="checkbox"/>
MULTIPLE COMPLETE	<input type="checkbox"/>	ALTERING CASING	<input type="checkbox"/>
ABANDON*	<input type="checkbox"/>	ABANDONMENT*	<input type="checkbox"/>
CHANGE PLANS	<input type="checkbox"/>		

17. DESCRIBE PROPOSED OR COMPLETED OPERATIONS: (Clearly state all pertinent details and give pertinent dates, including estimated date of starting any proposed work. If well is directionally drilled, give subsurface locations and measured and true vertical depths for all markers and zones pertinent to this work.)

Pipeline Connection X

Operator proposes to lay a 6" and 2" steel pipeline along the route and as shown on Exhibit A. The pipeline will be buried a minimum of 12", except for the areas circled in red.

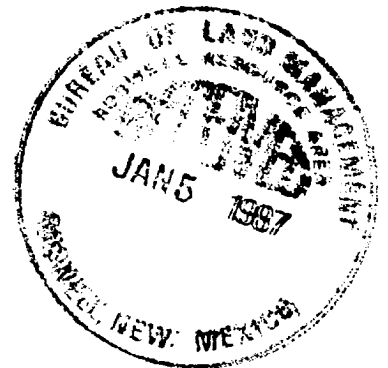

18. I hereby certify that the foregoing is true and correct

SIGNED Jim Schubert TITLE Landman DATE 1-5-86

(This space for Federal or State office use)

APPROVED BY [Signature] TITLE Area Manager DATE JAN 13 1987

CONDITIONS OF APPROVAL, IF ANY: THIS AUTHORIZATION IS GIVEN SUBJECT TO THE CONDITION THAT ALL OR PART OF IT MIGHT BE CONVERTED TO A RIGHT-OF-WAY GRANT IN THE FUTURE. ATTACHED ARE TWO PAGES OF STIPULATIONS WHICH ALSO APPLY TO THIS SUNDRY.

\*See Instructions on Reverse Side

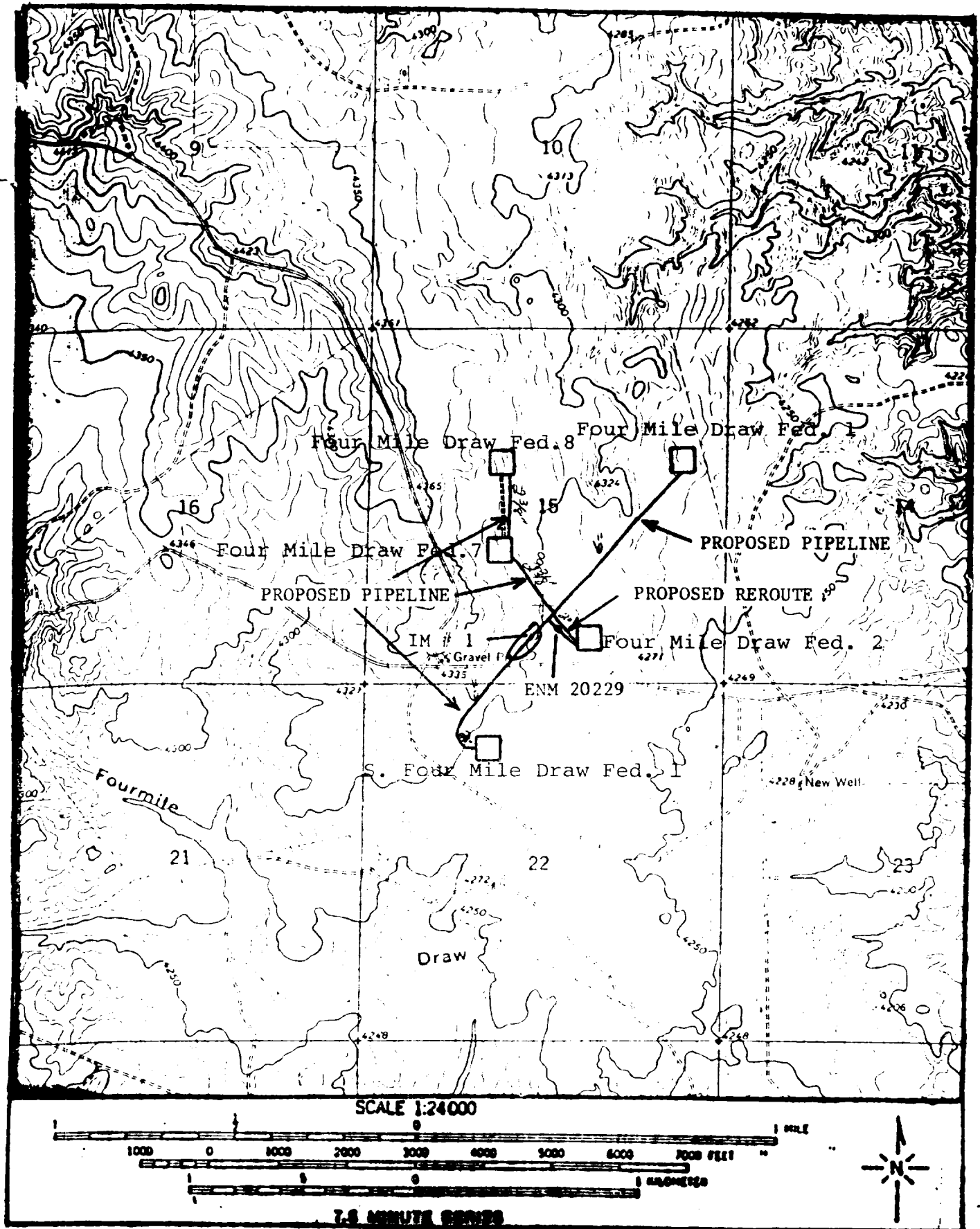

Exhibit A