

NO. OF COPIES RECEIVED	
DISTRIBUTION	
SANTA FE	<input checked="" type="checkbox"/>
FILL	<input checked="" type="checkbox"/>
U.S.G.S.	<input checked="" type="checkbox"/>
LAND OFFICE	<input checked="" type="checkbox"/>
OPERATION	<input checked="" type="checkbox"/>

5A. Indicate Type of Lease
STATE ☐ FEE ☒
5. State Oil & Gas Lease No.

APPLICATION FOR PERMIT TO DRILL, DEEPEN, OR PLUG BACK

1. Type of Work a. Type of Well OIL WELL <input checked="" type="checkbox"/> GAS WELL <input type="checkbox"/> OTHER <input type="checkbox"/> b. Type of Well DRILL <input checked="" type="checkbox"/> DEEPEN <input type="checkbox"/> PLUG BACK <input type="checkbox"/> SINGLE ZONE <input checked="" type="checkbox"/> MULTIPLE ZONE <input type="checkbox"/>		7. Unit Agreement Name
2. Name of Operator Cibola Energy Corporation		8. Farm or Lease Name CX Plains
3. Address of Operator P.O. Box 1668, Albuquerque, N.M. 87103		9. Well No. 18
4. Location of Well UNIT LETTER 2310 J LOCATED 2310 FEET FROM THE South LINE AND 1650 FEET FROM THE East LINE OF SEC. 19 TWP. 10S RGE. 28E NMPM		10. Field and Pool, or Wildcat Race Track San Andres
11. Elevations (Show whether DT, RL, etc.) 3759.3		12. County Chaves
19. Proposed Depth 2300'	19A. Formation San Andres	20. Rotary or C.T. <input checked="" type="checkbox"/> Rotary
21A. Kind & Status Plug. Bond One Well	21B. Drilling Contractor Salazar	22. Approx. Date Work will start 2-20-86

PROPOSED CASING AND CEMENT PROGRAM

SIZE OF HOLE	SIZE OF CASING	WEIGHT PER FOOT	SETTING DEPTH	SACKS OF CEMENT	EST. TOP
12 1/4"	7 5/8"	23#	300'	200 5x Class C	Surface
6 3/8"	4 1/2"	9.5#	2300'	90 5x self stress	1600'

We plan to drill a 12 1/4" hole to 300' and set 7 5/8" casing with 200 5x Class C cement circulated to surface. WOC 18 hrs
A 6 3/8" hole will then be drilled to 2300' where 4 1/2" casing will be set depending on the outcome of the logs. Post ID 2-21-86
A deviation survey will be run. NWC-4 APZ

APPROVAL VALID FOR 180 DAYS
PERMIT EXPIRES 8-19-86
UNLESS DRILLING UNDERWAY

IN ABOVE SPACE DESCRIBE PROPOSED PROGRAM; IF PROPOSAL IS TO DEEPEN OR PLUG BACK, GIVE DATA ON PRESENT PRODUCTIVE ZONE AND PROPOSED NEW PRODUCTIVE ZONE. GIVE BLOWOUT PREVENTER PROGRAM, IF ANY.

I hereby certify that the information above is true and complete to the best of my knowledge and belief.

Signed Harold Roper Title Drilling Secretary Date 2/19/86
(This space for State Use)

APPROVED BY Les A. Clements Original Signed By
Supervisor District 11 DATE FEB 19 1986

CONDITIONS OF APPROVAL, IF ANY: Supervisor District 11

MEXICO OIL CONSERVATION COMMISSION
WELL LOCATION AND ACREAGE DEDICATION PLAT

Form C-102
 Supersedes C-128
 Effective 1-1-65

All distances must be from the outer boundaries of the Section.

Operator CIBOLA ENERGY CORP.			Lease CX PLAINS		Well No. 18
Tract Letter J	Section 19	Township 10 SOUTH	Range 28 EAST	County CHAVES	
Actual Footage Location of Well: 2310 feet from the SOUTH line and 1650 feet from the EAST line					
Ground Level Elev. 3759.3'	Producing Formation San Andres		Pool Race Track San Andres	Dedicated Acreage: 40 Acres	

1. Outline the acreage dedicated to the subject well by colored pencil or hachure marks on the plat below.
2. If more than one lease is dedicated to the well, outline each and identify the ownership thereof (both as to working interest and royalty).
3. If more than one lease of different ownership is dedicated to the well, have the interests of all owners been consolidated by communitization, unitization, force-pooling, etc?

☐ Yes ☐ No If answer is "yes," type of consolidation _____

If answer is "no," list the owners and tract descriptions which have actually been consolidated. (Use reverse side of this form if necessary.) _____

No allowable will be assigned to the well until all interests have been consolidated (by communitization, unitization, forced-pooling, or otherwise) or until a non-standard unit, eliminating such interests, has been approved by the Commission.

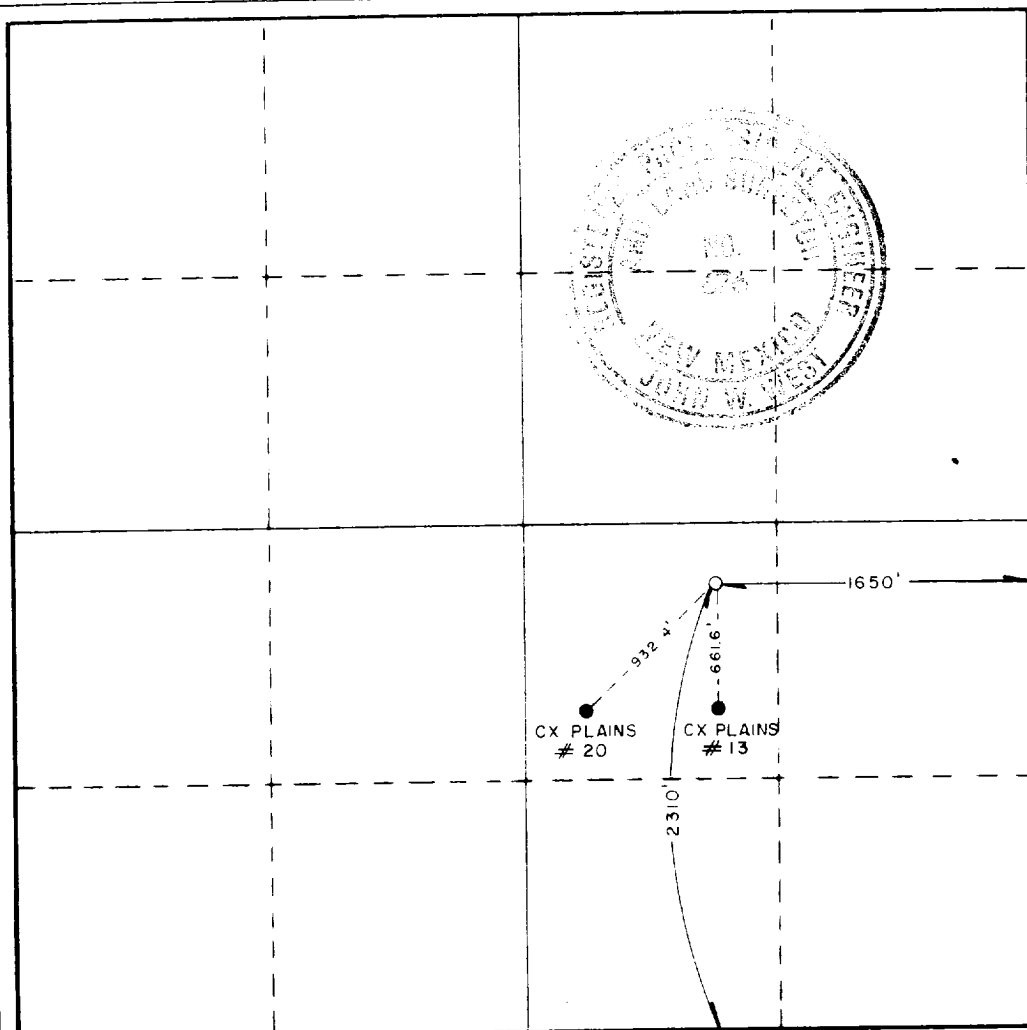

CERTIFICATION

I hereby certify that the information contained herein is true and complete to the best of my knowledge and belief.

Karen Azar
 Name

Karen Azar

Position
Drlg. Sec.

Company
Cibola Energy Corp.

Date
2-19-86

I hereby certify that the well location shown on this plat was plotted from field notes of actual surveys made by me or under my supervision, and that the same is true and correct to the best of my knowledge and belief.

Date Surveyed
FEBRUARY 13, 1986

Registered Professional Engineer
 and/or Land Surveyor

Ronald J. Eidson
 Certificate No. **JOHN W. WEST, 676**

RONALD J. EIDSON, 3239