

SUBMIT IN TRIPPLICATE*
(Other instructions on reverse side)

Form approved.
Budget Bureau No. 42-R1425.

UNITED STATES
DEPARTMENT OF THE INTERIOR
GEOLOGICAL SURVEY

APPLICATION FOR PERMIT TO DRILL, DEEPEN, OR PLUG BACK

1a. TYPE OF WORK

DRILL ☒

DEEPEN ☐

PLUG BACK ☐

b. TYPE OF WELL

OIL WELL ☐

GAS WELL ☒

OTHER

SINGLE ZONE ☒

MULTIPLE ZONE ☐

2. NAME OF OPERATOR

McKay Oil Corporation

3. ADDRESS OF OPERATOR

P.O. Box 2014, Roswell, New Mexico 88202

4. LOCATION OF WELL (Report location clearly and in accordance with any State requirements)
At surface

741'FWL & 1755'FNL

At proposed prod. zone

same

14. DISTANCE IN MILES AND DIRECTION FROM NEAREST TOWN OR POST OFFICE*

Approx. 23 miles North of Roswell, New Mexico

15. DISTANCE FROM PROPOSED*

LOCATION TO NEAREST

PROPERTY OR LEASE LINE, FT.

(Also to nearest drlg. unit line, if any)

741'

18. DISTANCE FROM PROPOSED LOCATION*

TO NEAREST WELL, DRILLING, COMPLETED,
OR APPLIED FOR, ON THIS LEASE, FT.

1 1/4 mile

16. NO. OF ACRES IN LEASE

17. NO. OF ACRES ASSIGNED
TO THIS WELL

160

19. PROPOSED DEPTH

3400'

20. ROTARY OR CABLE TOOLS.

Rotary

21. ELEVATIONS (Show whether DF, RT, GR, etc.)

4074'GL

22. APPROX. DATE WORK WILL START*

ASAP

23.

PROPOSED CASING AND CEMENTING PROGRAM

SIZE OF HOLE	SIZE OF CASING	WEIGHT PER FOOT	SETTING DEPTH	QUANTITY OF CEMENT
12 1/4"	8 5/8"	24.0 J-55	900' ±	850 cf cement circulated
7 7/8"	4 1/2"	10.5 J-55	TD	1200cf cement including 480 cf to tie in 4 1/2" to 8 5/8" from 1500' to 800'.

We propose to drill and test the Abo formation. Approximately 900' of surface casing will be set and cemented to surface. If commercial, 4 1/2" production casing will be run and cemented with adequate cover, perforated and stimulated as needed for production.

MUD PROGRAM: See Supplemental Drilling Data which is attached.

BOP PROGRAM: BOP will be installed on 8 5/8" casing and tested daily.

Gas is not dedicated.

Posted ID-1
NL API
4-4-86

IN ABOVE SPACE DESCRIBE PROPOSED PROGRAM: If proposal is to deepen or plug back, give data on present productive zone and proposed new productive zone. If proposal is to drill or deepen directionally, give pertinent data on subsurface locations and measured and true vertical depths. Give blowout preventer program, if any.

24.

SIGNED

James L. Shultz

TITLE Landman

DATE 3-12-86

(This space for Federal or State office use)

PERMIT NO.

APPROVAL DATE

S/Homer Meyer, Acting

Area Manager

APPROVED BY

TITLE

DATE

3-26-86

CONDITIONS OF APPROVAL, IF ANY:

All distances must be from the outer boundaries of the Section.

Operator McKay Oil Corp.			Lease China Draw Federal Comm.		Well No. #5
Unit Listed E	Section 30	Township 6 South	Range 23 East	County Chaves	
Actual Footage Location of Well 1755 feet from the North line and 741 feet from the West line					
Ground Level Elev. 4074	Producing Formation Abo		Pool W. Pecos Slope Abo		Dedicated Acreage 160

1. Outline the acreage dedicated to the subject well by colored pencil or hatchure marks on the plat below.
 2. If more than one lease is dedicated to the well, outline each and identify the ownership thereof (both as to work interest and royalty).
 3. If more than one lease of different ownership is dedicated to the well, have the interests of all owners been consolidated by communization, unitization, force-pooling, etc?
- ☐ Yes ☒ No - If answer is "yes," type of consolidation _____

If answer is "no," list the owners and tract descriptions which have actually been consolidated. (Use reverse side this form if necessary.) _____

No allowable will be assigned to the well until all interests have been consolidated (by communization, unitization, forced-pooling, or otherwise) or until a non-standard unit, eliminating such interests, has been approved by the Division.

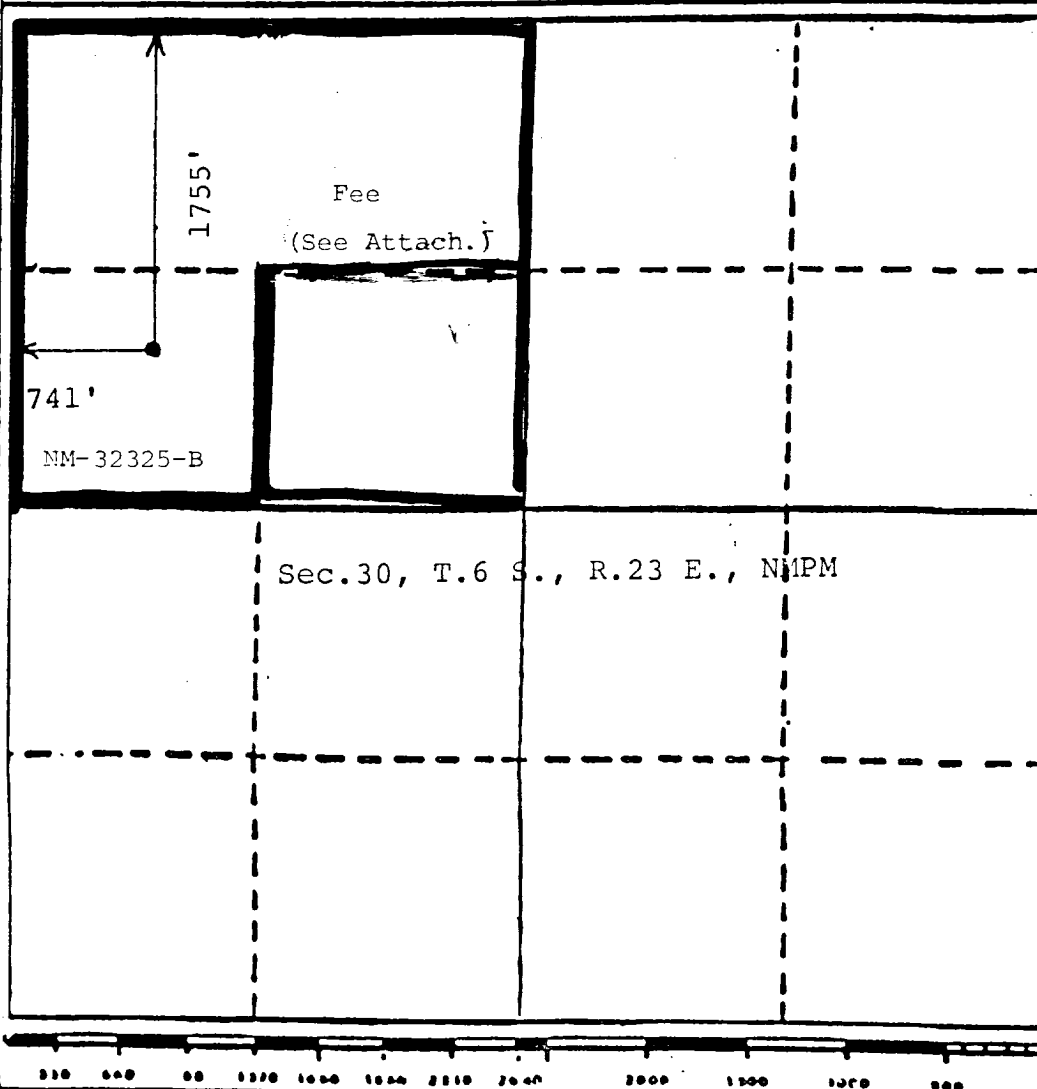

CERTIFICATION

I hereby certify that the information contained herein is true and complete to the best of my knowledge and belief.

James L. Schultz
Name

James L. Schultz

Position
Landman

Company
McKay Oil Corporation

Date
3-12-86

I hereby certify that the well location shown on this plat was plotted from field notes of actual surveys made by me or under my supervision, and that the same is true and correct to the best of my knowledge and belief.

John D. Jaques
Date Surveyed
2/26/86
Registered Professional Landman and/or Licensed Surveyor
John D. Jaques, P.E. & L.
Certification No.
6290

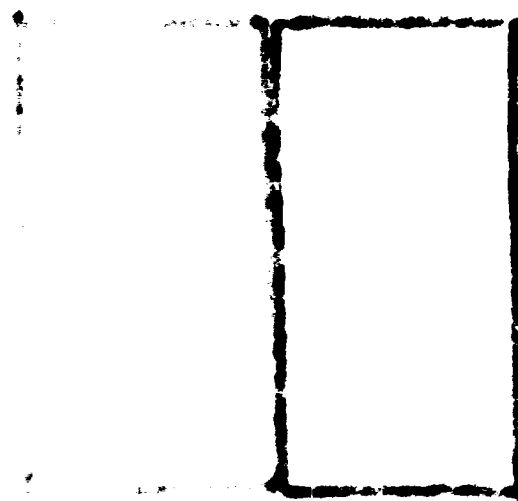

MCKAY OIL CORPORATION
China Draw Fed. Comm. #5
SW/4NW/4 Sec. 30-6S-23E
Chaves County, New Mexico

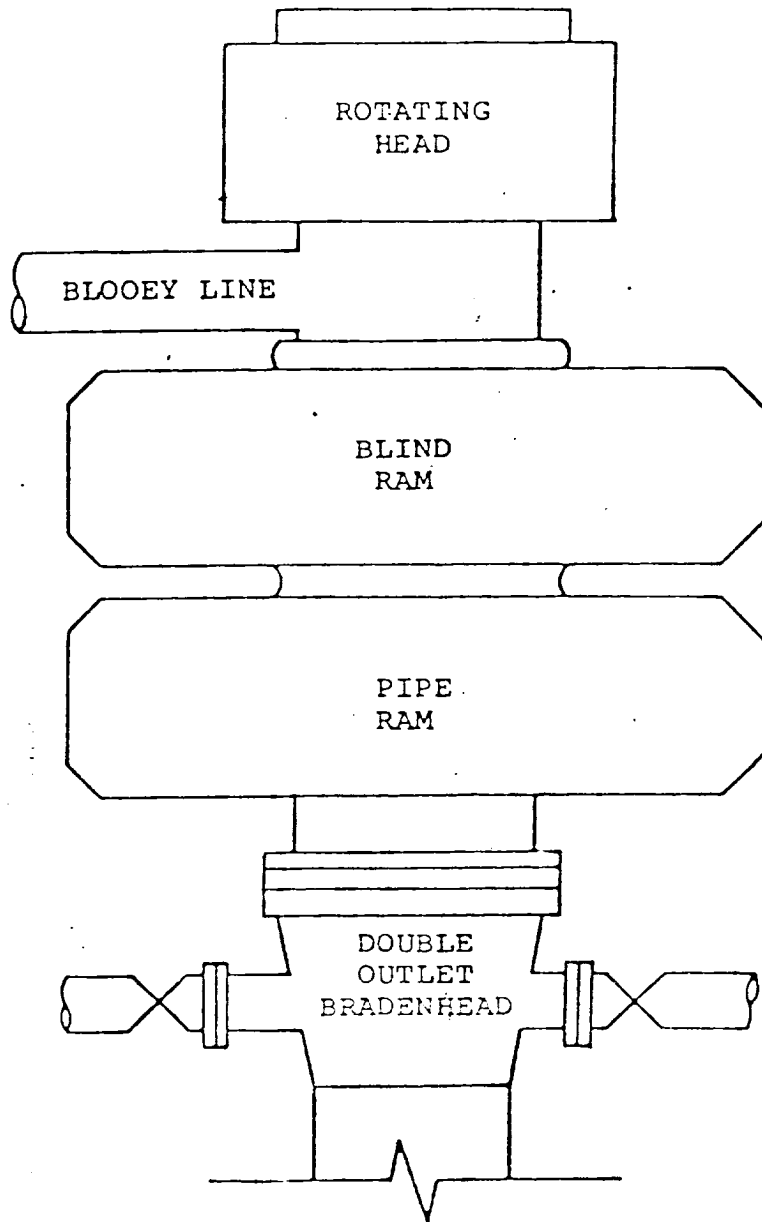

BOP STACK

3000 PSI WORKING PRESSURE

[illegible]

MCKAY OIL CORPORATION
 China Draw Fed. Comm. #5
 SW/4NW/4 Sec. 30-6S-23E
 Chaves County, New Mexico

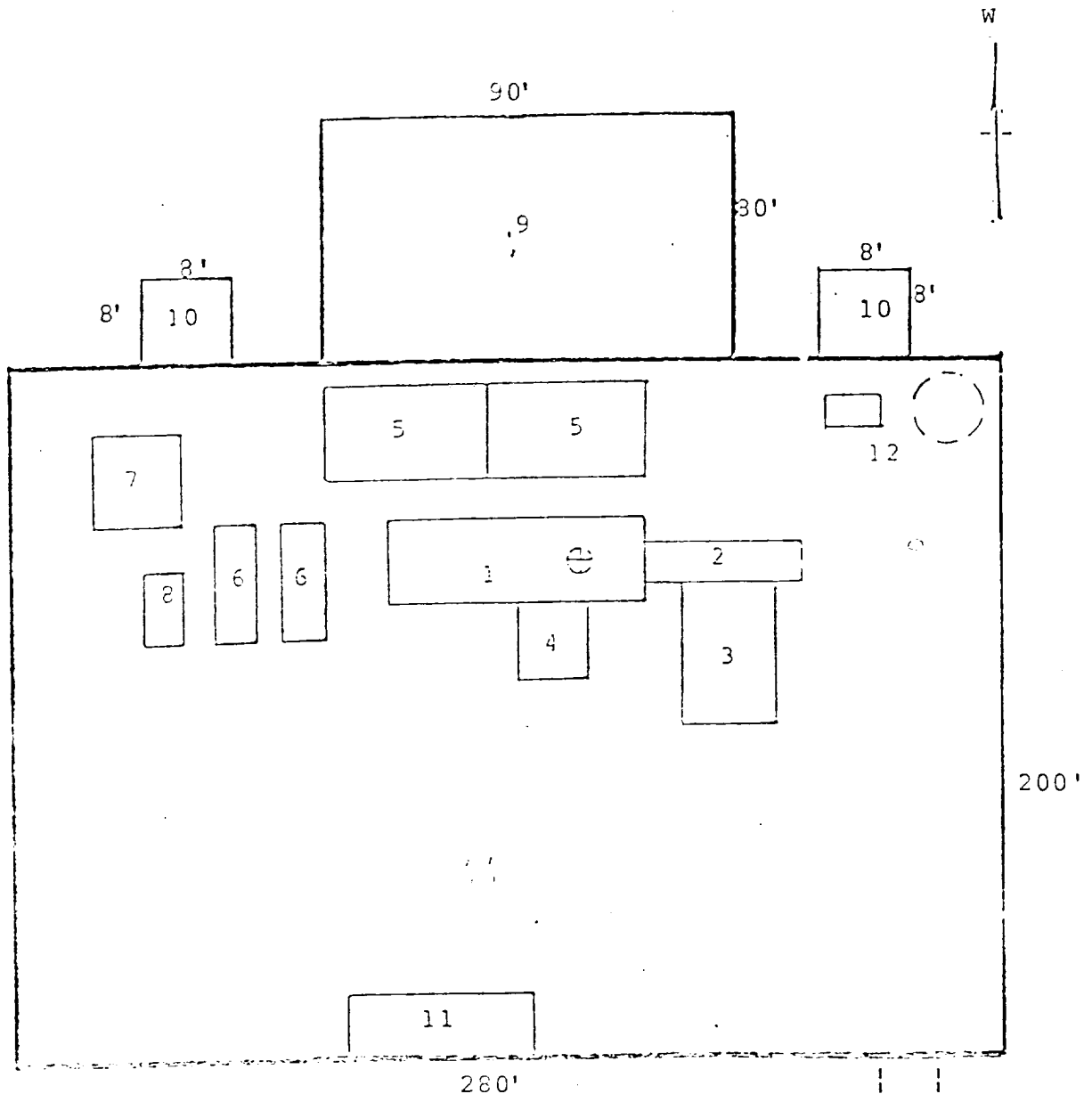

RIG LAYOUT

- | | |
|-----------------|---------------------------|
| 1. Substructure | 7. Water Tank |
| 2. Catwalk | 8. Light Plant |
| 3. Pipe Rack | 9. Reserve Pit |
| 4. Doghouse | 10. Trash Pit |
| 5. Mud Pits | 11. Trailer House |
| 6. Mud Pumps | 12. Production Facilities |

Access Road