

Form 3160-3
(July 1992)

Drawer DD

Artesia, NM 88210

SUBMIT IN TRIPLICATE
(Other instructions on
reverse side)

30-015-62326-154

Expires: February

UNITED STATES
DEPARTMENT OF THE INTERIOR
BUREAU OF LAND MANAGEMENT

APPLICATION FOR PERMIT TO DRILL OR DEEPEN

1a. TYPE OF WORK
DRILL ☐ RE-ENTER DEEPEN ☒

b. TYPE OF WELL
OIL WELL ☐ GAS WELL ☒ OTHER ☐ SINGLE ZONE ☐ MULTIPLE ZONE ☐

2. NAME OF OPERATOR
Yates Petroleum Corporation

3. ADDRESS AND TELEPHONE NO.
105 South Fourth Street, Artesia, NM 88210 505-748-1471

4. LOCATION OF WELL (Report location clearly and in accordance with any State requirements)
At surface
Unit Letter M; 660' FSL & 660' FWL
At proposed prod. zone
Same

14. DISTANCE IN MILES AND DIRECTION FROM NEAREST TOWN OR POST OFFICE
Approximately 19 miles East of Roswell, NM

15. DISTANCE FROM PROPOSED LOCATION TO NEAREST PROPERTY OR LEASE LINE, FT.
(Also to nearest drlg. unit line, if any)
660'

16. NO. OF ACRES IN LEASE
1240

17. NO. OF ACRES ASSIGNED TO THIS WELL
320

18. DISTANCE FROM PROPOSED LOCATION TO NEAREST WELL, DRILLING, COMPLETED, OR APPLIED FOR, ON THIS LEASE, FT.

19. PROPOSED DEPTH
6500'

20. ROTARY OR CABLE TOOLS
Rotary

21. ELEVATIONS (Show whether DF, RT, GR, etc.)
3880.6' Gr,

22. APPROX. DATE WORK WILL START
ASAP

PROPOSED CASING AND CEMENTING PROGRAM

SIZE OF HOLE	GRADE SIZE OF CASING	WEIGHT PER FOOT	SETTING DEPTH	QUANTITY OF CEMENT
12.25"	8.625"	24#	1145' - Inplace	600 Sx
7.875"	5 X 5.50"	10.50#	TD	950 Sx

Yates Petroleum Corporation proposes to re-enter this well drilling out the plugs to the original TD of 5000' and then deepen the well bore to a new TD of 6500' and test the Pre-Cambrian formation. If commercial will run production string, cement, perforate and stimulate as needed for production.

MUD PROGRAM: 0 to 5000' with SW Gel/Starch; 5000' to TD with Brine/MF-55/XC- D/Starch.

BOPE PROGRAM: BOPE will be installed on the 8.625" casing and tested daily for operation.

GAS NOT DEDICATED

PLEASE BE ADVISED THAT THERE WILL BE NO EXCAVATION
OF FEDERALLY OWNED MINERAL MATERIAL FOR CONSTRUCTION
OF THE ACCESS ROAD OR PAD WITHOUT PAYMENT
IN ADVANCE.

Post ID-1
6-17-94
Re-entry

IN ABOVE SPACE DESCRIBE PROPOSED PROGRAM: If proposal is to deepen, give data on present productive zone and proposed new productive zone. If proposal is to drill or deepen directionally, give pertinent data on subsurface locations and measured and true vertical depths. Give blowout preventer program, if any.

24. SIGNED Christa R. May TITLE Permit Agent DATE 5-6-94
(This space for Federal or State office use)

PERMIT NO. _____ APPROVAL DATE _____

Application approval does not warrant or certify that the applicant holds legal or equitable title to those rights in the subject lease which would entitle the applicant to conduct operations thereon.
CONDITIONS OF APPROVAL, IF ANY:

APPROVED BY A.T. Kreagen TITLE Acting Area Manager DATE MAY 27 1994

*See Instructions On Reverse Side

District I
PO Box 1980, Hobbs, NM 88241-1980
District II
PO Drawer DD, Artesia, NM 88211-0719
District III
1000 Rio Brazos Rd., Aztec, NM 87410
District IV
PO Box 2088, Santa Fe, NM 87504-2088

State of New Mexico
Energy, Minerals & Natural Resources Department

OIL CONSERVATION DIVISION
PO Box 2088
Santa Fe, NM 87504-2088

Form C-102
Revised February 10, 1994
Instructions on back
Submit to Appropriate District Office
State Lease - 4 Copies
Fee Lease - 3 Copies

☐ AMENDED REPORT

WELL LOCATION AND ACREAGE DEDICATION PLAT

¹ API Number 30-005-62326		² Pool Code PRE CAMBRIAN		³ Pool Name WILCAT PRE CAMBRIAN	
⁴ Property Code		⁵ Property Name Martin "ADW" Federal			⁶ Well Number 1
⁷ OGRID No.		⁸ Operator Name Yates Petroleum Corporation			⁹ Elevation 3880.6

¹⁰ Surface Location

UL or lot no.	Section	Township	Range	Lot Idn	Feet from the	North/South line	Feet from the	East/West line	County
---------------	---------	----------	-------	---------	---------------	------------------	---------------	----------------	--------

¹¹ Bottom Hole Location If Different From Surface

UL or lot no.	Section	Township	Range	Lot Idn	Feet from the	North/South line	Feet from the	East/West line	County
---------------	---------	----------	-------	---------	---------------	------------------	---------------	----------------	--------

¹² Dedicated Acres 320	¹³ Joint or Infill	¹⁴ Consolidation Code	¹⁵ Order No.
--------------------------------------	-------------------------------	----------------------------------	-------------------------

NO ALLOWABLE WILL BE ASSIGNED TO THIS COMPLETION UNTIL ALL INTERESTS HAVE BEEN CONSOLIDATED
OR A NON-STANDARD UNIT HAS BEEN APPROVED BY THE DIVISION

<div data-bbox="138 1064 503 1436"></div>					¹⁷ OPERATOR CERTIFICATION I hereby certify that the information contained herein is true and complete to the best of my knowledge and belief Signature <u>Clifton R. May</u> Clifton R. May Printed Name Permit Agent Title 5-6-94 Date	
					¹⁸ SURVEYOR CERTIFICATION I hereby certify that the well location shown on this plat was plotted from field notes of actual surveys made by me or under my supervision, and that the same is true and correct to the best of my belief. REFER TO ORIGINAL PLAT Date of Survey Signature and Seal of Professional Surveyer: Certificate Number	
16						
NM-27790 660-0 660						

All wells must be from the outer boundaries of the Res.

Operator Yates Petroleum Corporation		Lease Martin "ADW" Federal		Well No. #1
Unit Letter M	Section 34	Township 8 South	Range 26 East	County Chavez County
Actual Footage Location of Well: 660 feet from the South line and 660 feet from the West line				
Ground Level Elev. 3880.6	Producing Formation		Pool	Dedicated Acreage: Acres

1. Outline the acreage dedicated to the subject well by colored pencil or hachure marks on the plat below.
2. If more than one lease is dedicated to the well, outline each and identify the ownership thereof (both as to working interest and royalty).
3. If more than one lease of different ownership is dedicated to the well, have the interests of all owners been consolidated by communitization, unitization, force-pooling, etc?

☐ Yes ☐ No If answer is "yes," type of consolidation _____

If answer is "no," list the owners and tract descriptions which have actually been consolidated. (Use reverse side of this form if necessary.) _____

No allowable will be assigned to the well until all interests have been consolidated (by communitization, unitization, forced-pooling, or otherwise) or until a non-standard unit, eliminating such interests, has been approved by the Division

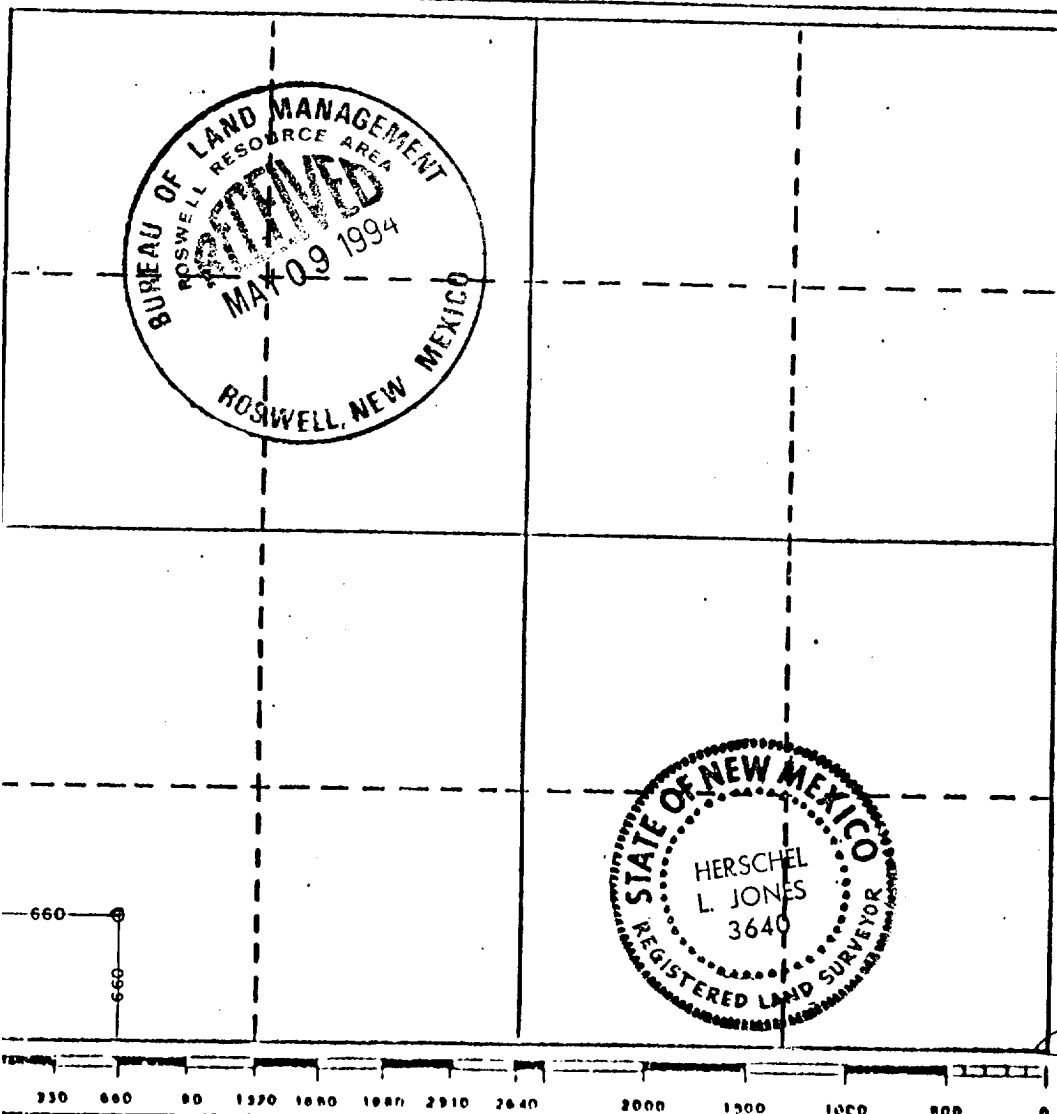

CERTIFICATION

I hereby certify that the information contained herein is true and complete to the best of my knowledge and belief.

Name _____

Position _____

Company _____

Date _____

I hereby certify that the well location shown on this plat was plotted from field notes of actual surveys made by me or under my supervision, and that the same is true and correct to the best of my knowledge and belief.

Date Surveyed

March 14, 1986

Registered Professional Engineer
and/or Land Surveyor

Certificate No.

#3640

YATES
PETROLEUM
CORPORATION

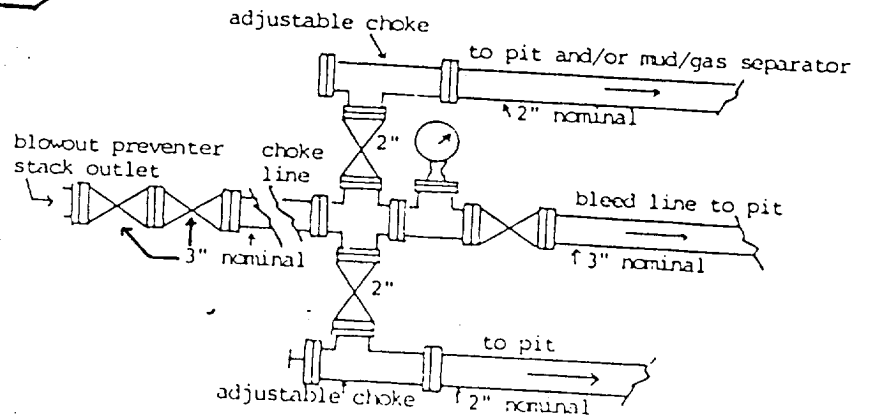
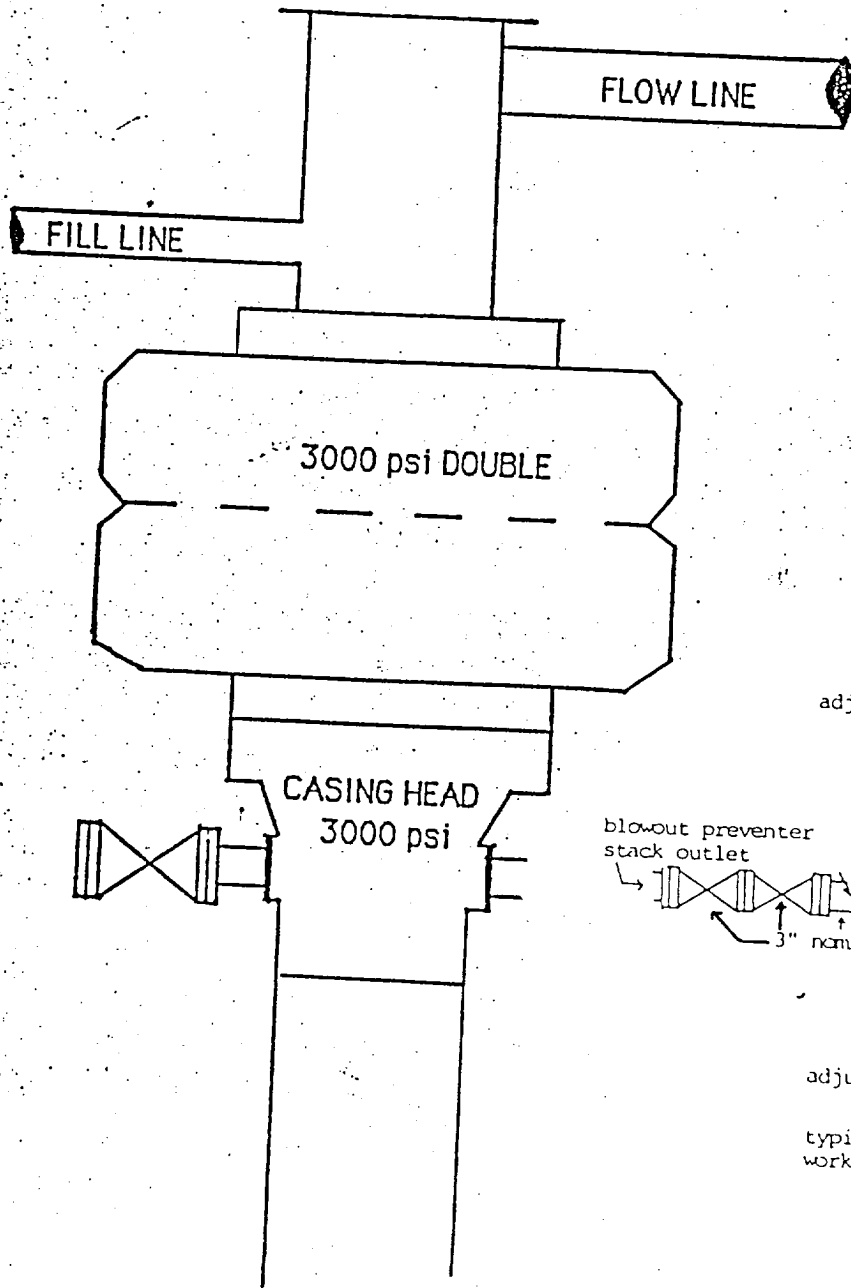

typical choke manifold assembly for 3M rated
working pressure service-surface installation

**BLOWOUT PREVENTER
3M SYSTEM**