

STATE OF NEW MEXICO
ENERGY AND MINERALS DEPARTMENT

OIL CONSERVATION DIVISION

Form C-101
Revised 10-1-78

NO. OF COPIES RECEIVED	
DISTRIBUTION	
SANTA FE	<input checked="" type="checkbox"/>
FILE	<input checked="" type="checkbox"/>
U.S.G.S.	<input checked="" type="checkbox"/>
LAND OFFICE	<input checked="" type="checkbox"/>
OPERATOR	<input checked="" type="checkbox"/>

RECEIVED BY P. O. BOX 2088
SANTA FE, NEW MEXICO 87501
SEP 25 1986
O. C. D.
ARTESIAN OFFICE

5A. Indicate Type of Lease
STATE ☒ FEE ☐
5. State Oil & Gas Lease No.
LG-5246

APPLICATION FOR PERMIT TO DRILL, DEEPEN, OR PLUG BACK

1. Type of Work
DRILL ☒ DEEPEN ☐ PLUG BACK ☐
2. Type of Well
OIL WELL ☒ GAS WELL ☐ OTHER ☐ SINGLE ZONE ☒ MULTIPLE ZONE ☐
3. Name of Operator
Roy Collins Drilling Co.
4. Address of Operator
Rt. 4, Box 501-CC, Roswell, NM 88201
5. Location of Well
UNIT LETTER P LOCATED 990 FEET FROM THE South LINE
NO 330 FEET FROM THE EAST LINE OF SEC. 21 TWP. 10S RGE. 27E NMPM
6. 12. County
Chaves
7. Unit Agreement Name
8. Farm or Lease Name
Frank "P" State
9. Well No.
3
10. Field and Pool, or Wildcat
Diablo-San Andres
11. 19. Proposed Depth
2140
19A. Formation
San-Andres
20. Rotary or C.T.
C.T.
1. Elevations (show whether DF, RT, etc.)
3854 GL
21A. Kind & Status Plug. Bond
Single ☒
21B. Drilling Contractor
Roy Collins Drilling
22. Approx. Date Work will start
11-2-86

3. PROPOSED CASING AND CEMENT PROGRAM

SIZE OF HOLE	SIZE OF CASING	WEIGHT PER FOOT	SETTING DEPTH	SACKS OF CEMENT	EST. TOP
12 1/2"	8-5/8	24	430	sufficient to circulate	
8	5-1/2	14	2140	sufficient to circulate	

Posted ID-1
API, NL
10-31-86

APPROVAL VALID FOR 60 DAYS
PERMIT EXPIRES 4-29-87
UNLESS DRILLING UNDERWAY

4. ABOVE SPACE DESCRIBE PROPOSED PROGRAM; IF PROPOSAL IS TO DEEPEN OR PLUG BACK, GIVE DATA ON PRESENT PRODUCTIVE ZONE AND PROPOSED NEW PRODUCTIVE ZONE. GIVE BLOWOUT PREVENTER PROGRAM, IF ANY.

I hereby certify that the information above is true and complete to the best of my knowledge and belief.

Signed Roy Collins Title Owner Date 9-23-86

(This space for State Use)

Original Signed By
Mike Williams
Oil & Gas Inspector

APPROVED BY _____ DATE OCT 29 1986
CONDITIONS OF APPROVAL, IF ANY:

All Distances must be from the outer boundaries of the Section.

Operator Roy Collins Drilling Co.		Lessee Frank P. State		Well No. #3
Unit Letter P	Section 21	Township 10 South	Range 27 East	County Chaves
Actual Footage Location of Well 330 feet from the East line and 990 feet from the South line				
Ground Level Elev. 3854	Producing Formation San Andres	Well Name Diablo-San Andres		Dedicated Acreage 40 Acres

1. Outline the acreage dedicated to the subject well by colored pencil or hatchure marks on the plat below.
2. If more than one lease is dedicated to the well, outline each and identify the ownership thereof (both as to working interest and royalty).
3. If more than one lease of different ownership is dedicated to the well, have the interests of all owners been consolidated by communitization, unitization, forced-pooling, etc?
☐ Yes ☐ No - If answer is "yes," type of consolidation:

If answer is "no," list the owners and tract descriptions which have actually been consolidated. (Use reverse side of this form if necessary.)

No allowable will be assigned to the well until all interests have been consolidated (by communitization, unitization, forced-pooling, or otherwise) or until a non-standard unit, eliminating such interests, has been approved by the Division.

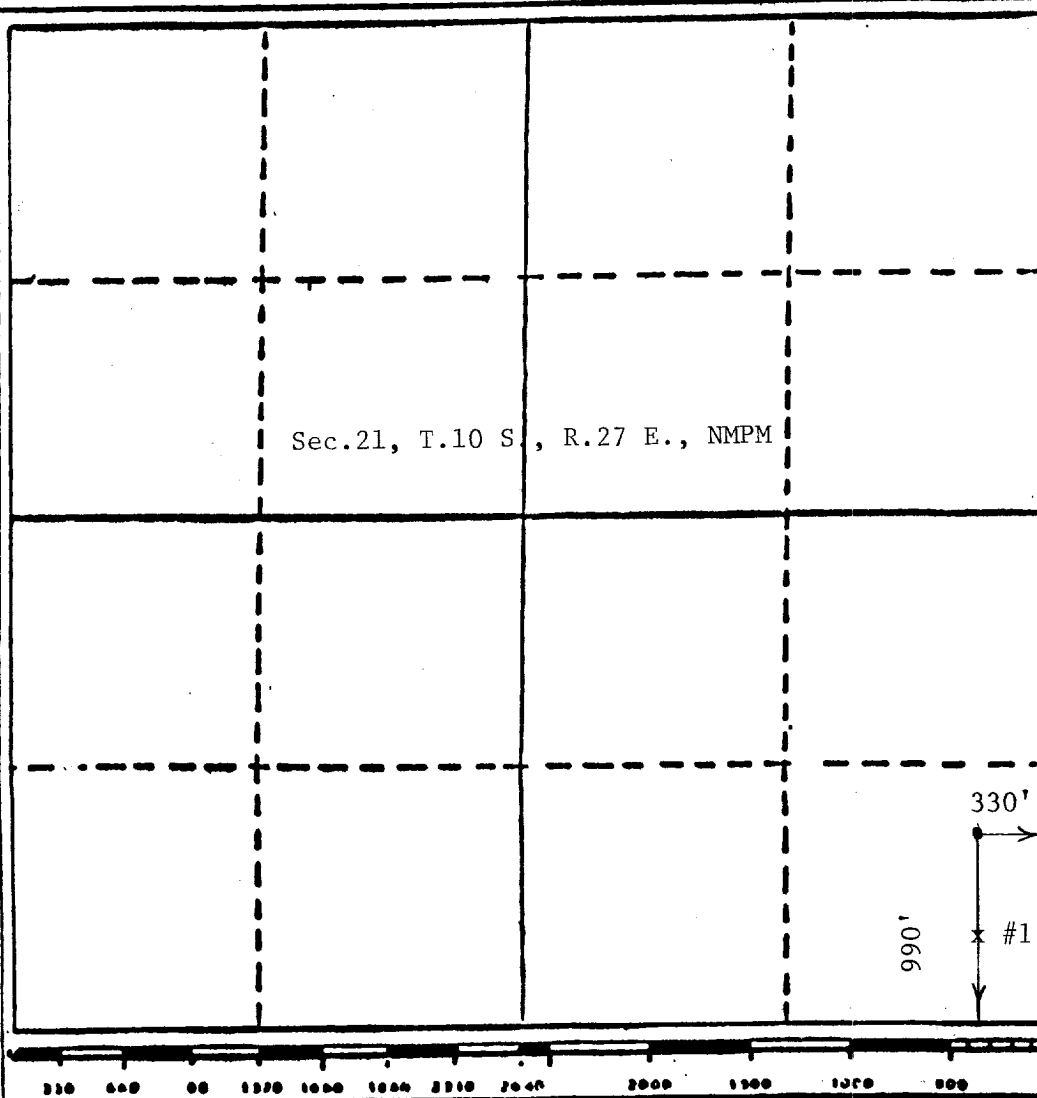

CERTIFICATION

I hereby certify that the information contained herein is true and complete to the best of my knowledge and belief.

Name
Roy Collins
Position
Owner
Company
Roy Collins Drilling Co.
Date
9-23-86

I hereby certify that the well location shown on this plat was plotted from field notes of actual surveys made by me or under my supervision, and that the same is true and correct to the best of my knowledge and belief.

Date Surveyed
September 17, 1986
Registered Professional Engineer and/or Land Surveyor
[Signature]
Professional Engineer, P.E. & L.S.
Certificate No. 9290