

NM Oil Cons. Commission  
Drawer DD  
Artesia, NM 88210UNITED STATES  
DEPARTMENT OF THE INTERIOR  
BUREAU OF LAND MANAGEMENT

30-005-62362

## APPLICATION FOR PERMIT TO DRILL DEEPEN, OR PLUG BACK

## 1a. TYPE OF WORK

DRILL ☒DEEPEN ☒PLUG BACK ☐

## b. TYPE OF WELL

OIL  
WELL ☐GAS  
WELL ☒

OTHER

SINGLE  
ZONE ☒MULTIPLE  
ZONE ☐

## 2. NAME OF OPERATOR

McKay Oil Corporation

## 3. ADDRESS OF OPERATOR

P.O. Box 2014, Roswell, New Mexico 88202

## 4. LOCATION OF WELL (Report location clearly and in accordance with any State requirements.)

At surface

1980 FSL-1980 FWL

At proposed prod. zone

## 14. DISTANCE IN MILES AND DIRECTION FROM NEAREST TOWN OR POST

28 Miles Northwest of Roswell, NM

## 15. DISTANCE FROM PROPOSED\*

LOCATION TO NEAREST

PROPERTY OR LEASE LINE, FT.

(Also to nearest drlg. unit line, if any)

1980'

## 18. DISTANCE FROM PROPOSED LOCATION\*

TO NEAREST WELL, DRILLING COMPLETED,  
OR APPLIED FOR, ON THIS LEASE, FT.

1/2 mile

## 16. NO. OF ACRES IN LEASE

909.88

## 19. PROPOSED DEPTH

3,400'

17. NO. OF ACRES ASSIGNED  
TO THIS WELL

160.0

## 20. ROTARY OR CABLE TOOLS

Rotary

## 21. ELEVATIONS (Show whether DP, RT, GR, etc.)

4213'

## 22. APPROX. DATE WORK WILL START\*

ASAP

## 23. PROPOSED CASING AND CEMENTING PROGRAM

SIZE OF HOLE	SIZE OF CASING	WEIGHT PER FOOT	SETTING DEPTH	QUANTITY OF CEMENT
12 1/4"	8 5/8"	24.0 J-55	900±	850 cf cement circulated
7 7/8"	4 1/2"	9.5 J-55	TD	1200 cf cement including 480 cf to tie in 4 1/2" to 8 5/8" from 1500' to 900'.

We propose to drill and test the Abo formation. Approximately 900' of surface casing will be set and cemented to surface. If commercial, 4 1/2" production casing will be run and cemented with adequate cover, perforated and stimulated as needed for production.

MUD PROGRAM: See Supplemental Drilling Data Which is Attached.

BOP PROGRAM: BOP will be installed on 8 5/8" casing and tested daily.

Gas is not dedicated.

IN ABOVE SPACE DESCRIBE PROPOSED PROGRAM: If proposal is to deepen or plug back, give data on present productive zone and proposed new productive zone. If proposal is to drill or deepen directionally, give pertinent data on subsurface locations and measured and true vertical depths. Give blowout preventer program, if any.

24.

SIGNED

TITLE Landman

DATE

12-7-86

(This space for Federal or State office use)

PERMIT NO.

APPROVAL DATE

S/Levi Deike, Acting

Area Manager

APPROVED BY

TITLE

DATE

DEC 12 1986

CONDITIONS OF APPROVAL, IF ANY:

APPROVAL OF THIS APPLICATION DOES NOT WARRANT OR CERTIFY THAT THE APPLICANT HOLDS LEGAL OR EQUITABLE TITLE TO THOSE RIGHTS IN THE SUBJECT LEASE WHICH WOULD ENTITLE THE APPLICANT TO CONDUCT OPERATIONS THEREON.

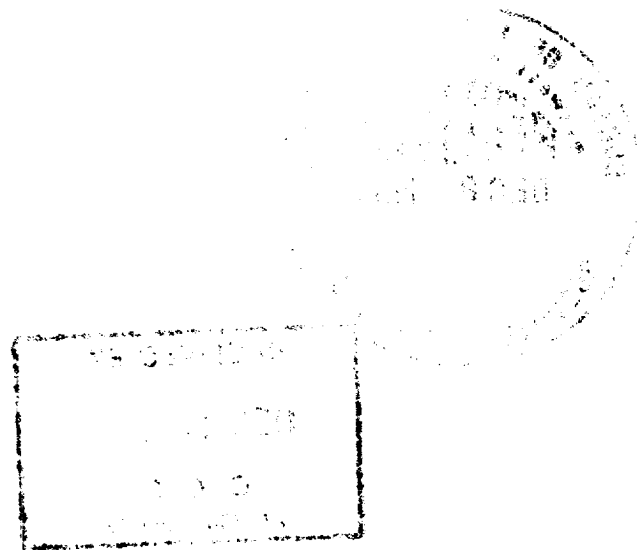

1890/1891

1890/1891

TO THE EDITOR OF THE  
BRITISH LANCET  
LONDON  
NOTICE TO THE EDITOR

All distances must be from the outer boundaries of the Section.

Lessor McKay Oil Corp.		Lessee Miller Federal		Well No. #3
Unit Letter K	Section 7	Township 6 South	Range 23 East	County Chaves
Actual Wellbore Location of Wells 1980 feet from the South line and 1980 feet from the West line				
Ground Level Elev. 4213	Producing Formation ABO	Pool W. Pecos Slope Abo Gas	Dedicated Acres 160	

1. Outline the acreage dedicated to the subject well by colored pencil or hatchure marks on the plat below.
2. If more than one lease is dedicated to the well, outline each and identify the ownership thereof (both as to working interest and royalty).
3. If more than one lease of different ownership is dedicated to the well, have the interests of all owners been consolidated by communitization, unitization, force-pooling, etc?

☐ Yes ☐ No - If answer is "yes," type of consolidation

If answer is "no," list the owners and tract descriptions which have actually been consolidated. (Use reverse side of this form if necessary.)

No allowable will be assigned to the well until all interests have been consolidated (by communitization, unitization, forced-pooling, or otherwise) or until a non-standard unit, eliminating such interests, has been approved by the Division

RECEIVED BY  
DEC 15 1986  
O. C. D.  
ARTESIA, NEW MEXICO

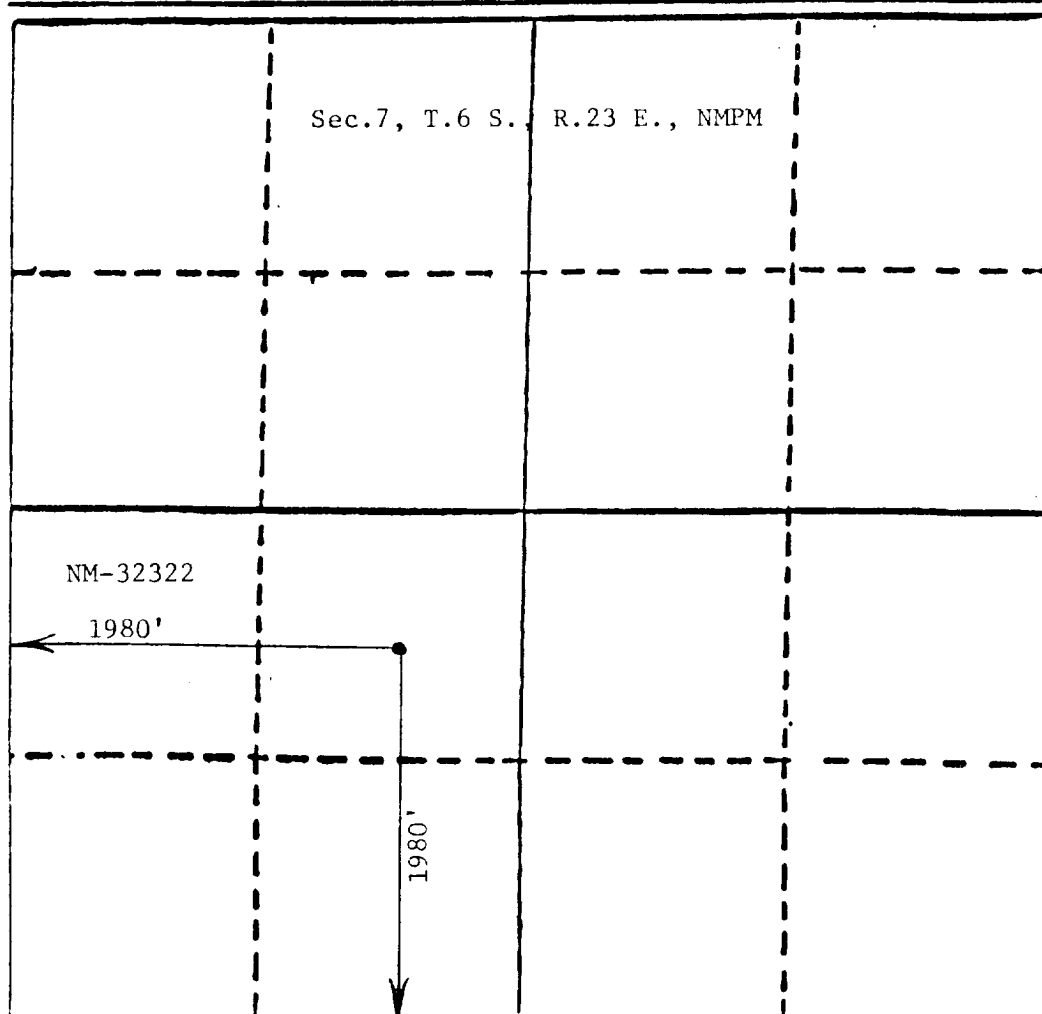

### CERTIFICATION

I hereby certify that the information contained herein is true and complete to the best of my knowledge and belief.

Name  
Sam L. Shackelford  
Position  
Agent  
Company  
McKay Oil Corp.  
Date  
12-7-86

I hereby certify that the well location shown on this plat was plotted from field notes of actual surveys made by me or under my supervision, and that the same is true and correct to the best of my knowledge and belief.

JOHN D. JAQUERS  
NEW MEXICO  
November 25, 1986  
I have placed this plat in the public records and it is now a part of the public records.  
John D. Jaquers, P.E. & L.S.  
Custodian No. 6290

MCKAY OIL CORPORATION  
Miller Federal #3  
NE $\frac{1}{4}$ SW $\frac{1}{4}$ , Sec. 7-6S-23E  
Chaves County, New Mexico

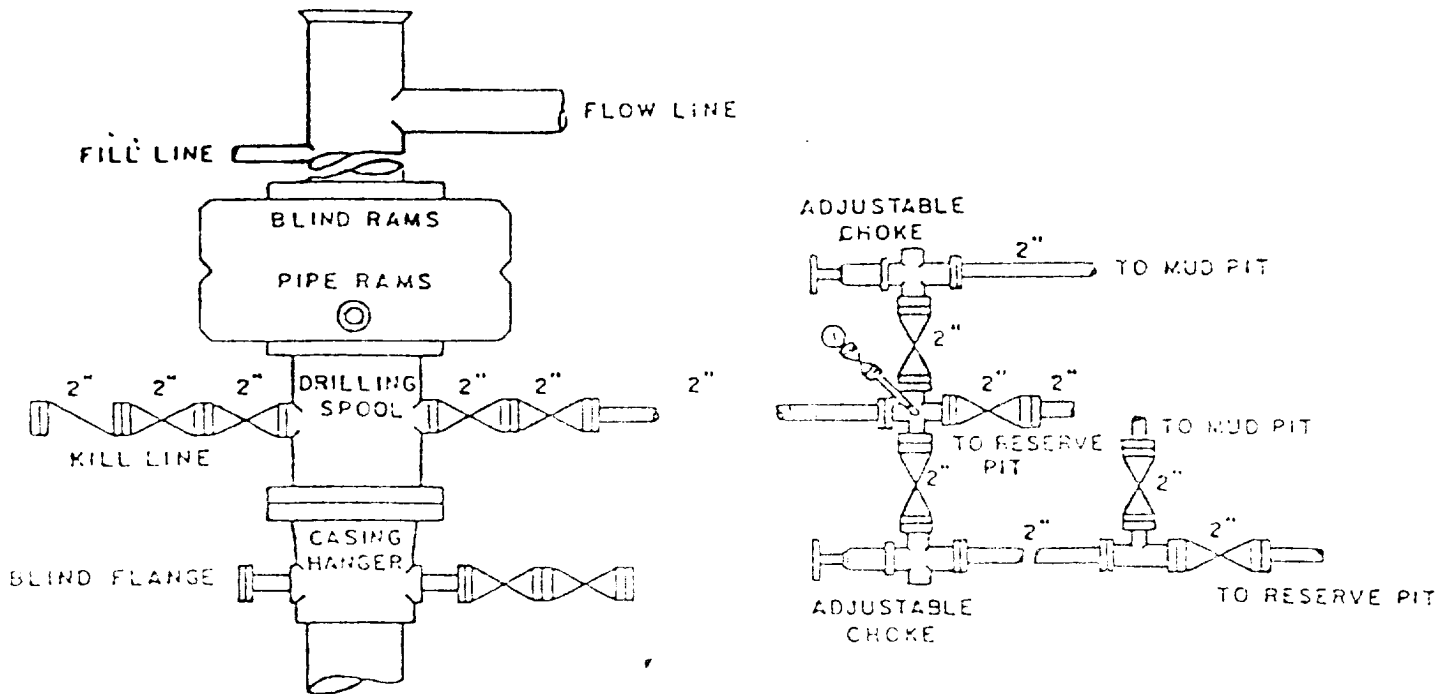

BOP DIAGRAM

3000# Working Pressure  
Rams Operated Daily

SUPPLEMENTAL DRILLING DATA

McKAY OIL CORPORATION  
Miller Federal #3  
NE1/4SW1/4 Sec. 7-6S-23E  
Chaves County, N.M.

NM 32322



The following items supplement Form 9-331C in accordance with instructions contained in NTL-6.

1. SURFACE FORMATION: San Andres
2. ESTIMATED TOPS OF GEOLOGIC MARKERS:

Yeso	- 652'
Tubb	- 2082'
Abo	- 2867'
3. ESTIMATED DEPTHS TO WATER, OIL OR GAS FORMATION:

Fresh water	- In surface formations above 600'
Gas	- In Abo formation below 2867'
4. PROPOSED CASING PROGRAM: See Form 9-331C
5. PRESSURE CONTROL EQUIPMENT: Blowout preventer stack will consist of at least a double-ram blowout preventer rated to 3000#WP. A sketch of the BOP is attached.
6. CIRCULATING MEDIUM:

0'- 600'	Lime and gel, spud mud, viscosity 32 to 34 seconds.
600'- 2750	Fresh water
2750'- TD	Start mudding up at 2750'; viscosity 36 to 38 seconds; water loss 10 cc or less; 3-5% Diesel; 2 KCL

Mud additives will be used to control water loss.
7. AUXILIARY EQUIPMENT: full-opening drill string safety valve fit the drill string in use, will be kept on the rig floor at all times.

MCKAY OIL CORPORATION  
Miller Federal #3  
NE 1/4 SW 1/4, Sec. 7-6S-23E  
Chaves County, New Mexico

4165  
4140  
4151  
4150  
4155  
4141  
4130  
4128  
4120  
4110  
4100  
4097  
4105  
4102

31 32 33 5 8 12 13 17 18 19

Miller Fed. #2  
Miller Fed. #3  
Miller Fed. #4  
Hosmer Fed. #1  
Hosmer Fed. #2  
Hosmer Fed. #3  
Hosmer Fed. #4  
Snakehead Fed. #1  
Snakehead Fed. #2

W R McKnight  
Ranch

EXHIBIT B

MCKAY OIL CORPORATION  
Miller Federal #3  
NE 1/4 SW 1/4, Sec. 7-6S-23E  
Chaves County, New Mexico

4165  
4140  
4151  
4150  
4155  
4141  
4160  
4128  
4100  
4103  
4097  
4105  
4102

31 32 33 5 8 12 13 17 18 19

Miller Fed. #1  
Miller Fed. #2  
Miller Fed. #3  
Miller Fed. #4  
Hosmer Fed. #1  
Hosmer Fed. #2  
Hosmer Fed. #3  
Hosmer Fed. #4  
Snakehead Fed. #1  
Snakehead Fed. #2

W R McKnight  
Ranch

EXHIBIT B

MCKAY OIL CORPORATION  
Miller Federal #3  
NE 1/4, Sec. 7-6S-23E  
Chaves County, New Mexico

4165  
4140  
4151  
4150  
4155  
4141  
4160  
4128  
4100  
4105  
4097  
4107  
4012

31 32 33 5 8 12 13 17 18 19

Miller Fed. #1  
Miller Fed. #2  
Miller Fed. #3  
Miller Fed. #4  
Hosmer Fed. #1  
Hosmer Fed. #2  
Hosmer Fed. #3  
Hosmer Fed. #4  
Snakehead Fed. #1

W R McKnight  
Ranch

EXHIBIT B

MCKAY OIL CORPORATION  
Miller Federal #3  
NE 1/4 SW 1/4, Sec. 7-6S-23E  
Chaves County, New Mexico

Miller Fed. #1  
Miller Fed. #2  
Miller Fed. #3  
Miller Fed. #4  
Miller Fed. #5  
Miller Fed. #6  
Hosmer Fed. #1  
Hosmer Fed. #2  
Hosmer Fed. #3  
Hosmer Fed. #4  
Snakehead Fed. #1

New Access Road-----  
Existing Access Road---

W R McKnight  
Ranch

EXHIBIT B

MCKAY OIL CORPORATION  
 Miller Federal #3  
 NE1SW1, Sec. 7-6S-23E  
 Chaves County, New Mexico

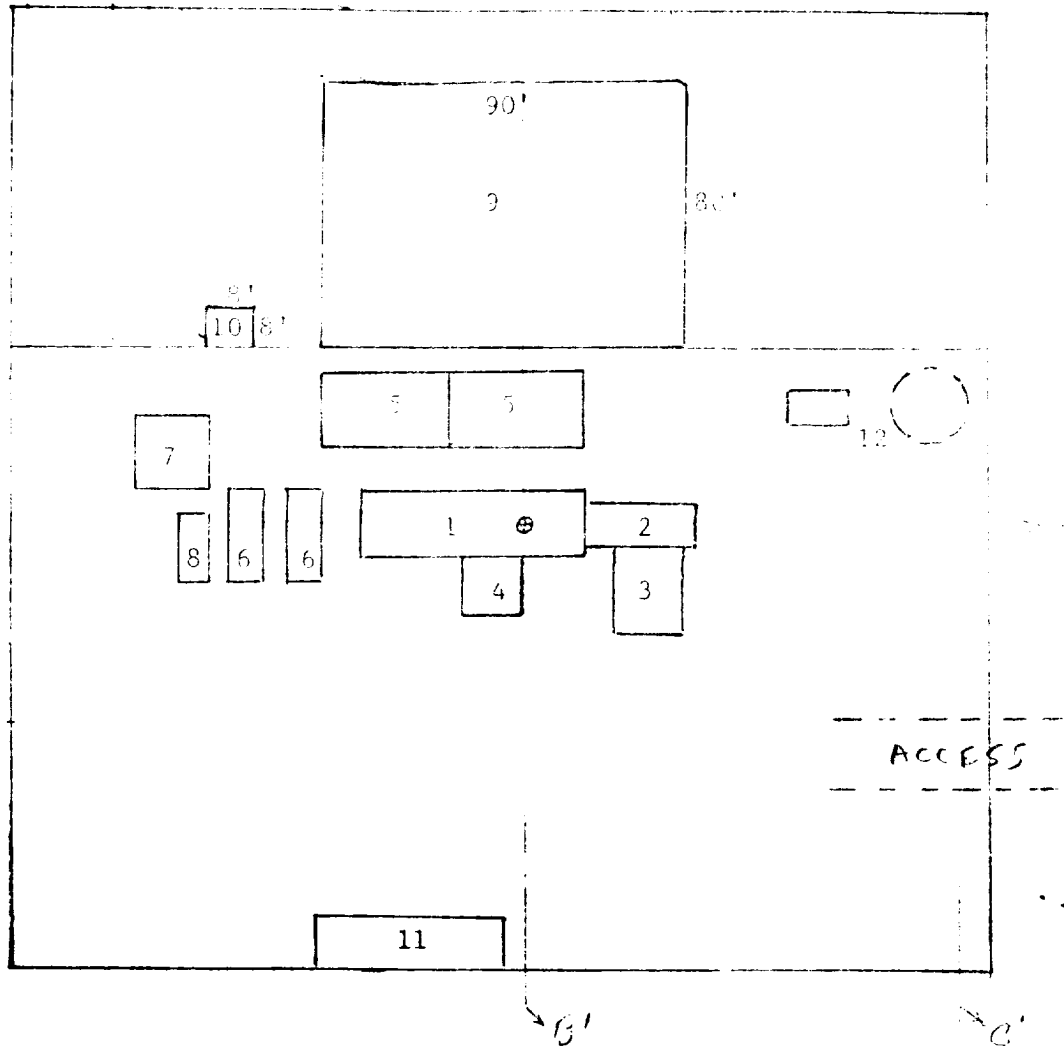

RIG LAYOUT

- |                 |                           |
|-----------------|---------------------------|
| 1. Substructure | 7. Water Tank             |
| 2. Catwalk      | 8. Light Plant            |
| 3. Pipe Rack    | 9. Reserve Pit            |
| 4. Doghouse     | 10. Trash Pit             |
| 5. Mud Pits     | 11. Trailer House         |
| 6. Mud Pumps    | 12. Production Facilities |