

All distances must be from the outer boundaries of the Section.

Operator McKay Oil Corporation		Lease Inexco State		Well No. #5
Unit Letter K	Section 33	Township 5 South	Range 22 East	County Chaves
Actual Well Location of Well:				
1980 feet from the South line and		1980 feet from the West line		
Ground Level Elev. 4113	Producing Formation Abo	Pool W. Pecos Slope Abo	Dedicated Acres 160	

1. Outline the acreage dedicated to the subject well by colored pencil or hatchure marks on the plat below.
2. If more than one lease is dedicated to the well, identify the ownership thereof (both as to working interest and royalty).
3. If more than one lease of different ownership is dedicated to the well, have the interests of all owners been consolidated by communitization, unitization, forced-pooling, or otherwise?
☐ Yes ☐ No If answer is "yes," type of consolidation:

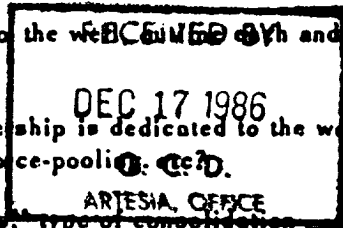

If answer is "no," list the owners and tract descriptions which have actually been consolidated. (Use reverse side of this form if necessary.)

No allowable will be assigned to the well until all interests have been consolidated (by communitization, unitization, forced-pooling, or otherwise) or until a non-standard unit, eliminating such interests, has been approved by the Division.

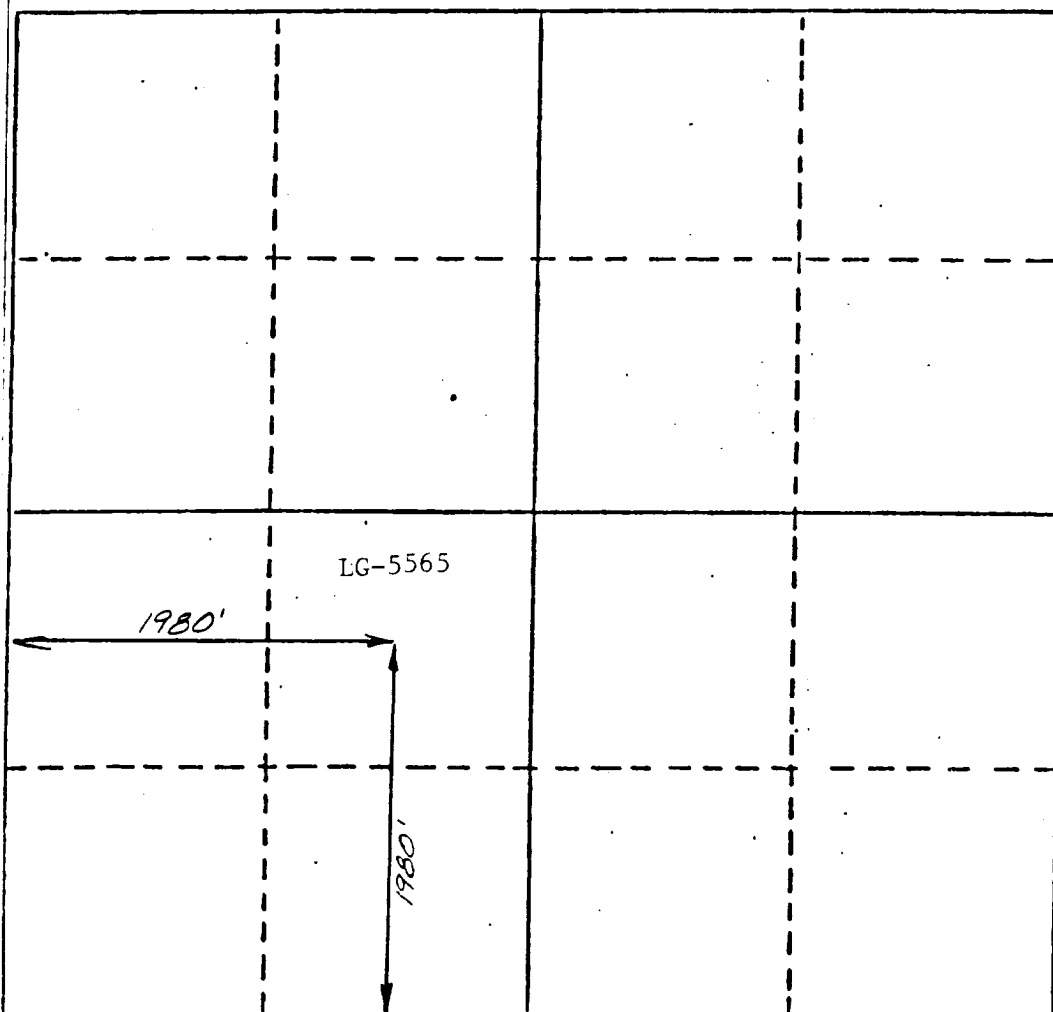

CERTIFICATION

I hereby certify that the information contained herein is true and complete to the best of my knowledge and belief.

Name
James L. Schultz
Position
Landman
Company
McKay Oil Corp.
Date
12-15-86

I hereby certify that the well location shown on this plat was plotted from field notes of actual surveys made by me or under my supervision, and that the same is true and correct to the best of my knowledge and belief.

December 15, 1986
Date Surveyed
John D. Jaques, P.E. & L.S.
Registered Professional Engineer and/or Surveyor
#6290
Certificate No.

