

STATE OF NEW MEXICO
ENERGY AND MINERALS DEPARTMENT

P. O. BOX 2088
SANTA FE, NEW MEXICO 87501

Form C-102
Revised 10-1-78

All distances must be from the outer boundaries of the Section.

Operator McKay Oil Corp. ✓			Lease Pipeline Comm.			Well No. 1		
Unit Letter J	Section 26	Township 6 S	Range 22 E	County Chaves				
Actual Postage Location of Well: 1960 feet from the East line and 1342 feet from the South line								
Ground Level Elev. 4209	Producing Formation Abo			Pool W. Pecos Slope Abo			Dedicated Acres 160	

1. Outline the acreage dedicated to the subject well by colored pencil or hatchure marks on the plat below.
2. If more than one lease is dedicated to the well, outline each and identify the ownership thereof (both as to working interest and royalty).
3. If more than one lease of different ownership is dedicated to the well, have the interests of all owners been consolidated by communitization, unitization, force-pooling, etc?

RECEIVED BY

DEC 29 1986

ARTESIAL OFFICE

☐ Yes ☒ No If answer is "yes," type of consolidation Will Communitize if productive.

If answer is "no," list the owners and tract descriptions which have actually been consolidated. (Use reverse side of this form if necessary.)

No allowable will be assigned to the well until all interests have been consolidated (by communitization, unitization, forced-pooling, or otherwise) or until a non-standard unit, eliminating such interests, has been approved by the Division.

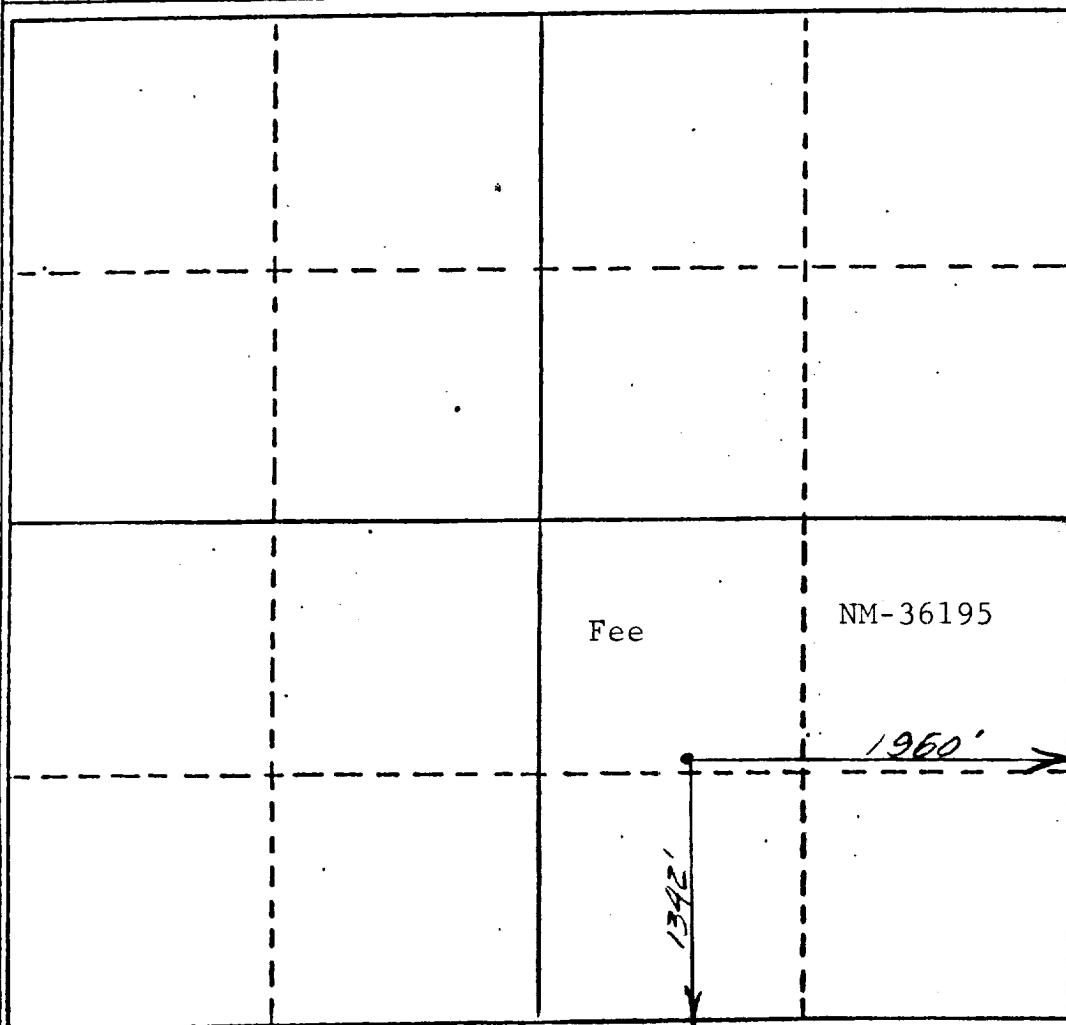

CERTIFICATION

I hereby certify that the information contained herein is true and complete to the best of my knowledge and belief.

Name
James L. Schultz

Position
Landman

Company
McKay Oil Corp.

Date
12-23-86

I hereby certify that the well location shown on this plat was plotted from field notes of actual surveys made by me or under my supervision, and that the same is true and correct to the best of my knowledge and belief.

Date Surveyed
12-18-86
Registered Professional Engineer and/or Land Surveyor
John D. Jaquess, P.E. L.S.
Certificate No. 6290