

November 1987
Formerly 9-331

UNITED STATES NM Oil Conservation Commission
DEPARTMENT OF THE INTERIOR
BUREAU OF LAND MANAGEMENT
Artesia, NM 88210

Expires August 1, 1988

5. LEASE DESIGNATION AND SERIAL
NM-32322
6. IF INDIAN, ALLOTTEE OR TRIBE NAME

SUNDRY NOTICES AND REPORTS ON WELLS

(Do not use this form for proposals to drill or to deepen or plug back to a different reservoir.
Use "APPLICATION FOR PERMIT" for such proposals.)

7. UNIT AGREEMENT NAME

8. FARM OR LEASE NAME

Miller Federal

9. WELL NO.

6

10. FIELD AND POOL, OR WILDCAT

W. Pecos Slope Abo

11. SEC., T., S., R., OR BLK. AND
SUBVY OR AREA

Sec. 6, T6S, R23E

12. COUNTY OR PARISH 13. STATE

Chaves

NM

1. OIL WELL ☐ GAS WELL ☒ OTHER

2. NAME OF OPERATOR

McKay Oil Corporation

3. ADDRESS OF OPERATOR

P.O. Box 2014, Roswell, New Mexico 88202

4. LOCATION OF WELL (Report location clearly and in accordance with BLM requirements.
See also space 17 below.)
At surface

660' FSL & 990' FEL

14. PERMIT NO.

15. ELEVATIONS (Show whether DF, RT, GR, etc.)

4202' GR

16. Check Appropriate Box To Indicate Nature of Notice, Report, or Other Data

NOTICE OF INTENTION TO:

TEST WATER SHUT-OFF

FRACTURE TREAT

SHOOT OR ACIDIZE

REPAIR WELL

PULL OR ALTER CASING

MULTIPLE COMPLETE

ABANDON*

CHANGE PLANS

SUBSEQUENT REPORT OF:

WATER SHUT-OFF

FRACTURE TREATMENT

SHOOTING OR ACIDIZING

(Other)

REPAIRING WELL

ALTERING CASING

ABANDONMENT*

(Other) "On Lease Gas Pipeline"

X

(NOTE: Report results of multiple completion on Well
Completion or Recompletion Report and Log form.)

17. DESCRIBE PROPOSED OR COMPLETED OPERATIONS (Clearly state all pertinent details, and give pertinent dates, including estimated date of starting any proposed work. If well is directionally drilled, give subsurface locations and measured and true vertical depths for all markers and zones pertinent to this work.)

Operator proposes to construct a 6" steel natural gas pipeline as displayed on the enclosed topographic map. Proposed line will be buried a minimum of 12".

Operator also proposes to construct a 2 1/2" steel line as displayed on the enclosed topographic map. Proposed line is to connect to well and will also be buried a minimum of 12".



18. I hereby certify that the foregoing is true and correct

SIGNED

Levy W. Franklin

TITLE

Landman

DATE

January 15, 1987

(This space for Federal or State office use)

APPROVED BY

S/Phil Kirk

TITLE

Area Manager

DATE

MAR 4 1987

CONDITIONS OF APPROVAL, IF ANY:

THIS AUTHORIZATION IS GIVEN SUBJECT TO THE CONDITION THAT ALL OR PART OF IT MIGHT BE CONVERTED TO A RIGHT-OF-WAY GRANT IN THE FUTURE. ATTACHED ARE TWO PAGES OF STIPULATIONS WHICH ALSO APPLY TO THIS SUNDRY.

*See Instructions on Reverse Side

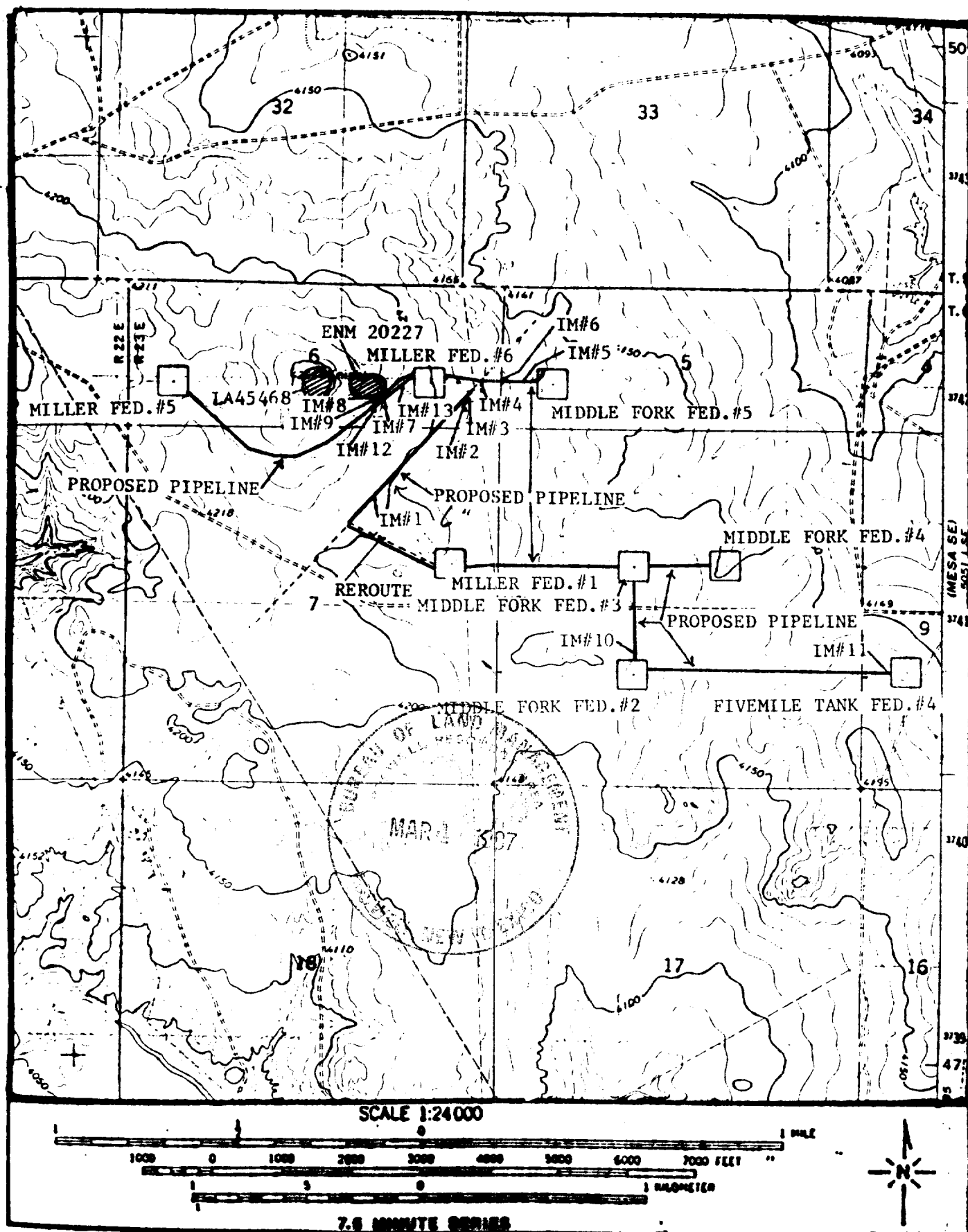

Figure 1. Location of proposed project areas and associated cultural resources in Sections 5, 6, 7, 8, and 9, T06S, R23E, NMPM, Chaves County, New Mexico.

Map Reference: USGS Mesa SW, N.Mex. Quadrangle, 1967 photorevised 1982