

UNITED STATES  
DEPARTMENT OF THE INTERIOR  
GEOLOGICAL SURVEY

30-005-62444

5. LEASE DESIGNATION AND SERIAL NO.

NM-13978

6. IF INDIAN, ALLOTTEE OR TRIBE NAME

7. UNIT AGREEMENT NAME

8. FARM OR LEASE NAME

Leeman Fed.

9. WELL NO.

4

10. FIELD AND POOL, OR WILDCAT

S. Pecos Slope Abo

11. SEC., T., R., M., OR BLK.  
AND SURVEY OR AREA

Sec. 12-T9S-R25E

12. COUNTY OR PARISH 13. STATE

Chaves

NM

## APPLICATION FOR PERMIT TO DRILL, DEEPEN, OR PLUG BACK

1a. TYPE OF WORK

DRILL ☒DEEPEN ☐PLUG BACK ☐

b. TYPE OF WELL

OIL  
WELL ☐GAS  
WELL ☒

OTHER

SINGLE  
ZONE ☐MULTIPLE  
ZONE ☐

2. NAME OF OPERATOR

McClellan Oil Corporation

3. ADDRESS OF OPERATOR

P.O. Drawer 730, Roswell, NM 88202

4. LOCATION OF WELL (Report location clearly and in accordance with an State

660' FSL & 2310' FWL  
At proposed prod. zone

RECEIVED BY

FEB 24 1987

O. C. D.

ARTESIA, OFFICE

14. DISTANCE IN MILES AND DIRECTION FROM NEAREST TOWN OR POST OFFICE\*

10 miles northeast of Roswell, N.M.

15. DISTANCE FROM PROPOSED\*

LOCATION TO NEAREST  
PROPERTY OR LEASE LINE, FT.  
(Also to nearest drlg. unit line, if any)

660'

16. NO. OF ACRES IN LEASE

1400

17. NO. OF ACRES ASSIGNED  
TO THIS WELL

160

18. DISTANCE FROM PROPOSED LOCATION\*

TO NEAREST WELL, DRILLING, COMPLETED,  
OR APPLIED FOR, ON THIS LEASE, FT.

2640'

19. PROPOSED DEPTH

4450'

20. ROTARY OR CABLE TOOLS

Rotary

21. ELEVATIONS (Show whether DF, RT, GR, etc.)

3685' G.L.

22. APPROX. DATE WORK WILL START\*

April 1, 1987

## PROPOSED CASING AND CEMENTING PROGRAM

SIZE OF HOLE	SIZE OF CASING	WEIGHT PER FOOT	SETTING DEPTH	QUANTITY OF CEMENT
12-1/4"	8-5/8"	24	950'	450 sx circulate
7-7/8"	4-1/2"	10.5	4450'	350 sx

Propose to drill to approximately 4450' to test the Abo formation. If production is indicated, will set casing and attempt completion.

Estimated formation tops: San Andres 636' Tubbs 3228'  
Glorieta 1716' Abo 3952'

Gas is dedicated.

IN ABOVE SPACE DESCRIBE PROPOSED PROGRAM: If proposal is to deepen or plug back, give data on present productive zone and proposed new productive zone. If proposal is to drill or deepen directionally, give pertinent data on subsurface locations and measured and true vertical depths. Give blowout preventer program, if any.

24.

SIGNED

Mark McClellan

TITLE

Geologist

DATE

1/28/87

(This space for Federal or State office use)

PERMIT NO.

APPROVAL DATE

APPROVED BY

S/Phil Kirk

TITLE

Area Manager

DATE

2-17-87

CONDITIONS OF APPROVAL, IF ANY:

APPROVAL OF THIS APPLICATION DOES NOT WARRANT OR  
CERTIFY THAT THE APPLICANT HOLDS LEGAL OR EQUITABLE  
TITLE TO THOSE RIGHTS IN THE SUBJECT LEASE WHICH WOULD  
ENTITLE THE APPLICANT TO CONDUCT OPERATIONS HEREUNDER.  
See Instructions On Reverse Side

All distances must be from the outer boundaries of the Section.

Operator McClellan Oil Corp. ✓		Lease Leeman Federal		Well No. #4
Unit Letter N	Section 12	Township 9 South	Range 25 East	County Chaves
Actual Footage Location of Well: 2310 feet from the West line and 660 feet from the South line				
Ground Level Elev. 3685	Producing Formation Abo	Pool S. Pecos Slope Abo	Dedicated Acres 160	Acres

1. Outline the acreage dedicated to the subject well by colored pencil or hachure marks on the plat below.
2. If more than one lease is dedicated to the well, outline each and identify the ownership thereof (both as to working interest and royalty).
3. If more than one lease of different ownership is dedicated to the well, have the interests of all owners been consolidated by communitization, unitization, force-pooling, etc?

RECEIVED BY  
FEB 24 1987  
O. C. D.  
ARTESIA, OFFICE

☐ Yes ☐ No If answer is "yes," type of consolidation \_\_\_\_\_

If answer is "no," list the owners and tract descriptions which have actually been consolidated. (Use reverse side of this form if necessary.) \_\_\_\_\_

No allowable will be assigned to the well until all interests have been consolidated (by communitization, unitization, forced-pooling, or otherwise) or until a non-standard unit, eliminating such interests, has been approved by the Division.

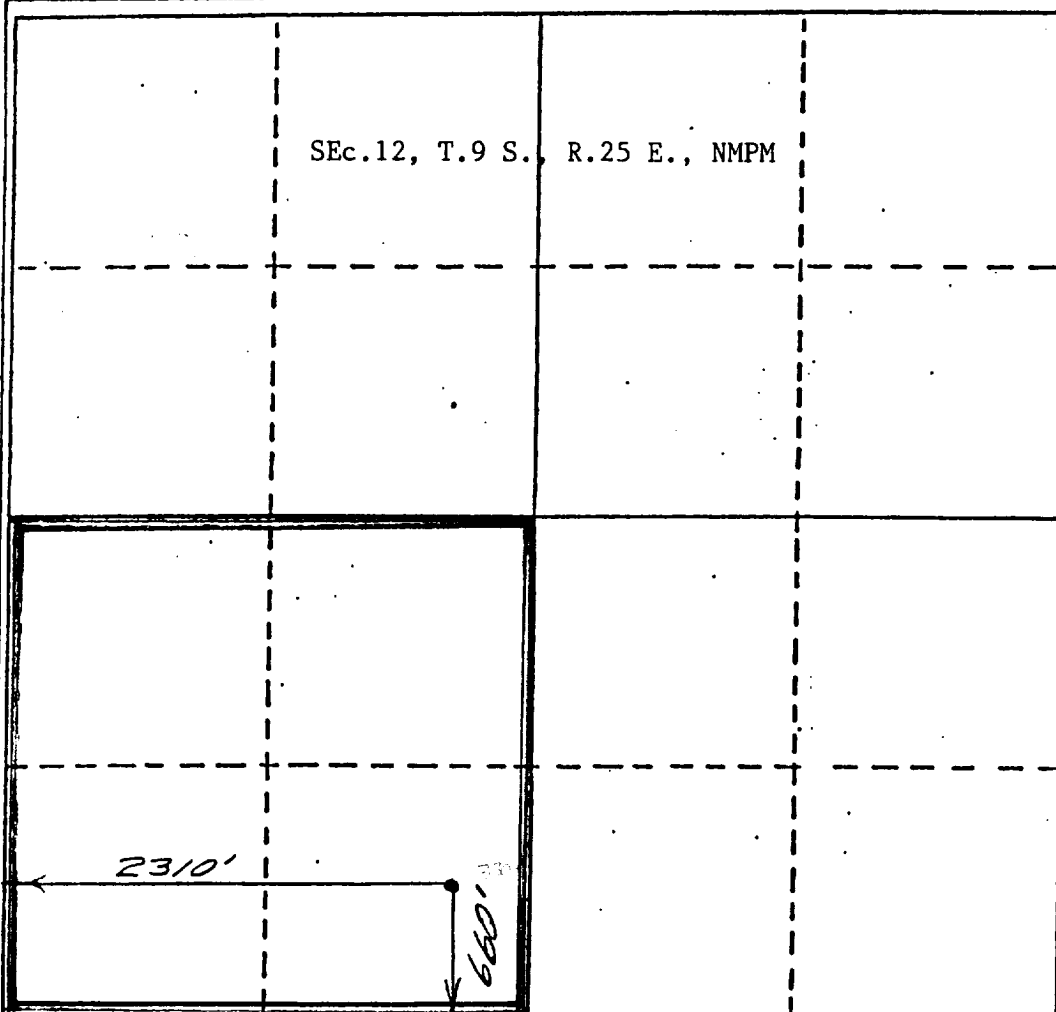

CERTIFICATION

I hereby certify that the information contained herein is true and complete to the best of my knowledge and belief.

*Mark McClellan*

Name  
Mark McClellan  
Position  
Geologist  
Company  
McClellan Oil Corporation  
Date  
1/28/87

I hereby certify that the well location shown on this plat was plotted from field notes of actual surveys made by me or under my supervision, and that the same is true and correct to the best of my knowledge and belief.

JOHN D. JAQUES  
Date Surveyed  
January 25, 1987  
Registered Professional Engineer  
and/or Land Surveyor  
John D. Jaques, P.E. & L.S.  
Certificate No. 6290

# BLUETOOTH PREVENTER SPECIFICATION

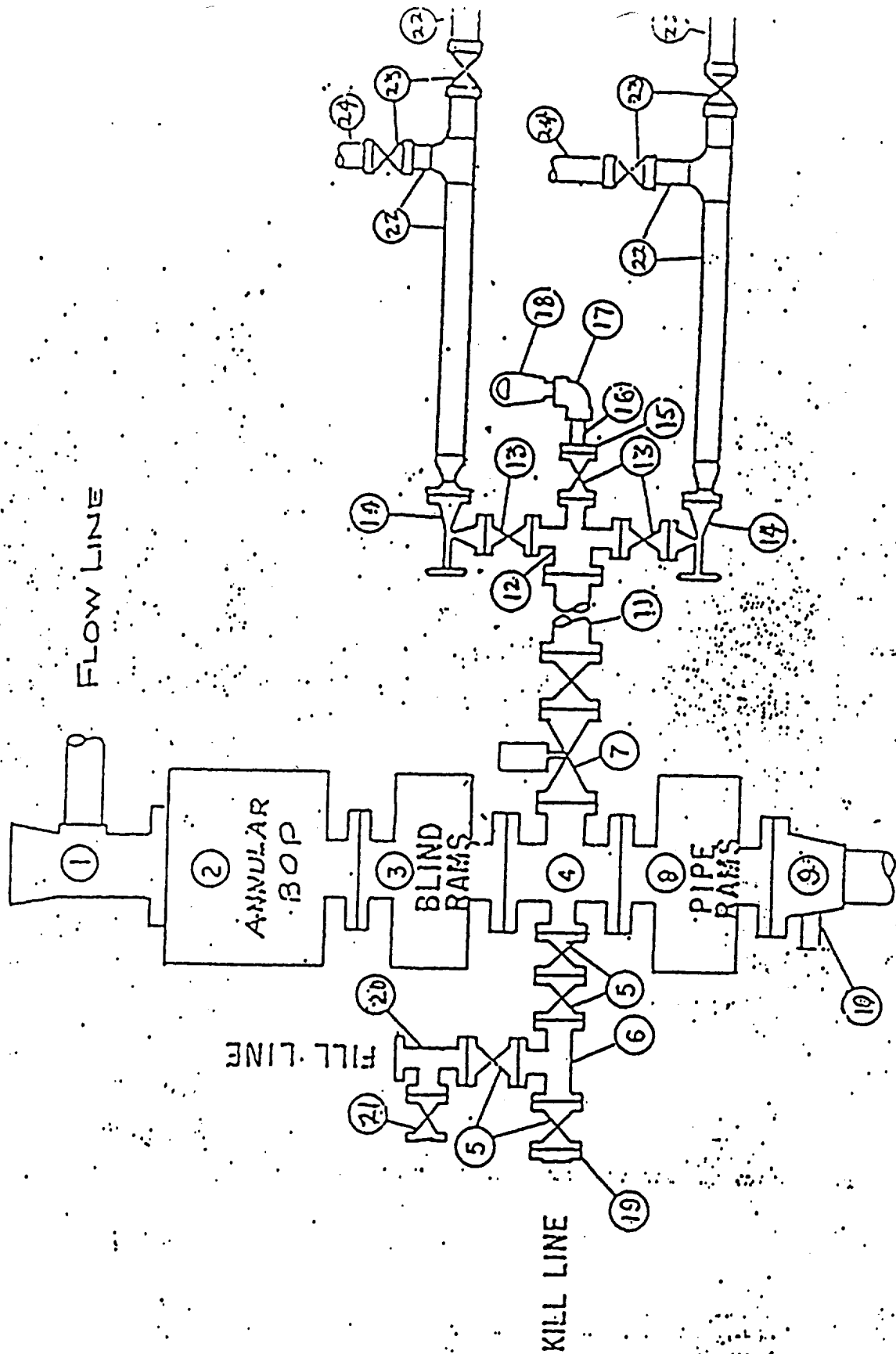

SURFACE USE PLAN EXHIBIT "E"  
 Leeman Fed. No. 4  
 SW1/4 Sec. 12-T9S-R25E  
 Chaves County, N.M.

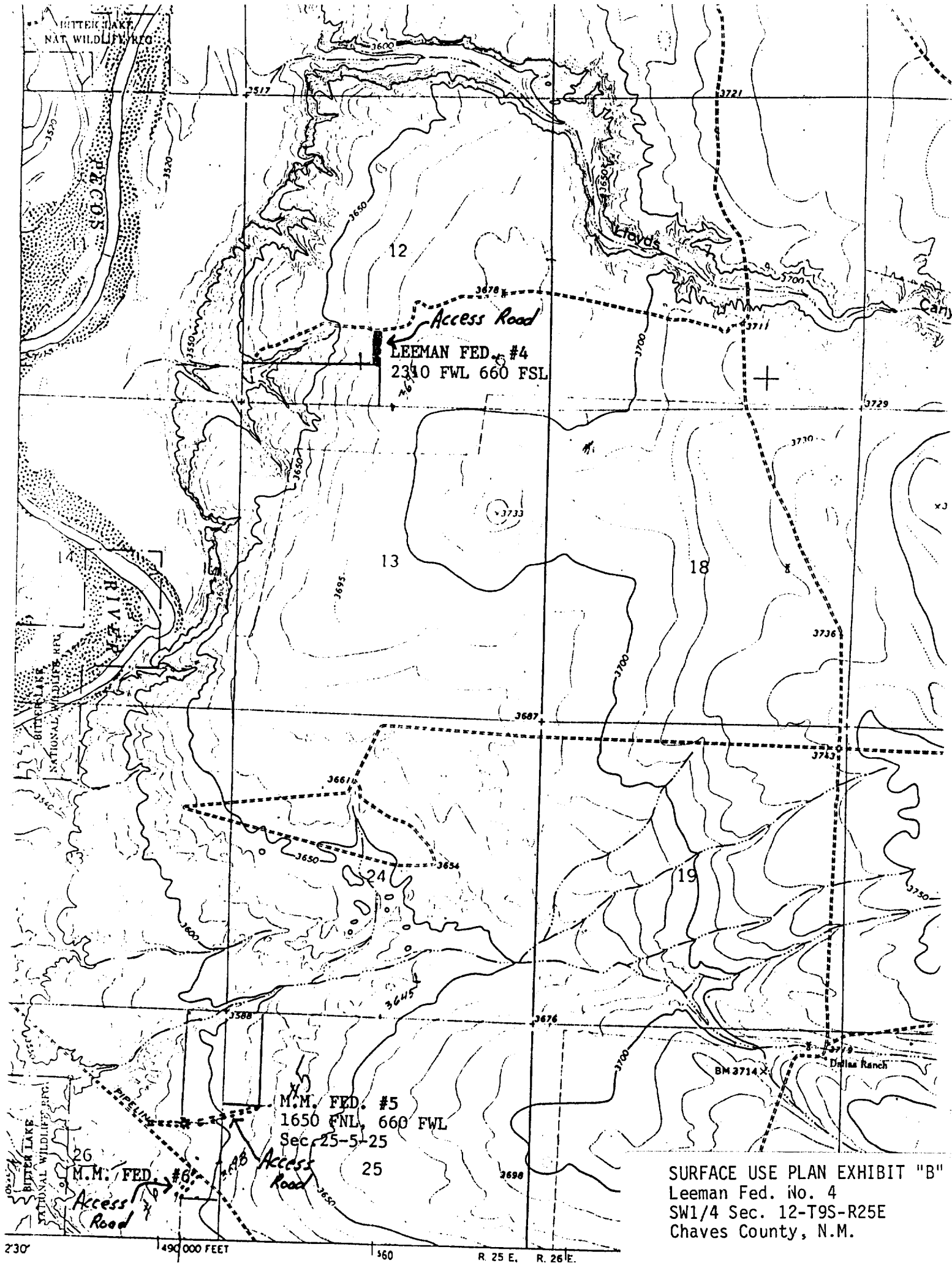

SURFACE USE PLAN EXHIBIT "B"  
Leeman Fed. No. 4  
SW1/4 Sec. 12-T9S-R25E  
Chaves County, N.M.

McCLELLAN OIL CORPORATION  
SUGGESTED PAD DIMENSIONS

Reserve Pits 4 ft. deep, plastic lined

Working pits 5 ft. deep

No cellar

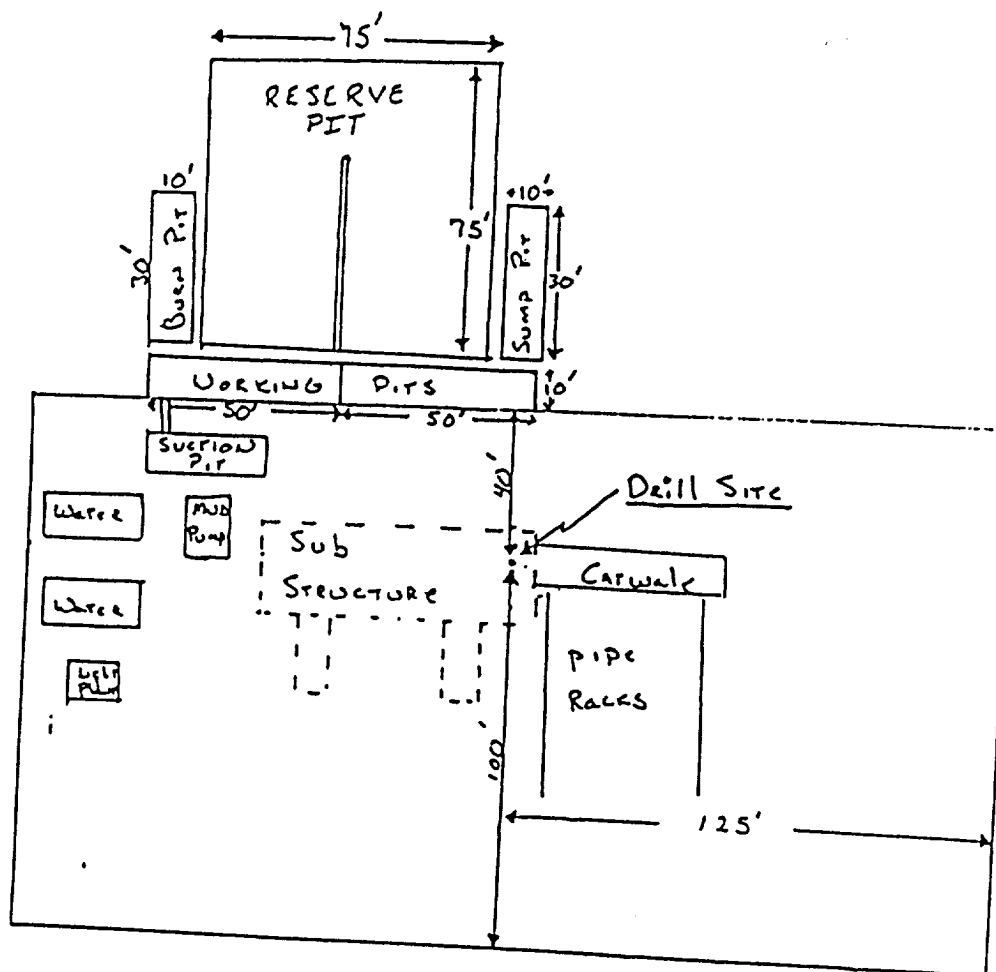

Scale 1" = 50'