

UNITED STATES OF AMERICA, NM 88210  
DEPARTMENT OF THE INTERIOR  
GEOLOGICAL SURVEY

(See instructions on  
reverse side)

30-005-62449

APPLICATION FOR PERMIT TO DRILL, DEEPEN, OR PLUG BACK

1a. TYPE OF WORK

DRILL ☒

DEEPEN ☐

PLUG BACK ☐

b. TYPE OF WELL

OIL  
WELL ☐

GAS  
WELL ☒

OTHER

SINGLE  
ZONE ☐

MULTIPLE  
ZONE ☐

2. NAME OF OPERATOR

McClellan Oil Corporation

3. ADDRESS OF OPERATOR

P.O. Drawer 730, Roswell, NM 88202

4. LOCATION OF WELL (Report location clearly and in accordance with any State requirements.)\*

At surface

660' FSL & 1980' FEL

At proposed prod. zone

RECEIVED BY

MAR -2 1987

O. C. D.

ARTESIA, OFFICE

ut. 0

14. DISTANCE IN MILES AND DIRECTION FROM NEAREST TOWN OR POST OFFICE\*

14 miles east of Roswell, N.M.

15. DISTANCE FROM PROPOSED\*

LOCATION TO NEAREST  
PROPERTY OR LEASE LINE, FT.  
(Also to nearest drlg. unit line, if any)

660'

16. NO. OF ACRES IN LEASE

1872.48

17. NO. OF ACRES ASSIGNED  
TO THIS WELL

160

18. DISTANCE FROM PROPOSED LOCATION\*

TO NEAREST WELL, DRILLING, COMPLETED,  
OR APPLIED FOR, ON THIS LEASE, FT.

5600'

19. PROPOSED DEPTH

4450'

20. ROTARY OR CABLE TOOLS

Rotary

21. ELEVATIONS (Show whether DF, RT, GR, etc.)

3630' G.L.

22. APPROX. DATE WORK WILL START\*

April 1, 1987

PROPOSED CASING AND CEMENTING PROGRAM

SIZE OF HOLE	SIZE OF CASING	WEIGHT PER FOOT	SETTING DEPTH	QUANTITY OF CEMENT
12-1/4"	8-5/8"	24	950'	500 sx Circulate
7-7/8"	4-1/2"	10.5	4450'	350 sx

Propose to drill to approximately 4450' to test the Abo formation. If production is indicated, will run casing and attempt completion.

Estimated formation tops: San Andres 584' Tubb 3189'  
Glorieta 1698' Abo 3935'

Gas is dedicated.



IN ABOVE SPACE DESCRIBE PROPOSED PROGRAM: If proposal is to deepen or plug back, give data on present productive zone and proposed new productive zone. If proposal is to drill or deepen directionally, give pertinent data on subsurface locations and measured and true vertical depths. Give blowout preventer program, if any.

SIGNED Mark McClellan

TITLE Geologist

DATE 2/3/87

(This space for Federal or State office use)

PERMIT NO. \_\_\_\_\_

APPROVAL DATE \_\_\_\_\_

APPROVED BY \_\_\_\_\_

S/Phil Kirk

Area Manager

FEB 24 1987

CONDITIONS OF APPROVAL, IF ANY:

TITLE \_\_\_\_\_

DATE \_\_\_\_\_

APPROVAL OF THIS APPLICATION DOES NOT WARRANT OR  
CERTIFY THAT THE APPLICANT HOLDS LEGAL OR EQUIPABLE  
TITLE TO THOSE RIGHTS IN THE SUBJECT LEASE WHICH WOULD  
ENTITLE THE APPLICANT TO CONDUCT OPERATIONS THEREON

All distances must be from the outer boundaries of the Section.

Operator McClellan Oil Corp.			Lease M.M. Federal		Well No. #4
Unit Letter 0	Section 25	Township 9 South	Range 25 East	County Chaves	
Actual Postage Location of Well: 1980 feet from the East line and 660 feet from the South line					
Ground Level Elev. 3630	Producing Formation Abo	Pool Pecos Slope Abo		Dedicated Acreages 160 Acres	

1. Outline the acreage dedicated to the subject well by colored pencil or hachure marks on the plat below.
2. If more than one lease is dedicated to the well, outline each and identify the ownership thereof (both as to working interest and royalty).
3. If more than one lease of different ownership is dedicated to the well, have the interests of all owners been consolidated by communitization, unitization, force-pooling, etc?

☐ Yes ☐ No If answer is "yes," type of consolidation \_\_\_\_\_

If answer is "no," list the owners and tract descriptions which have actually been consolidated. (Use reverse side of this form if necessary.) \_\_\_\_\_

No allowable will be assigned to the well until all interests have been consolidated (by communitization, unitization, forced-pooling, or otherwise) or until a non-standard unit, eliminating such interests, has been approved by the Division.

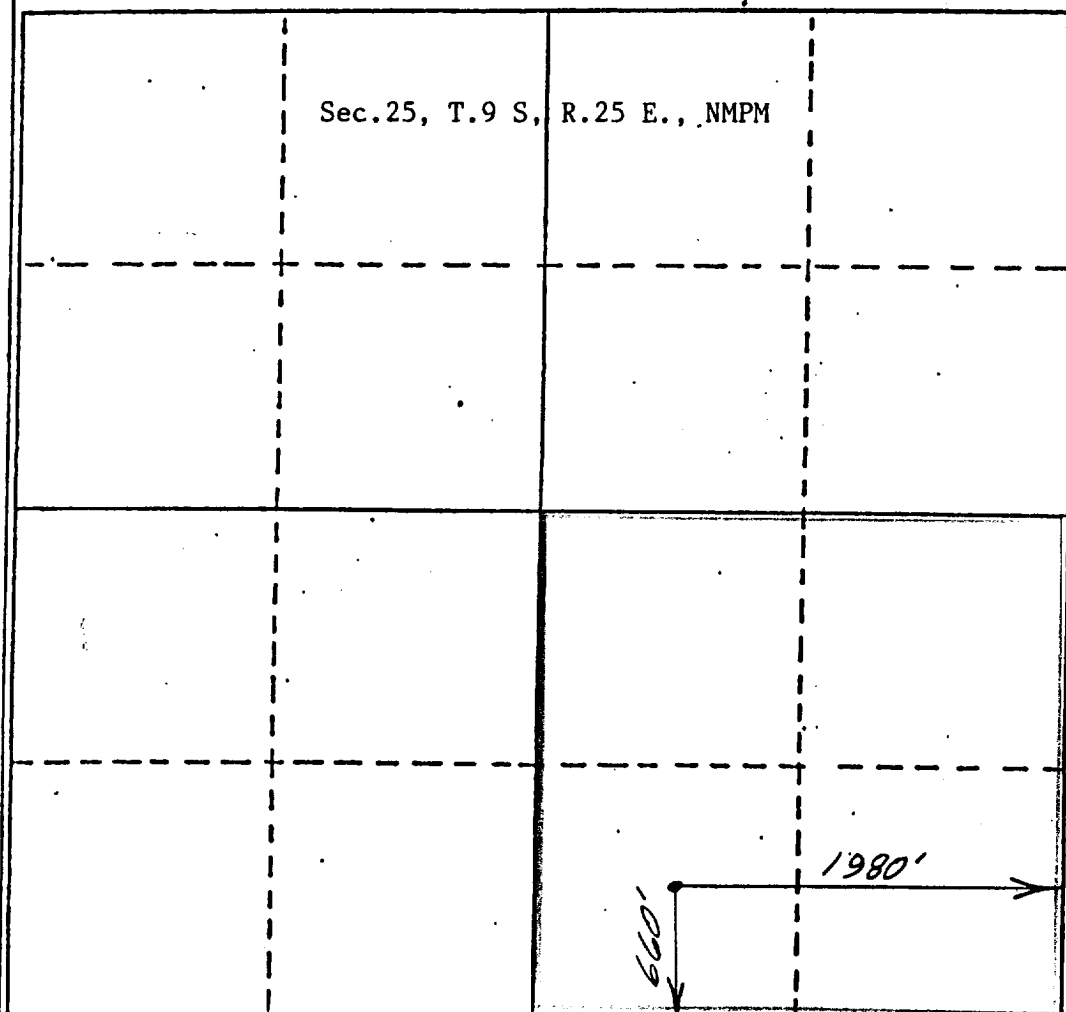
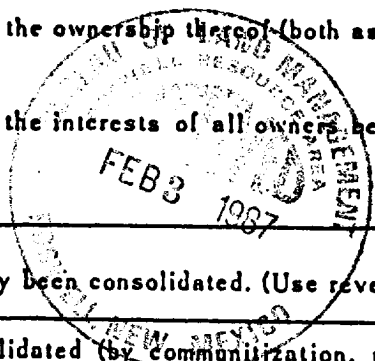

CERTIFICATION

I hereby certify that the information contained herein is true and complete to the best of my knowledge and belief.

*Mark McClellan*

Name

Mark McClellan

Position

Geologist

Company

McClellan Oil Corporation

Date

1/30/87

I hereby certify that the well location shown on this plat was plotted from field notes of actual surveys made by me or under my supervision, and that the same is true and correct to the best of my knowledge and belief.

JOHN D. JAQUESS  
NEW MEXICO  
Date Surveyed January 28, 1987  
Registered Professional Engineer and a Land Surveyor  
JOHN D. JAQUESS  
PROFESSIONAL ENGINEER & L.S.  
Certificate No. 6290

# BLOWOUT PREVENTER SPECIFICATION

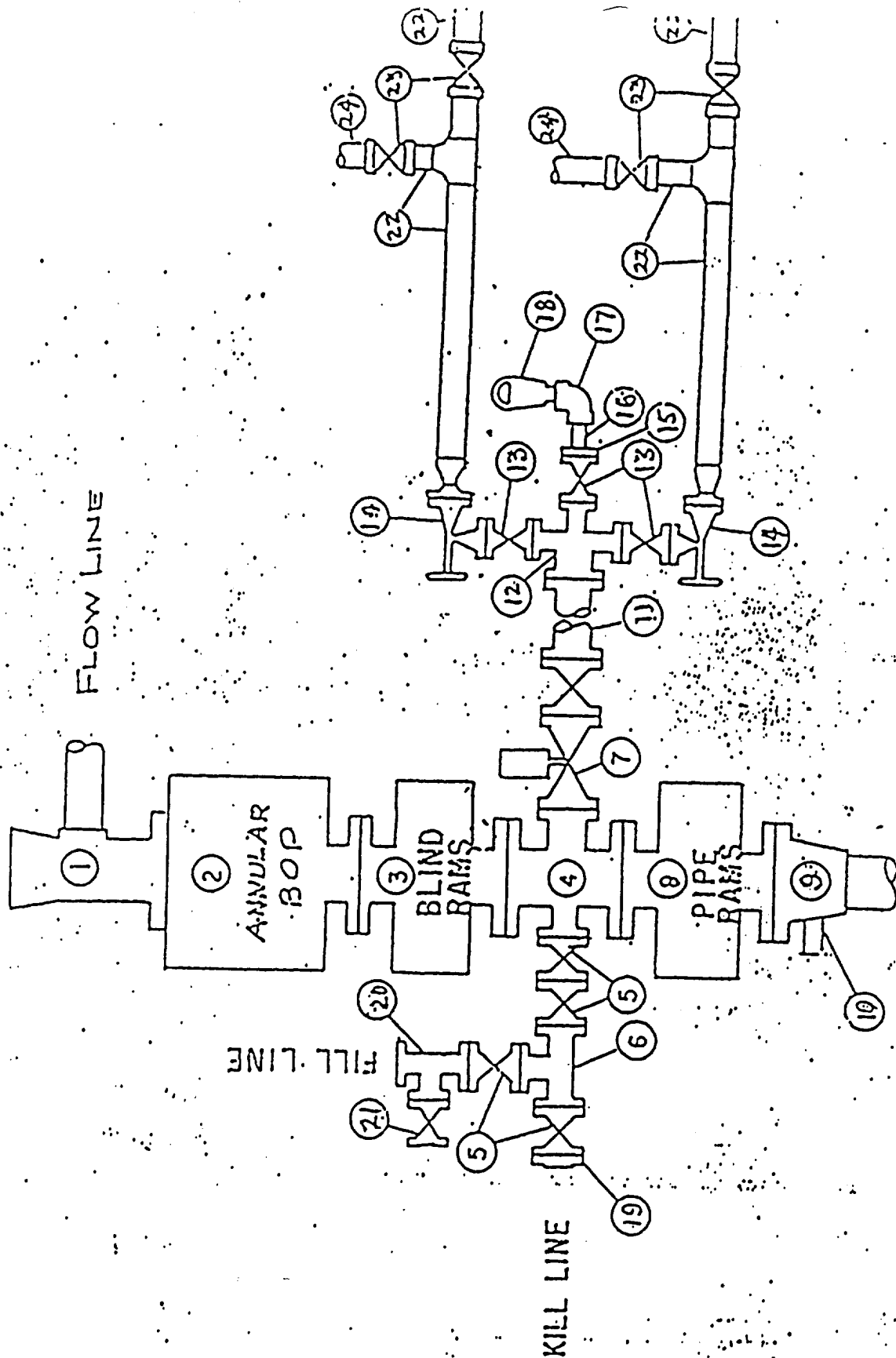

MM Fed. No. 4  
McClellan Oil Corp.

REQUIREMENTS  
(NTL-6)

1. Location: 660' FSL & 1980' FEL of Section 25-T9S-R25E
2. Elevation: 3630' G.L.
3. Geologic name of surface formation: See archaeological report
4. Type of drilling rig and associated equipment: Rotary
5. Proposed drilling depth and objective formation: 4450' - Abo
6. Estimated tops of geologic markers:

Yates	<u>          </u>	San Andres	<u>584'</u>	Abo	<u>3935'</u>
7-Rivers	<u>          </u>	Glorieta	<u>1698'</u>	Wolfcamp	<u>          </u>
Queen	<u>          </u>	Tubb	<u>3189'</u>		
7. Estimated depths of any oil, water, or gas: Possible gas from 3935' to 4450'
- 8-9. Proposed casing program:

<u>8-5/8" @ 950'</u>	<u>Grade J-55</u>	<u>Wt. 24 lb.</u>	<u>Type Cement Class "C"</u>
<u>4-1/2" @ 4450'</u>	<u>Grade J-55</u>	<u>Wt. 10.5 lb.</u>	<u>Type Cement Class "C"</u>
10. Specifications for pressure control equipment and testing procedures:  
Schaeffer type E 10" series 900 hydraulic BOP
11. Type and characteristics of drilling fluids: Drill to top of Abo with native mud. Mud up 100' above Abo with salt base gel, 45 visc., 9.5 lb/gal weight & 15 cc water loss.
12. Testing, logging, and coring programs: No D.S.T.'s or coring is anticipated. Will run-CNL-LDT, DLL Gamma Ray Logs.
13. Anticipated abnormal pressures or temperature: None
14. Anticipated commencement and completion date:  
April 1, 1987 - April 15, 1987



McCLELLAN OIL CORPORATION  
SUGGESTED PAD DIMENSIONS

Reserve Pits 4 ft. deep, plastic lined

Working pits 5 ft. deep

No cellar

