

UNITED STATES
DEPARTMENT OF THE INTERIOR
GEOLOGICAL SURVEY

SUNDRY NOTICES AND REPORTS ON WELLS

(Do not use this form for proposals to drill or to deepen or plug back to a different reservoir. Use Form 9-331-C for such proposals.)

1. oil ☐ well gas ☒ well other

2. NAME OF OPERATOR
McClellan Oil Corporation

3. ADDRESS OF OPERATOR
P. O. Drawer 730, Roswell, NM 88202

4. LOCATION OF WELL (REPORT LOCATION CLEARLY. See space 17 below.)

AT SURFACE: 660' FSL & 1980 FEL
AT TOP PROD. INTERVAL: Same
AT TOTAL DEPTH: Same

16. CHECK APPROPRIATE BOX TO INDICATE NATURE OF NOTICE, REPORT, OR OTHER DATA

REQUEST FOR APPROVAL TO:

TEST WATER SHUT-OFF ☐
FRACTURE TREAT ☐
SHOOT OR ACIDIZE ☐
REPAIR WELL ☐
PULL OR ALTER CASING ☐
MULTIPLE COMPLETE ☐
CHANGE ZONES ☐
ABANDON* ☐

SUBSEQUENT REPORT OF:

☐
☐
☐
☐
☐
☐
☐
☐

(other) Request for natural gas pipeline "on-lease" right of way.

17. DESCRIBE PROPOSED OR COMPLETED OPERATIONS (Clearly state all pertinent details, and give pertinent dates, including estimated date of starting any proposed work. If well is directionally drilled, give subsurface locations and measured and true vertical depths for all markers and zones pertinent to this work.)*

McClellan Oil Corp. hereby applies for approximately 1400 feet of "on-lease" right of way for a natural gas pipeline to run east from the MM Fed., No. 4 wellsite in the SW $\frac{1}{4}$, SE $\frac{1}{4}$ of section 25 to the main north/south gathering line of Transwestern Pipeline Co. in the SE $\frac{1}{4}$, SE $\frac{1}{4}$ of section 25. A hot tap will be made at this location, requiring the placing of the meter at this point. This will require the construction of a service road to be graded and topped with compacted caliche 12 feet wide and properly drained. The request is for a 20 foot right of way to dig and bury a 3000 PSI tested 2 3/8" tubing to a maximum depth of 24 inches and construct the 12 wide service road. See Exhibit "A" and "B" for maps. An Archaeological survey has been submitted.

Subsurface Safety Valve: Manu. and Type _____ Set @ _____ Ft.

18. I hereby certify that the foregoing is true and correct

Agent for:

SIGNED George K. Smith TITLE McClellan Oil Corp. DATE March 11, 1987

(This space for Federal or State office use)

APPROVED BY Philip Kirk
CONDITIONS OF APPROVAL, IF ANY:

TITLE Area Manager

DATE MAR 30 1987

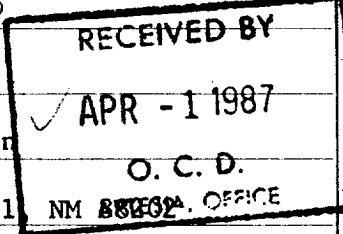

5. LEASE
NM-055993

6. IF INDIAN, ALLOTTEE OR TRIBE NAME

7. UNIT AGREEMENT NAME

8. FARM OR LEASE NAME
MM Federal

9. WELL NO.
4

10. FIELD OR WILDCAT NAME
S. Pecos Slope Abo

11. SEC., T., R., M., OR BLK. AND SURVEY OR AREA
Sec. 25-T9S-R25E

12. COUNTY OR PARISH
Chaves

13. STATE
New Mexico

14. API NO.

15. ELEVATIONS (SHOW DF, KDB, AND WD)
3630' GL

(NOTE: Report results of multiple completion or zone change on Form 9-330.)

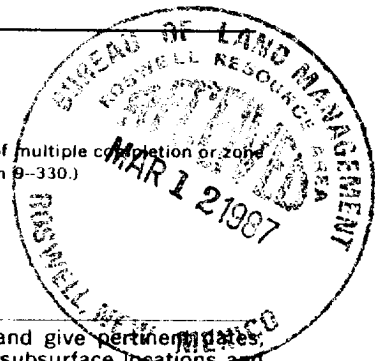

CHAVES COUNTY, NEW MEXICO

SECTION 25-T9S-R25E

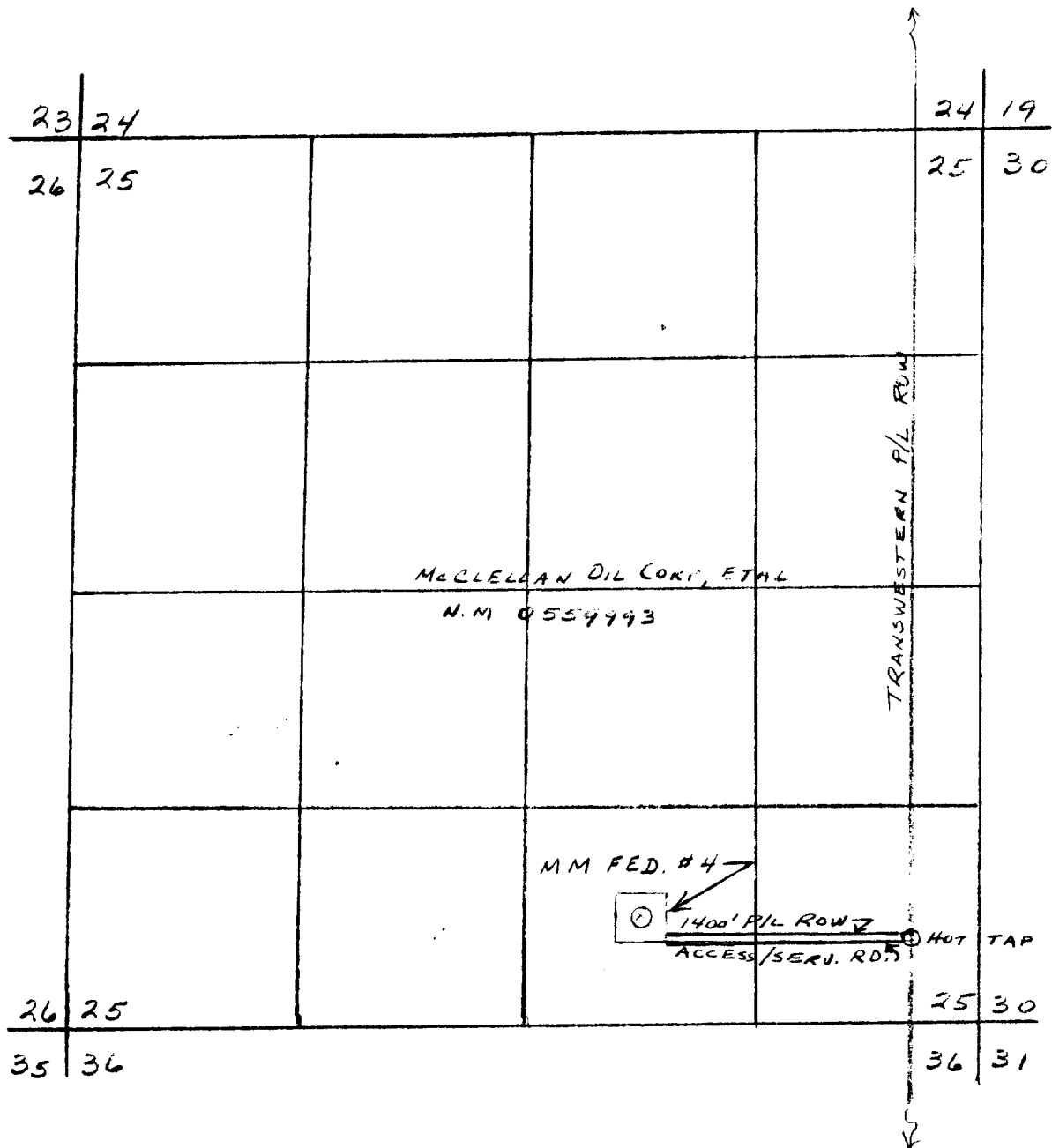

EXHIBIT "B"

McCLELLAN OIL CORP.

MM Federal, Well No. 4

Proposed 2 3/8" Natural Gas Pipeline
Crossing Federal Surface

Date: March 11, 1987

Scale: 1" = 1,000'