

Drawer DD

ARTESIA, NM 88210 UNITED STATES
DEPARTMENT OF THE INTERIOR
GEOLOGICAL SURVEY

30-005-62466

5. LEASE DESIGNATION AND SERIAL NO.

NM-35925

6. IF INDIAN, ALLOTTEE OR TRIBE NAME

7. UNIT AGREEMENT NAME

8. FARM OR LEASE NAME

Dana Fed.

9. WELL NO.

5

10. FIELD AND POOL, OR WILDCAT

Pecos Slope Abo

11. SEC., T., R., M., OR BLK.
AND SURVEY OR AREA

Sec. 4-T9S-R25E

12. COUNTY OR PARISH

Chaves

13. STATE
N.M.

APPLICATION FOR PERMIT TO DRILL, DEEPEN, OR PLUG BACK

1a. TYPE OF WORK

DRILL ☒DEEPEN ☐PLUG BACK ☐

b. TYPE OF WELL

OIL
WELL ☐GAS
WELL ☒

OTHER

SINGLE
ZONE ☐MULTIPLE
ZONE ☐

2. NAME OF OPERATOR

McClellan Oil Corp.

3. ADDRESS OF OPERATOR

P.O. Drawer 730, Roswell, New Mexico 88202

4. LOCATION OF WELL (Report location clearly and in accordance with any State requirements.)*

At surface

660' FSL & 1980' FWL

At proposed prod. zone

14. DISTANCE IN MILES AND DIRECTION FROM NEAREST TOWN OR POST OFFICE*

10 miles northeast of Roswell, New Mexico

15. DISTANCE FROM PROPOSED*

LOCATION TO NEAREST
PROPERTY OR LEASE LINE, FT.
(Also to nearest drlg. unit line, if any)

660'

16. NO. OF ACRES IN LEASE

1,200

17. NO. OF ACRES ASSIGNED
TO THIS WELL

160

18. DISTANCE FROM PROPOSED LOCATION*

TO NEAREST WELL, DRILLING, COMPLETED,
OR APPLIED FOR, ON THIS LEASE, FT.

2648'

19. PROPOSED DEPTH

4275'

20. ROTARY OR CABLE TOOLS

Rotary

21. ELEVATIONS (Show whether DF, RT, GR, etc.)

3,618 GL

22. APPROX. DATE WORK WILL START*

May 1, 1987

23.

PROPOSED CASING AND CEMENTING PROGRAM

SIZE OF HOLE	SIZE OF CASING	WEIGHT PER FOOT	SETTING DEPTH	QUANTITY OF CEMENT
12 3/4"	8 5/8"	23 lb.	900'	500 sx circulated
7 7/8"	4 1/2"	10.5 lb.	4,275	350 sx

Propose to drill to approximately 4,275' to test the Abo formation.

If commercial production is indicated, will, production csg. and attempt
completion.
runEstimated formation tops: San Andres - 406'
Glorieta - 1,478'Tubb - 2,973'
Abo - 3,678'

Gas is dedicated

IN ABOVE SPACE DESCRIBE PROPOSED PROGRAM: If proposal is to deepen or plug back, give data on present productive zone and proposed new productive zone. If proposal is to drill or deepen directionally, give pertinent data on subsurface locations and measured and true vertical depths. Give blowout preventer program, if any.

24.

SIGNED

Mark McClellan

TITLE

Geologist

DATE

February 10, 1987

(This space for Federal or State office use)

PERMIT NO.

APPROVAL DATE

APPROVED BY

S/Jan Dana, Acting

TITLE

Area Manager

DATE

MAR 17 1987

CONDITIONS OF APPROVAL, IF ANY:

THIS APPROVAL APPLIES ONLY TO WELL AND ACCESS ROAD.

APPROVAL FOR AN ASSOCIATED PIPELINE IS NOT GRANTED.

APPROVAL OF THIS APPLICATION DOES NOT WARRANT OR
CERTIFY THAT THE APPLICANT HOLDS LEGAL OR EQUITABLE
TITLE TO THOSE RIGHTS IN THE SUBJECT LEASE WHICH WOULD
ENTITLE THE APPLICANT TO CONDUCT OPERATIONS THEREON.
See Instructions On Reverse Side

All distances must be from the outer boundaries of the Section.

Operator McClellan Oil Corp.			Lease Dana Federal			Well No. #5		
Unit Letter N	Section 4	Township 9 South		Range 25 East	County Chaves			
Actual Footage Location of Well: 1980 feet from the West line and 660 feet from the South line								
Ground Level Elev. 3618	Producing Formation Abo		Pool S. Pecos Slope Abo			Dedicated Acreage: 160 Acres		

1. Outline the acreage dedicated to the subject well by colored pencil or bookcase marks on the plat below.
2. If more than one lease is dedicated to the well, outline each and identify the ownership thereof (both as to working interest and royalty).
3. If more than one lease of different ownership is dedicated to the well, have the interests of all owners been consolidated by communitization, unitization, force-pooling, etc?

☐ Yes ☐ No If answer is "yes," type of consolidation _____

If answer is "no," list the owners and tract descriptions which have actually been consolidated. (Use reverse side of this form if necessary.) _____

No allowable will be assigned to the well until all interests have been consolidated (by communitization, unitization, forced-pooling, or otherwise) or until a non-standard unit, eliminating such interests, has been approved by the Division.

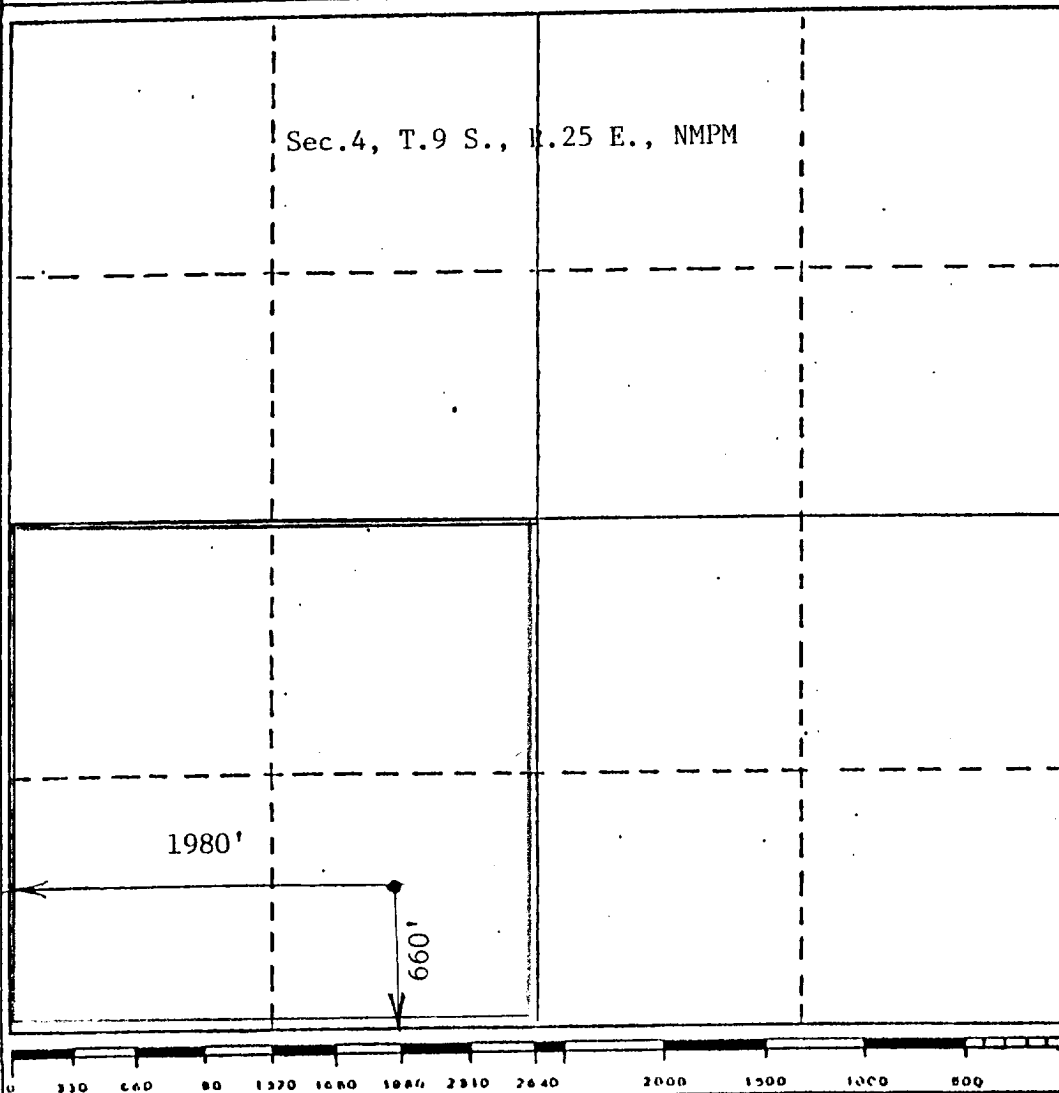
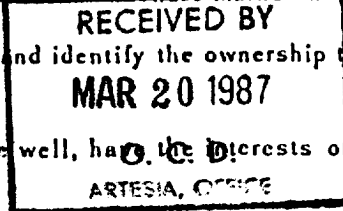

CERTIFICATION

I hereby certify that the information contained herein is true and complete to the best of my knowledge and belief.

Mark McClellan

Name

Mark McClellan

Position

Geologist

Company

McClellan Oil Corp.

Date

February 10, 1987

I hereby certify that the well location shown on this plat was plotted from field notes of actual surveys made by me or under my supervision, and that the same is true and correct to the best of my knowledge and belief.

Date Surveyed

February 10, 1987

Registered Professional Engineer and/or Land Surveyor

John D. Jaquess, P.E., L.S.

Certificate No.

6290

BLOWOUT PREVENTER SPECIFICATION

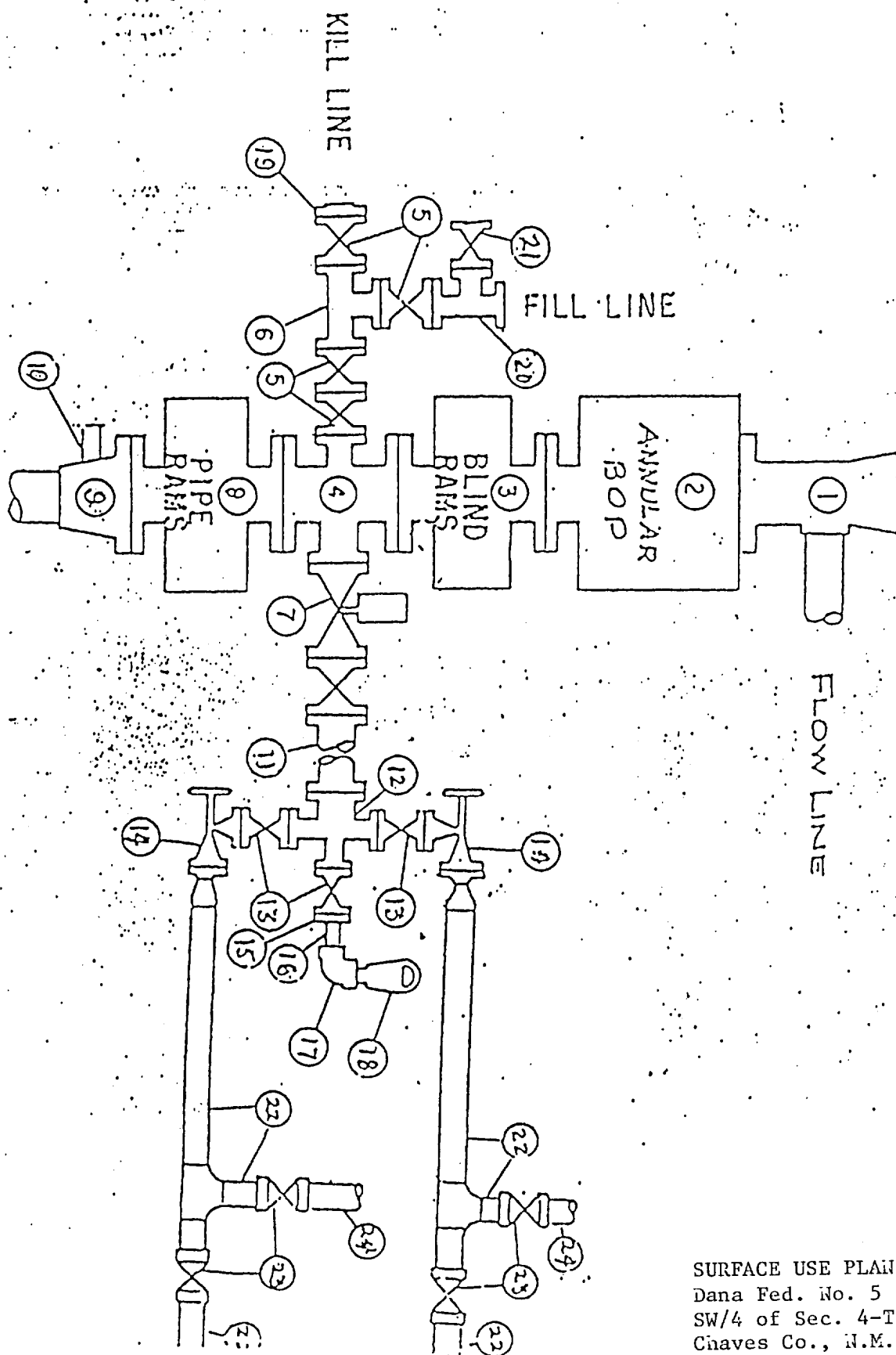

SURFACE USE PLAN EXHIBIT "E"
 Dana Fed. No. 5
 SW/4 of Sec. 4-T9S-R25E
 Chaves Co., N.M.

Dana Fed. No. 5
McClellan Oil Corp.

REQUIREMENTS
(NTL-6)

1. Location: 660' FSL & 1980' FWL of Section 4-T9S-R25E
2. Elevation: 3618' G.L.
3. Geologic name of surface formation: See archaeological report
4. Type of drilling rig and associated equipment: Rotary
5. Proposed drilling depth and objective formation: 4275' - Abo
6. Estimated tops of geologic markers:

Yates	<u> </u>	San Andres	<u>406'</u>	Abo	<u>3678'</u>
7-Rivers	<u> </u>	Glorieta	<u>1478'</u>	Wolfcamp	<u> </u>
Queen	<u> </u>	Tubb	<u>2973'</u>		
7. Estimated depths of any oil, water, or gas: Possible gas from 3678' to 4275'.
- 8-9. Proposed casing program:

<u>8-5/8" @ 900'</u>	<u>Grade J-55</u>	<u>Wt. 23 lb.</u>	<u>Type Cement Class "C"</u>
<u>4-1/2" @ 4275'</u>	<u>Grade J-55</u>	<u>Wt. 10.5 lb.</u>	<u>Type Cement Class "C"</u>
10. Specifications for pressure control equipment and testing procedures:
Schaeffer type E 10" series 900 hydraulic BOP
11. Type and characteristics of drilling fluids: Drill to top of Abo with native mud. Mud up 100' above Abo with salt base gel, 45 visc., 9.5 lb/gal weight & 15 cc water loss.
12. Testing, logging, and coring programs: No D.S.T.'s or coring is anticipated. Will run CNL-LDT & DLL gamma ray logs.
13. Anticipated abnormal pressures or temperature: None
14. Anticipated commencement and completion date:
May 1, 1987 to May 15, 1987

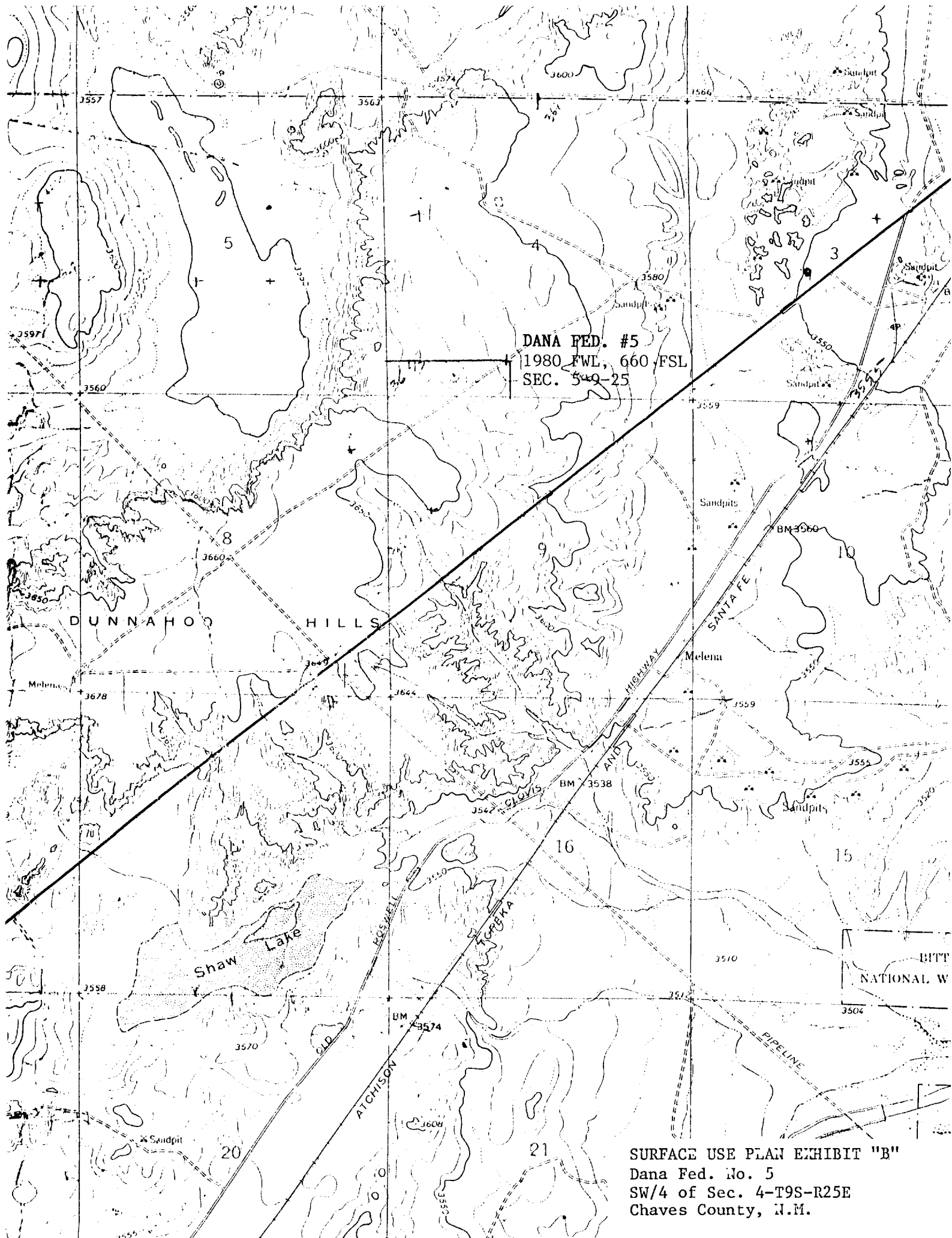

DANA FED. #5
1980 FWL, 660 FSL
SEC. 5-9-25

SURFACE USE PLAN EXHIBIT "B"
Dana Fed. No. 5
SW/4 of Sec. 4-T9S-R25E
Chaves County, N.M.

McCLELLAN OIL CORPORATION
SUGGESTED PAD DIMENSIONS

Reserve Pits 4 ft. deep, plastic lined

Working pits 5 ft. deep

No cellar

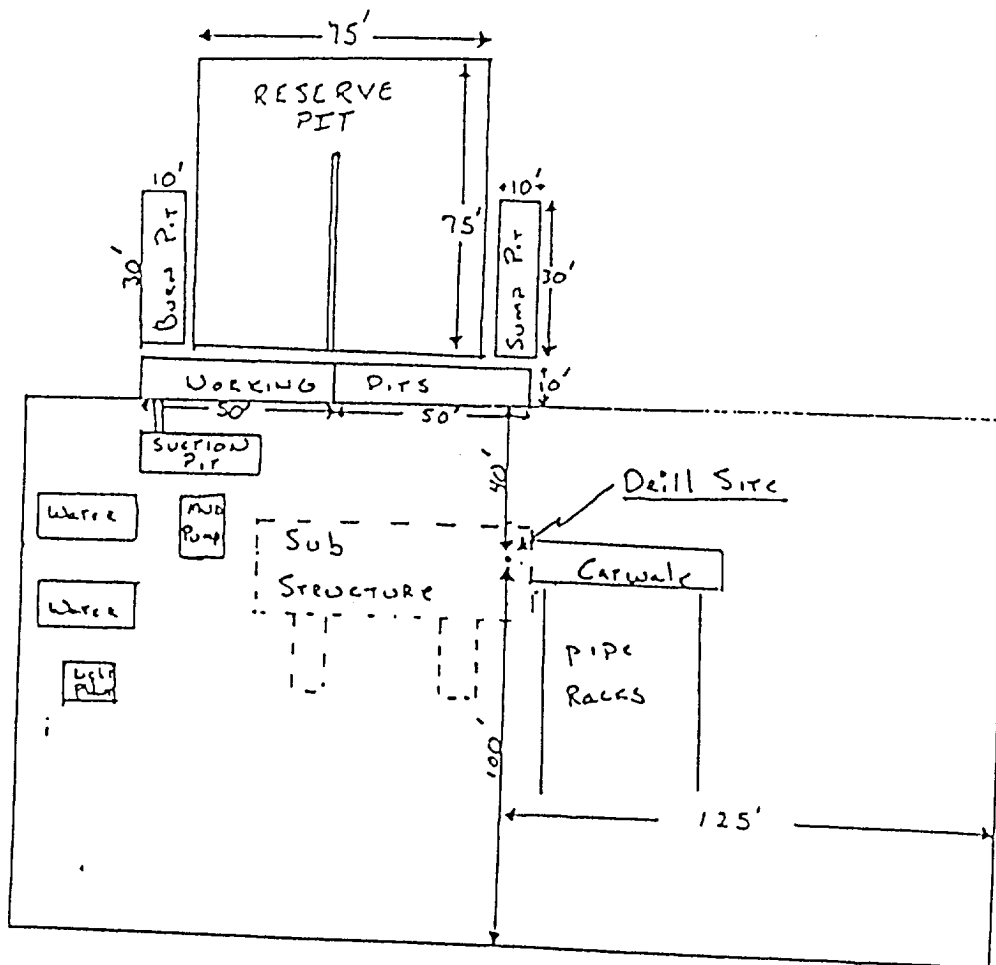

Scale 1" = 50'

South

SURFACE USE PLAN EXHIBIT "D"
 Dana Fed. No. 5
 SW/4 of Sec. 4-T9S-R25E
 Chaves County, N.M.