

UNITED STATES  
DEPARTMENT OF THE INTERIOR  
GEOLOGICAL SURVEY

SUNDRY NOTICES AND REPORTS ON WELLS

(Do not use this form for proposals to drill or to deepen or plug back to a different reservoir. Use Form 9-331-C for such proposals.)

1. oil ☐ gas ☒ other ☐

2. NAME OF OPERATOR

McClellan Oil Corp.

3. ADDRESS OF OPERATOR

P. O. Drawer 730, Roswell, New Mexico 88202

4. LOCATION OF WELL (REPORT LOCATION CLEARLY. See space 17 below.)

AT SURFACE: 660' FSL & 1980' FWL

AT TOP PROD. INTERVAL: Same

AT TOTAL DEPTH: Same

16. CHECK APPROPRIATE BOX TO INDICATE NATURE OF NOTICE, REPORT, OR OTHER DATA

REQUEST FOR APPROVAL TO:

TEST WATER SHUT-OFF ☐  
FRACTURE TREAT ☐  
SHOOT OR ACIDIZE ☐  
REPAIR WELL ☐  
PULL OR ALTER CASING ☐  
MULTIPLE COMPLETE ☐  
CHANGE ZONES ☐  
ABANDON\* ☐

SUBSEQUENT REPORT OF:

☐  
☐  
☐  
☐  
☐  
☐  
☐  
☐

(other) Request for gas pipeline "on-lease" Right-of-Way

17. DESCRIBE PROPOSED OR COMPLETED OPERATIONS (Clearly state all pertinent details, and give pertinent dates, including estimated date of starting any proposed work. If well is directionally drilled, give subsurface locations and measured and true vertical depths for all markers and zones pertinent to this work.)\*

McClellan Oil Corp. hereby applies for approximately 1320 feet of "on-lease" right-of-way for a gas pipeline to run east from the Dana Fed., No. 5 wellsite in the SE $\frac{1}{4}$ , SW $\frac{1}{4}$  of section 4 to the gas gathering system at the wellsite of the Dana Fed., No. 1 in the SE $\frac{1}{4}$ , SE $\frac{1}{4}$  of section 4. The request is for a 15 foot right of way to dig and bury a 3000 PSI test 4" line pipe to a maximum depth of 24 inches. The total length of the pipeline will be approximately 2400 feet with 1100 feet on private surface. See Exhibit "A" and "B" for maps. An archaeological survey has been submitted to the appropriate government agencies.

Subsurface Safety Valve: Manu. and Type \_\_\_\_\_ Set @ \_\_\_\_\_ Ft.

18. I hereby certify that the foregoing is true and correct.

Agent for:

SIGNED George Smith TITLE McClellan Oil Corp. DATE March 11, 1987

(This space for Federal or State office use)

APPROVED BY S/Phil Kirk  
CONDITIONS OF APPROVAL, IF ANY:

TITLE

Area Manager

DATE

MAR 30 1987

CHAVEZ COUNTY, NEW MEXICO  
SECTION 4, T9S-R25E

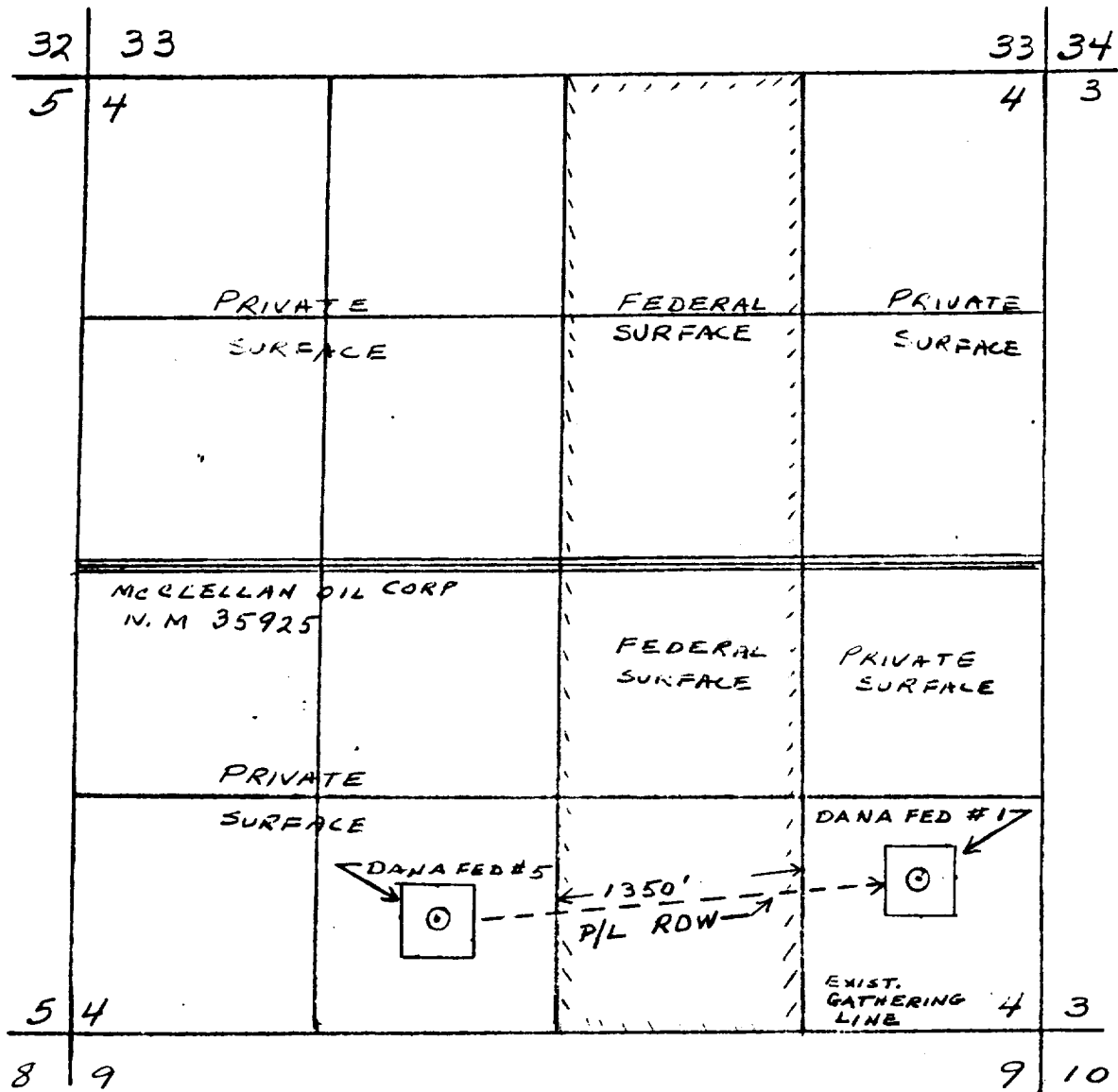

EXHIBIT "B"  
MCLELLAN OIL CORP.  
Dana Federal, Well No. 5  
Proposed 4" Natural Gas Pipeline Crossing  
Federal Surface  
and Private Surface

Date: March 11, 1987  
Scale: 1" = 1,000'