

NO. OF COPIES RECEIVED	
DISTRIBUTION	
SANTA FE	
FILE	
U.S.G.S.	
LAND OFFICE	
OPERATOR	

NEW MEXICO CONSERVATION COMMISSION

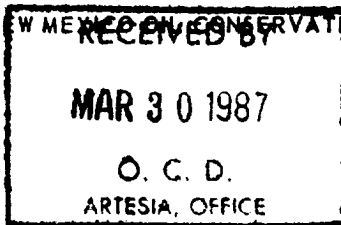

Form C-101

30-025-62471

5A. Indicate Type of Lease

STATE ☒ FEE ☐

5. State Oil & Gas Lease No.

LG-5564

APPLICATION FOR PERMIT TO DRILL, DEEPEN, OR PLUG BACK

1a. Type of Work		7. Unit Agreement Name	
b. Type of Well OIL WELL <input type="checkbox"/> GAS WELL <input checked="" type="checkbox"/> OTHER <input type="checkbox"/>		8. Farm or Lease Name Altered State	
2. Name of Operator Harvard Petroleum Corp.		9. Well No. # 1	
3. Address of Operator P.O. Box 936, Roswell N.M. 88201		10. Field and Pool, or Wildcat Undesignated West Pecos Abo Slope	
4. Location of Well UNIT LETTER M LOCATED 660 FEET FROM THE South LINE AND 660 FEET FROM THE West LINE OF SEC. 27 TWP. 5 S RGE. 22 E NMPM		12. County Chaves	
19. Proposed Depth 4500'		19A. Formation Abo	
20. Rotary or C.T. Rotary		21. Elevations (Show whether DF, RL, etc.) GL. - 4155	
21A. Kind & Status Plug. Bond Blanket		21B. Drilling Contractor Rio Grande Drilling	
22. Approx. Date Work will start April 15, 1987			

23.

PROPOSED CASING AND CEMENT PROGRAM

SIZE OF HOLE	SIZE OF CASING	WEIGHT PER FOOT	SETTING DEPTH	SACKS OF CEMENT	EST. TOP
12-1/4	8 5/8	24#	900'	850 sx	Surface
7-7/8	4 1/2	10.5#	4500	1575	

Mud Program - Fresh water to 900'. Gelled water to T.D.  
BOP installed on 8-5/8" casing.

FOR 180 DAYS  
10/1/87  
UNDERWAY

IN ABOVE SPACE DESCRIBE PROPOSED PROGRAM; IF PROPOSAL IS TO DEEPEN OR PLUG BACK, GIVE DATA ON PRESENT PRODUCTIVE ZONE AND PROPOSED NEW PRODUCTIVE ZONE. GIVE BLOWOUT PREVENTER PROGRAM, IF ANY.

I hereby certify that the information above is true and complete to the best of my knowledge and belief.

Signed [Signature] Title Vice President Operations Date March 30, 1987

(This space for State Use)

Original Signed By  
Mike Williams

APPROVED BY Oil & Gas Inspector

DATE MAR 31 1987

CONDITIONS OF APPROVAL, IF ANY:

4/55

STATE OF NEW MEXICO  
ENERGY AND MINERALS DEPARTMENT

## OIL CONSERVATION DIVISION

P. O. BOX 2088

SANTA FE, NEW MEXICO 875

Form C-102  
Revised 10-1-78

All distances must be from the outer boundaries of the Section.

Operator Harvard Petroleum Corp.			Lease Altered State		Well No. # 1
Unit Letter M	Section 27	Township 5 SOUTH	Range 22 EAST	County CHAVES	
Actual Footage Location of Well: 660 feet from the SOUTH line and 660 feet from the WEST line					
Ground Level Elev. 4155	Producing Formation Abo	Pool Undesignated W. Pecos Abo Slope		Dedicated Acreage 162 Acres	

1. Outline the acreage dedicated to the subject well by colored pencil or hatchure marks on the plat below.
2. If more than one lease is dedicated to the well, outline each and identify the ownership thereof (both as to working interest and royalty).
3. If more than one lease of different ownership is dedicated to the well, have the interests of all owners been consolidated by communitization, unitization, force-pooling, etc?

☐ Yes ☐ No If answer is "yes," type of consolidation \_\_\_\_\_

If answer is "no," list the owners and tract descriptions which have actually been consolidated. (Use reverse side of this form if necessary.) \_\_\_\_\_

No allowable will be assigned to the well until all interests have been consolidated (by communitization, unitization, forced-pooling, or otherwise) or until a non-standard unit, eliminating such interests, has been approved by the Division.

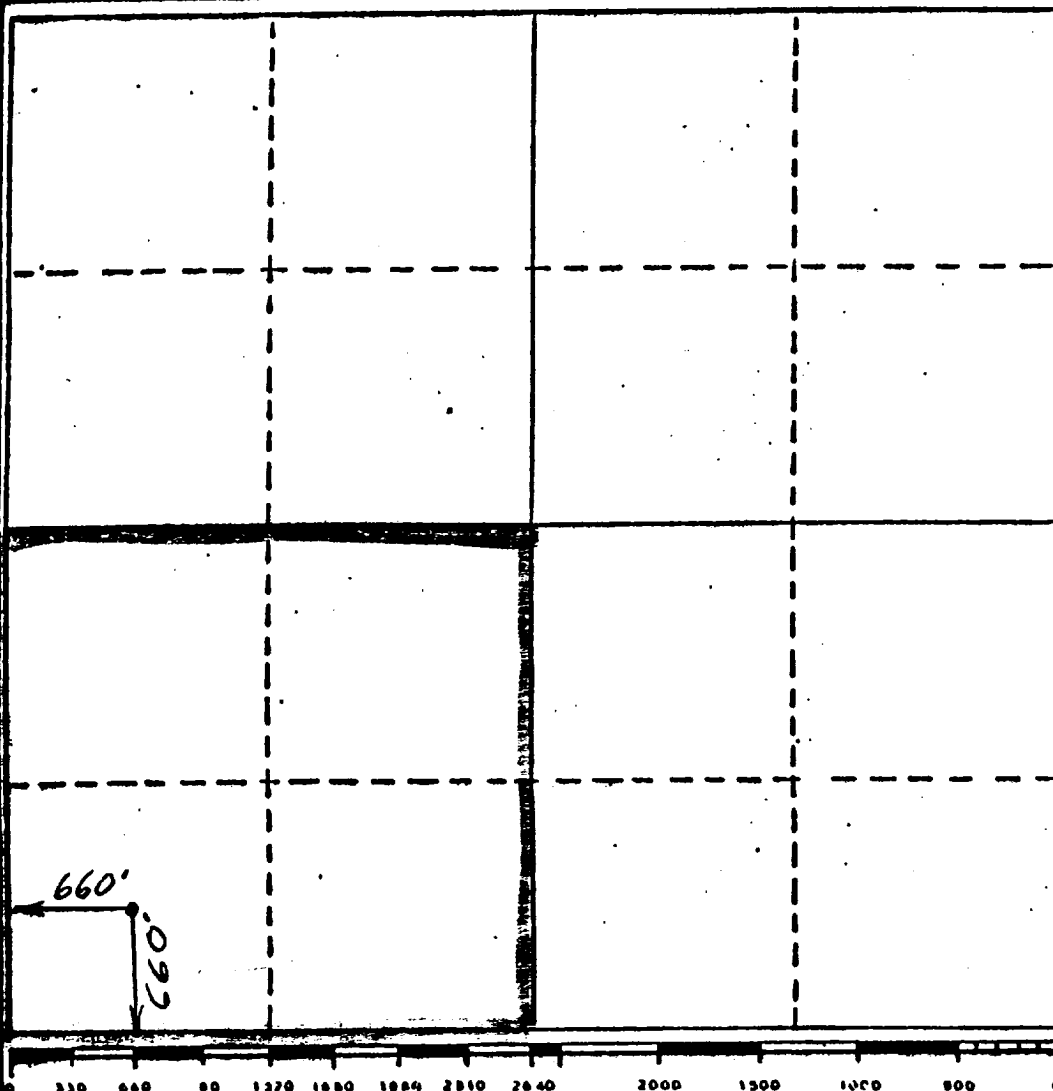

## CERTIFICATION

I hereby certify that the information contained herein is true and complete to the best of my knowledge and belief.

Name

Agent

Position

Harvard Petroleum Corp.

Company

March 30, 1987

Date

I hereby certify that the well location shown on this plat was plotted from field notes of actual surveys made by me or under my supervision, and that the same is true and correct to the best of my knowledge and belief.

Date Surveyed

MARCH 25, 1987

Registered Professional Engineer and/or Land Surveyor

John D. Jaquess, N.E. &amp; L.S.

Certificate No. 6290

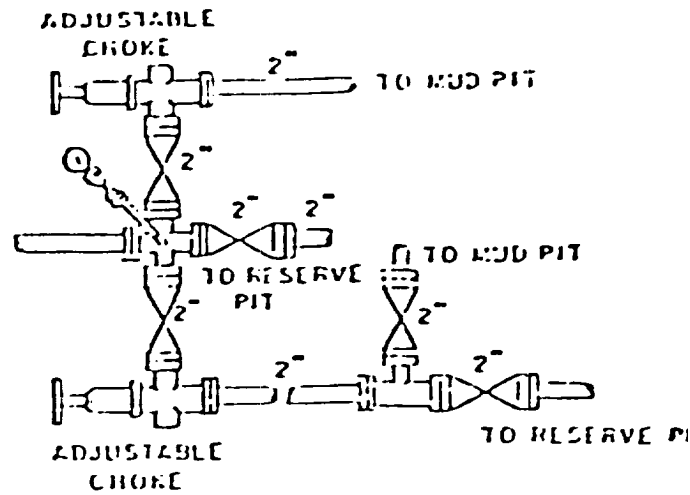
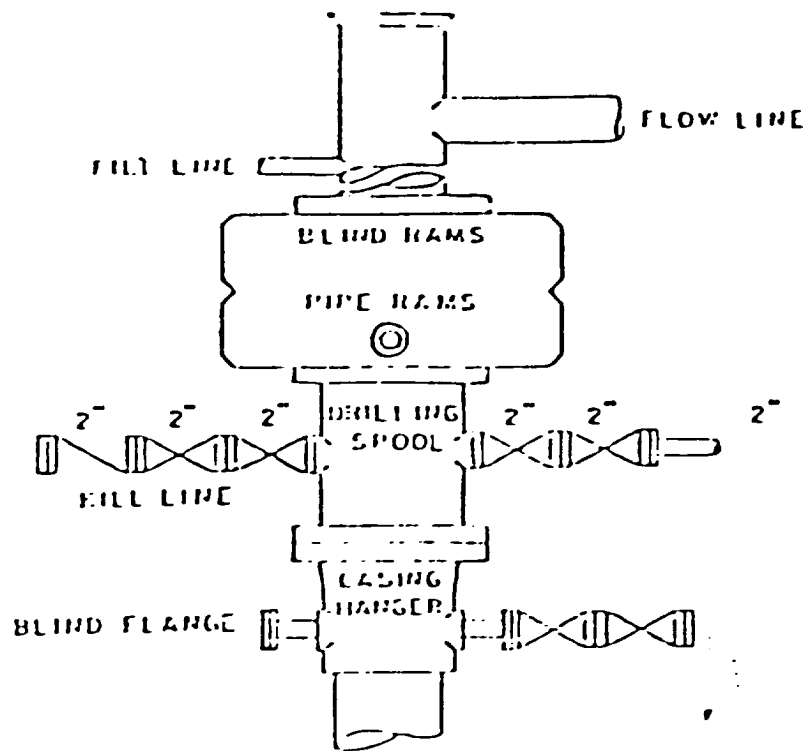

### ROP DIAGRAM

3000# Working Pressure  
Rams Operated Daily

EXHIBIT 11