

## OIL CONSERVATION DIVISION

STATE OF NEW MEXICO  
ENERGY AND MINERALS DEPARTMENTP. O. BOX 2088  
SANTA FE, NEW MEXICO 87501Form C-102  
Revised 10-1-78

All distances must be from the outer boundaries of the Section.

Operator McClellan Oil Corp.			Lease McCreath Fee		Well No. #2
Unit Letter B	Section 1	Township 10 South	Range 25 East	County Chaves	
Actual Footage Location of Well:					
235 feet from the North		line and 1695		feet from the East line	
Ground Level Elev. 3663	Producing Formation Abo	Pool Pecos Slope Abo		Dedicated Acreage: 160 Acres	

1. Outline the acreage dedicated to the subject well by colored pencil or hatchure marks on the plat below.
2. If more than one lease is dedicated to the well, outline each and identify the owners, if thereof (both as to working interest and royalty).
3. If more than one lease of different ownership is dedicated to the well, have the interests of all owners been consolidated by communitization, unitization, force-pooling, etc?

☒ Yes ☐ No If answer is "yes," type of consolidation Communitization

If answer is "no," list the owners and tract descriptions which have actually been consolidated. (Use reverse side of this form if necessary.)

No allowable will be assigned to the well until all interests have been consolidated (by communitization, unitization, forced-pooling, or otherwise) or until a non-standard unit, eliminating such interests, has been approved by the Division.

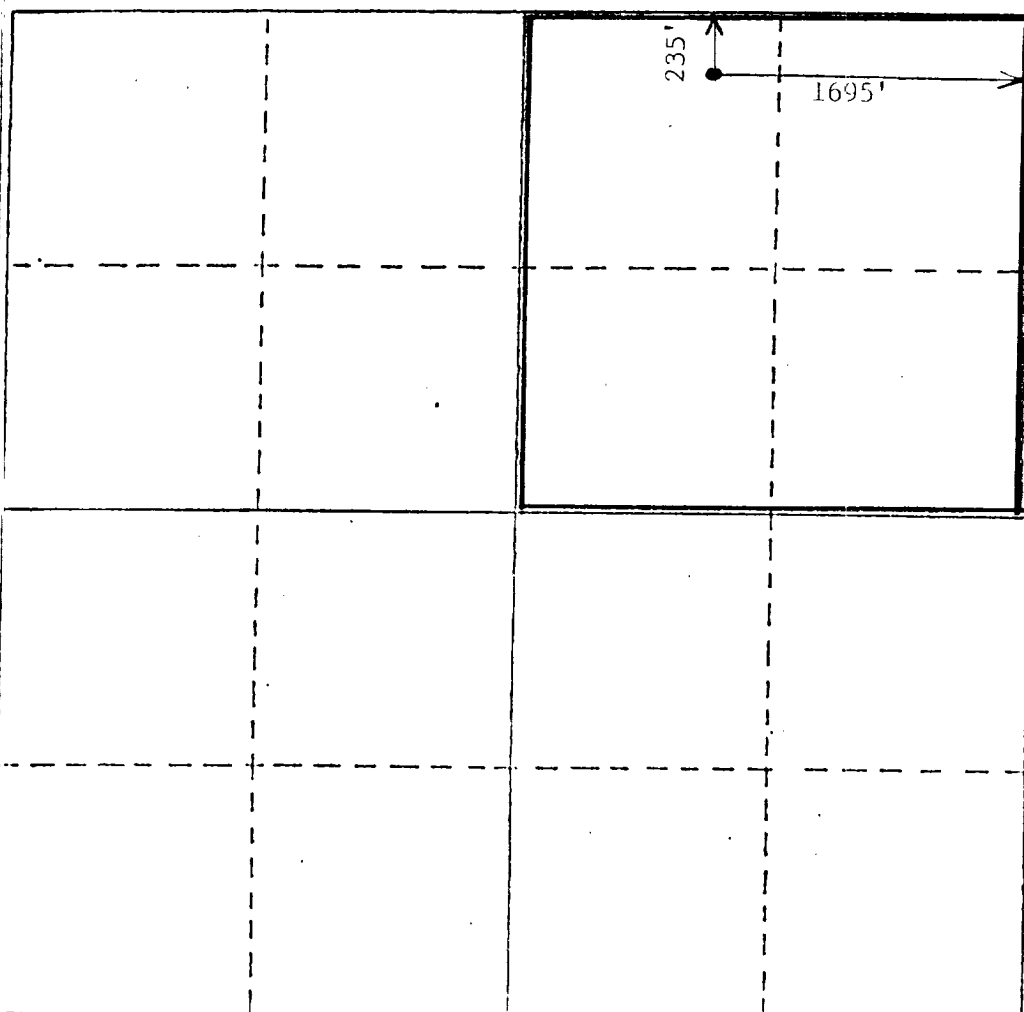

## CERTIFICATION

I hereby certify that the information contained herein is true and complete to the best of my knowledge and belief.

*Mark McClellan*

Name

Mark McClellan

Position

Geologist

Company

McClellan Oil Corp.

Date

February 13, 1987

I hereby certify that the well location shown on this plat was plotted from field notes of actual surveys made by me or under my supervision, and that the same is true and correct to the best of my knowledge and belief.

Data Reviewed

February 13, 1987

Registered Professional Engineer and/or Land Surveyor

John D. Jaquess, P.E. &amp; L.S.

Certificate No. 6290