

NM Oil Cons.
Drawer DD
Artesia, NM 88210

Form 9-331
(May 1983)

UNITED STATES
DEPARTMENT OF THE INTERIOR
GEOLOGICAL SURVEY

SUBMIT IN TRIPLICATE*
RECEIVED
(Indicate actions on reverse side)

Form approved.
Budget Bureau No. 42-R1424.

5. LEASE DESIGNATION AND SERIAL NO.

NM-0559993

6. IF INDIAN, ALLOTTEE OR TRIBE NAME

7. UNIT AGREEMENT NAME

8. FARM OR LEASE NAME

MM Federal

9. WELL NO.

7

10. FIELD AND POOL, OR WILDCAT

Pecos Slope Abo

11. SEC., T., R., M., OR BLK. AND SURVEY OR AREA

Sec. 25-T9S-R25E

12. COUNTY OR PARISH

Chaves

13. STATE

New Mexico

1. OIL WELL ☐ GAS WELL ☒ OTHER

2. NAME OF OPERATOR

McClellan Oil Corporation

3. ADDRESS OF OPERATOR

P. O. Dr. 730 Roswell, New Mexico 88202

4. LOCATION OF WELL (Report location clearly and in accordance with any State requirements.* See also space 17 below.)
At surface

1650' FSL & 1980' FWL

14. PERMIT NO.

15. ELEVATIONS (Show whether DF, RT, GR, etc.)

3646 GL

16.

Check Appropriate Box To Indicate Nature of Notice, Report, or Other Data

NOTICE OF INTENTION TO:

TEST WATER SHUT-OFF

FRACTURE TREAT

SHOOT OR ACIDIZE

REPAIR WELL

(Other)

PULL OR ALTER CASING

MULTIPLE COMPLETE

ABANDON*

CHANGE PLANS

SUBSEQUENT REPORT OF:

WATER SHUT-OFF

FRACTURE TREATMENT

SHOOTING OR ACIDIZING

(Other) Gas pipeline right-of-way

(NOTE: Report results of multiple completion on Well Completion or Recompletion Report and Log form.)

REPAIRING WELL

ALTERING CASING

ABANDONMENT*

17. DESCRIBE PROPOSED OR COMPLETED OPERATIONS (Clearly state all pertinent details, and give pertinent dates, including estimated date of starting any proposed work. If well is directionally drilled, give subsurface locations and measured and true vertical depths for all markers and zones pertinent to this work.)*

McClellan Oil Corporation hereby applies for approximately 1300 feet of "on-lease" right of way for a gas pipeline to run southeast from the MM Federal, Well No. 7 wellsite in the NE/4, SW/4 of section 25-T9S-R25E to the wellsite of the MM Fed., No. 4 in the SW/4, SE/4 of the same section 25. The request is for a 15 foot right of way to dig and bury a 3000 PSI tested 2 3/8" tubing to a maximum depth of 24 inches. See Exhibit "A" & "B" for maps. An archaeological survey has been submitted.



18. I hereby certify that the foregoing is true and correct

SIGNED

(This space for Federal or State office use)

APPROVED BY

S/Levi Deike, Acting

CONDITIONS OF APPROVAL, IF ANY:

Agent for:

TITLE McClellan Oil Corporation

DATE September 1, 1987

Area Manager

TITLE

DATE SEP 10 1987

THAT ALL OR PART OF IT MIGHT BE CONVERTED TO A RIGHT-OF-WAY GRANT IN THE FUTURE. ATTACHED ARE TWO PAGES OF STIPULATIONS WHICH ALSO APPLY TO THIS SUNDRY.

*See Instructions on Reverse Side

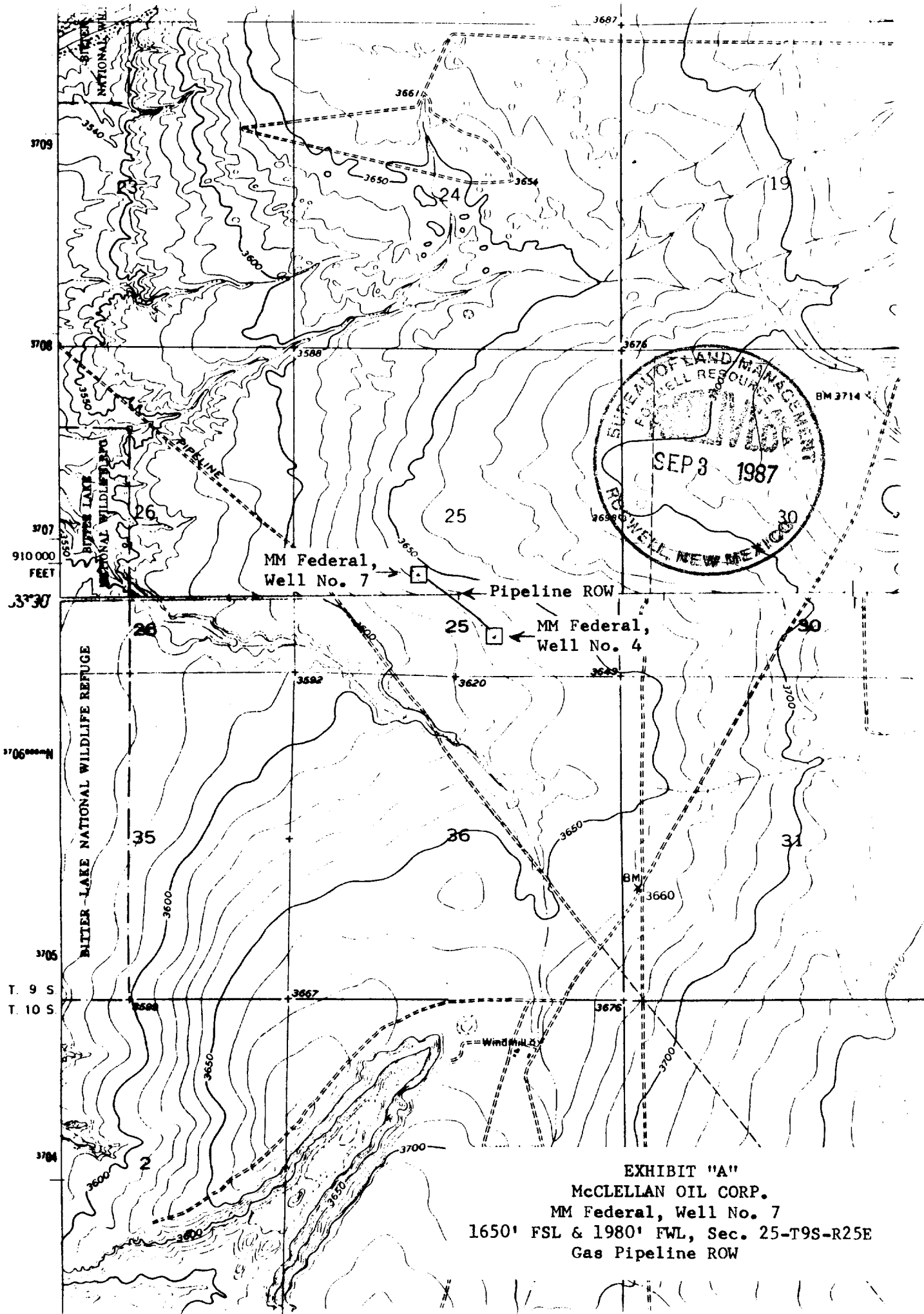

CHAYES COUNTY, NEW MEXICO

SECTION 25-T9S-R25E

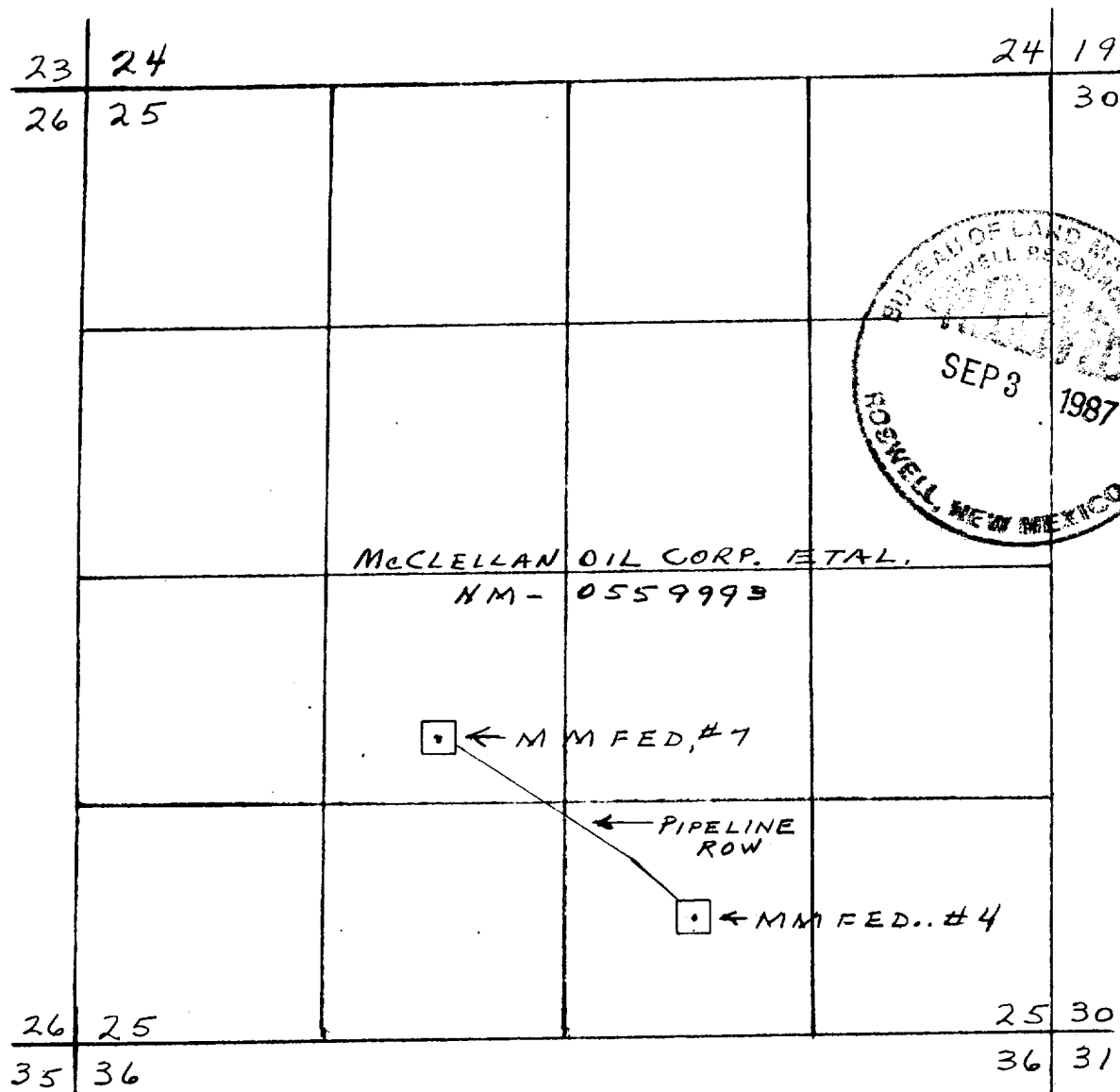

EXHIBIT "B"

McCLELLAN OIL CORP.

MM Federal, Well No. 7

Proposed 2 3/8" Natural Gas Pipeline

Crossing Federal Surface

Date: September 1, 1987

Scale: 1" = 1,000'