

## OIL CONSERVATION DIVISION

P. O. BOX 2088

STATE OF NEW MEXICO  
ENERGY AND MINERALS DEPARTMENT

SANTA FE, NEW MEXICO 87501

Form C-102  
Revised 10-1-78

All distances must be from the outer boundaries of the Section.

Operator McCLELLAN OIL CORP.			Lease RICK FEDERAL		Well No. #2
Unit Letter P	Section 23	Township 9 SOUTH	Range 25 EAST	County CHAVES	
Actual Wellbore Location of Well					
660		feet from the	SOUTH	line and	660
				feet from the	EAST
Ground Level Elev. 3598		Producing Formation Abo		Dedicated Acreage 160	
		Paul		S. Pecos Slope Abo	

1. Outline the acreage dedicated to the subject well by colored pencil or hatchure marks on the plat below.
2. If more than one lease is dedicated to the well, outline each and identify the ownership thereof (both as to working interest and royalty).
3. If more than one lease of different ownership is dedicated to the well, have the interests of all owners been consolidated by communitization, unitization, force-pooling, etc?

☐ Yes ☐ No - If answer is "yes," type of consolidation \_\_\_\_\_

If answer is "no," list the owners and tract descriptions which have actually been consolidated. (Use reverse side of this form if necessary.) \_\_\_\_\_

No allowable will be assigned to the well until all interests have been consolidated (by communitization, unitization, forced-pooling, or otherwise) or until a non-standard unit, eliminating such interests, has been approved by the Division

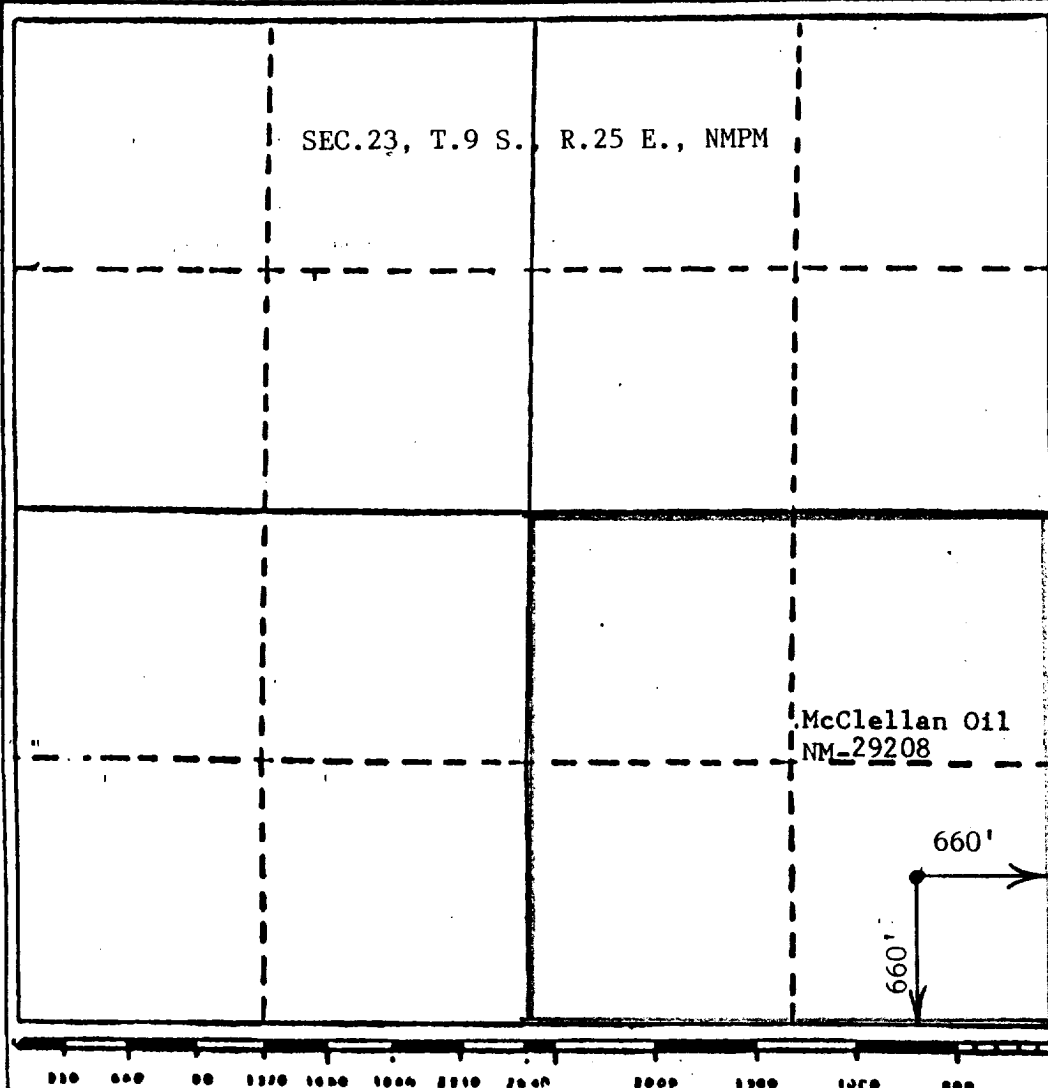

## CERTIFICATION

I hereby certify that the information contained herein is true and complete to the best of my knowledge and belief.

*George R. Smith*

Name

George R. Smith

Position

Agent for:

Company

McClellan Oil Corp.

Date

July 15, 1987

I hereby certify that the well location shown on this plat was plotted from field notes of actual surveys made by me or under my supervision, and that the same is true and correct to the best of my knowledge and belief.

*John D. Jaques*

JOHN D. JAUQUES  
NEW MEXICO  
JUNE 29, 1987  
REGISTERED PROFESSIONAL ENGINEER  
AND LAND SURVEYOR  
No. 12345  
JOHN D. JAUQUES, P.E. & L.S.  
Certificate No. 6290

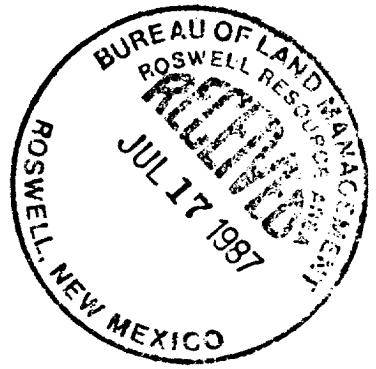

WEK DRILLING CO., INC. - Rig 1 & 3  
**BLOWOUT PREVENTER SPECIFICATION**

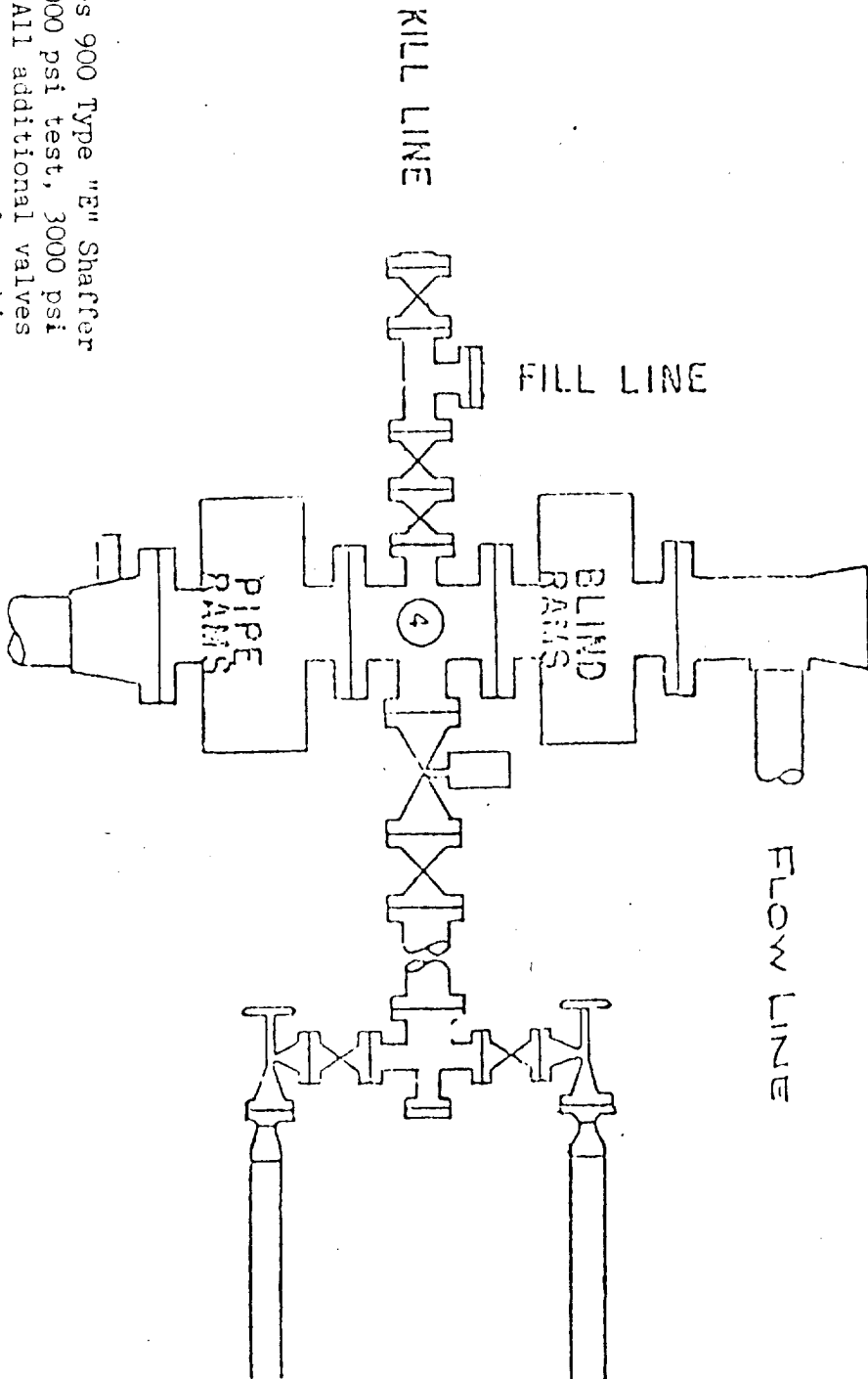

BOP's are 10" Series 900 Type "E" Shaffer Double Hydraulic 6000 psi test, 3000 psi working pressure. All additional valves & connections are the same test & working pressures.

EXHIBIT "E"  
McCLELLAN OIL CORPORATION  
Rick Federal, Well No. 2  
BOP Specifications

APPLICATION FOR DRILLING

McCLELLAN OIL CORPORATION  
Rick Federal, Well No. 2  
660' PSL & 660' FEL, Sec. 23-T9S-R25E  
Chaves County, New Mexico  
Lease No.: NM-29208  
(Development Well)

In conjunction with Form 9-331C, Application for Permit to Drill subject well, McClellan Oil Corporation submits the following items of pertinent information in accordance with BLM requirements:

1. The geologic surface formation is recent Permian with quaternary alluvium and other surficial deposits.

2. The estimated tops of geologic markers are as follows:

San Andres	510'	Abo	3840'
Glorieta	1610'	T.D.	4380'
Tubb	3100'		

3. The estimated depths at which water, oil or gas formations are anticipated to encountered:

Water: Surface water between 100' to 300'.

Oil: None expected.

Gas: In the Abo below 3840'.

4. Proposed Casing Program: See Form 9-331C.
5. Pressure Control Equipment: See Form 9-331C and Exhibit "E".
6. Mud Program: See Form 9-331C.
7. Auxiliary Equipment: Blowout preventer, gas detector, kelly cock, pit level monitor, flow sensors and stabbing valve.
8. Testing, Logging, and Coring Program:  
  
Drill Stem Tests: None planned.  
  
Logging: From surface Casing to T.D.: G/R, CNL-LDT, DLL,  
  
Coring: None planned.
9. No abnormal pressures or temperatures are anticipated. In the event abnormal pressures are encountered the proposed mud program will be modified.
10. Anticipated starting date: July 22, 1987.  
Anticipated completion of drilling operations: Approximately 35 days.



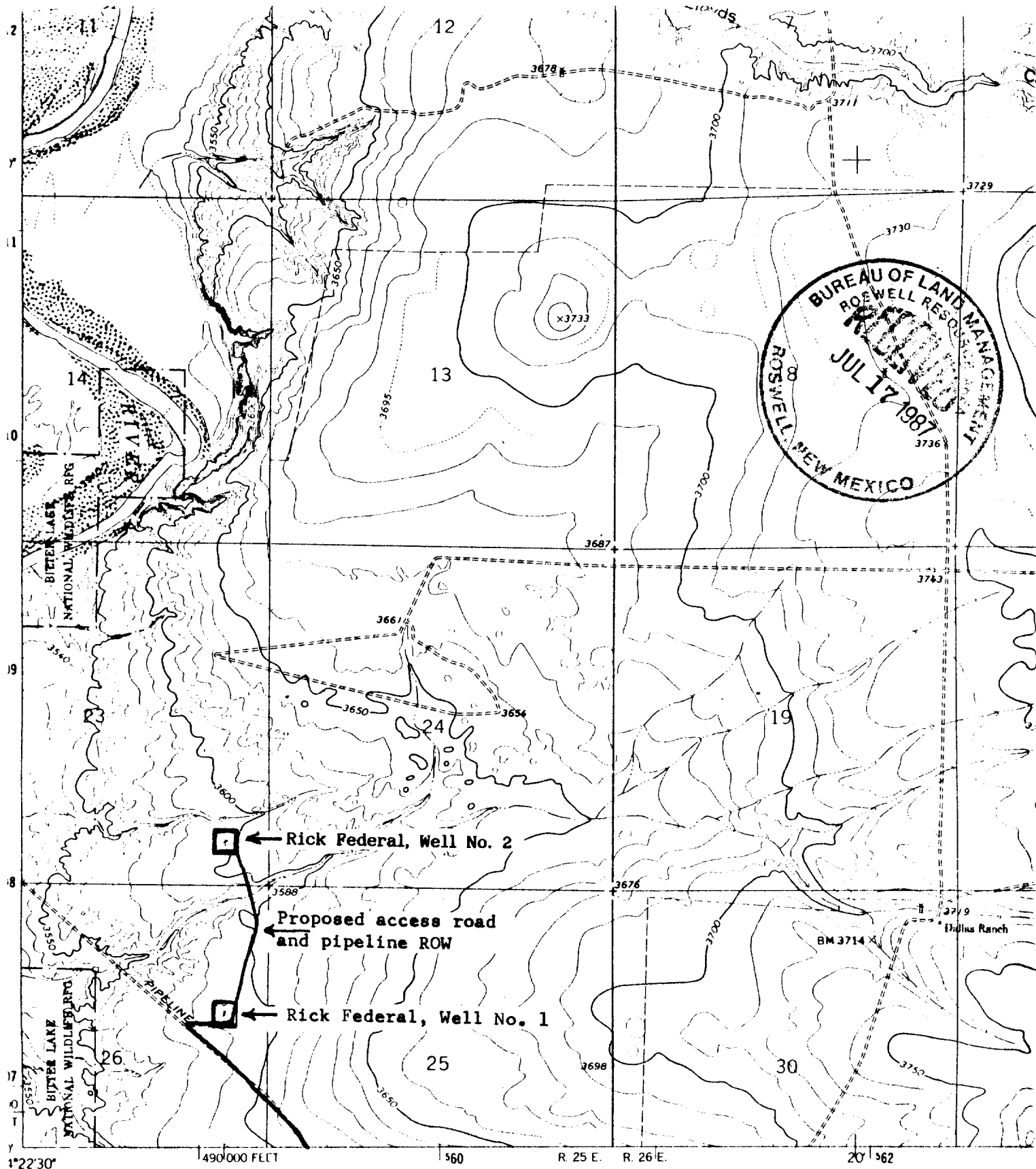

Mapped, edited, and published by the Geological Survey

Control by USGS and USC&GS

Topography by photogrammetric methods from aerial photographs taken 1961 Field checked 1962

Polyconic projection 1927 North American datum  
10,000-foot grid based on New Mexico coordinate system, east zone  
1000 meter Universal Transverse Mercator grid ticks, zone 13, shown in blue

Fine red dashed lines indicate selected fence lines

**EXHIBIT "B"**  
**McCLELLAN OIL CORPORATION**  
**Rick Federal, Well No. 2**  
**660' FSL & 660' FEL, Sec. 23-T9S-R25E**  
**Existing Access Road: —**  
**Proposed Access Road: —**

UTM GRID AND 1962 MAGNETIC NORTH

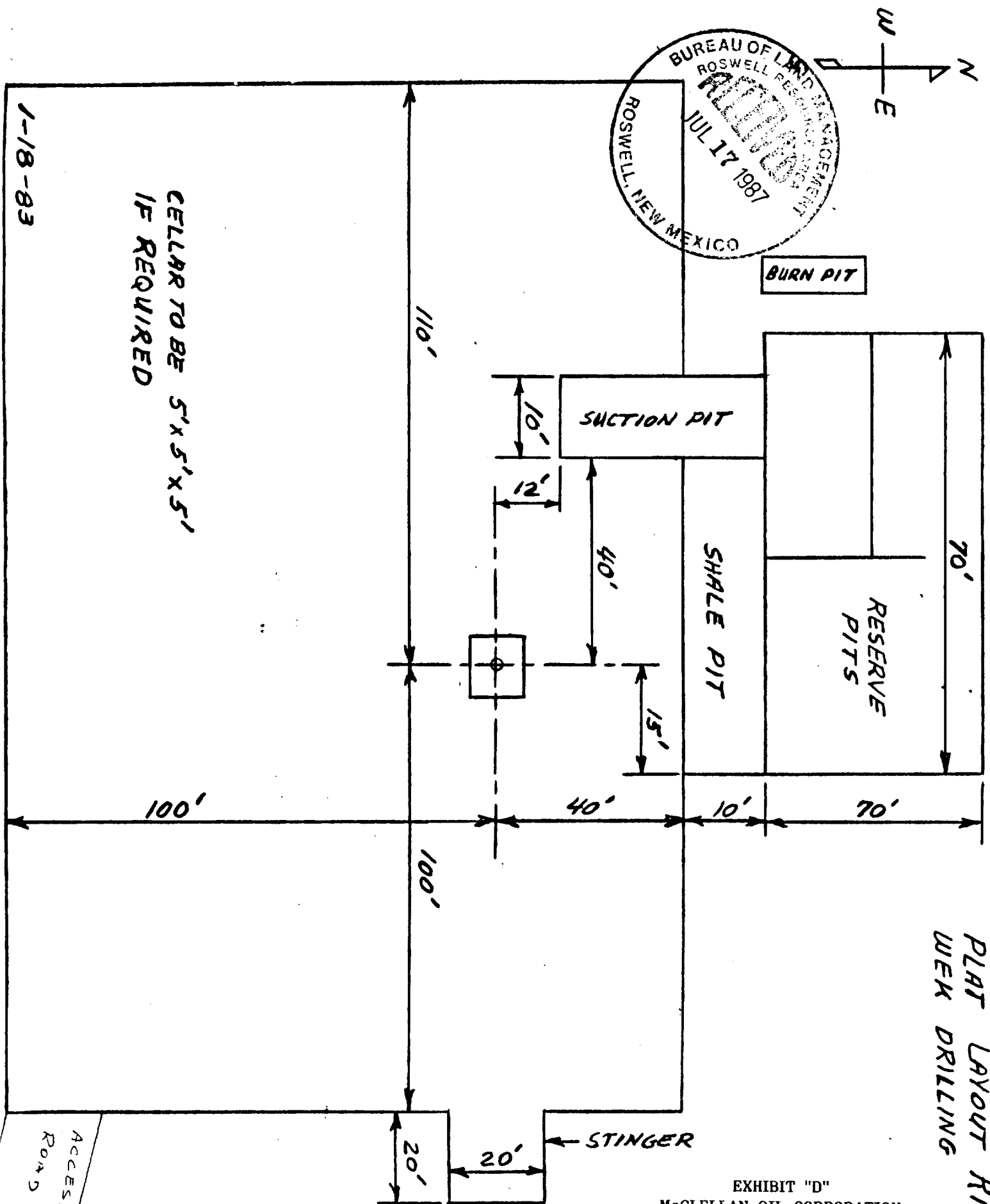

PLAT LAYOUT RIG 1  
WELL DRILLING

EXHIBIT "D"  
McCLELLAN OIL CORPORATION  
Rick Federal, Well No. 2  
Rig Layout