

NO. OF COPIES RECEIVED	
DISTRIBUTION	
SANTA FE	<input checked="" type="checkbox"/>
FILE	<input checked="" type="checkbox"/>
U.S.G.S.	<input checked="" type="checkbox"/>
LAND OFFICE	<input checked="" type="checkbox"/>
OPERATOR	<input checked="" type="checkbox"/>

RECEIVED

FEB 05 '88

AMENDED LOCATION

## APPLICATION FOR PERMIT TO DRILL, DEEPEN, OR PLUG BACK C. O.

1a. Type of Work		ARTESIA, OFFICE		7. Unit Agreement Name	
b. Type of Well		DRILL <input checked="" type="checkbox"/> DEEPEN <input type="checkbox"/> PLUG BACK <input type="checkbox"/>		8. Farm or Lease Name	
OIL WELL <input type="checkbox"/> GAS WELL <input checked="" type="checkbox"/> OTHER <input type="checkbox"/>		SINGLE ZONE <input checked="" type="checkbox"/> MULTIPLE ZONE <input type="checkbox"/>		Homestead	
2. Name of Operator				9. Well No.	
McKay Oil Corporation				1	
3. Address of Operator				10. Field and Pool, or Wildcat	
P.O. Box 2014, Roswell, New Mexico 88202-2014				W. Pecos Slope-Abo	
4. Location of Well				12. County	
UNIT LETTER J LOCATED 1676 FEET FROM THE East LINE				Chaves	
AND 1676 FEET FROM THE South LINE OF SEC. 20 TWP. 6S RGE. 22E NMPM					
19. Proposed Depth		19A. Formation		20. Rotary or C.T.	
3,400'		Abo		Rotary	
21. Elevations (Show whether DT, HT, etc.)		21A. Kind & Status Plug. Band		22. Approx. Date Work will start	
4278' GR		Blanket		February 20, 1988	

23.

## PROPOSED CASING AND CEMENT PROGRAM

SIZE OF HOLE	SIZE OF CASING	WEIGHT PER FOOT	SETTING DEPTH	SACKS OF CEMENT	EST. TOP
12 1/4"	8 5/8"	24.0# J-55	850'±	450 sx	Surface
7 7/8"	4 1/2"	9.5# J-55	T.D.	150 sx	600' above
					T/Pay

1. Drill 12 1/4" hole to 850' and run 8 5/8" casing and cement to surface.
2. Wait on cement for 18 hours.
3. Nipple up on 8 5/8" casing using a Double Ram Blow-out Preventer and pressure test casing to 1000 psi for 30 minutes.
4. Drill 7 7/8" hole to 3,400' to adequately test the Abo formation.
5. Run 4 1/2" casing if warranted and cement to 600' above top of pay section and or to isolate all oil, gas and water zones.

Post 10#1  
NL  
2-12-88180 DATE  
8/8/88  
WAY

IN ABOVE SPACE DESCRIBE PROPOSED PROGRAM; IF PROPOSAL IS TO DEEPEN OR PLUG BACK, GIVE DATA ON PRESENT PRODUCTIVE ZONE AND PROPOSED NEW PRODUCTIVE ZONE. GIVE BLOWOUT PREVENTER PROGRAM, IF ANY.

I hereby certify that the information above is true and complete to the best of my knowledge and belief.

Signed Terry W. Franklin Title \_\_\_\_\_ Agent \_\_\_\_\_ Date February 4, 1988

(This space for State Use)

Original Signed By  
Mike WilliamsAPPROVED BY \_\_\_\_\_ TITLE \_\_\_\_\_ DATE FEB 8 1988CONDITIONS OF APPROVAL, IF ANY Oil & Gas Inspector

All distances must be from the outer boundaries of the Section.

Operator McKAY OIL CORP.		Lease HOMESTEAD		Well No. #1
Unit Letter J	Section 20	Township 6 SOUTH	Range 22 EAST	County CHAVES
Actual Footage Location of Well: 1676 feet from the SOUTH line and 1676 feet from the EAST line				
Ground Level Elev. 4278	Producing Formation Abo	Pool W. Pecos Slope-Abo	Dedicated Acreage 160 Acres	

1. Outline the acreage dedicated to the subject well by colored pencil or hatchure marks on the plat below.
2. If more than one lease is dedicated to the well, outline each and identify the ownership thereof (both as to working interest and royalty).
3. If more than one lease of different ownership is dedicated to the well, have the interests of all owners been consolidated by communitization, unitization, force-pooling, etc?

☐ Yes ☐ No If answer is "yes," type of consolidation \_\_\_\_\_

If answer is "no," list the owners and tract descriptions which have actually been consolidated. (Use reverse side of this form if necessary.) \_\_\_\_\_

No allowable will be assigned to the well until all interests have been consolidated (by communitization, unitization, forced-pooling, or otherwise) or until a non-standard unit, eliminating such interests, has been approved by the Division.

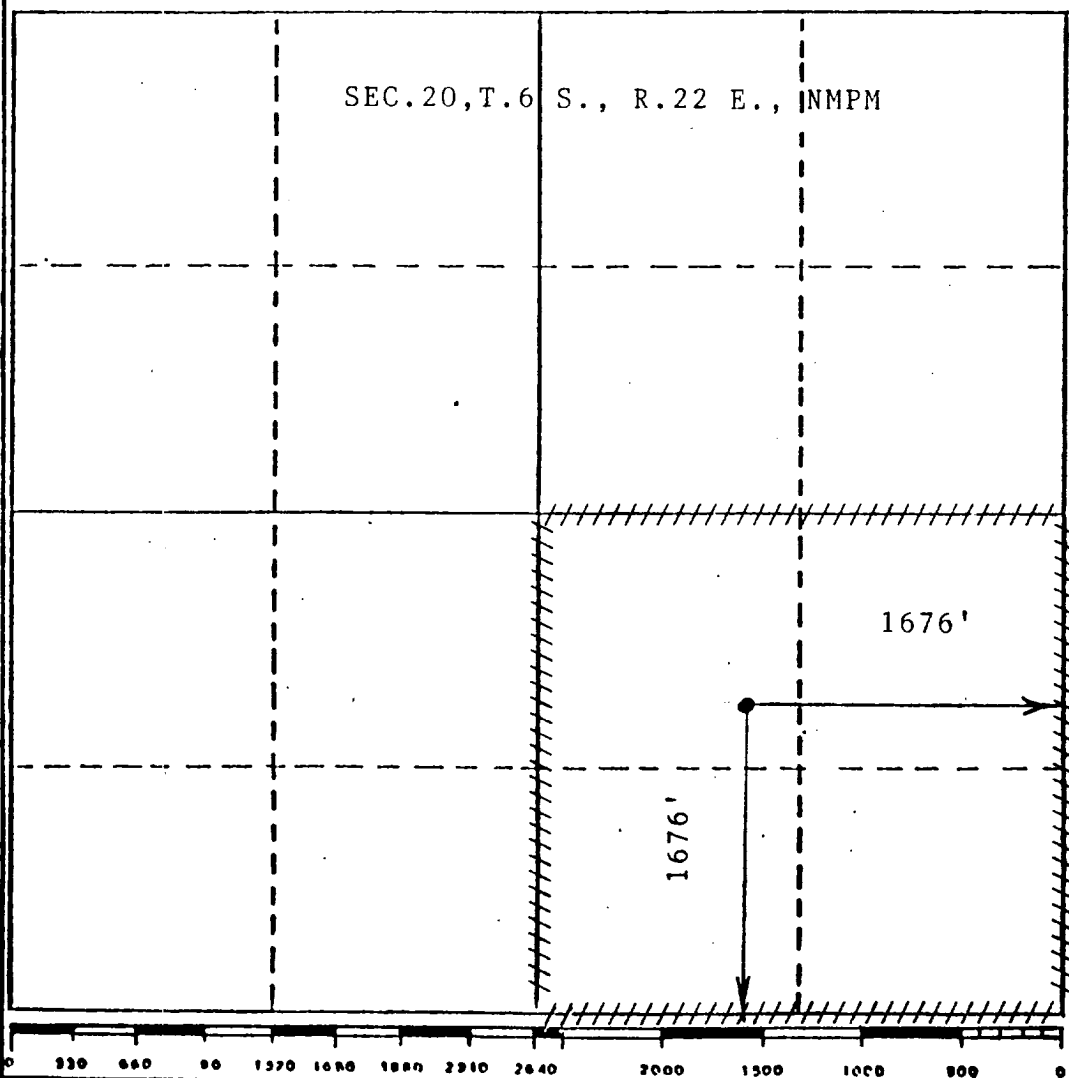

#### CERTIFICATION

I hereby certify that the information contained herein is true and complete to the best of my knowledge and belief.

*Terry W. Franklin*  
Name

Terry W. Franklin

Position

Agent

Company

McKay Oil Corporation

Date

February 4, 1988

I hereby certify that the well location shown on this plat was plotted from field notes of actual surveys made by me or under my supervision, and that the same is true and correct to the best of my knowledge and belief.

JOHN D. JAQUESS  
Date Surveyed  
JANUARY 29, 1988  
Registered Professional Engineer  
and a Land Surveyor  
John D. Jaquess, P.E. & L.S.  
Certificate No. 6290

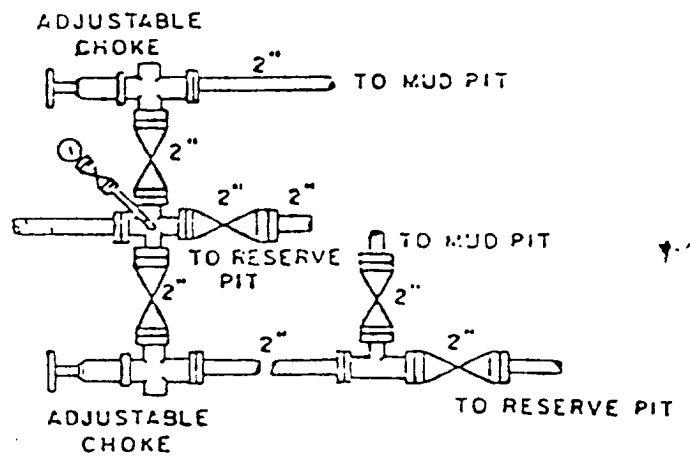
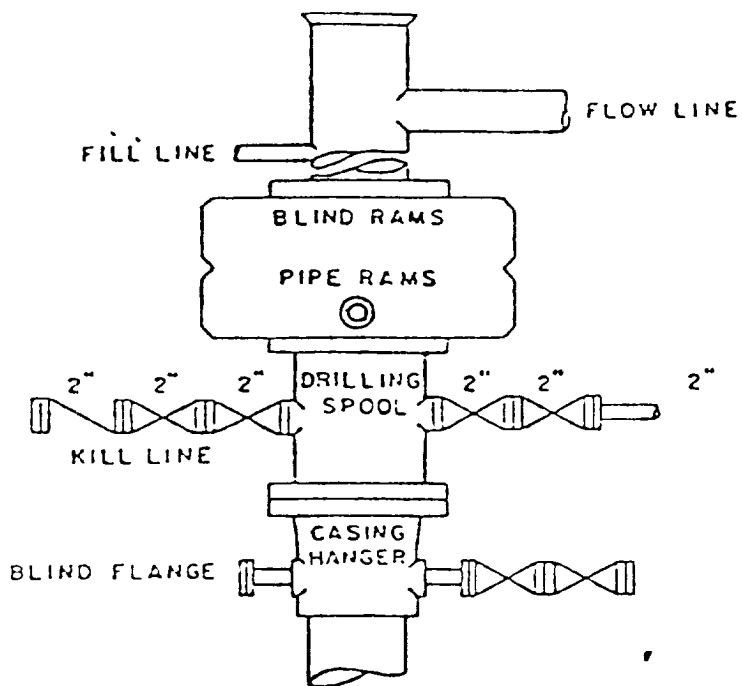

# BOP DIAGRAM

3000# Working Pressure  
Rams Operated Daily