

STATE OF NEW MEXICO
ENERGY AND MINERALS DEPARTMENT

IL CONSERVATION DIVISION

P. O. BOX 2088

SANTA FE, NEW MEXICO 87501

RECEIVED

30-005-61553
Form C-101
Revised 10-1-78

OCT 21 '87

O. C. D.
ARTESIA OFFICE

NO. OF COPIES RECEIVED	
DISTRIBUTION	
SANTA FE	
FILE	
U.S.G.S.	
LAND OFFICE	
OPERATOR	

5A. Indicate Type of Lease
STATE ☒ FEE ☐

5. State Oil & Gas Lease No.
LG-8138

APPLICATION FOR PERMIT TO DRILL, DEEPEN, OR PLUG BACK

1a. Type of Work b. Type of Well OIL WELL <input type="checkbox"/> GAS WELL <input checked="" type="checkbox"/> OTHER <input type="checkbox"/> SINGLE ZONE <input type="checkbox"/> MULTIPLE ZONE <input type="checkbox"/>		DRILL <input checked="" type="checkbox"/> DEEPEN <input type="checkbox"/> PLUG BACK <input type="checkbox"/>		7. Unit Agreement Name Hard as Nails State Unit
2. Name of Operator Yates Petroleum Corporation		3. Address of Operator 105 South Fourth Street - Artesia, NM 88210		8. Farm or Lease Name HARD AS NAILS ST. JT.
4. Location of Well UNIT LETTER J LOCATED 1980 FEET FROM THE South LINE AND 1980 FEET FROM THE East LINE OF SEC. 27 TWP. 9S RGE. 26E NMPM		9. Well No. 1		10. Field and Pool, or Wildcat Pecos Slope Abo
11. Elevations (show whether DF, RT, etc.) 3803.2' GR		21A. Kind & Status Plug. Bond Blanket		12. County Chaves
21B. Drilling Contractor Undesignated		19. Proposed Depth 5200'		19A. Formation Abo
22. Approx. Date Work will start ASAP		20. Rotary or C.T. Rotary		

PROPOSED CASING AND CEMENT PROGRAM

SIZE OF HOLE	SIZE OF CASING	WEIGHT PER FOOT	SETTING DEPTH	SACKS OF CEMENT	EST. TOP
12-1/4"	8-5/8"	24# K-55	Approx. 1000'	600 sacks	Circulate
7-7/8"	4-1/2"	9.5# J-55	TD	450 sacks	

We propose to drill and test the Abo and intermediate formations. Approximately 1000' of surface casing will be set and cement circulated to shut off gravel and cavings. If commercial, production casing will be run and cemented with adequate cover, perforated and stimulated as needed for production.

MUD PROGRAM: FW gel & LCM to 1000', brine to 3500', brine, salt water gel & starch to TD

BOP PROGRAM: BOP's will be tested daily and installed at the offset.

GAS NOT DEDICATED

FOR 180 DAYS
4-22-88
UNDERWAY

IN ABOVE SPACE DESCRIBE PROPOSED PROGRAM; IF PROPOSAL IS TO DEEPEN OR PLUG BACK, GIVE DATA ON PRESENT PRODUCTIVE ZONE AND PROPOSED NEW PRODUCTIVE ZONE. GIVE BLOWOUT PREVENTER PROGRAM, IF ANY.

I hereby certify that the information above is true and complete to the best of my knowledge and belief.

Signed Clifton R. May Title Regulatory Agent Date October 14, 1987

(This space for State Use)

Original Signed By
Mike Williams

APPROVED BY Oil & Gas Inspector TITLE Oil & Gas Inspector DATE OCT 22 1987

CONDITIONS OF APPROVAL, IF ANY

**NEW MEXICO OIL CONSERVATION COMMISSION
WELL LOCATION AND ACREAGE DEDICATION PLAT**

Form C-102
Supersedes C-128
Effective 1-1-85

All distances must be from the outer boundaries of the Section.

Operator YATES PETROLEUM CORPORATION			Lease HARD AS NAILS STATE UNIT		Well No. 1
Unit Letter J	Section 27	Township 9 South	Range 26 East	County Chaves	
Actual Footage Location of Well:					
1980 feet from the South line and		1980 feet from the East line		Map	
Ground Level Elev. 3803.2	Producing Formation Abo	Pool PEROS. SLOPE Abo	Dedicated Acreage 160 Acres		

1. Outline the acreage dedicated to the subject well by colored pencil or hatchure marks on the plat below.
2. If more than one lease is dedicated to the well, outline each and identify the ownership thereof (both as to working interest and royalty).
3. If more than one lease of different ownership is dedicated to the well, have the interests of all owners been consolidated by communitization, unitization, force-pooling, etc?

☒ Yes ☐ No If answer is "yes," type of consolidation **IS TO BE COMMUNITIZED**

If answer is "no," list the owners and tract descriptions which have actually been consolidated. (Use reverse side of this form if necessary.) _____

No allowable will be assigned to the well until all interests have been consolidated (by communitization, unitization, forced-pooling, or otherwise) or until a non-standard unit, eliminating such interests, has been approved by the Commission.

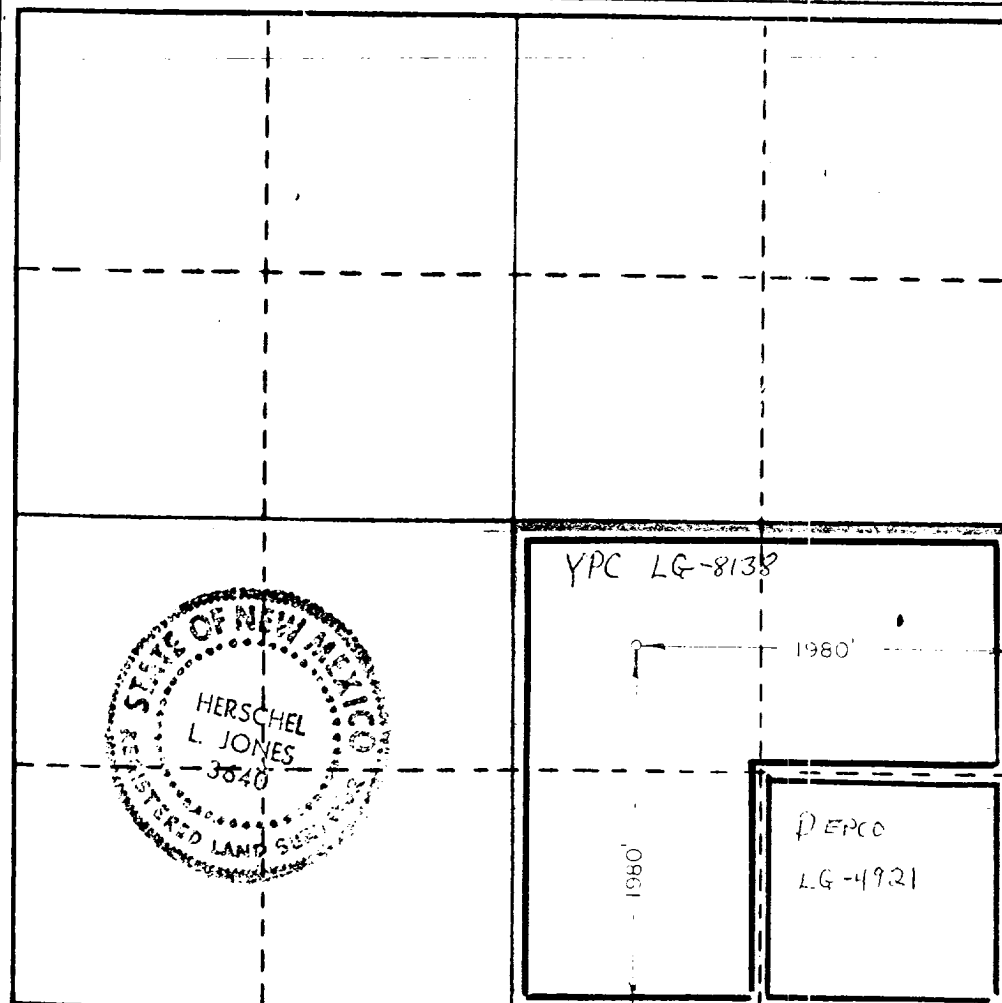

CERTIFICATION

I hereby certify that the information contained herein is true and complete to the best of my knowledge and belief.

Clifton R. May
Name

Clifton R. May

Position

Regulatory Agent

Company

Yates Petroleum Corporation

Date

October 14, 1987

I hereby certify that the well location shown on this plat was plotted from field notes of actual surveys made by me or under my supervision, and that the same is true and correct to the best of my knowledge and belief.

Date Surveyed

10/12/87

Registered Professional Engineer and/or Land Surveyor

Herschel L. Jones
Certificate No. **3640**

EXHIBIT B

BDP DIAGRAM

RATED 3000[#]

