

DISTRICT I  
1625 N. French Dr., Hobbs, NM 88240

DISTRICT II  
811 South First, Artesia, NM 88210

DISTRICT III  
1000 Rio Brazos Rd., Aztec, NM 87410

DISTRICT IV  
2040 South Pacheco, Santa Fe, NM 87501

State of New Mexico  
Energy, Minerals and Natural Resources Department

OIL CONSERVATION DIVISION  
PO BOX 2088  
Santa Fe, NM 87504-2088

Form C-101  
Revised March 17, 1999  
Instructions on back  
Submit to appropriate District Office  
State Lease - 6 Copies  
Fee Lease - 5 Copies

☐ AMENDED REPORT

APPLICATION FOR PERMIT TO DRILL, RE-ENTER, DEEPEN, PLUGBACK, OR ADD A ZONE

<sup>1</sup> Operator Name and Address Yates Petroleum Corporation 105 South Fourth Street Artesia, New Mexico 88210		<sup>2</sup> OGRID Number 025575
		<sup>3</sup> API Number 30- 30-005-62553
<sup>4</sup> Property Code 26800	<sup>5</sup> Property Name Hard As Nails AMD State Com.	<sup>6</sup> Well No. 3

<sup>7</sup> Surface Location

UL or lot no.	Section	Township	Range	Lot Idn	Feet from the	North/South Line	Feet from the	East/West Line	County
J	27	9S	26E		1980'	South	1980'	East	Chaves

<sup>8</sup> Proposed Bottom Hole Location If Different From Surface

UL or lot no.	Section	Township	Range	Lot Idn	Feet from the	North/South Line	Feet from the	East/West Line	County
<sup>9</sup> Proposed Pool 1 Undes. Foot Ranch Pre Permian					<sup>10</sup> Proposed Pool 2				

<sup>11</sup> Work Type Code E	<sup>12</sup> Well Type Code G	<sup>13</sup> Cable/Rotary R	<sup>14</sup> Lease Type Code S	<sup>15</sup> Ground Level Elevation 3803.2'
<sup>16</sup> Multiple N	<sup>17</sup> Proposed Depth 6200'	<sup>18</sup> Formation Ordovician	<sup>19</sup> Not Determined	<sup>20</sup> Spud Date ASAP

<sup>21</sup> Proposed Casing and Cement Program

Hole Size	Casing Size	Casing weight/feet	Setting Depth	Sacks of Cement	Estimated TOC
12 1/4"	8 5/8"	42#	978'	475 sx	In Place
7 7/8"	5 1/2"	24#	6200'	As necessary	TOC 3200'
Cement to cover	all oil, gas, and	water bearing	zones.		

<sup>22</sup> Describe the proposed program. If this application is to DEEPEN or PLUG BACK give the data on the present production zone and proposed new production zone. Describe the blowout prevention program, if any. Use additional sheets if necessary.

SEE ATTACHED PAGE #2.

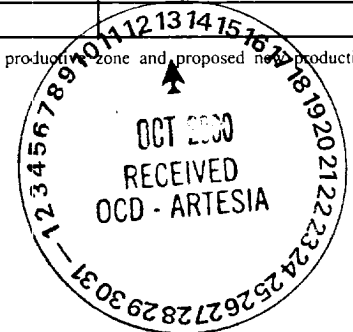

<sup>23</sup> I hereby certify that the information given above is true and complete to the best of my knowledge and belief. Signature: <i>Cy Cowan</i>		OIL CONSERVATION DIVISION	
Printed name: Cy Cowan		Approved by: ORIGINAL SIGNED BY TIM W. GUM	
Title: Regulatory Agent		DISTRICT II SUPERVISOR	
Date: 10/09/00		Approval Date: OCT 17 2000 Expiration Date: OCT 17 2001	
Phone: (505) 748-1471		Conditions of Approval Attached <input type="checkbox"/> BGA	

District I  
PO Box 1980, Hobbs, NM 88241-1980  
District II  
PO Drawer DD, Artesia, NM 88211-0719  
District III  
1000 Rio Brazos Rd., Aztec, NM 87410  
District IV  
PO Box 2088, Santa Fe, NM 87504-2088

State of New Mexico  
Energy, Minerals & Natural Resources Department

OIL CONSERVATION DIVISION  
PO Box 2088  
Santa Fe, NM 87504-2088

Form C-102  
Revised February 10, 1994  
Instructions on back  
Submit to Appropriate District Office  
State Lease - 4 Copies  
Fee Lease - 3 Copies

☐ AMENDED REPORT

WELL LOCATION AND ACREAGE DEDICATION PLAT

1 API Number		2 Pool Code		3 Pool Name Undes. Four Ranch Pre Permian	
4 Property Code		5 Property Name Hard As Nails AMD State Com.			6 Well Number 3
7 OGRID No. 025575		8 Operator Name YATES PETROLEUM CORPORATION			9 Elevation 3808.2'

10 Surface Location

UL or lot no.	Section	Township	Range	Lot Idn	Feet from the	North/South line	Feet from the	East/West line	County
J	27	9S	26E		1980'	South	1980'	East	Chaves

11 Bottom Hole Location If Different From Surface

UL or lot no.	Section	Township	Range	Lot Idn	Feet from the	North/South line	Feet from the	East/West line	County
12 Dedicated Acres 320		13 Joint or Infill		14 Consolidation Code		15 Order No.			

NO ALLOWABLE WILL BE ASSIGNED TO THIS COMPLETION UNTIL ALL INTERESTS HAVE BEEN CONSOLIDATED  
OR A NON-STANDARD UNIT HAS BEEN APPROVED BY THE DIVISION

16				17 OPERATOR CERTIFICATION I hereby certify that the information contained herein is true and complete to the best of my knowledge and belief  Signature <u>Cy Cowan</u> Printed Name <u>Cy Cowan</u> Title <u>Regulatory Agent</u> Date <u>October 11, 2000</u>					
				18 SURVEYOR CERTIFICATION I hereby certify that the well location shown on this plat was plotted from field notes of actual surveys made by me or under my supervision, and that the same is true and correct to the best of my belief.  Date of Survey _____ Signature and Seal of Professional Surveyor: _____  REFER TO ORIGINAL PLAT  Certificate Number _____					
16		16-8138		1980'		1980'		16-8138	
16		16-8138		1980'		1980'		16-8138	
16		16-8138		1980'		1980'		16-8138	

**NEW MEXICO OIL CONSERVATION ( MISSION  
WELL LOCATION AND ACREAGE DEDICATION PLAT**

Form C-102  
Supersedes C-128  
Effective 1-1-65

*All distances must be from the outer boundaries of the Section.*

Operator <b>YATES PETROLEUM CORPORATION</b>			Lease <b>HARD AS NAILS STATE UNIT</b>		Well No. <b>1</b>
Unit Letter <b>J</b>	Section <b>27</b>	Township <b>9 South</b>	Range <b>26 East</b>	County <b>Chaves</b>	
Actual Footage Location of Well: <div style="display: flex; justify-content: space-between;"> <span>1980 feet from the South line and</span> <span>1980 feet from the East line</span> </div>					
Ground Level Elev. <b>3803.2</b>	Producing Formation <b>Abo</b>	Pool <b>PEROS SLOPE Abo</b>		Dedicated Acreage <b>160</b> Acres	

1. Outline the acreage dedicated to the subject well by colored pencil or hatchure marks on the plat below.
2. If more than one lease is dedicated to the well, outline each and identify the ownership thereof (both as to working interest and royalty).
3. If more than one lease of different ownership is dedicated to the well, have the interests of all owners been consolidated by communitization, unitization, force-pooling, etc?

☒ Yes    ☐ No    If answer is "yes," type of consolidation **IS TO BE COMMUNITIZED**

If answer is "no," list the owners and tract descriptions which have actually been consolidated. (Use reverse side of this form if necessary.) \_\_\_\_\_

No allowable will be assigned to the well until all interests have been consolidated (by communitization, unitization, forced-pooling, or otherwise) or until a non-standard unit, eliminating such interests, has been approved by the Commission.

**CERTIFICATION**

I hereby certify that the information contained herein is true and complete to the best of my knowledge and belief.

*Clifton R. May*

Name

Clifton R. May

Position

Regulatory Agent

Company

Yates Petroleum Corporation

Date

October 14, 1987

I hereby certify that the well location shown on this plat was plotted from field notes of actual surveys made by me or under my supervision, and that the same is true and correct to the best of my knowledge and belief.

Date Surveyed

10/12/87

Registered Professional Engineer and/or Land Surveyor

*Herschel L. Jones*

Certificate No.

3640

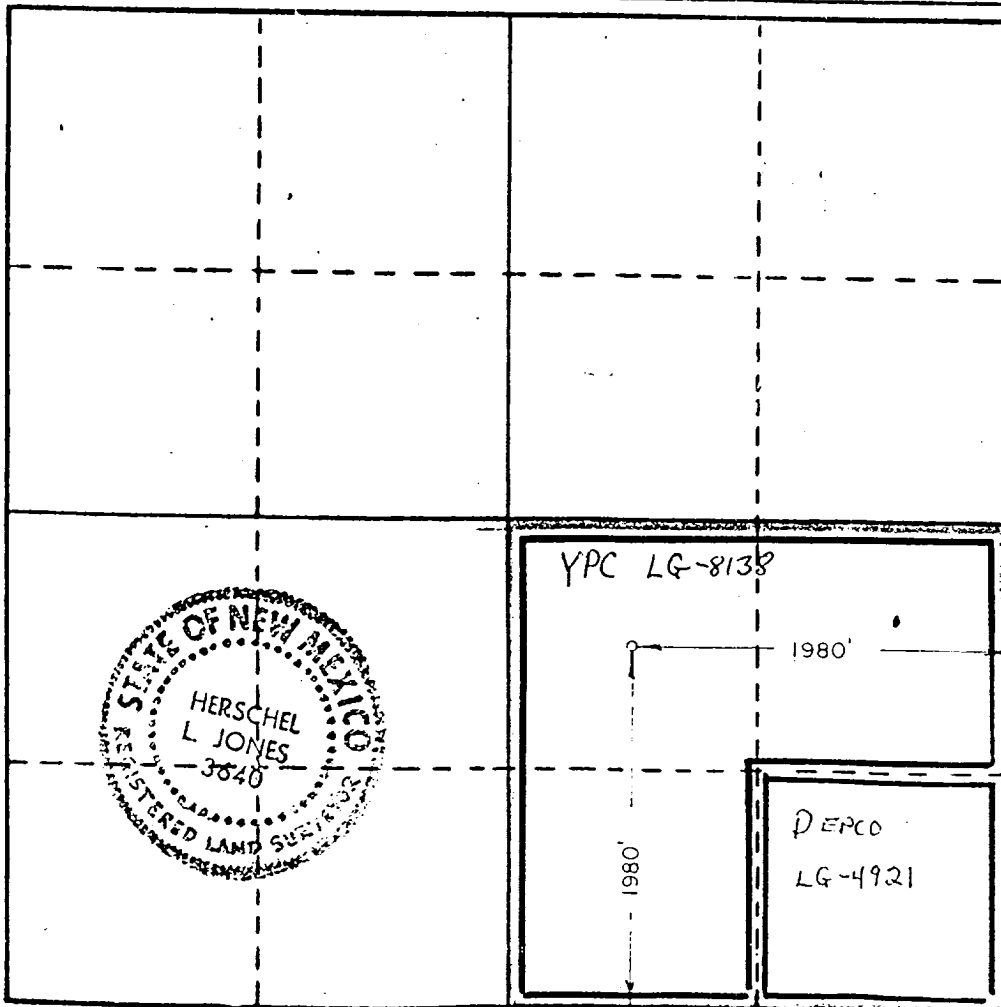

# **YATES PETROLEUM CORPORATION**

## **Re-entry Procedure**

### **Hard as Nails AMD State #3**

#### **Drilling Prognosis**

#### **Page 2**

This well was originally drilled by Yates Petroleum Corporation as the Hard as Nails State Unit #1 on November 18, 1987. Yates Petroleum Corporation proposes to re-enter this well with a drilling rig and drill out plugs in the 8 5/8" casing and in the 7 7/8" open hole to 5100'. The well will be deepened to 6200' in the Ordovician Formation. A new suite of open hole logs will be run then a string of 5 1/2" casing will be run to TD and cemented back to 3,000'+-. The well will then be completed with a pulling unit. The formation to be tested will be the Wolfcamp Formation.

MUD PROGRAM: 0-5100' Brine; 5100'-6200' Salt Gel/Starch. Wt 9.3-10.2.  
Vis 32-40. <10cc.

BOPE PROGRAM: 2000 # BOPE will be nipped up on 8 5/8 in casing.

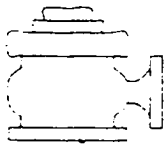

# Yates Petroleum Corporation

BOP-2

## Typical 2,000 psi Pressure System Schematic Double Ram Preventer Stack

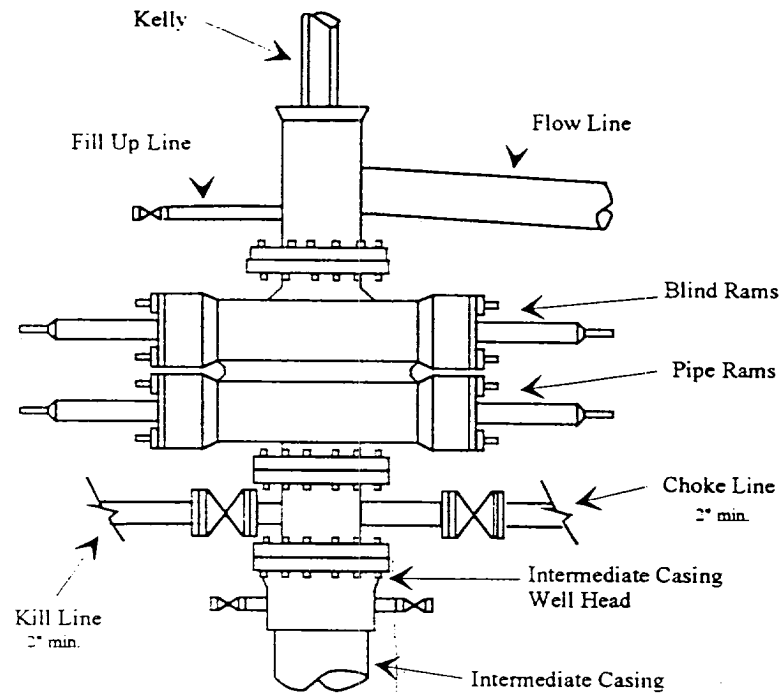

Typical 2,000 psi choke manifold assembly with at least these minimum features

