

CONSERVATION DIVISION

P. O. BOX 2088

SANTA FE, NEW MEXICO 87501

Form C-102
Revised 10-1-78

STATE OF NEW MEXICO

ENERGY AND MINERALS DEPARTMENT

All distances must be from the outer boundaries of the Section.

Operator ELK OIL			Lease RUNYAN STATE UNIT			Well No. 1		
Unit Letter N	Section 28	Township 8 SOUTH	Range 27 EAST	County CHAVES				
Actual Footage Location of Well: 1980 feet from the WEST line and 660 feet from the SOUTH line								
Ground Level Elev. 3892	Producing Formation Penn		Pool S. PALMA MESA PENN Undesignated N. Poor Ranch Penn			Dedicated Acreage: 320 Acres		

1. Outline the acreage dedicated to the subject well by colored pencil or hatchure marks on the plat below.
2. If more than one lease is dedicated to the well, outline each and identify the ownership thereof (both as to working interest and royalty).
3. If more than one lease of different ownership is dedicated to the well, have the interests of all owners been consolidated by communitization, unitization, force-pooling, etc?

☒ Yes ☐ No If answer is "yes," type of consolidation Unit

If answer is "no," list the owners and tract descriptions which have actually been consolidated. (Use reverse side of this form if necessary.)

No allowable will be assigned to the well until all interests have been consolidated (by communitization, unitization, forced-pooling, or otherwise) or until a non-standard unit, eliminating such interests, has been approved by the Division.

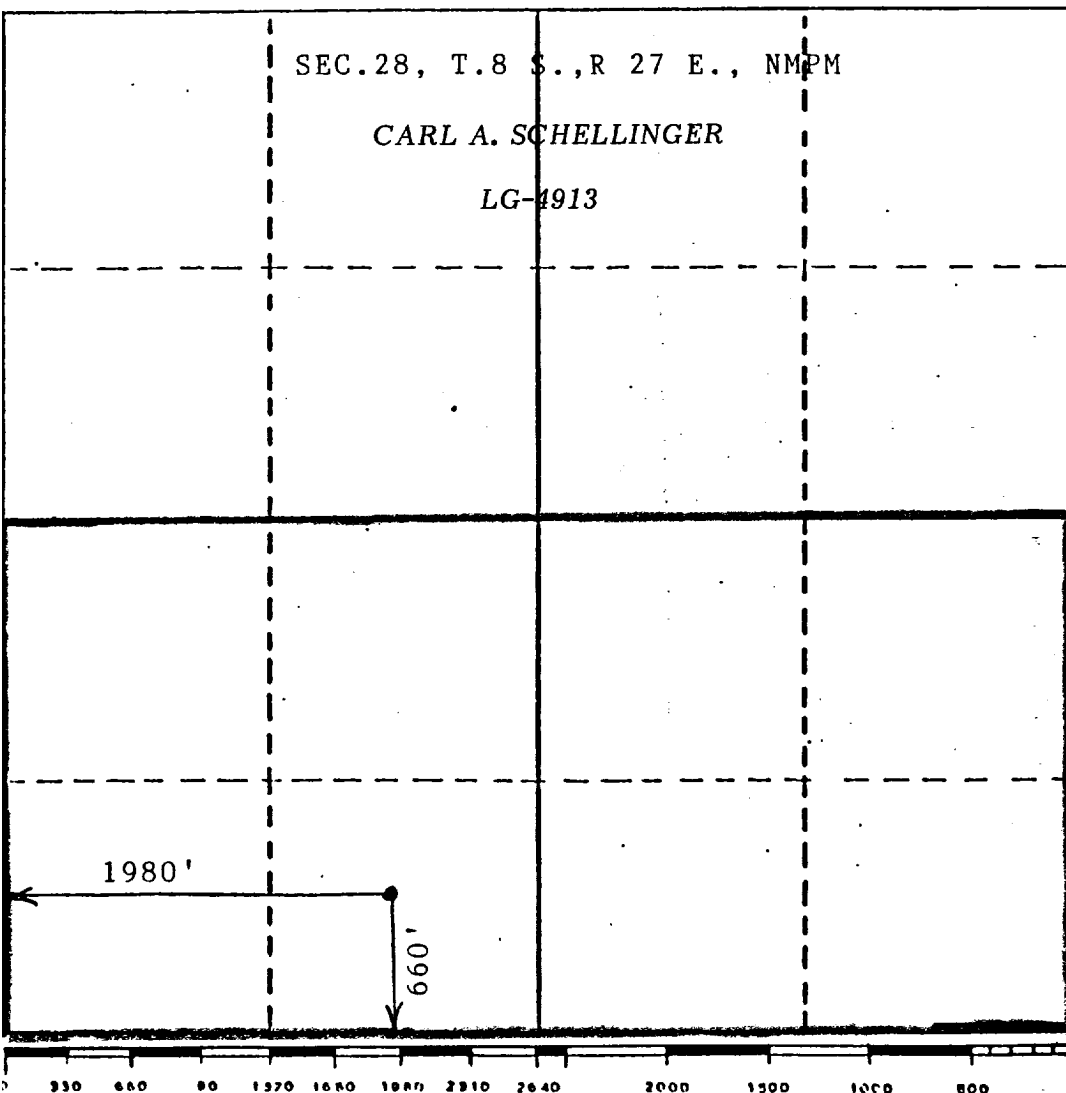

CERTIFICATION

I hereby certify that the information contained herein is true and complete to the best of my knowledge and belief.

Name
Joseph J. Kelly
Position
President
Company
ELK OIL COMPANY
Date
November 5, 1987

I hereby certify that the well location shown on this plat was plotted from field notes of actual surveys made by me or under my supervision, and that the same is true and correct to the best of my knowledge and belief.

JOHN D. JAQUES
Date Surveyed
OCTOBER 21, 1987
Registered Professional Engineer and/or Land Surveyor
John D. Jaques
Certificate No. **6290**